

12/1/11

SEWER	
REVISIONS	
SUPPLEMENTAL DRAWINGS:	
C-324 A	C-390
C-325	C-739
C-326 A	C-585
C-327	C-739 A
	C-739 B

NOTE:
BEFORE STARTING CONSTRUCTION CONTRACTOR MUST CHECK WITH UTILITIES FOR LOCATIONS OF EXISTING STRUCTURES WHETHER OR NOT INDICATED ON PLANS

PLAN SCALE DISTORTED
LOTS & ALLEYS 1"=100'
STREET WIDTHS 1"=50'

DRAINAGE COMPLETED
PAVING COMPLETED

QUANTITIES	ESTIMATED		FINAL	
	LOTS	CITY	LOTS	CITY
EXCAVATION CU. YDS.				
NEW CURB LIN. FT.				
PAVING SQ. YDS.				
SIDEWALK SQ. FT.				
MANHOLES ADJUST				
CONSTRUCT				
BASINS ADJUST				
CONSTRUCT				
SEWERS 12" LIN. FT.				
SEWERS 15" LIN. FT.				

HON. SCALE 1"=100'	BOOK 1669	PAGE 20
VER. SCALE 1"=2'	DATE DRAWING 11-20-46	COMPUTED 3-28-47
PLAN	W.C. PROFILE	W.C. CHECKED
CHECKED 5.5	GRADE	W.C. CHECKED 5.5
LOTTS 21	2394	1196
CITY 21	76	38
TOTAL 21	2468	1234
CITY		

DESIGNED BY
DRAWN BY
TRACED BY
CHECKED BY
APPROVED BY

Wm. Chittard
R. J. Staehelin
ENGINEER OF STREETS
ASSIST. CITY ENGINEER

DEPARTMENT OF PUBLIC WORKS DETROIT
CITY ENGINEERS OFFICE DIVISION OF PAVING DESIGN
STREET PAVING PLAN
STAHELIN

ASSIGN NO. 203-22
PETITION NO.

NAME OF STREET
20'S of N.P.L. OF OUTER DR.
S.P.L. OF CURTIS.

RECORD NO. 65 104
INDEX TO NO. 65 104

DATE 8:6:8
REQUESTED BY Schmedding
TYPE OF PAVEMENT ONE COURSE CONCRETE - INTERNAL CURB
WIDTH 30-36

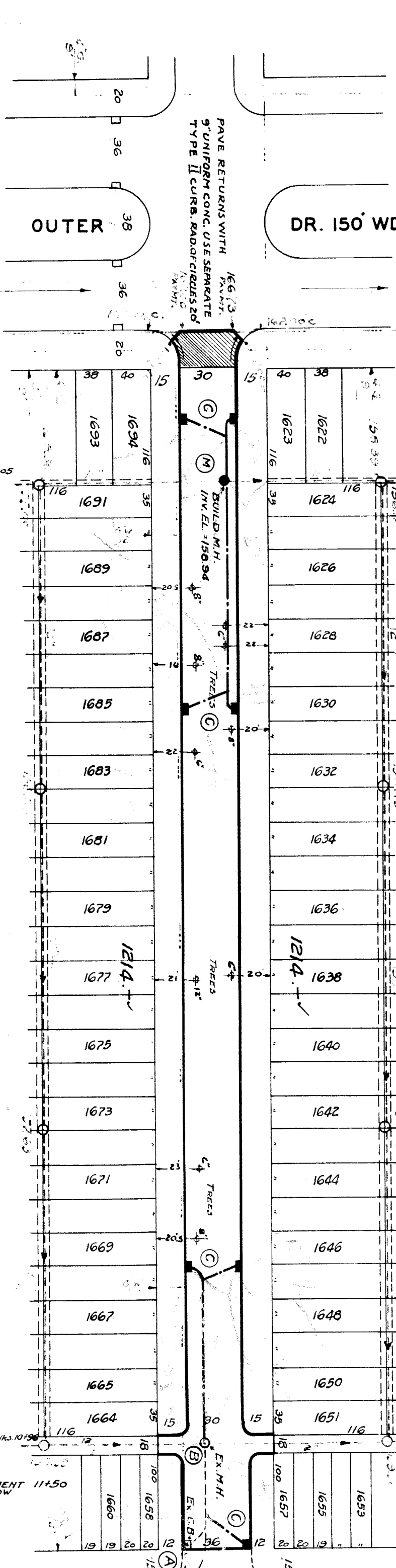

167.78	167.00	167.71	167.00
167.85	167.65	167.85	167.65
168.16	168.05	168.16	168.05
168.35	168.35	168.35	168.35
168.85	168.85	168.85	168.85
169.19	169.19	169.19	169.19
169.39	169.39	169.39	169.39
169.59	169.59	169.59	169.59
170.09	170.09	170.09	170.09
170.19	170.19	170.19	170.19
170.26	170.26	170.26	170.26
169.76	169.76	169.76	169.76

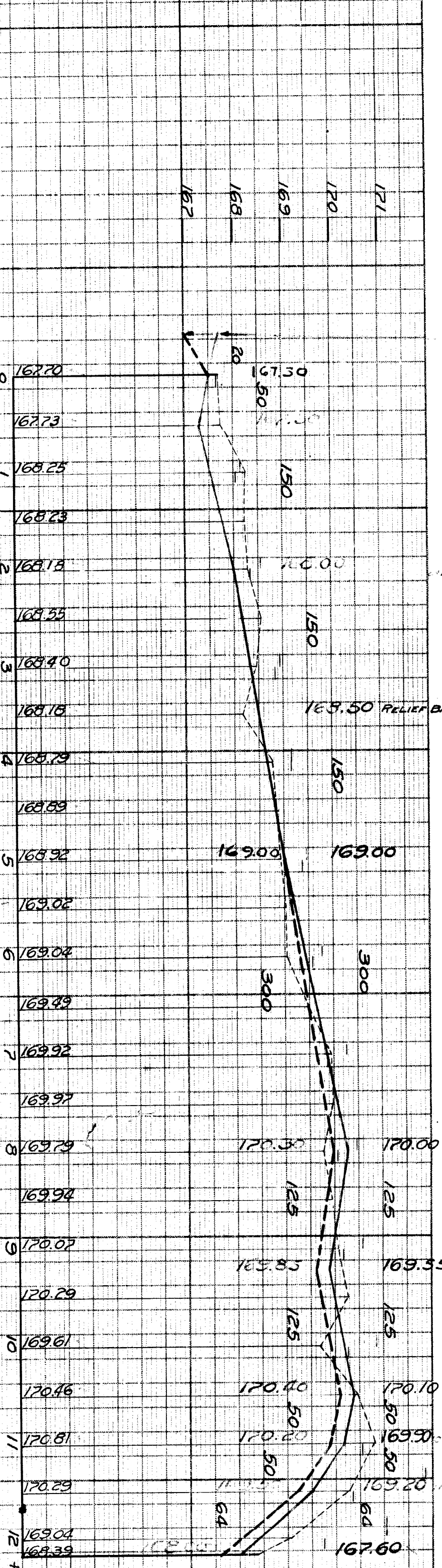

- Ⓐ Remove 1 ex. 12" L. basin and replace with 1 modified 18-12" Y. basin complete.
- Ⓑ Adjust top of 1 existing M.H. Construct 7 Std. 18x12" Y. basins complete and connect to existing sewer as shown.
- Ⓜ Construct 1 Std. M.H. complete.
- Contractor shall furnish and install Std. Flat Type Catch Basin Frames + Grates.
- Contractor shall haul Old castings to DPW Yard of State Fair + John R.
- B.M. #104-250 S.E. Cor. Sunderland + Nichols 160.048
- B.M. + W.S. Condit. Base light pole N.E. Cor. Stahelin + Outer Dr. 168.63
- Arrow Hyd. E.S. Stahelin 350' N. of Outer Dr. 171.89
- Arrow Hyd. N.E. Cor. Sunderland + Curtis. 162.81
- Arrow Hyd. N.E. Cor. Sunderland + Margaretta. 174.96
- B.M. 105-250 N.E. Cor. Sunderland + Seven M. 172.15

