

100111/16/78

REVISIONS	STA 4+00 TO 7+00 - F.F. 2-49
BEVER	GRADE CHANGED FROM
SUPPLEMENTARY DETAILS	
C-327	C-566 C-739A
C-326A	C-585 C-739
C-325	C-524 C-733 C-938
C-324A	C-390 C-567 C-739B

NOTE:
BEFORE STARTING CONSTRUCTION CONTRACTOR MUST CHECK WITH UTILITIES FOR LOCATIONS OF EXISTING STRUCTURES WHETHER OR NOT INDICATED ON PLANS.

PLAN SCALE DISTORTED
LOTS & ALLEYS 1"=50'
STREET WIDTHS 1"=50'

DRAINAGE COMPLETED
PAVING COMPLETED **G.C. 8-13-49**

QUANTITIES	ESTIMATED	FINAL
LOTS	CITY	CITY
EXCAVATION CU YDS		
NEW CURB LIN FT		
PAVING SQ YDS		
SIDEWALK SQ FT		
MANHOLES ADJUST		
CONSTRUCT		
ADJUST		
CONSTRUCT		
SEWER 12" LIN FT		

HOR SCALE 1"=50'	BOOK 111	PAGE 10
VERT SCALE 1"=2'	DATE DRAWN 11-10-48	PROJECT PRIVATE
PLAN	E.H.	COMPUTED
PROFILE	E.H.	CHECKED
GRADE	G.H.S.	
CHANGED 6-1-5	LENGTH	435 -
LOT 2L	LENGTH	
TOTAL 2L	LENGTH	
SOFT ADJUSTING	LOT 2	CITY
COST INSPECTION	LOT 1	CITY

DESIGNED BY **SEXTON**
DRAWN BY **EUGENE HENRY**
CHECKED BY **SEXTON - Robert R. Sexton**
APPROVED BY **J. P. Sexton**
ENGINEER OF STREETS
Martin K. Gault
ASSISTANT ENGINEER

CONTRACT NO. **PRIVATE**

DEPARTMENT OF PUBLIC WORKS DETROIT
CITY ENGINEERS OFFICE - DIVISION OF PAVING DESIGN
STREET PAVING PLAN
SOUTH NORFOLK
INTSCTN. NPL. NORFOLK ✓
FROM **435'S EASTERLY OF INTSCTN. NPL. NORFOLK** ✓
TO **8' S B**
DATE OF EXAMIN. **8' S B**
INDEX TOPS NO 64 NO 67
RECORD NO. **325C-25** SHEET 1 OF 2 SHEETS
ASSIGN NO. **325C-25** SHEET NO. **2** OF **2** SHEETS
DATE OF EXAMIN. **8' S B**
DATE OF EXAMIN. **8' S B**
DATE OF EXAMIN. **8' S B**

REQUESTED BY **SCHAEFER DEVELOPMENT CORP 11-5-49**
B.L. SMOKLER & CO. - W.O. 5-4477
404 PENOBSCOTT BLDG.

NOTES

1. CONSTRUCT 2 STD. 18" x 24" FLAT TYPE BASINS & CONNECT TO EXISTING OUTLET AS SHOWN. SEE CITY OF DETROIT STD. DRAWG. #C-326A

2. SEE CITY OF DETROIT STD. DRAWG. C-739A FOR TYPE IX CURB.

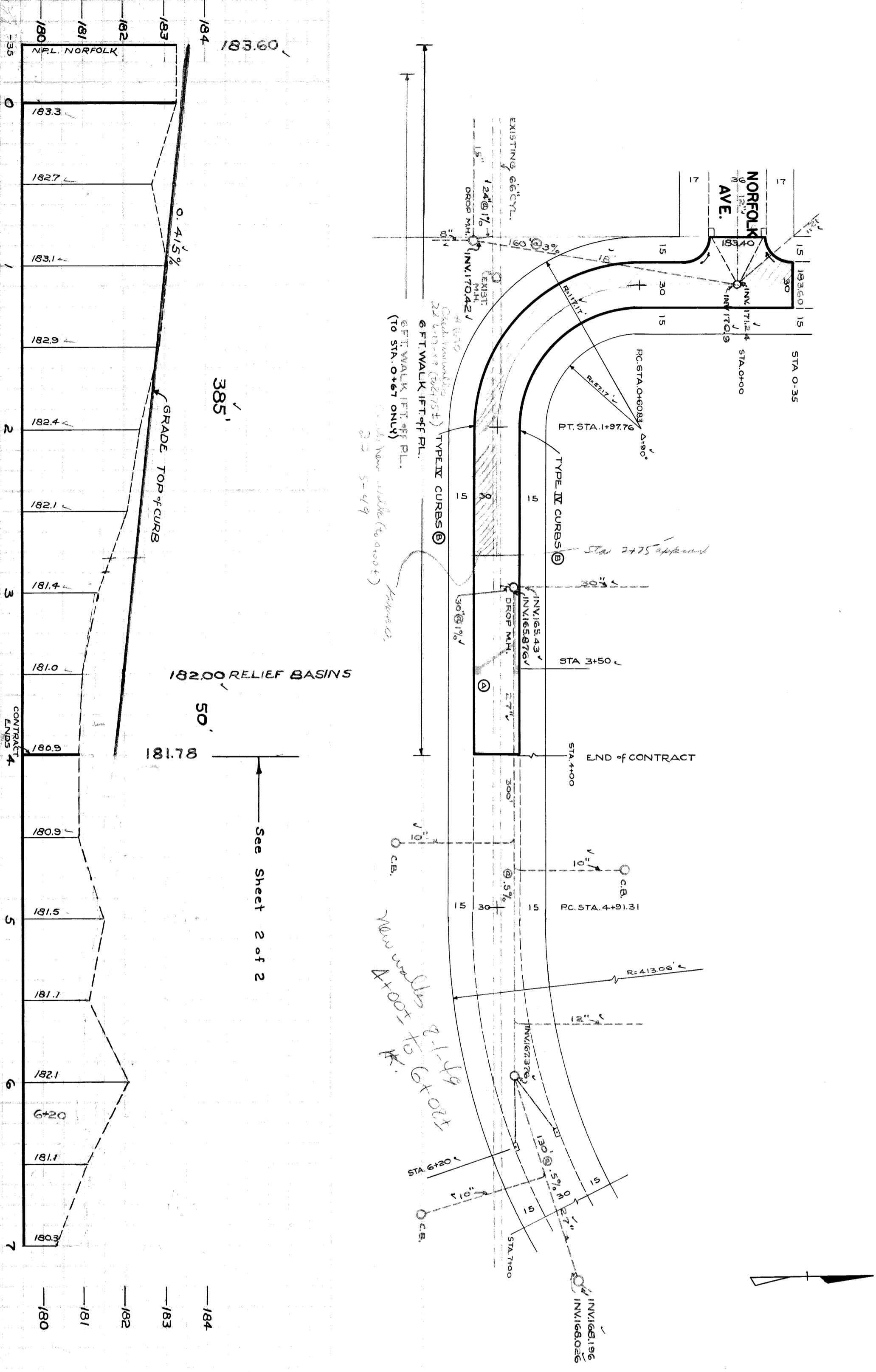

183.60
183.3
182.7
183.1
182.9
182.4
182.1
181.4
181.0
180.9
180.8
181.5
181.7
182.1
181.7
180.3

0 1 2 3 4 5 6 7

184
183
182
181
180

385'
50'

See Sheet 2 of 2

95433