

GROUP NO. 6613 CONTRACT NO. P.W. 4782F
STREET PAVING PLAN
CITY OF DETROIT
 DEPARTMENT OF PUBLIC WORKS-CITY ENGINEERS OFFICE

NAME OF STREET **SHIAWASSEE**
 FROM **NPL OF SEVEN MILE**
 TO **959' N OF NPL OF SEVEN MILE**

TYPE OF PAVEMENT **3.0 ONE COURSE CONCRETE-INTERNAL CURB** 36.30
 UNIFORM AT STREET INTERSECTION EXCEPT AS NOTED

PET. NO. BY **F.C.C.** DATE **3-2-57**

NOTE - FOR SYMBOLS © ETC., SEE STANDARD DETAIL DRAWING C-479
 BENCH MARKS
 P.L.B.M. # 123-255 N.E. COR. 7 MILE RD 148263
 AND TELEGRAPH
 C.B.M. - 5PK IN M.B.T. POLE, N.W. COR. 7 MILE RD 15322
 AND SHIAWASSEE
 C.B.M. - 1 HYD. W.S. OF SHIAWASSEE 15730
 STA 5+97
 C.B.M. - 1 HYD. W.S. OF SHIAWASSEE 15735
 STA 9+89
 P.L.B.M. # 123-355A N.E. COR. 7 MILE RD AND RIVERVIEW 148101

INDEX NO.	71
TOPO NO.	123
INDEXED	✓

MADE BY	CHECKED BY
PLAN	W.C. MOORE
PROFILE	W.C. MOORE
SEWER	W.C. MOORE
ESTIMATE	W.L.T.
FINAL CHECK	W.L.T.
APPROVED	
ENGINEER'S OFFICE	
J. Erickson	
M. J. Leffler	
Raymond H. Palmer	
CITY ENGINEER	

ASSIGNMENT NO.	225 DJ-13		
BOOK NO.	949 Pg. 68-72 DATE 9-3-64		
LEVEL			
DATE	9-3-64		
LOTS BL.	1918.00	LENGTH	959.00
CITY BL.		LENGTH	
TOTAL	1918.00	LENGTH	959.00
DATE OF DRAWG.	MARCH 15, 1966		
DRAINAGE COMPLETED	PAVING COMPLETED C.C. 3-21-67		

QUANTITIES	ESTIMATED	LOTS	CITY
PAVING	1723	497	3150
EXCAVATION			
CURB REMOVAL			
FILL			
ADJUST MANHOLES			
MANHOLES			
CATCH BASIN ADJUST			
CATCH BASIN BY STANDARD NEW			
12" SEWER PIPE			
PAVING	6.6	8.7	3150

CONTRACTOR MUST CHECK WITH UTILITIES FOR LOCATIONS OF EXISTING STRUCTURES WHETHER OR NOT INDICATED ON PLANS.

SCALE 1"=100'

DATE 5-23-66

REVISIONS

OLD PLAN 7-22-53

GAS LINES ADDED 7/27/66

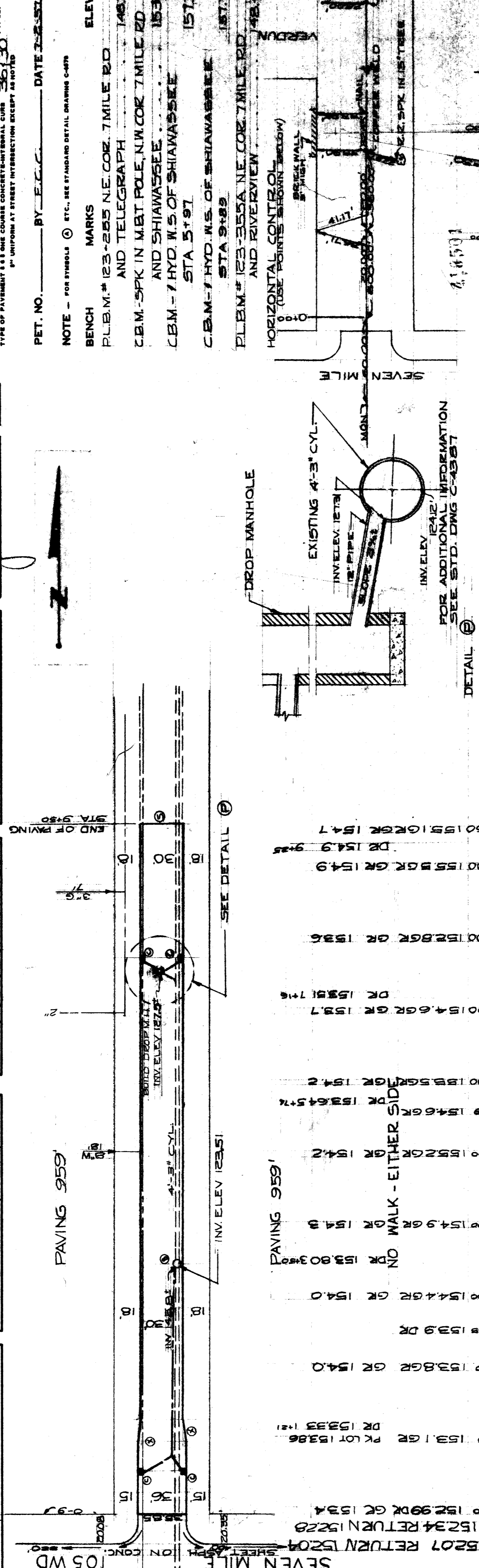

STATION	DESCRIPTION	AMOUNT	REMARKS
0+00	PAVING	153.1	GR PK LOT 15386 DR 15333 1-21
1+00	PAVING	153.8	GR 1540
2+00	PAVING	153.9	DR 1538 GR 1540
3+00	PAVING	154.0	GR 1540
4+00	PAVING	154.0	DR 1538 GR 1540
5+00	PAVING	154.2	GR 1542
6+00	PAVING	154.6	DR 1545 GR 1547
7+00	PAVING	154.7	DR 1547 GR 1547
8+00	PAVING	154.9	DR 1549 GR 1549
9+00	PAVING	155.0	GR 1550
10+00	PAVING	155.0	GR 1550

TREE REMOVAL SCHEDULE	STA	NUMBER	DIA.	LOCATION
1	154	105'	E OF C	
1	156	105'	E OF C	
1	157	105'	E OF C	