

DESIGNED BY *J. G. Kennedy*
 DRAWN BY *E. J. McArthur*
 TRACED BY *E. J. McArthur*
 CHECKED BY *J. G. Kennedy*
 APPROVED _____

BOOK 1455 PAGE 15
 DATE 5-23-40
 PLAN PROFILE EM
 CHECKED GRADE 1/6
 CHECKED 3/40

LENGTH 4 842.64
 CITY 449 98
 TOTAL 10 575.24
 LENGTH 5 287.62

INDEX TOPO NO. 38 95
 SHEET NO. 4

| QUANTITIES | LOTS | CITY | LOTS | CITY | PROGRESS | DATE | FINISH |
|-------------------|------|------|------|------|----------|------|--------|
| EXCAVATION | | | | | START | | |
| STRAIGHT CURB NEW | | | | | | | |
| OLD CURB RESET | | | | | | | |
| CIRCULAR CURB | | | | | | | |
| PAVING | | | | | | | |
| CONCRETE BASE | | | | | | | |

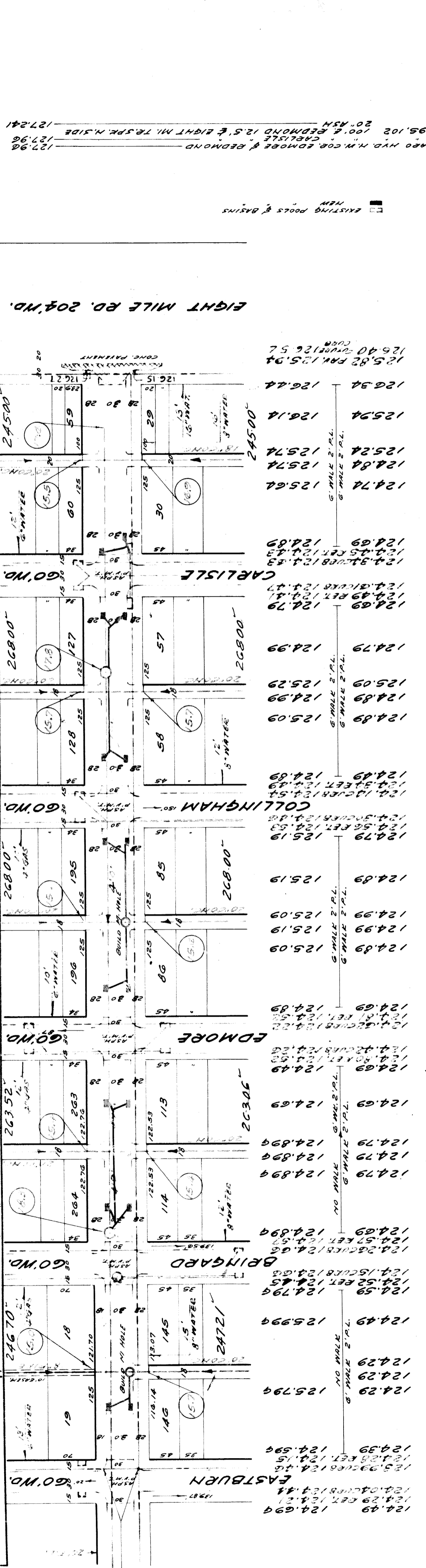

| STATION | PLAN | ELEVATION | STATION | PLAN | ELEVATION |
|---------|--------|-----------|---------|--------|-----------|
| 124.19 | 124.29 | 124.21 | 124.42 | 124.42 | 124.42 |
| 124.29 | 124.29 | 124.21 | 124.57 | 124.57 | 124.57 |
| 124.94 | 124.94 | 124.94 | 124.82 | 124.82 | 124.82 |
| 124.97 | 124.97 | 124.97 | 125.02 | 125.02 | 125.02 |
| 124.17 | 124.17 | 124.17 | 124.79 | 124.79 | 124.79 |
| 124.94 | 124.94 | 124.94 | 124.72 | 124.72 | 124.72 |
| 123.80 | 123.80 | 123.80 | 125.02 | 125.02 | 125.02 |
| 124.97 | 124.97 | 124.97 | 124.70 | 124.70 | 124.70 |
| 125.07 | 125.07 | 125.07 | 124.89 | 124.89 | 124.89 |
| 125.19 | 125.19 | 125.19 | 124.99 | 124.99 | 124.99 |
| 124.48 | 124.48 | 124.48 | 124.89 | 124.89 | 124.89 |
| 124.53 | 124.53 | 124.53 | 124.79 | 124.79 | 124.79 |
| 125.34 | 125.34 | 125.34 | 124.89 | 124.89 | 124.89 |
| 124.80 | 124.80 | 124.80 | 124.99 | 124.99 | 124.99 |
| 124.60 | 124.60 | 124.60 | 124.89 | 124.89 | 124.89 |
| 124.20 | 124.20 | 124.20 | 124.79 | 124.79 | 124.79 |
| 124.69 | 124.69 | 124.69 | 124.89 | 124.89 | 124.89 |
| 124.74 | 124.74 | 124.74 | 124.99 | 124.99 | 124.99 |
| 124.63 | 124.63 | 124.63 | 124.89 | 124.89 | 124.89 |
| 124.62 | 124.62 | 124.62 | 124.79 | 124.79 | 124.79 |
| 124.52 | 124.52 | 124.52 | 124.89 | 124.89 | 124.89 |
| 125.12 | 125.12 | 125.12 | 124.99 | 124.99 | 124.99 |
| 124.30 | 124.30 | 124.30 | 124.89 | 124.89 | 124.89 |
| 124.42 | 124.42 | 124.42 | 124.79 | 124.79 | 124.79 |
| 124.42 | 124.42 | 124.42 | 124.89 | 124.89 | 124.89 |
| 124.57 | 124.57 | 124.57 | 124.99 | 124.99 | 124.99 |
| 124.57 | 124.57 | 124.57 | 124.89 | 124.89 | 124.89 |
| 124.57 | 124.57 | 124.57 | 124.79 | 124.79 | 124.79 |
| 124.82 | 124.82 | 124.82 | 124.89 | 124.89 | 124.89 |
| 125.29 | 125.29 | 125.29 | 124.99 | 124.99 | 124.99 |
| 125.94 | 125.94 | 125.94 | 124.89 | 124.89 | 124.89 |
| 125.97 | 125.97 | 125.97 | 124.79 | 124.79 | 124.79 |

NOTE
 RESET CIRCLES FOR 90' RETURN AT INTERSECTION OF REDMOND & EASTBURN, BRINGARD, EDMORE, COLLINGHAM & CARLISLE.

EXISTING POOLS & BASINS
 NEW