

DATE	REVISIONS
	OLD MAP DATE 2-24-49

BEFORE STARTING CONSTRUCTION
CONTRACTOR MUST CHECK WITH UTILITIES FOR LOCATIONS
OF EXISTING STRUCTURES WHETHER OR NOT INDICATED ON
PLANS.

SCALE

LOTS & ALLEYS 1" = 60' ✓
STREET WIDTH 1" = 60' ✓
VERTICAL 1" = 2' ✓
DRAINAGE COMPLETED 7-18-49 ✓
PAVING COMPLETED 6-17-58

QUANTITIES		ESTIMATED	
CU. YDS.	LOTS	CITY	GITE
EXCAVATION	1058	170	
CONCRETE DRIVEWAYS	100		
PAVING 8" G.I. B.	3006	9	
8" UNIF.		344	
TEST CORES		4	
SIDEWALK	SQ. FT.	648	
MANHOLES	ADJUST	4-5	
CONCRETE	ADJUST	1	
CONSTRUCT	CONSTRUCT	2	
SEWER BASINS	CONSTRUCT	5	
SEWER-12"	LN. FT.	170	

PETITION NO.	2811	PETITION DATE	7-20-54
ASSIGNMENT NO.	325CH-7	GROUP NO.	
BOOK NO.	1773	LEVEL	16.44
DATE OF DRAW'G.	12-29-55	LENGTH	873.10
CITY ZL	174620	LENGTH	82.75
TOTAL	1911.70	LENGTH	955.85

MADE BY	J. KING	CHECKED BY	W.D. MORRIS
PROFILE	J. KING	ESTIMATE	W.D. MORRIS
GRADE	W.D. MORRIS	SEWER APPROVED	W.D. MORRIS
ESTIMATE	W.D. MORRIS	FINAL CHECK	W.D. MORRIS
SEWER APPROVED	W.D. MORRIS	APPROVED	W.D. MORRIS
ENGINEER OF STREETS		CITY ENGINEER	

INDEX NO.	72
TORO NO.	115
INDEXED	

CONTRACT NO. P.W. _____
STREET PAVING PLAN
CITY OF DETROIT
DEPARTMENT OF PUBLIC WORKS - CITY ENGINEERS OFFICE

NAME OF STREET PEMBROKE
FROM E.P.L. OF STOUT SOUTH SIDE ✓
TO E.P.L. OF HEYDEN SOUTH SIDE ✓

TYPE OF PAYMENT 8 & 8 ONE COURSE CONCRETE-INTERGRAL CURB
8" UNIFORM AT STREET INTERSECTION EXCEPT AS NOTED

BENCH MARKS

ELEV. 30'-11"
SHEET 1 OF 2 SHEETS

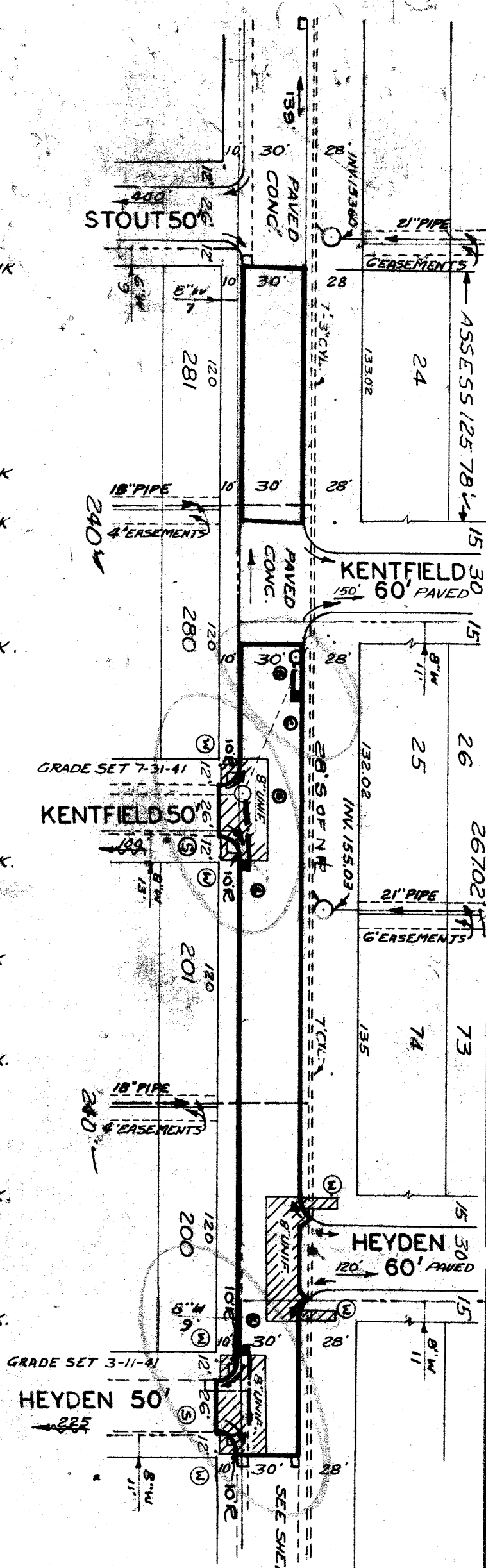

163.15 GUT	163.08 WK
162.96 GUT.	163.97 WK
163.93 WK	
6" WALKS BOTH SIDES 1' OFF R	
164.21 WK	164.26 WK
163.64 GUT	164.34 WK
GUT	163.66 WK
163.78 GUT	163.92 WK
164.51 WK	163.97 WK
GUT	164.26 WK
163.78 GUT	164.34 WK
164.51 WK	163.66 WK
164.70 WK	
164.73 WK	164.99 WK.
145-165.09 WK	
165.14 GAR	165.16 WK
165.57 WK	165.92 WK.
165.03 WK	165.78 WK.
GUT.	165.01
GUT.	164.90
GUT	164.62
GUT	164.28
164.35 WK.	165.44 WK.
164.18 WK.	
164.08 WK	

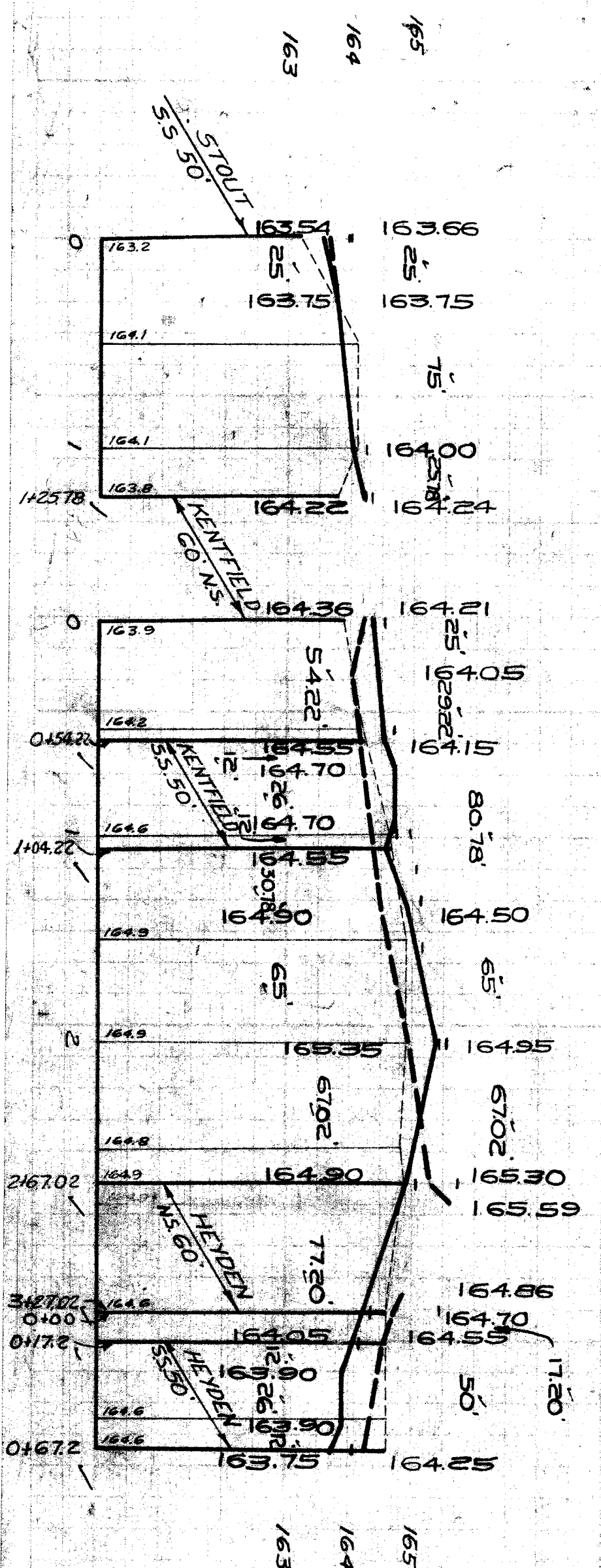

NOTE: FOR SYMBOLS (A) ETC. SEE STD DETAIL DRWG C-327
HORIZONTAL CONTROL BY EXISTING RETURNS

PL B.M. #15-2554 NE COR. BRAILLE & SEVEN MI. ROAD
B.M. TOP HYD. S.E. COR. HEYDEN & PEMBROKE
PL B.M. #15-256 NE COR. EVERGREEN & SEVEN MI. ROAD.

159,069 REC.
166,895
160,889 REC.

CITY OF DETROIT
SEWER DIVISION
NOV 19 58 AM