

DEPARTMENT OF PUBLIC WORKS DETROIT
CITY ENGINEER'S OFFICE --- DIVISION OF PAVING DESIGN
STREET PAVING PLAN

NAME OF STREET: **PATTON AVE.**
 FROM: **N.P.L. OF JOY ROAD**
 TO: **N.P.L. OF CATHEDRAL AVE.**

TYPE OF PAVEMENT: **CONCRETE**
 WIDTH: **30 & 36**

DESIGNED BY: *F. Minikel*
 DRAWN BY: *F. Minikel*
 TRACED BY: *R. R. R.*
 CHECKED BY: *R. R. R.*
 APPROVED: *[Signature]*
 CITY ENGINEER

BOOK: **1495** PAGE: **46**
 DATE: **5-18-42**
 PLAN: **F.M.** PROFILE: **F.M.** GRADE: **H.J.S.** CHECKED: **R3**
 CHECKED: **H.J.S.** GRADE: **H.J.S.** CHECKED: **R3**
 TOTAL LENGTH: **1,138.00**
 CITY: **DETROIT**

QUANTITIES	LOTS	CITY
EXCAVATION		
STRAIGHT CURB NEW		
OLD CURB RESET		
CIRCULAR CURB		
PAVING		
CONCRETE BASE		

PROGRESS	START	FINISH
EXCAVATION		
STRAIGHT CURB NEW		
OLD CURB RESET		
CIRCULAR CURB		
PAVING		
CONCRETE BASE		

INDEXED	REVISIONS

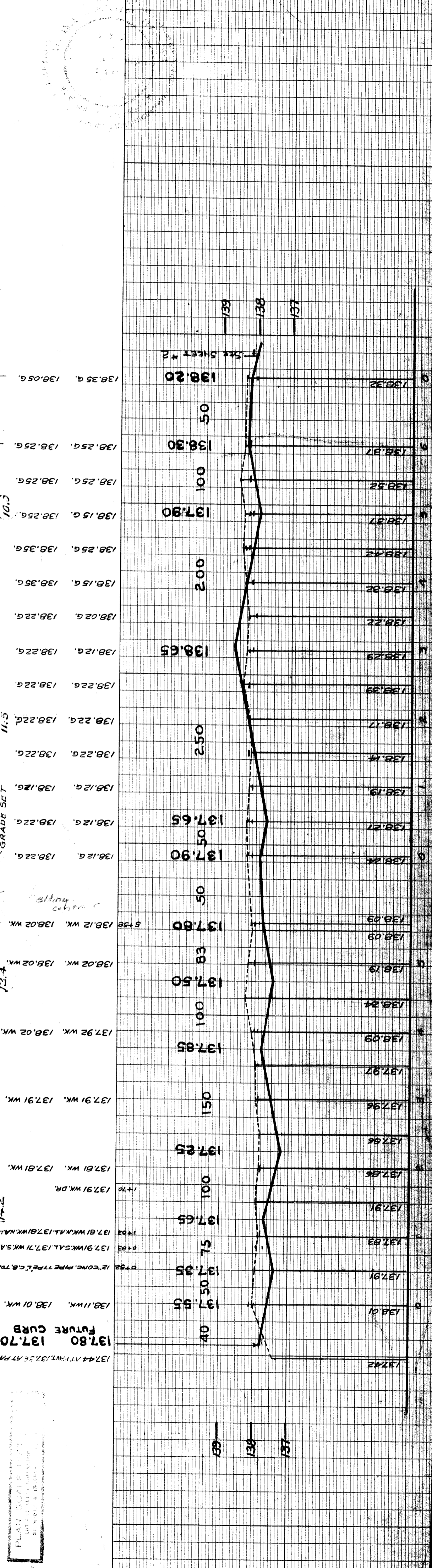
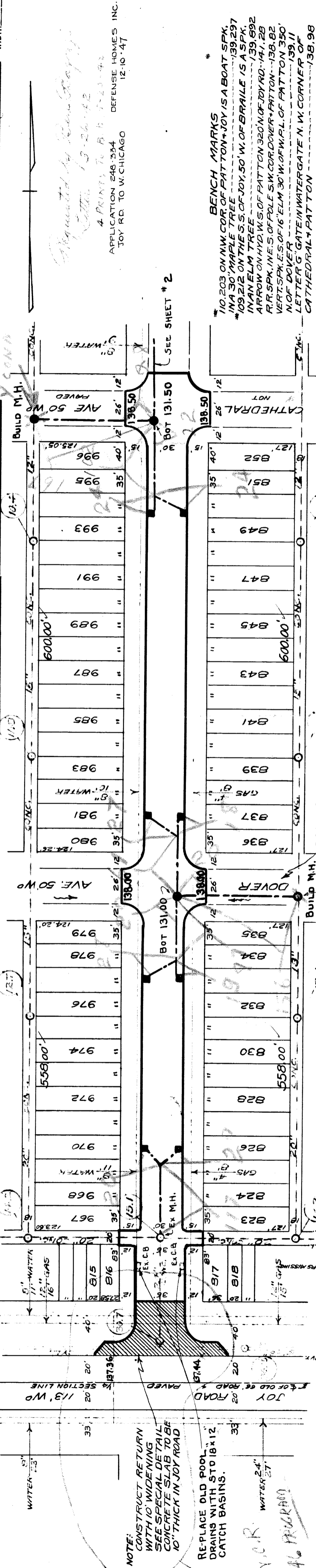

1123 12/10/42
 IMPERIAL TRACING CLOTH
 K & E CO., N.Y.

1123 12/10/42
 IMPERIAL TRACING CLOTH
 K & E CO., N.Y.

1123 12/10/42
 IMPERIAL TRACING CLOTH
 K & E CO., N.Y.

1123 12/10/42
 IMPERIAL TRACING CLOTH
 K & E CO., N.Y.

1123 12/10/42
 IMPERIAL TRACING CLOTH
 K & E CO., N.Y.

1123 12/10/42
 IMPERIAL TRACING CLOTH
 K & E CO., N.Y.

1123 12/10/42
 IMPERIAL TRACING CLOTH
 K & E CO., N.Y.

1123 12/10/42
 IMPERIAL TRACING CLOTH
 K & E CO., N.Y.