

DEPARTMENT OF PUBLIC WORKS DETROIT  
 CITY ENGINEERS' OFFICE ... DIVISION OF PAVING DESIGN  
**STREET PAVING PLAN**  
**ORANGELAWN**

CARD NO. 49-14  
 INDEX TOPO NO. 77  
 RECORD NO. 110  
 NAME OF STREET: 23 W. OF E.P.L. BURT ROAD  
 TO: W.P.L. PIERSON  
 ASSIGN NO. 325 U-1  
 PETITION NO. 5340  
 SHEET 1 OF 5 SHEETS  
 WIDTH 30'

LITTLE EXAMINER 8 6 8  
 ONE COURSE CONCRETE INTEGRAL CURB  
 8" UNIFORM AT STREET INTERSECTIONS EXCEPT AS NOTED

CONTRACT APPROVED - C.C.  
 PET # 5340 - IRVING LUVISCH-412-49 - BURT ROAD TO FIELDING 25% PD.  
 BENCH MARKS  
 B.M. # 110-252 SE. COR. TRINITY & W. CHICAGO (REG. 139,853) 139.85  
 B.M. ARROW ON HYD. NE. COR. ORANGELAWN & BURT ROAD 142.32  
 B.M. ARROW ON HYD. OPP. HOUSE # 9575 PIERSON 142.43  
 P.B.M. # 110-252-A SE. COR. BURT ROAD & W. CHICAGO (REG. 139,569) 139.56

DESIGNED BY: *W. P. L.*  
 DRAWN BY: *W. P. L.*  
 TRACED BY:  
 CHECKED BY:  
 APPROVED: *W. P. L.*  
 ENGINEER OF STREETS  
 ASSIST. CITY ENGINEER

HOR. SCALE 1"=50'	BOOK 1595	PAGE 76
VER. SCALE 1"=2'	LEVELS 4-15-49	DATE DRAWING
PLAN	PROFILE	COMPUTED
CHECKED F.F.	GRADE	CHECKED P.A.
LOT 2L 218358	LENGTH 1	09179
CITY 2L 4600	LENGTH 1	2300
TOTAL 2L 222958	LENGTH 1	11479
CITY	LENGTH	CITY

QUANTITIES	ESTIMATED	FINAL
EXCAVATION CU. YDS.	LOTS	LOTS
NEW CURB LIN. FT.	CITY	CITY
PAVING SQ. YDS.		
MANHOLES ADJUST		
CONSTRUCT		
ADJUST		
CONSTRUCT		
SEWER 12" LIN. FT.		

NOTE: BEFORE STARTING CONSTRUCTION CONTRACTOR MUST CHECK WITH UTILITIES FOR LOCATIONS OF EXISTING STRUCTURES WHETHER OR NOT INDICATED ON PLANS.  
 PLAN SCALE DISTORTED  
 LOTS & ALLEYS 1"=50'  
 STREET WIDTHS 1"=50'  
 DRAINAGE COMPLETED  
 PAVING COMPLETED

SEWER	C-324A	C-390	C-587	C-739B
REVISIONS	C-325	C-524	C-733	C-938
	C-326A	C-585	C-739	
	C-327	C-586	C-739A	

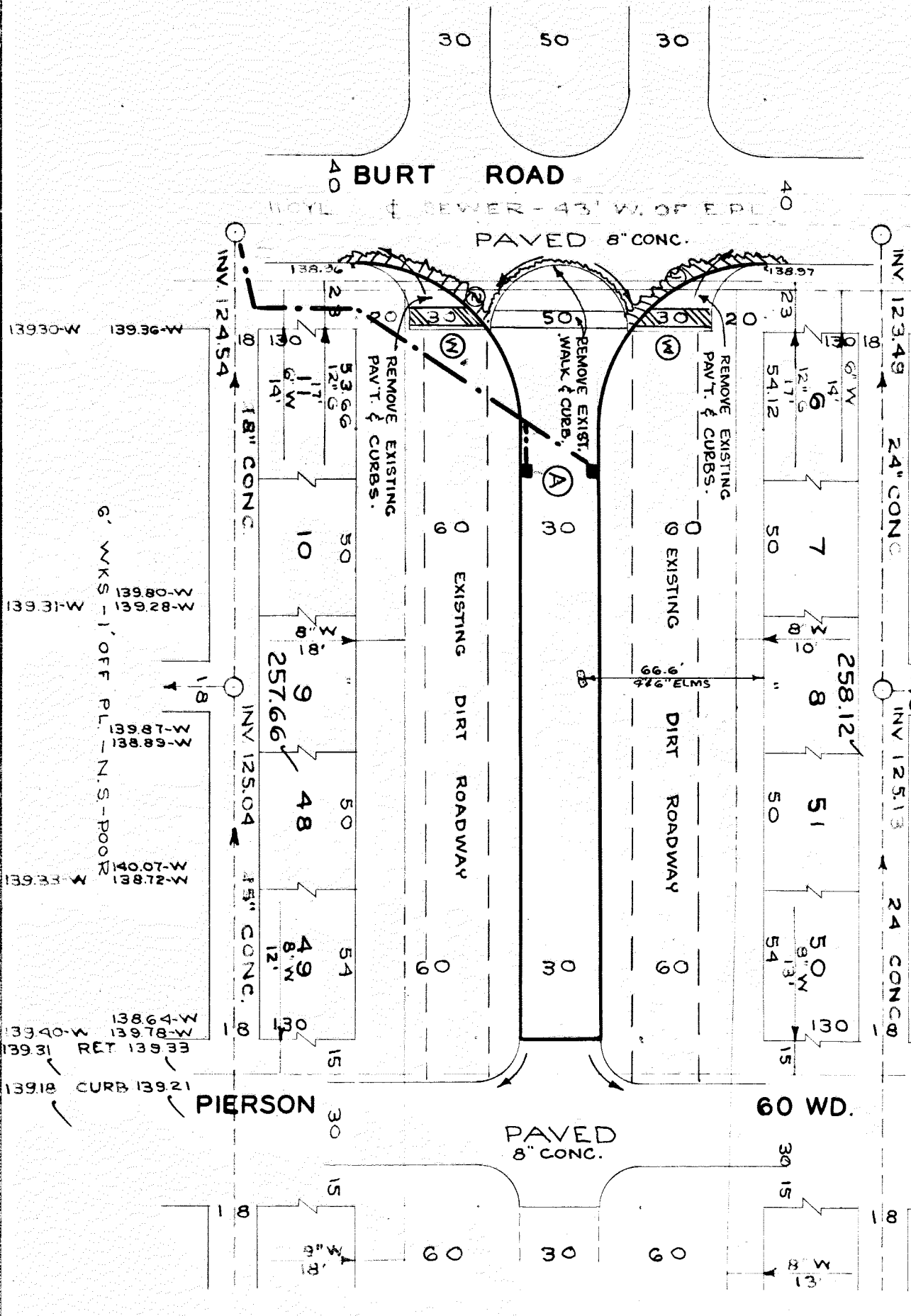

①  
 R = 60'  
 Δ = 90°  
 T = 60'  
 A = 94.25'  
 S = 772.570'

②  
 R = 60'  
 Δ = 90°  
 T = 60'  
 A = 94.25'  
 S = 772.570'

**NOTES**

- AT (W) CONSTRUCT 360 SQ. FT. OF STANDARD 4" CONCRETE WALK.
- AT (A) CONSTRUCT 2 STD. 18x12Y FLAT TYPE BASINS COMPLETE AND CONNECT TO EXISTING OUTLETS AS SHOWN.
- BACKFILL SEWER PIPE TRENCHES UNDER PROPOSED PAVEMENT WITH APPROVED SAND GRAVEL MATERIAL, ELSEWHERE FILL & TAMP WITH APPROVED EARTH LAYERS AS REQUIRED.
- CONTRACTOR TO GRUB & REMOVE 2-4" to 12" TREES AS INDICATED ON PLAN AT UNIT COST PER TREE ADJUST TOPS OF 2 WATER MANHOLES.
- CONTRACTOR SHALL FURNISH ALL NECESSARY MATERIALS INCLUDING CASTINGS AND SHALL HAUL ALL SALVAGEABLE MATERIALS TO D.P.W. YARD AT STATE FAIR AND JOHN R.
- CONTRACTOR SHALL STRIP APPROXIMATELY 6" OF EXISTING DIRT ROADWAYS ON BOTH SIDES OF STREET AND HARD SURFACE. REPLACE WITH TOPSOIL EXCAVATED FROM PROPOSED PAVEMENT AREA.
- CONTRACTOR SHALL REMOVE ALL CURBING AND WALKS INSIDE OF PROPOSED NEW PAVING AREA.
- CONTRACTOR SHALL REMOVE ALL EXISTING CURBS AND EXISTING PAVEMENT LOCATED OUTSIDE OF THE PROPOSED NEW PAVING AREA AND FOR A DISTANCE OF APPROXIMATELY 12" INSIDE OF THE FACE OF THE PROPOSED NEW CURB. CONSTRUCT TYPE III CURB. SEE DETAIL SKETCH BELOW.

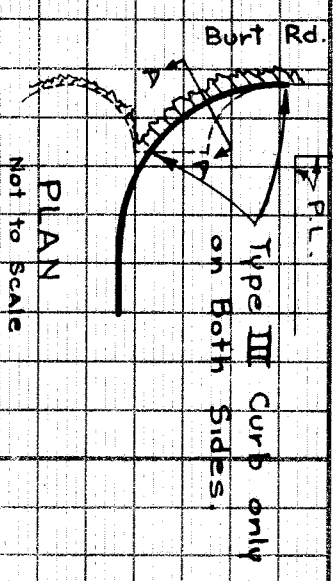

PLAN  
 Not to Scale  
 Remove Existing Concrete Pavement and Replace to meet Proposed Grades.  
 Existing Concrete Pavement

