

838762348

1946 Sp. Sewer

SEWER	2" 12" 15"
REVISIONS	
NOTE:	BEFORE STARTING CONSTRUCTION CONTRACTOR MUST CHECK WITH UTILITIES FOR LOCATIONS OF EXISTING STRUCTURES WHETHER OR NOT INDICATED ON PLANS.
PLAN SCALE DISTORTED	LOTS & ALLEYS 1"=100'
STREET WIDTHS	1"=50'
DRAINAGE COMPLETED	
PAVING COMPLETED	

QUANTITIES	ESTIMATED	FINAL
EXCAVATION CU. YDS.	3,069	27
NEW CURB LIN. FT.	4,281	37
PAVING SQ. YDS.	6,297	80
SIDEWALK SQ. FT.	8	1
MANHOLES CONSTRUCT	1	1
BASINS CONSTRUCT	10	1
SEWER-12" LIN. FT.	230	1
SEWER-15" LIN. FT.		

VER. SCALE 1"=2'	DATE 1-23-05	ROOM 589	PAGE 33
PLAN CHECKED LJK	PROFILE CHECKED LJK	COMPUTED CHECKED LJK	P.M. REK
CITY 2L	LENGTH 200	LENGTH 140	LENGTH 140
TOTAL 2L	LENGTH 200	LENGTH 140	LENGTH 140
CITY 2L	LENGTH 200	LENGTH 140	LENGTH 140
CITY 2L	LENGTH 200	LENGTH 140	LENGTH 140

DESIGNED BY	LJK.
DRAWN BY	H.K. EBERT
TRACED BY	
CHECKED BY	LJK.
APPROVED	<i>W. C. ...</i>
ENGINEER OF STREETS	
ASST. CITY ENGINEER	

DESIGNED BY	LJK.
DRAWN BY	H.K. EBERT
TRACED BY	
CHECKED BY	LJK.
APPROVED	<i>W. C. ...</i>
ENGINEER OF STREETS	
ASST. CITY ENGINEER	

DEPARTMENT OF PUBLIC WORKS DETROIT
 CITY ENGINEERS OFFICE - DIVISION OF PAVING DESIGN
 STREET PAVING PLAN APP-111
 NORTHROP
 N.P.L. SEVEN MILE RD.
 FROM 2140' N.P.L. SEVEN MILE RD.
 TO 2140' N.P.L. SEVEN MILE RD.
 TYPE OF PAVEMENT
 WIDTH 26' & 30'

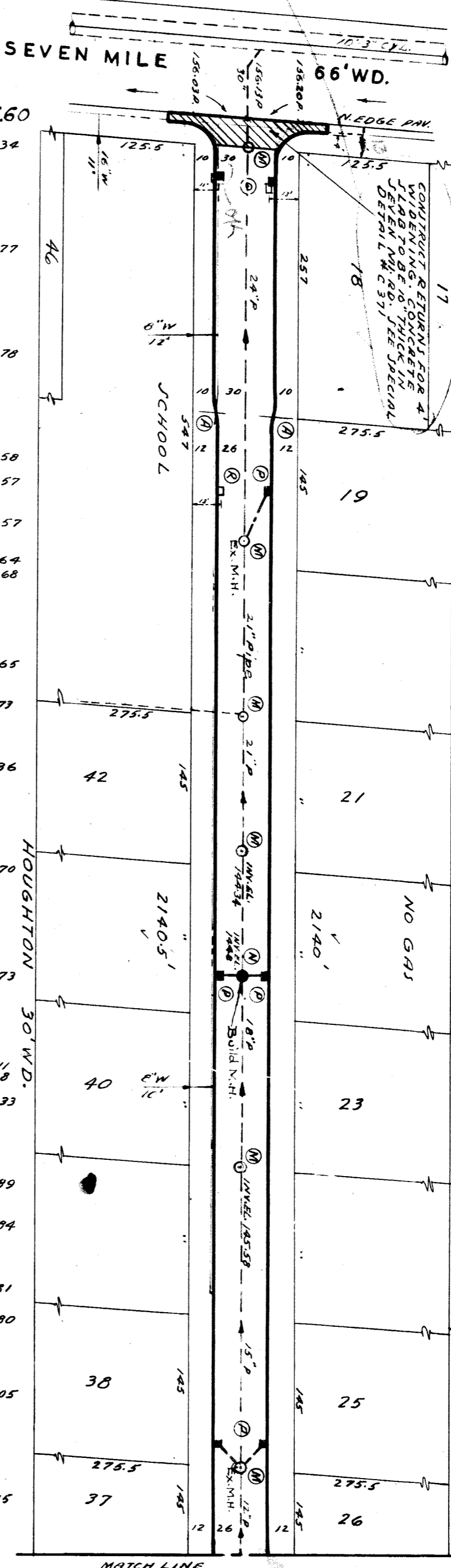

156.34	156.34	156.77	156.78	156.58	156.64	156.65	156.36	155.70	154.73	155.89	155.81	155.80	156.05	156.15
				DR. 156.57	DR. 156.68					DR. 155.11	DR. 155.33		DR. 156.05	DR. 156.15

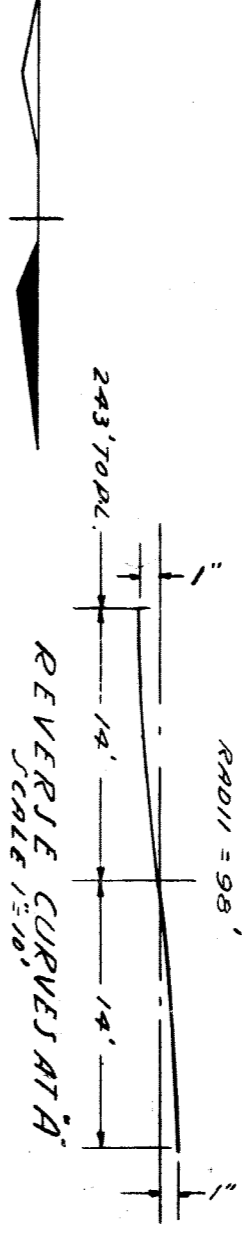
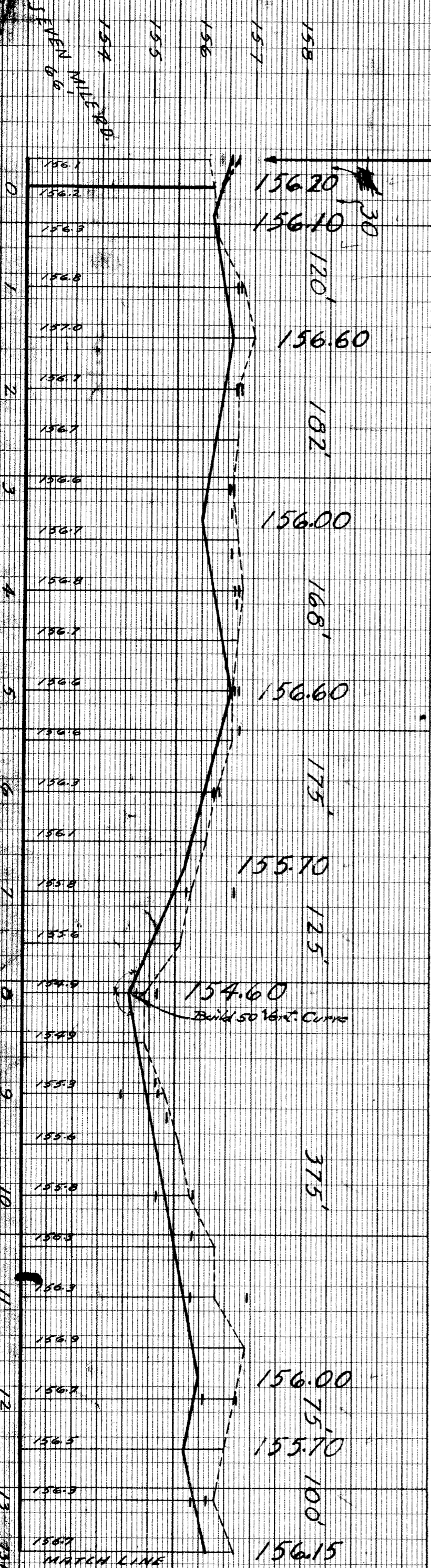

BENCH MARKS ELEV.
 P.L.B.M. 123-2568 BRASS CAP ON MONUMENT IN HANDHOLE IN SIDEWALK N.E. CORNER REDESKIN & SEVEN MILE RD. 151.40
 N.E. CORNER HYDRANT N.E. CORNER SEVEN MILE RD. & NORTHROP 159.18
 HYDRANT IN FRONT OF SCHOOL ON NORTHROP 159.61
 P.L.B.M. 123-2578 BRASS CAP ON MONUMENT IN HANDHOLE IN SIDEWALK S.E. CORNER REDESKIN & PEMBORKE 158.13

NOTE
 AT (M) ADJUST TOP OF EXIST. M.H.'S
 AT (N) CONSTRUCT 1 STD. MANHOLE COMPLETE
 AT (O) REMOVE 2 EX. 12" LI. & REPLACE WITH 2 STD. 18" 12" 1/2" CATCH BASINS & CONNECT TO EXIST. OUTLETS
 AT (P) CONSTRUCT 9 STD. 18" 12" 1/2" CATCH BASINS COMPLETE & CONNECT AS SHOWN
 AT (Q) ADJUST TOP OF EXIST. SUMM M.H. BASIN
 CONTRACTOR SHALL FURNISH & INSTALL STD. FLATTYPE CATCH BASIN FRAMES & GRATES NOTIFY D.P.W. TO SALVAGE OLD GRATES

