

DEPARTMENT OF PUBLIC WORKS DETROIT
CITY ENGINEER'S OFFICE DIVISION OF PAVING DESIGN
STREET PAVING PLAN

NAME OF STREET: **MAPLE**
FROM: **E.P.L. RIOPELLE (SOUTH SIDE)**
TO: **W.P.L. ORLEANS (S. SIDE)**

INDEX TO P.O. NO. **238**
RECORD NO. **27**

ASSIGN NO. **40-220**
PETITION NO. **17**

M.L. OF PAVEMENT: **8:6:8**
MATERIAL SPECIFIED: **ONE COURSE CONCRETE**

GRATIOT REDEVELOPMENT PROJECT

BENCH MARKS

WATER TABLE S.E. COR. CAPRON SCHOOL N.W. COR. RIOPELLE & MAPLE ARE ON HYD. N.E. COR. MAPLE & ORLEANS

- LEGEND:
- PROF. & LOT LINES
 - EXISTING PAVT.
 - PAVT. OR CURB TO BE REMOVED
 - PAVT. OR CURB PROF. ON ANOTHER SHEET
 - PROF. PAVT.

NOTE: For symbols (A) etc., see std. drawing C-327

Ed J. W. [Signature]

DESIGNED BY: **Erickson**
DRAWN BY: **R. Deel**
TRACED BY:
CHECKED BY: **B. M. M.**
APPROVED: **[Signature]**
ENGINEER OF STREETS

BOOK 1729 PAGE 53
DATE DRAWING 8-52
C.M.C. COMPUTED M.L.
CHECKED J.E.
CITY 36199

QUANTITIES	ESTIMATED	FINAL
EXCAVATION CU. YDS.		
NEW CURB LIN. FT.		
PAVING SQ. YDS.		
SIDEWALK SQ. FT.		
MANHOLES ADJUST. CONSTRUCT.		
BASINS ADJUST. CONSTRUCT.		
SEWERS 12" LIN. FT.		

NOTE: BEFORE STARTING CONSTRUCTION CONTRACTOR MUST CHECK WITH UTILITIES FOR LOCATIONS OF EXISTING STRUCTURES WHETHER OR NOT INDICATED ON PLANS.

PLAN SCALE DISTORTED
LOTS & ALLEYS: 1"=40'
STREET WIDTHS: 1"=40'

DRAINAGE COMPLETED
PAVING COMPLETED

REVISIONS	DATE	BY	REASON
C-1008			
C-739A			
C-586			
C-585			
C-733			
C-587			
C-739B			

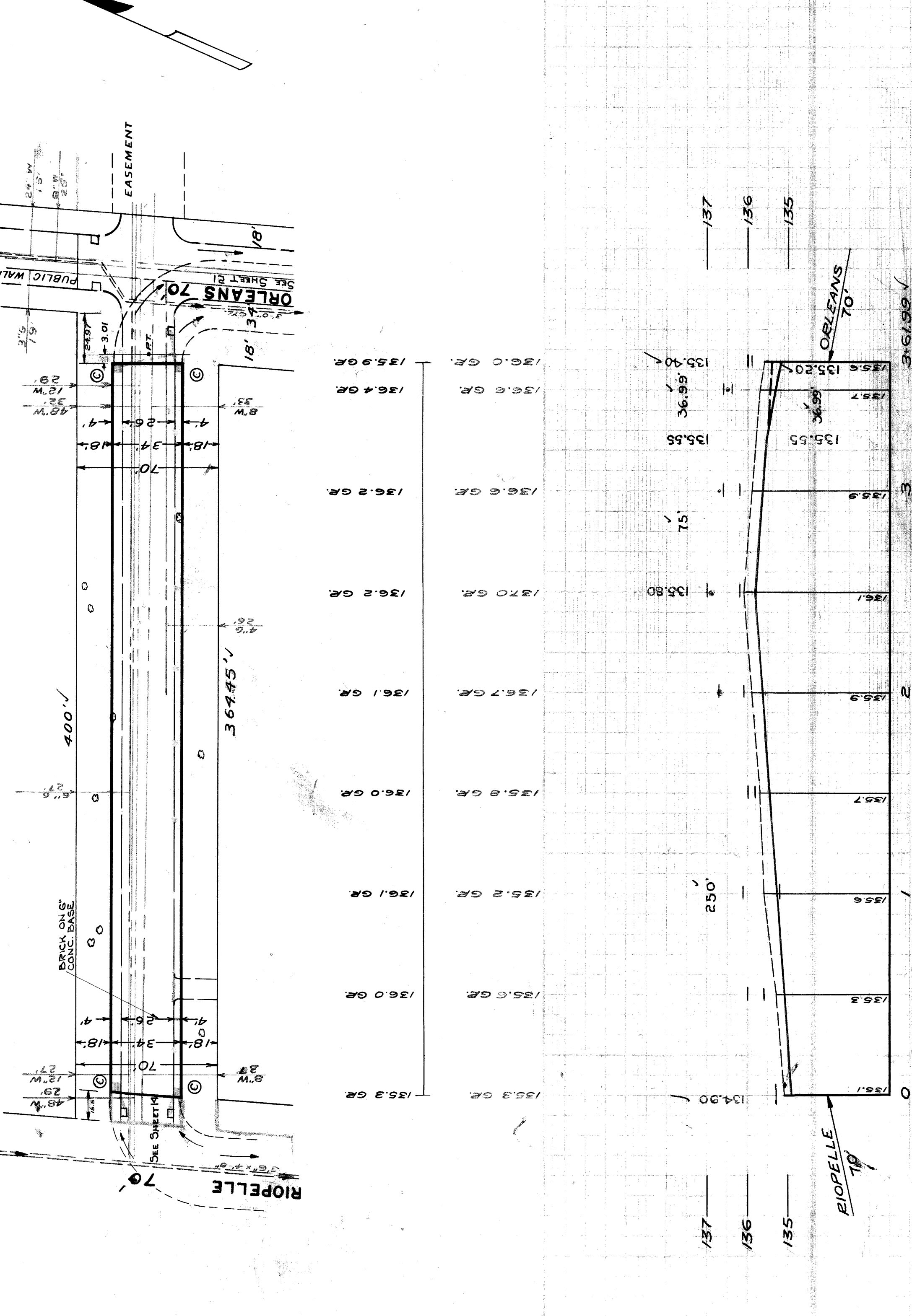

STATION	ELEVATION	GR.
0	135.1	
1	135.6	135.2 GR.
2	135.9	136.7 GR.
3	135.9	136.2 GR.
4	136.1	137.0 GR.
5	135.80	136.2 GR.
6	135.55	136.0 GR.
7	135.55	136.4 GR.
8	135.20	136.0 GR.
9	135.20	135.9 GR.