

DEPARTMENT OF PUBLIC WORKS DETROIT
CITY ENGINEER'S OFFICE -- DIVISION OF PAVING DESIGN
STREET PAVING PLAN

NAME OF STREET: **LYNDON**
FROM: **138.54' W. OF W.P.L. OF BRAMELL**
TO: **ERL. OF LAMPHERE**

DESIGNED BY: *C.M. Cwik*
DRAWN BY: *C.M. Cwik*
TRACED BY: *Scotton*
CHECKED BY: *Scotton*
APPROVED: *Errol D. Brown*
CITY ENGINEER

BOOK	7744	PAGE	12
LEVELS	5-51	CHECKED	DB
DATE DRAWING	7-10-31	CHECKED	JE
PLAN	C.M.C.	COMPUTED	DB
CHECKED	AB	GRADE	AB
LC'S	145774	LENGTH	728.87
CITY	35900	LENGTH	179.50
TOTAL	181674	PERCENT	908.37

QUANTITIES	ESTIMATED	FINAL	CITY
EXCAVATION CU. YDS.	1721	733	
NEW CURB LIN. FT.	3350	161	
PAVING 10'-8" TO 10'-0" YDS.	1190	100	
6" CON. DR. SQ. FT.	2058	33	
10' UNIF. SIDEWALK 4" 5.0 BT.	1	10	
MANHOLES ADJUST CONC.	390	10	
RE CONSTRUCT ADJUST			
BASES			
SEWERS 12" LIN. FT.			

NOTE: BEFORE STARTING CONSTRUCTION CONTRACTOR MUST CHECK WITH UTILITIES FOR LOCATIONS OF EXISTING STRUCTURES WHETHER OR NOT INDICATED ON PLANS.

PLAN SCALE DISTORTED
LOTS & ALLEYS 1"=100'
STREET WIDTHS 1"=50'

DRAINAGE COMPLETED
PAVING COMPLETED C.C. 1-15-52

C-324A	C-390	C-567	C-739B
C-325	C-524	C-733	C-938
C-326A	C-585	C-739	C-160B
C-327	C-586	C-739A	

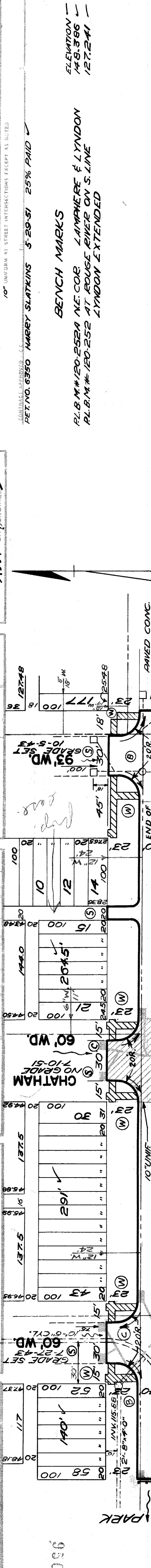

NOTE: THIS STREET IS A SECONDARY HIGHWAY CITY ASSESSORS SHOULD REDISTRIBUTE THE ASSESSED COST ACCORDING TO BENEFITS DERIVED FOR A 30' RESIDENTIAL STREET.

NOTE: INSPECTION DEPT TO NOTIFY TRAFFIC ENGINEER WHEN THE BARRICADE IS READY FOR SIGN INSTALLATION.

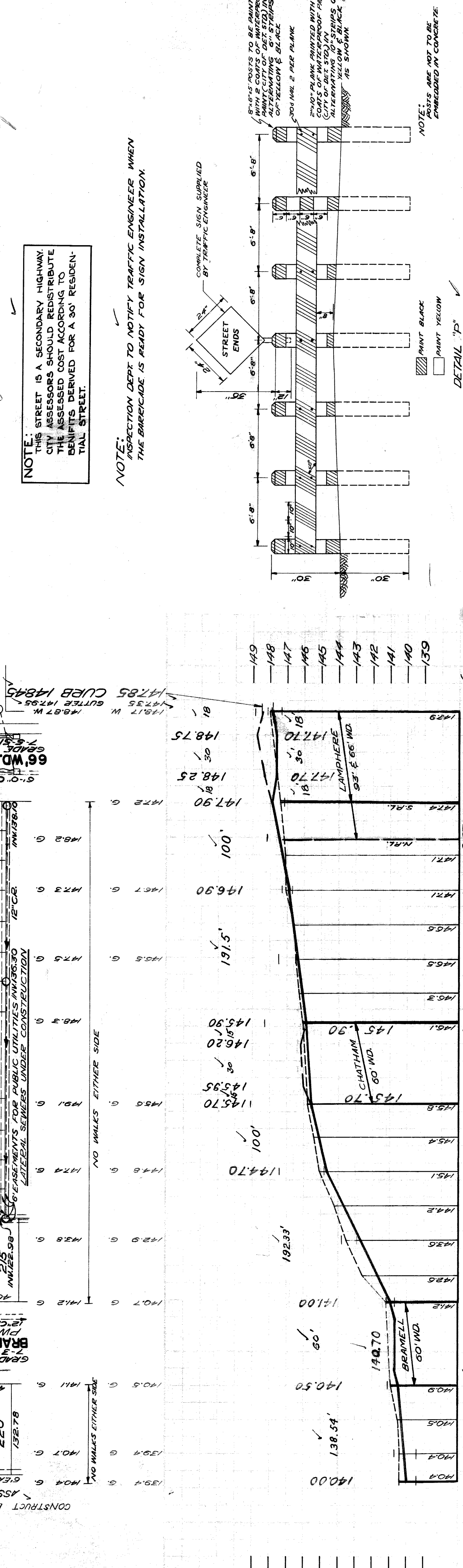
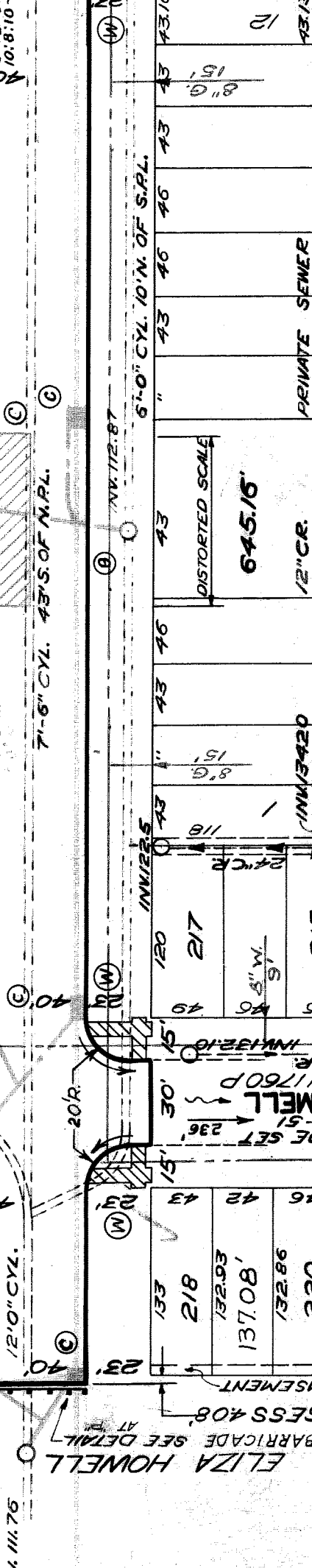
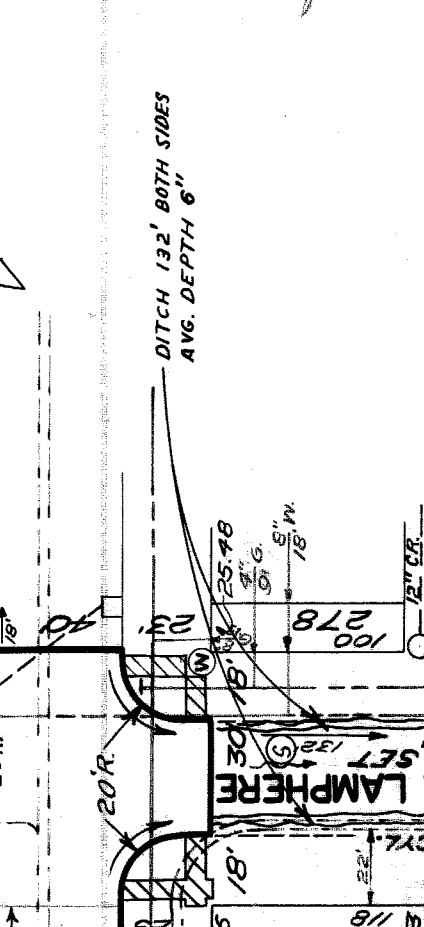

NOTE: THIS STREET IS A SECONDARY HIGHWAY CITY ASSESSORS SHOULD REDISTRIBUTE THE ASSESSED COST ACCORDING TO BENEFITS DERIVED FOR A 30' RESIDENTIAL STREET.

NOTE: INSPECTION DEPT TO NOTIFY TRAFFIC ENGINEER WHEN THE BARRICADE IS READY FOR SIGN INSTALLATION.

NOTE: 8"x6" POSTS TO BE PAINTED WITH 2 COATS OF WATERPROOF PAINT ALTERNATING 10" STRIPS OF YELLOW & BLACK. 300# NAIL 2 PER PLANK. 2"x10" PLANK PAINTED WITH 2 COATS OF WATERPROOF PAINT (CITY OF DET. STD.) IN ALTERNATING 10" STRIPS OF YELLOW & BLACK AS SHOWN.

NOTE: REINFORCING BARS ARE NOT TO BE EMBEDDED IN CONCRETE.

PAINT BLACK
PAINT YELLOW

DETAIL "P" SCALE DISTORTED

REVISIONS: *OK J. J. J. 8/15/51*
OLD MAP 3-18-48

REVISIONS: *Letter of 9-13-51 from Water Bd. request paving to be held up until water mains are completed.*

REVISIONS: *NOTE: FOR SYMBOLS A ETC. SEE STD. DET. DRAWG C-327*

REVISIONS: *REINFORCING BARS ARE NOT TO BE EMBEDDED IN CONCRETE.*

REVISIONS: *PAVING COMPLETED C.C. 1-15-52*

REVISIONS: *PLAN SCALE DISTORTED*

REVISIONS: *LOT & ALLEYS 1"=100'*

REVISIONS: *STREET WIDTHS 1"=50'*

REVISIONS: *DRAINAGE COMPLETED*

REVISIONS: *PAVING COMPLETED*

REVISIONS: *CONSTRUCT BARRICADE SEE DETAIL AT PARK*

REVISIONS: *ASSESS 408*

REVISIONS: *66' WD LAMPHERE*

REVISIONS: *14785 CURB 14845*

REVISIONS: *DITCH 132' BOTH SIDES AVG. DEPTH 6"*

REVISIONS: *14785 W. GUTTER 14795*

REVISIONS: *14817 W. GUTTER 14845*

REVISIONS: *14875*

REVISIONS: *14875*

REVISIONS: *14875*

REVISIONS: *14875*

REVISIONS: *14875*

REVISIONS: *14875*

REVISIONS: *14875*

REVISIONS: *14875*

REVISIONS: *14875*

REVISIONS: *14875*

REVISIONS: *14875*

REVISIONS: *14875*

REVISIONS: *14875*

REVISIONS: *14875*

REVISIONS: *14875*

REVISIONS: *14875*

REVISIONS: *14875*

REVISIONS: *14875*

REVISIONS: *14875*

REVISIONS: *14875*

REVISIONS: *14875*

REVISIONS: *14875*

REVISIONS: *14875*

REVISIONS: *14875*

REVISIONS: *14875*

REVISIONS: *14875*

REVISIONS: *14875*

REVISIONS: *14875*

REVISIONS: *14875*

REVISIONS: *14875*

REVISIONS: *14875*

REVISIONS: *14875*