

SEWER	REVISIONS	OLD MAPS	4-15-41
C-327	C-586	C-739A	C-1608
C-325	C-524	C-733	C-936
C-324A	C-350	C-587	C-739B
SUPPLEMENTARY DETAILS			

NOTE:  
BEFORE STARTING CONSTRUCTION CONTRACTOR MUST CHECK WITH UTILITIES FOR LOCATIONS OF EXISTING STRUCTURES WHETHER OR NOT INDICATED ON PLANS.

PLAN SCALE DISTORTED  
LOTS & ALLEYS, 1" = 100'  
STREET WIDTHS, 1" = 50'

DRAINAGE COMPLETED 2-10-42  
PAVING COMPLETED C.C. 11-20-51

QUANTITIES	ESTIMATED	FINAL
EXCAVATION CU. YRS.	885	153
NEW CURB LIN. FT.	2030	236
PAVING 8x8 SQ. YRS.	100	100
6" CONC. DR. S.F.T.	144	43
MANHOLE ADJUST.	1	4
RE-CONSTRUCT	4	2
BASINS	2	35
ADJUST. CONSTRUCT		

HOW SCALE	1" = 100'	BOOK	1723	PAGE	44
DATE	6-2-51	DATE DRAWING	7-9-51		
PLAN	GS	PROPOSED	GS	COMPLETED	DL
CHECKED	AVG	GRADE	64.5	CHECKED	0.8
LOVE	1	375.43	LENGTH	687.72	
CITY	2	82.08	WIDTH	41.04	
TOTAL	21	1457.51	LENGTH	728.76	

DESIGNED BY  
DRAWN BY G. SMITH  
TRACED BY  
CHECKED BY  
APPROVED BY  
ENGINEER OF STREETS  
CITY ENGINEER

CONTRACT NO. PW 1706F

DEPARTMENT OF PUBLIC WORKS  
CITY ENGINEERS OFFICE - DIVISION OF PAVING DESIGN

STREET PAVING PLAN

NAME OF STREET: LARKINS  
FROM: N.P.L. ST. JOHN  
TO: S.P.L. MICHIGAN

INDEX TOPO NO. 54 13  
RECORD NO.

ASSIGN NO. 254W-3  
PETITION NO. 5042

SHEET 1 OF 1

CONTRACT APPROVAL - C.C.  
PET # 5042 MARTIN-CENTRAL DISTRICTS PROPERTY OWNERS ASSN 4/17/51

BENCH MARKS  
P.L.B.M. #13-251 N.E. COR. MICHIGAN & CHOPIN  
P.L.B.M. #13-251 A N.E. COR. MICHIGAN & LARKINS  
ARDON HYD. W.S. OF MICHIGAN - B.M. 450 FT. E. OF LARKINS  
ARDON HYD. W.S. OF LARKINS - B.M. 450 FT. N. OF ST. JOHN  
ARDON HYD. W.S. OF LARKINS - B.M. 50 FT. N. OF ST. JOHN

ELEV.  
114.404  
113.805  
117.32  
116.92  
117.08

NOTE  
FOR SYMBOLS (A) ETC. SEE STD. DETAIL DWG. C-327

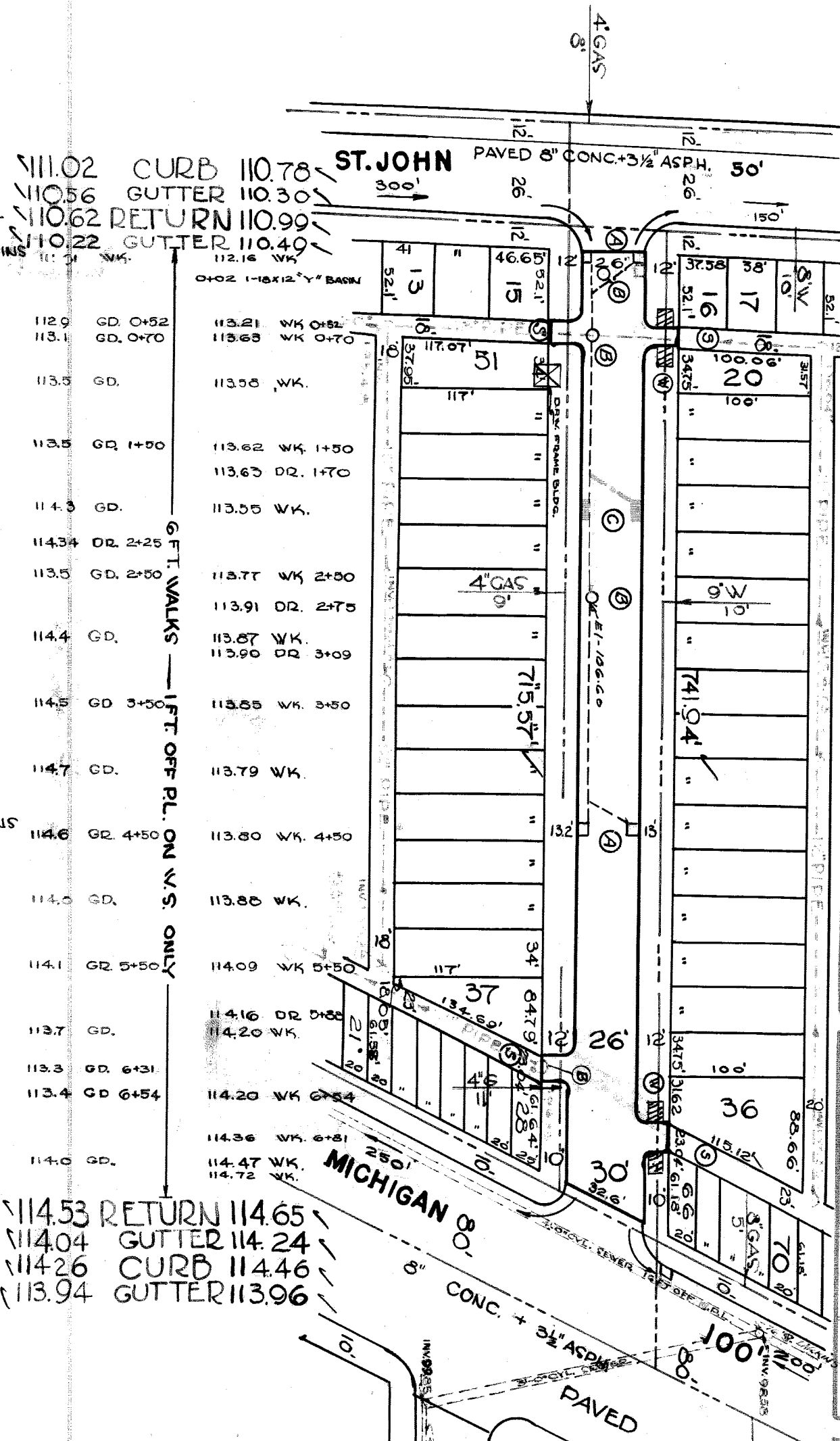

114.53 RETURN 114.65  
114.04 GUTTER 114.24  
114.26 CURB 114.46  
113.94 GUTTER 113.96

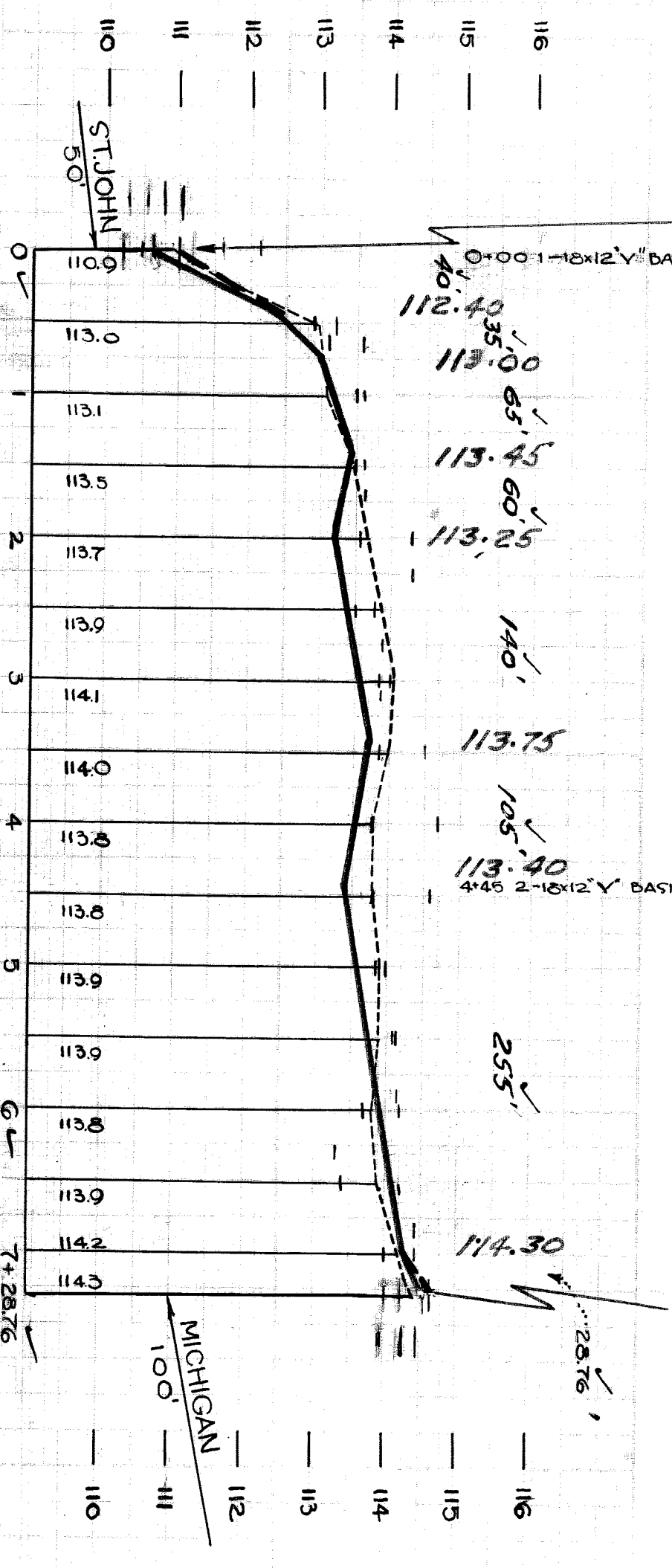

91309