

STREET PAVING PLAN

LANTZ

E.P.L. OF ALBANY

W.P.L. OF DWYER

TYPE OF PAVEMENT - 8" C.C. 8" ONE COURSE CONCRETE SLAB & CURB INTEGRAL

MOHT 26

CARD NO. INDEX NO. 19 92

DESIGNED BY: S. Sadowski
 DRAWN BY: C. HENDERSON
 TRACED BY:
 CHECKED BY: S. Sadowski
 APPROVED:

PLAN	CL.H.	PROFILE	CL.H.	COMPUTED	5.5
CHECKED	5.5	GRADE	CHECKED	4.9	5
LOTS	21	130.00	LENGTH	565.00	
CITY	21	240.00	LENGTH	123.00	
TOTAL	21	1376.00	LENGTH	688.00	

QUANTITIES	ESTIMATED	FINAL
EXCAVATION CU YDS.	283	283
NEW CURB LIN. FT.	1695	1695
PAVING SQ. YDS.	616	616
SIDEWALK SQ. FT.	288	288
MANHOLES ADJUST	1	1
CONSTRUCT	6	6
BASES	2	2
SEWERS-12" LIN. FT.	40	40
SEWERS-15" LIN. FT.		

SEWER REVISIONS: 5 3 48 GRADE AT GABLE INTERSECT

NOTE: BEFORE STARTING CONSTRUCTION CONTRACTOR MUST CHECK WITH UTILITIES FOR LOCATIONS OF EXISTING STRUCTURES WHETHER OR NOT INDICATED ON PLANS.

PLAN SCALE DISTORTED
 LOTS & ALLEYS 1" = 100'
 STREET WIDTHS 1" = 50'

PAVING COMPLETED

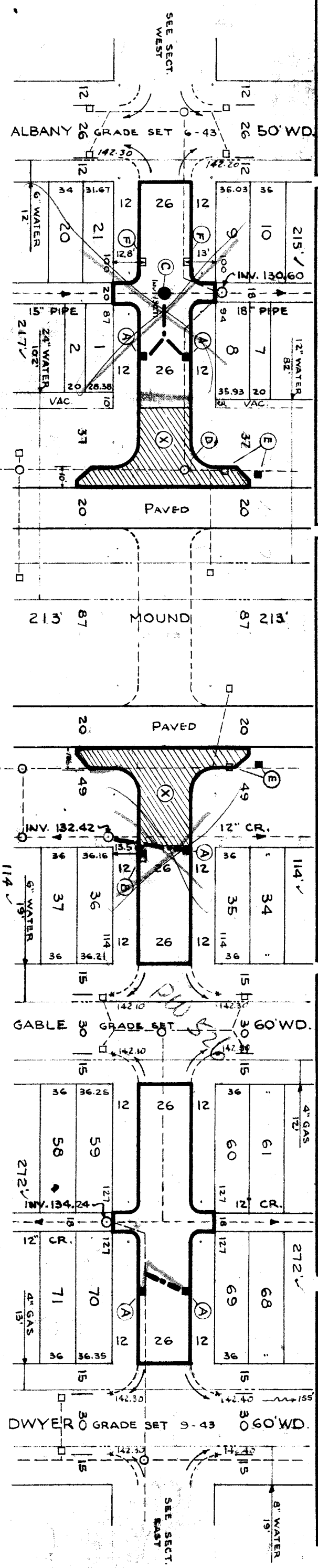

- (A) CONSTRUCT 5 STD. 18" x 12" Y-BASINS COMPLETE AND ABANDON AS SHOWN
- (B) ABANDON 1 E-XIS 12" L-TYPE BASIN AND CONSTRUCT 1 STD. 18" x 12" Y-BASIN COMPLETE & CONNECT AS SHOWN
- (C) CONSTRUCT 1 STD MANHOLE COMPLETE AND CONNECT TO EXISTING SEWER
- (D) ADJUST TOP OF 1 EXISTING MANHOLE
- (E) CONTRACTOR SHALL FURNISH & INSTALL STD. FLAT TYPE CATCH BASIN FRAMES AND GRATES.
- (F) NOTIFY DRW. TO SALVAGE OLD CASTINGS.
- (X) CONSTRUCT CONCRETE RETURN AND WIDENINGS SEE SPECIAL DETAIL C-371. CONCRETE SLAB IN MOUND AVE. TO BE 10" THICK.
- (B) ABANDON 2 EXISTING BASINS AND CONSTRUCT 2 STD. 18" x 12" Y-BASINS COMPLETE. CONNECT TO EXIST. OUTLET
- (F) ABANDON 2 EXISTING Y-BASINS

WK. 142.64	18" 12" Y-BASIN	+78	WK. 142.64	142.75
ALLEY-WK. 142.89			ALLEY-WK. 142.89	+18
20 ALLEY-WK. 142.96			ALLEY-WK. 142.89	+18
6" WKS. 1' OFF P.L. BOTH SIDES. GOOD COND.				
WK. 142.84			WK. 142.64	+12
07 WK. 142.84			WK. 142.64	+12
142.63	FUTURE CURB		142.75	
142.33	P.V.T.		142.45	
142.05	P.V.T.		142.13	
142.35	CURB FUTURE		142.43	
WK. 142.44	5" WKS. 1' OFF P.L. BOTH SIDES FAIR COND.		WK. 141.94	
06 12" L-CATCH BASIN			WK. 142.64	+14
WK. 142.34			WK. 142.62	+14
14 WK. 142.32				
WK. 142.72	5" WKS. 1' OFF P.L. BOTH SIDES COND. FAIR		WK. 142.72	
WK. 142.70			WK. 142.60	+07
27 ALLEY-WK. 142.72			GARAGE 142.70	+18
45 ALLEY-WK. 142.57			ALLEY-WK. 142.80	+27
			ALLEY-WK. 142.69	+45
WK. 142.40			WK. 142.40	
72 WK. 142.30			WK. 142.50	+72

