

DATE: 3-12-69
 SCALE: HORIZONTAL 1" = 40' VERTICAL 1" = 2'
 DRAWING NO. 3-12-69
 SHEET 16 OF 16 SHEETS
 CONTRACT PW 7302 F
 ASSIGNMENT NO. 325-DO-4
 DATE 4-1-70

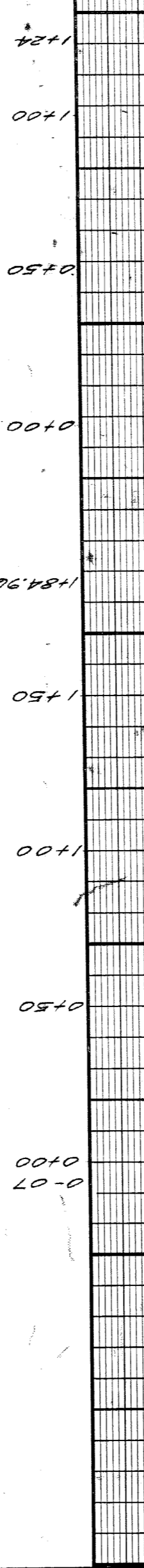
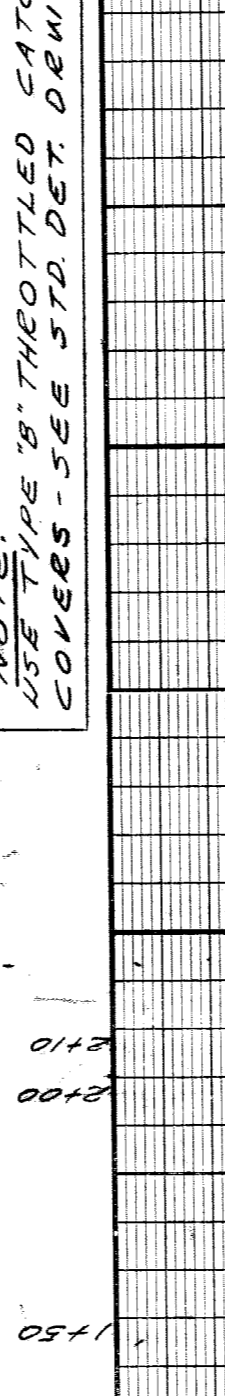
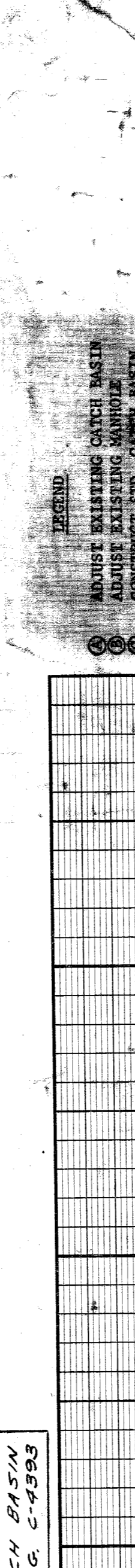
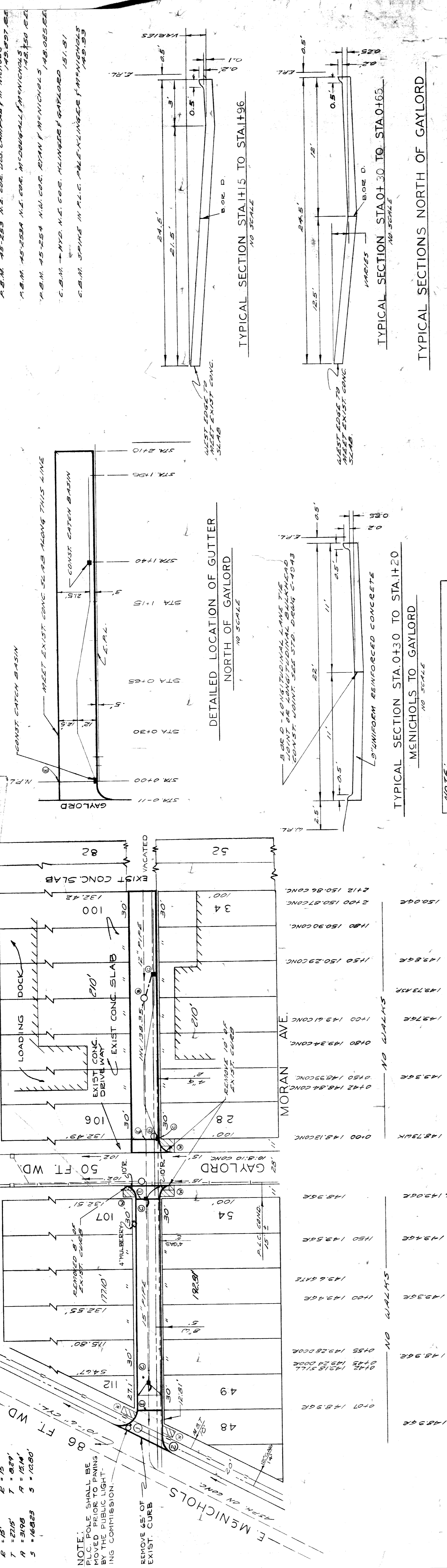

NO.	ITEM	UNIT	LOTS	CITY
1	EXCAVATION	CYDS	518	41
2	BERM GRADING	SYDS	59	65
3	SEPARATE TYPE CURB E.M.L. UNREINFORCED	LF.	280	4
4	INTEGRAL TYPE CURB E.M.L.	LF.	200	50
5	SIDEWALK E.M.L.	SFT.	452	107
6	CATCH BASIN-NEW	EA.	2	232
7	SEWER 12" DIAPE	LF.	2	28
8	PAVT. 9" UNIFORM REINFORCED	SYDS.	572	33
9	TEST CORES	EA.	2	100
10	SIDEWALK 5'-4" STANDARD	SFT.	2	2
11	OLD PATCHING	SFT.	8	2
12	DRIVEWAYS - 8" STANDARD	EA.	1	2
13	TREE REMOVAL 4"-12" DIA.	EA.	1	1
14	MANHOLE - ADJUSTMENT	EA.	1	1
15	MANHOLE - RECONSTRUCT CONE	EA.	1	1
16	PAVT. 9" UNIFORM REINFORCED	SYDS.	572	33

*INCLUDES REINFORCED INTEGRAL CURB.
 **HIGH EARLY STRENGTH CONCRETE.
 TOTAL 6758.1 LENGTH 436.96
 TOTAL 6758.1 LENGTH 436.96

NOTE: 1. ADJUST EXISTING CATCH BASIN TO MEET EXISTING MANHOLE. 2. CONSTRUCT STD. CONC. WALK. 3. CONSTRUCT 9" CONC. WALK. 4. CONSTRUCT 9" CONC. WALK. 5. CONSTRUCT 9" CONC. WALK. 6. CONSTRUCT 9" CONC. WALK. 7. CONSTRUCT 9" CONC. WALK. 8. CONSTRUCT 9" CONC. WALK. 9. CONSTRUCT 9" CONC. WALK. 10. CONSTRUCT 9" CONC. WALK. 11. CONSTRUCT 9" CONC. WALK. 12. CONSTRUCT 9" CONC. WALK. 13. CONSTRUCT 9" CONC. WALK. 14. CONSTRUCT 9" CONC. WALK. 15. CONSTRUCT 9" CONC. WALK. 16. CONSTRUCT 9" CONC. WALK.

CITY OF DETROIT
 DEPARTMENT OF PUBLIC WORKS
 CITY ENGINEERS OFFICE
 PAVING OF KLINGER
 FROM 2246' S. OF N.P.L. OF MICHOLDS
 TO 210' N. OF N.P.L. OF GAYLORD
 APPROVED: *[Signature]*
 ENGINEER OF STREETS
 R. H. HICKS
 ASSISTANT ENGINEER
 CHECKED BY: *[Signature]*
 BY: *[Signature]*
 PLAN: *[Signature]*
 GRADE: *[Signature]*
 ESTIMATE: *[Signature]*
 FINAL: *[Signature]*
 GAS LINE IN MICHOLDS ADDED
 REVISIONS: 1. 7-2-70
 2. 7-2-70