

DESIGNED BY	<i>J. Miller</i>	APPROVED	
DRAWN BY	<i>C. L. Miller</i>	<i>W. Wallace</i>	ENGINEER OF STREETS
TRACED BY		<i>Martin R. Fisher</i>	ASS'T. CITY ENGINEER
CHECKED BY	<i>J. Miller</i>		

DRAINAGE COMPLETED
PAVING COMPLETED 5/13/39

178

180

181

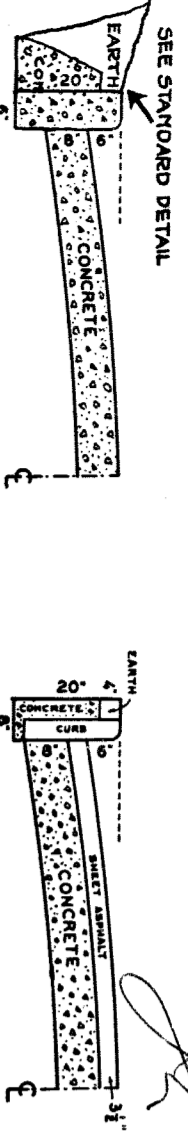
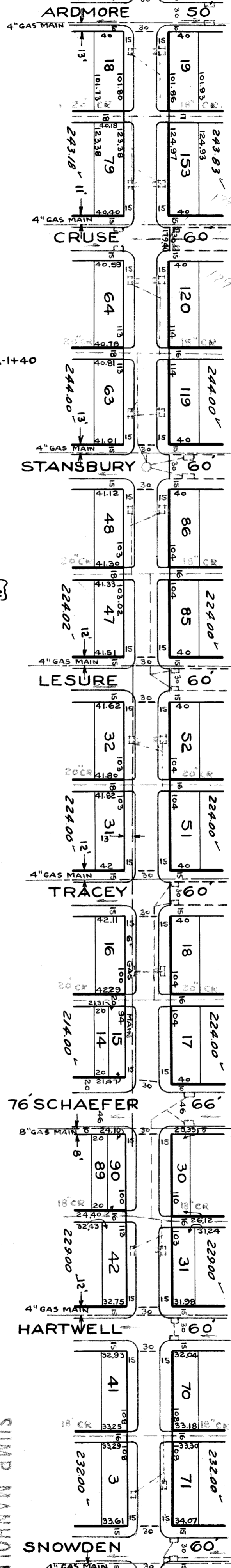
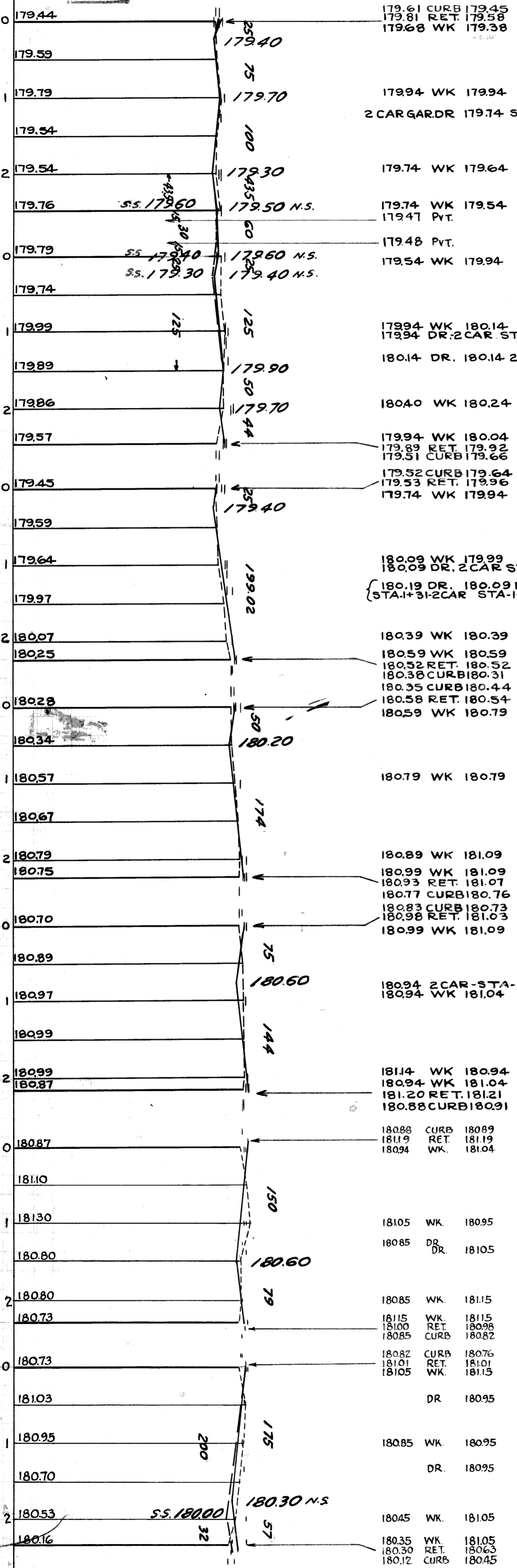

CROSS SECTIONS

SEE STANDARD DETAIL

J. Miller

AT NO.	A	RADIUS	TANG.	ARC	SEG.	QUANTITIES	LOTS	CITY	LOTS	CITY	EXCAVATION	STRAIGHT CURB NEW	OLD CURB RESET	CIRCULAR CURB	PAVING	CONCRETE BASE

CROSS SECTION PAVING MEASUREMENTS TO MARK TWAIN

HOR. SCALE	1" = 100'	BOOK	1087	PAGE	56
VER. SCALE	1" = 4'	DATE	4-6-37		
PLAN	CLW	PROFILE	1/6	CHECKED	1/6
CHECKED	GRADE	LENGTH	5,505.30'	CHECKED	1/6
LOT 2L	1/11	LENGTH	1,777.5'	CHECKED	1/6
CITY	1/11	LENGTH	1,777.5'	CHECKED	1/6
TOTAL 2L	1/11	LENGTH	1,777.5'	CHECKED	1/6
LOT 3L	1/11	LENGTH	1,777.5'	CHECKED	1/6
CITY	1/11	LENGTH	1,777.5'	CHECKED	1/6

DEPARTMENT OF PUBLIC WORKS
CITY ENGINEERS' OFFICE - DIVISION OF PAVING DESIGN

STREET PAVING PLAN
KEELER 60'
MEYERS GREENFIELD

NAME OF STREET: KEELER 60'

FROM: MEYERS

TO: GREENFIELD

TYPE OF PAVEMENT: _____

RECORD NO. _____

INDEX TOPO. NO. 85

INDEX NO. 66

NUMBER OF SHEETS: 4

SHEET NO. 2

BENCH MARKS	ELEV.
ARO. TOP HYD. S.W. COR. ARDMORE & KEELER	182.52
ARO. TOP HYD. N.E. COR. STANSBURY & CRUISE	184.26
ARO. TOP HYD. N.W. COR. SNOWDEN & LESURE	183.81

94682

178

180

181

WPA-4021-1936-37

DETROIT

REVISED 8-4-37