

J.V. WICKLEY  
M. POLITO  
N. KANWAS  
5/13  
5/13  
5/13

SURVEYED	BY	DATE
PLAN PLOTTED		
PLAN CHECKED		
PROFILE PLOTTED		
PROFILE CHECKED		
PRELIMINARY GRADE		
CRACK SPECTRUM		
FEDERAL INSPECTION		

PLANS PREPARED BY  
CITY OF DETROIT  
DEPARTMENT OF PUBLIC WORKS  
BUREAU OF HIGHWAYS AND EXPRESSWAYS

OPERATION	BY	DATE
PRELIMINARY R.O.W. CHECKED		
FINAL DESIGN		
FINAL DESIGN CHECKED		
TRACED		
FINAL R.O.W. CHECK		
QUANTITIES		
QUANTITIES CHECKED		
SQUAD		

Remove Asphalt Surface shown cross-hatched to provide for a smooth connection and to adjust crown. Replace with Bituminous Concrete Pavement.

Station	Remove Ex. Asphalt Surface Sq. Yds	Replace with Bit. Conc. Pavement Sq. Yds
12+50	51	51
16+40	44	44
Totals	95	95

5 Tons Bit Conc. Wearing Course  
5 Tons Bit Conc. Leveling Course

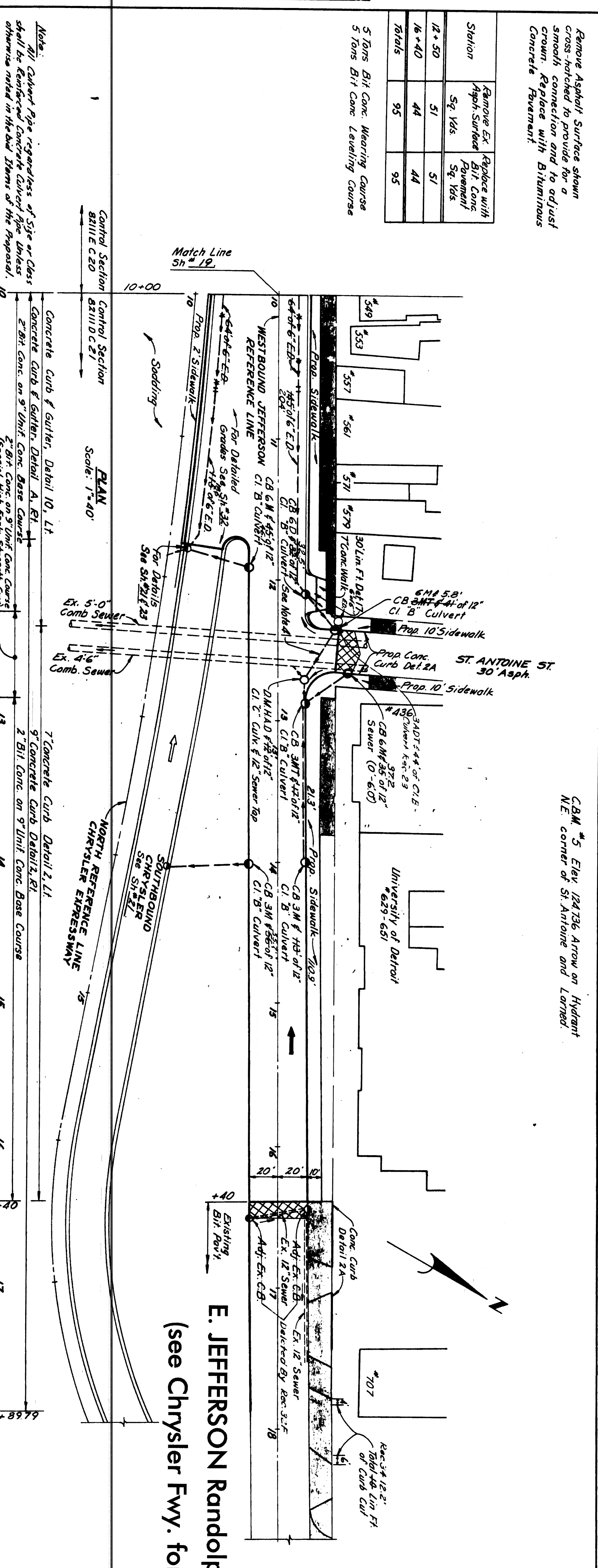
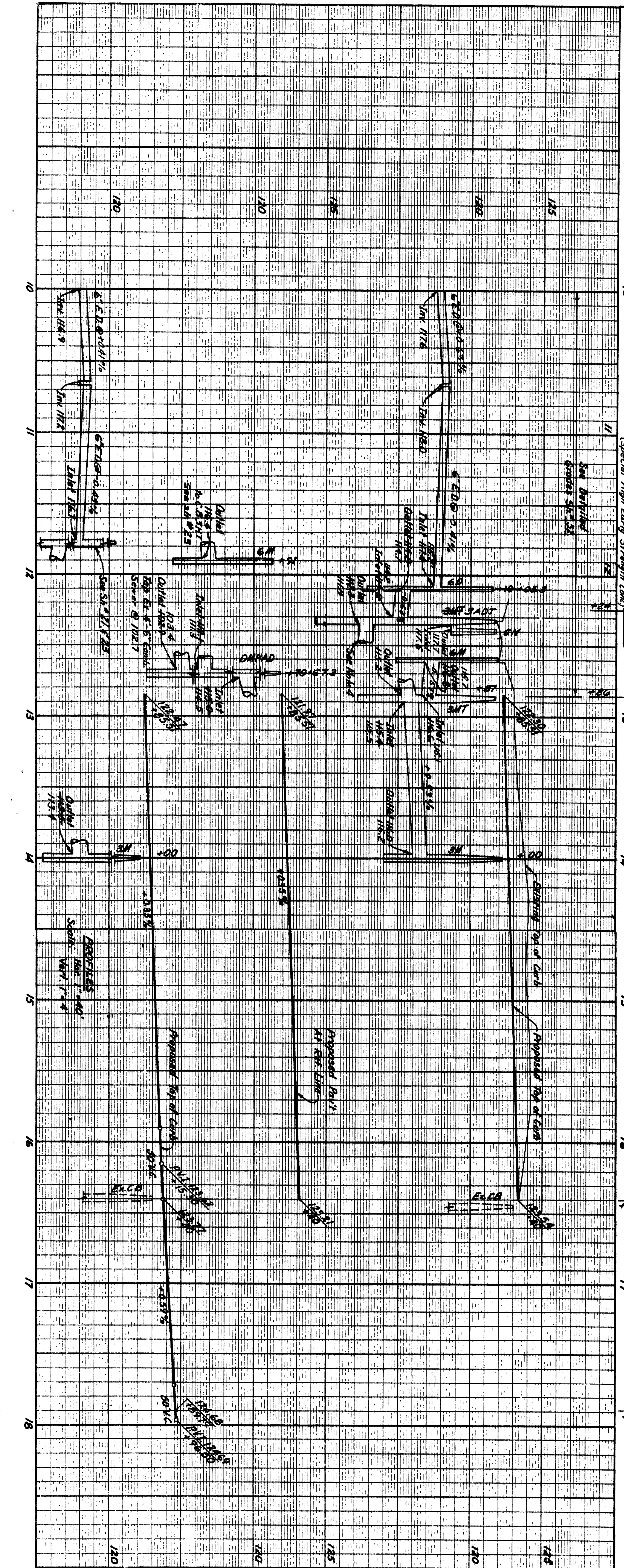

Notes:

- All Culvert Pipe regardless of Size or Class shall be Reinforced Concrete Culvert Pipe Unless otherwise noted in the Bid Items of the Proposal.
- Concrete Curb & Gutter, Detail 10, Lt.
- 2" Bit. Conc. on 9" Unit Conc. Base Course (Special High Early Strength Conc.)
- 2" Bit. Conc. on 9" Unit Conc. Base Course
- 7" Concrete Curb Detail 2, Lt.
- 9" Concrete Curb Detail 2, Rt.
- 2" Bit. Conc. on 9" Unit Conc. Base Course

Scale: 1" = 40'

PLAN

WESTBOUND JEFFERSON

STA. 10+00 TO 17+ 89.79

Notes:

- For Alignment See Sh. # 11, # 12
- For Construction Sequence See Sh. # 13, # 14
- Existing Sidewalk to remain
- The Contractor shall construct sewers crossing streets prior to constructing adjacent C.B. and remainder of sewer lines.

ALL WORK THIS SHEET CONTROL SECTION 82111 DC 21

E. JEFFERSON Randolph to Chrysler Fwy., 1-375  
(see Chrysler Fwy. for full set). #82211E-C20

STATE	MO. NO.	FEED. NO.	SHEET NO.	TOTAL SHEETS
MI.	82111	20	20	20