

DEPARTMENT OF PUBLIC WORKS DETROIT  
CITY ENGINEER'S OFFICE ... DIVISION OF PAVING DESIGN  
**STREET PAVING PLAN**

**HENDERSON**

ASSIGN. NO. 325AC/1  
PETITION NO. 6668

INDEX TOPO NO. 54 5

NAME OF STREET FROM: **E.P.L. OF RENVILLE**

TO: **W.P.L. OF ST. LAWRENCE**

SHEET 2 OF 2 SHEETS

DRAINAGE

CONTRACT APPROVED - C.C. TO \_\_\_\_\_  
**PET. # 6668 MARY FUNK 7-26-49**

ELEV

DESIGNED BY	L. F. KEYS
DRAWN BY	Walter Smith Jr.
TRACED BY	
CHECKED BY	Robert Romo
APPROVED BY	D. J. Wallace
DEPUTY CITY ENGINEER	

PLAN	VER. SCALE	BOOK	PAGE
W/S	1" = 2'	17A1	11
PROFILE			
DATE			
LEVELS	1-5-50		
DRAWING	4-7-50		
CITY			
CHECKED	LFK	J.H.	CS
W/S	GRADE	LENGTH	LENGTH
LOT	21	21	21
CITY			

QUANTITIES	ESTIMATED	FINAL
EXCAVATION CU. YDS.	LOTS	CITY
NEW CURB LIN. FT.		
PAVING SQ. YDS.		
ADJUST		
MANHOLES CONSTRUCT		
ADJUST		
CONSTRUCT		
BASINS CONSTRUCT		
LIN. FT.		

SEWER REVISIONS	
C-324A	C-587
C-325	C-733
C-326A	C-585
C-327	C-586
	C-739A

NOTE:  
BEFORE STARTING CONSTRUCTION CONTRACTOR MUST CHECK WITH UTILITIES FOR LOCATIONS OF EXISTING STRUCTURES WHETHER OR NOT INDICATED ON PLANS.  
**PLAN SCALE DISTORTED**  
LOTS & ALLEYS 1" = 100'  
STREET WIDTHS 1" = 50'  
DRAINAGE COMPLETED  
PAVING COMPLETED

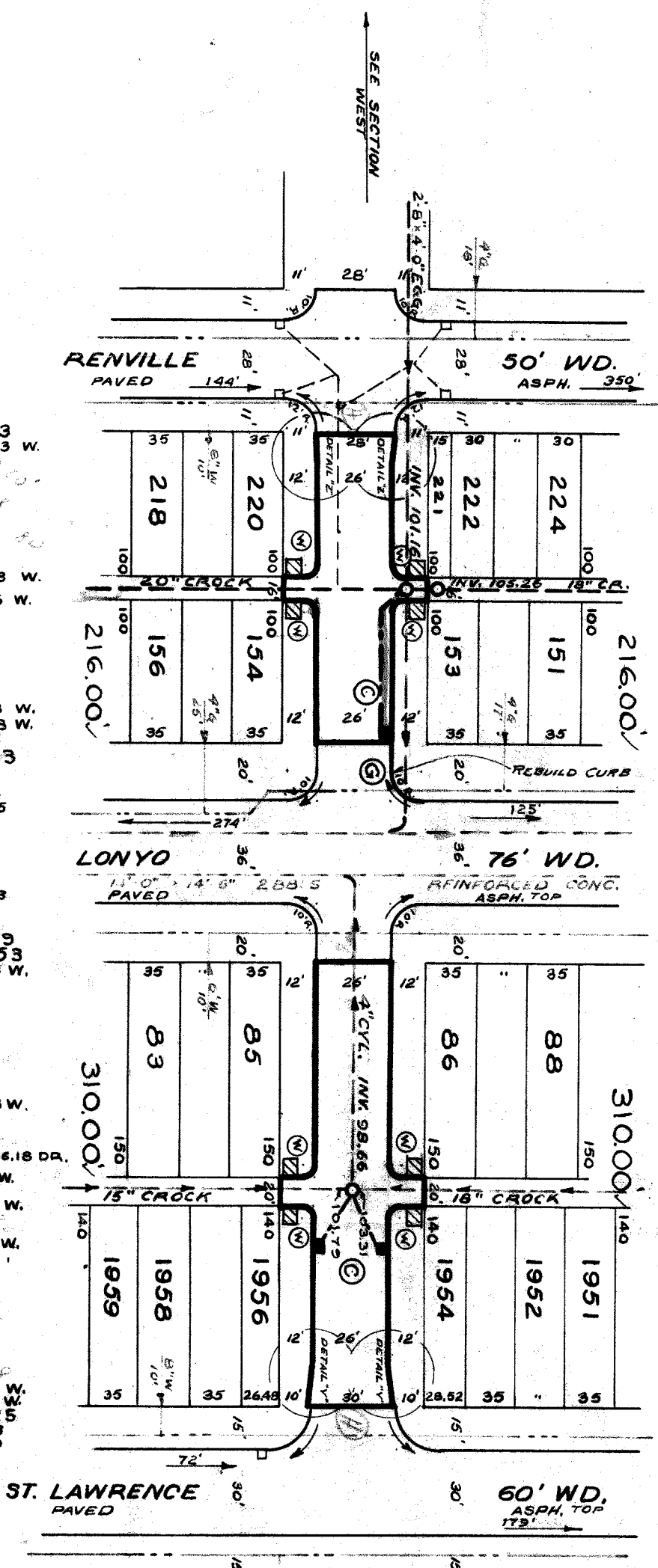

GUTTER RETURN	113.78	114.31	114.13	114.33 W.
GUTTER	113.80			
6' WALK BOTH SIDES				
GUTTER RETURN	116.08 W.	116.06 W.		
GUTTER	115.88 W.	115.88 W.	115.12	114.83
CURB	115.81			
GUTTER	114.95			
6' WALK BOTH SIDES				
GUTTER	114.93	114.93		
CURB	115.41			
GUTTER RETURN	115.28	115.29	115.53	115.83 W.
GUTTER	115.75			
CURB	115.76 W.			
6' WALK BOTH SIDES				
GUTTER	116.25 W.	116.23 W.		
CURB	+38 116.18 DR.	116.25 W.		
GUTTER	116.25 W.	116.25 W.	116.16 W.	
CURB	116.03 W.			
GUTTER	116.03 W.			
CURB	116.31 W.	116.27 W.	116.25	116.03
GUTTER	116.03			
CURB	115.93			
GUTTER	116.06 W.	116.07	116.03	115.93
CURB	116.07			
GUTTER	116.03			
CURB	115.93			

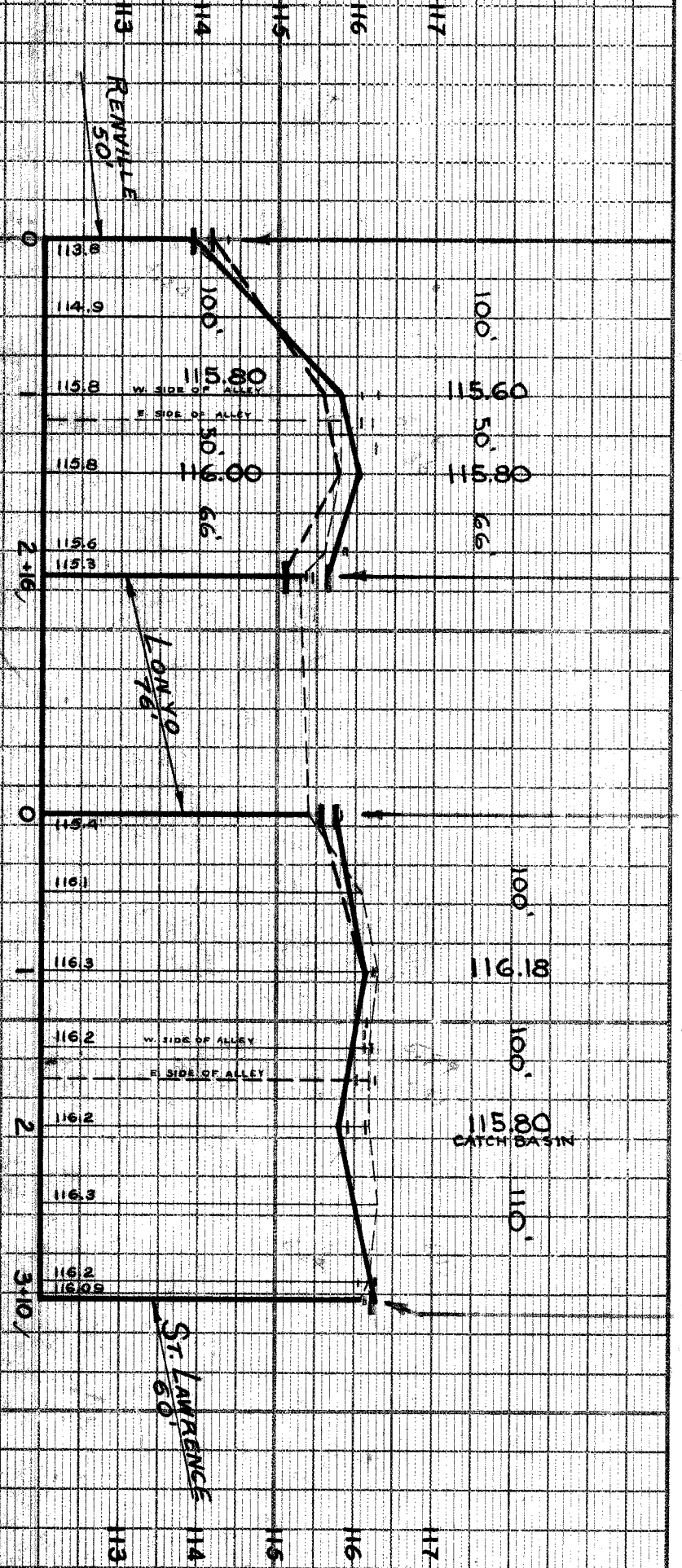

NOTE:  
ALL CROSS STREETS ARE 8" CONC. + 3" ASPHALT.

- AT (C) CONSTRUCT 3 STD PIPE CATCH BASINS WITH STD FRAMES & GRATES AS REQUIRD. CONNECT TO EXISTING OUTLETS AS SHOWN. SEE DWGS. C326A & C326B.
- AT (W) CONSTRUCT 2 3/4" DIA. OF STD #1 SIDEWALK.
- ADJUST TOPS OF 1 WATER MANHOLE.
- ADJUST TOPS OF 1 WATER MANHOLE.
- BACHFILL SEWER PIPE TRENCHES UNDER PROPOSED PAVEMENT WITH APPROVED SAND-GRAVEL MATERIAL.
- DIRT ALLEYS AT ENDS OF PAVEMENT SHALL BE GRADED BACK AND STONED 6" DEEP UNIFORMITY FOR A DISTANCE OF 10 FT. TO MEET EXISTING GRADES. 48 CURBS INCLUDED UNDER EXCAVATION TOTALS FOR COST.
- AT (G) REBUILD 28 FT. OF TYPE II CURB.

*Handwritten note:* Under Renville St. at Lonyo St.

FOR DETAILS  
SEE  
SHEET 1 OF 2