

AS 06
6\"/>

AS 13
TYPICAL SUBSURFACE DRAIN TRENCH
SCALE: 1-1/2\"/>

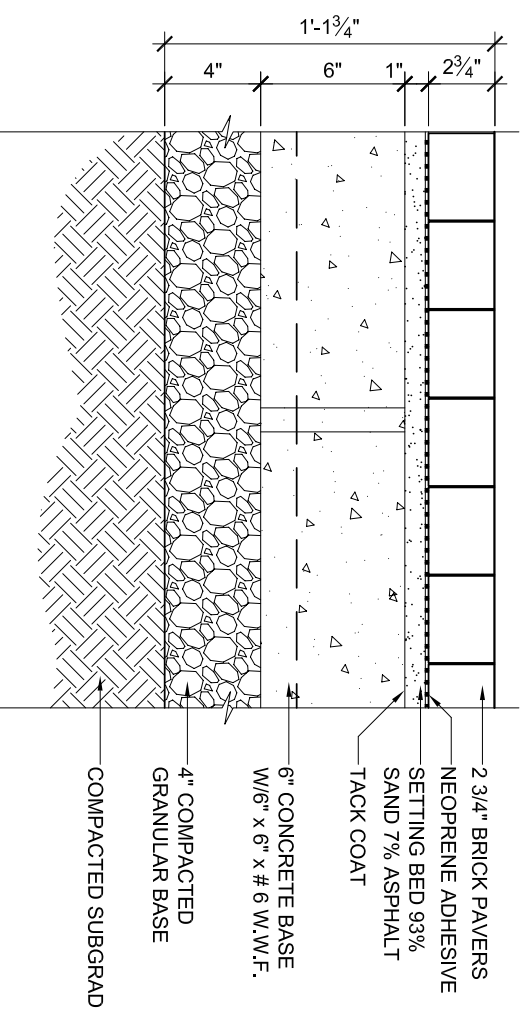

AS 07
BRICK PAVING W/6\"/>

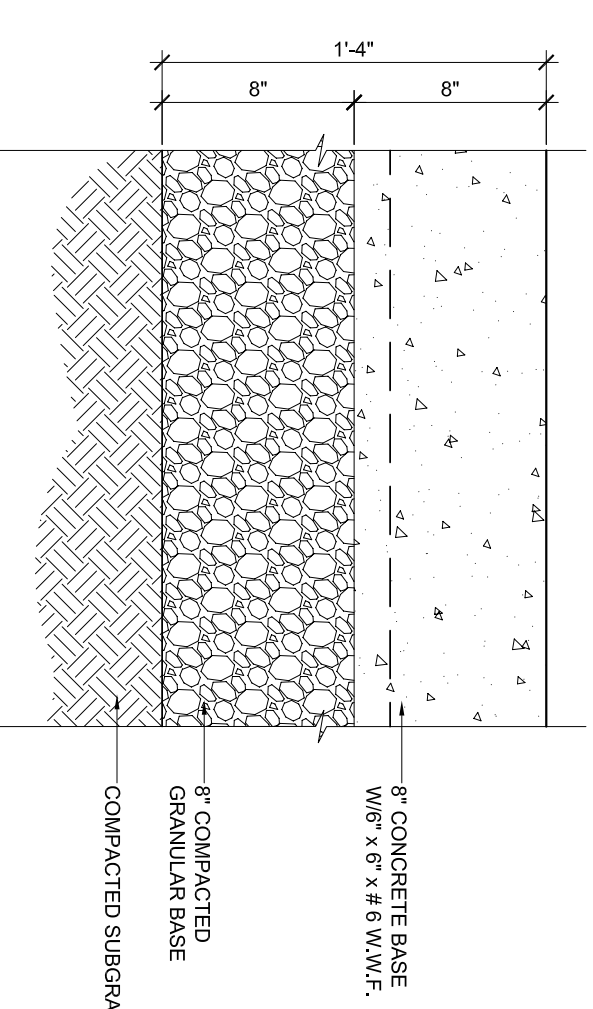

AS 06
8\"/>

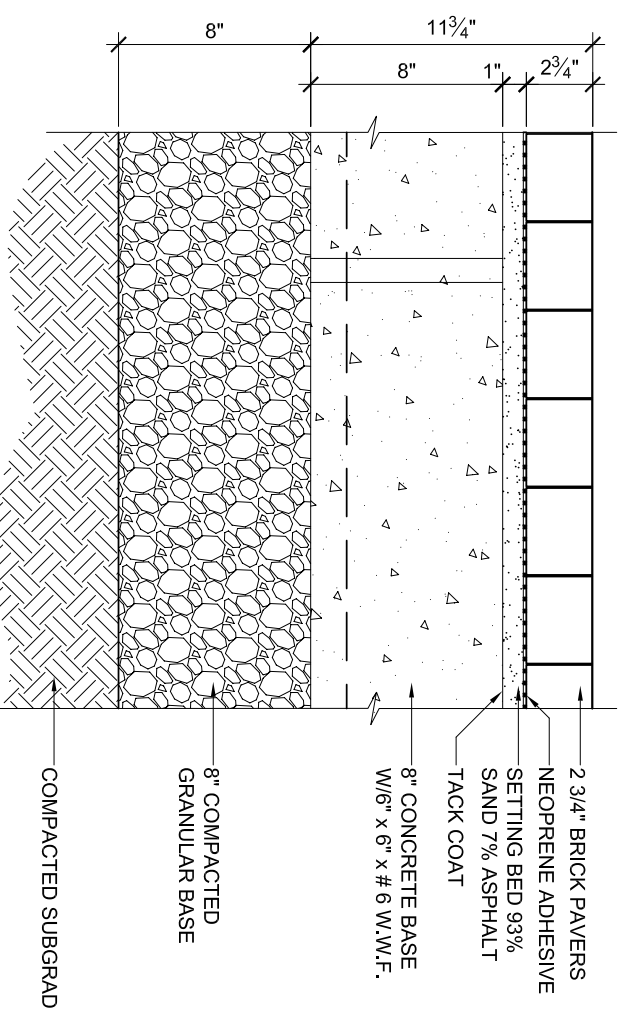

AS 05
BRICK PAVING W/8\"/>

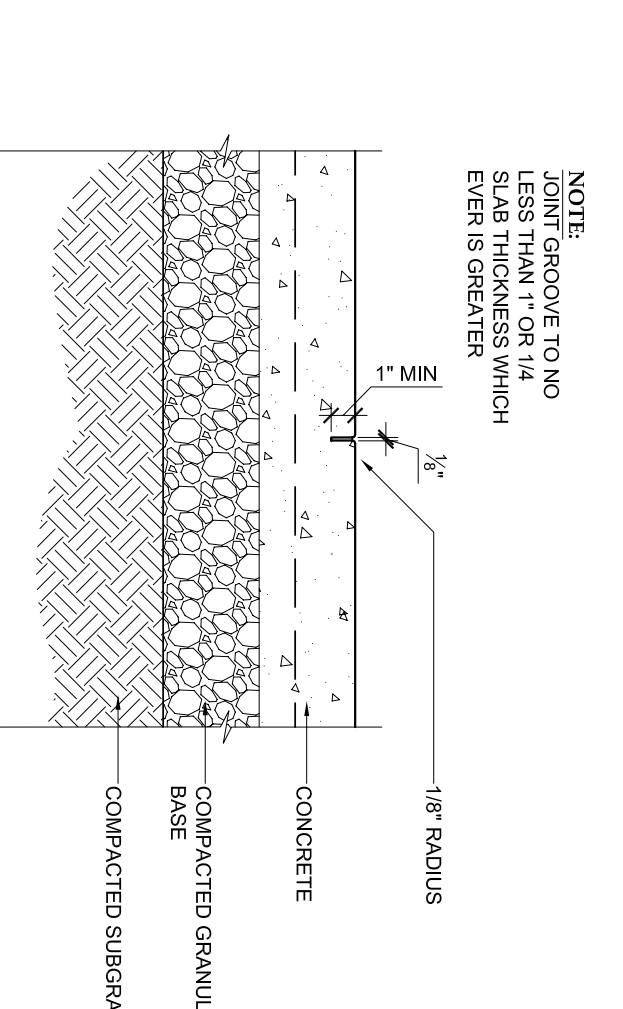

AS 02
TYP. TROWELED CONTROL JOINT
SCALE: 1-1/2\"/>

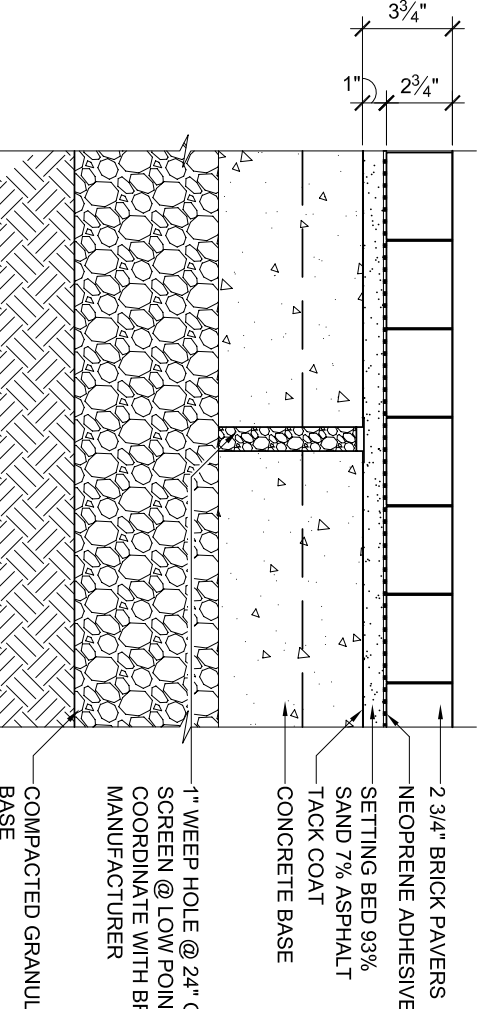

AS 08
BRICK PAVING W/8\"/>

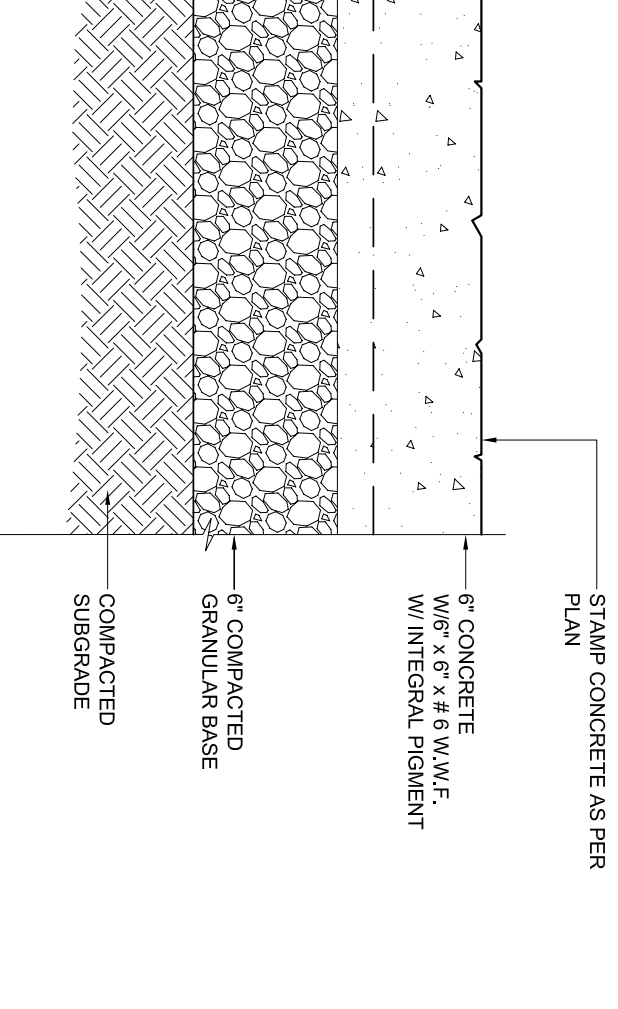

AS 01
TYP. 6\"/>

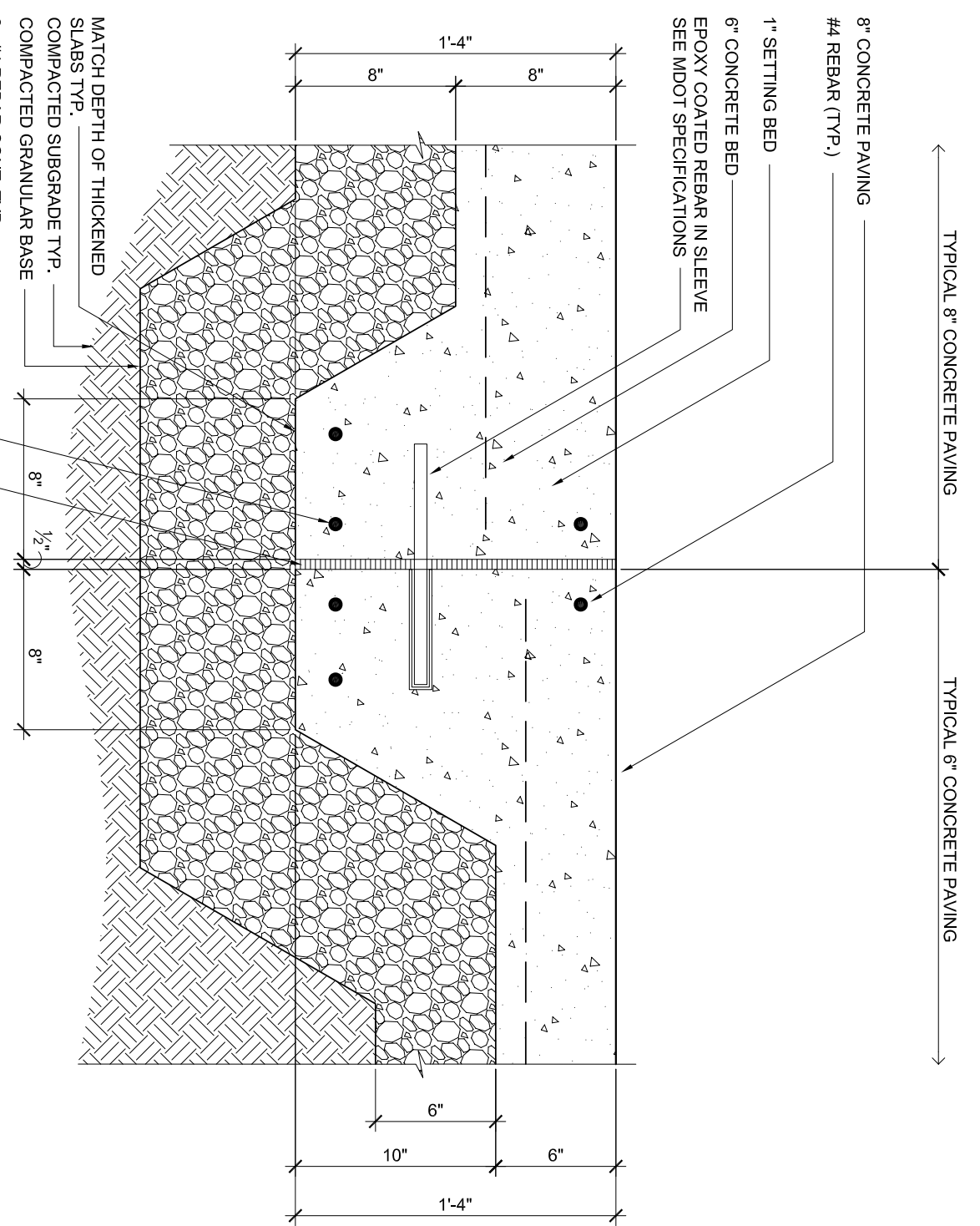

AS 10
PAVEMENT TO PAVEMENT DETAILS
SCALE: 1-1/2\"/>

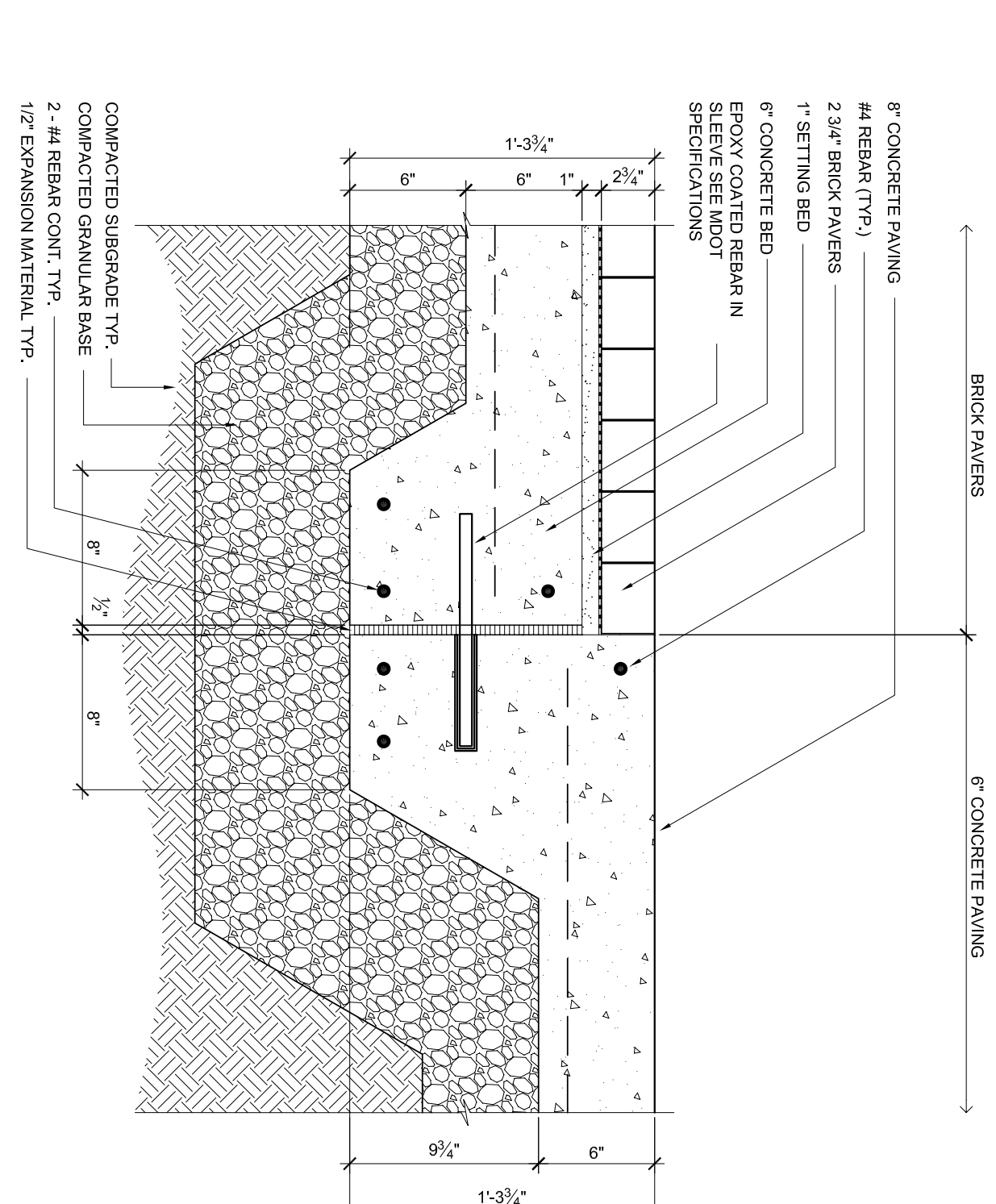

AS 11
PAVEMENT TO PAVEMENT DETAILS
SCALE: 1-1/2\"/>

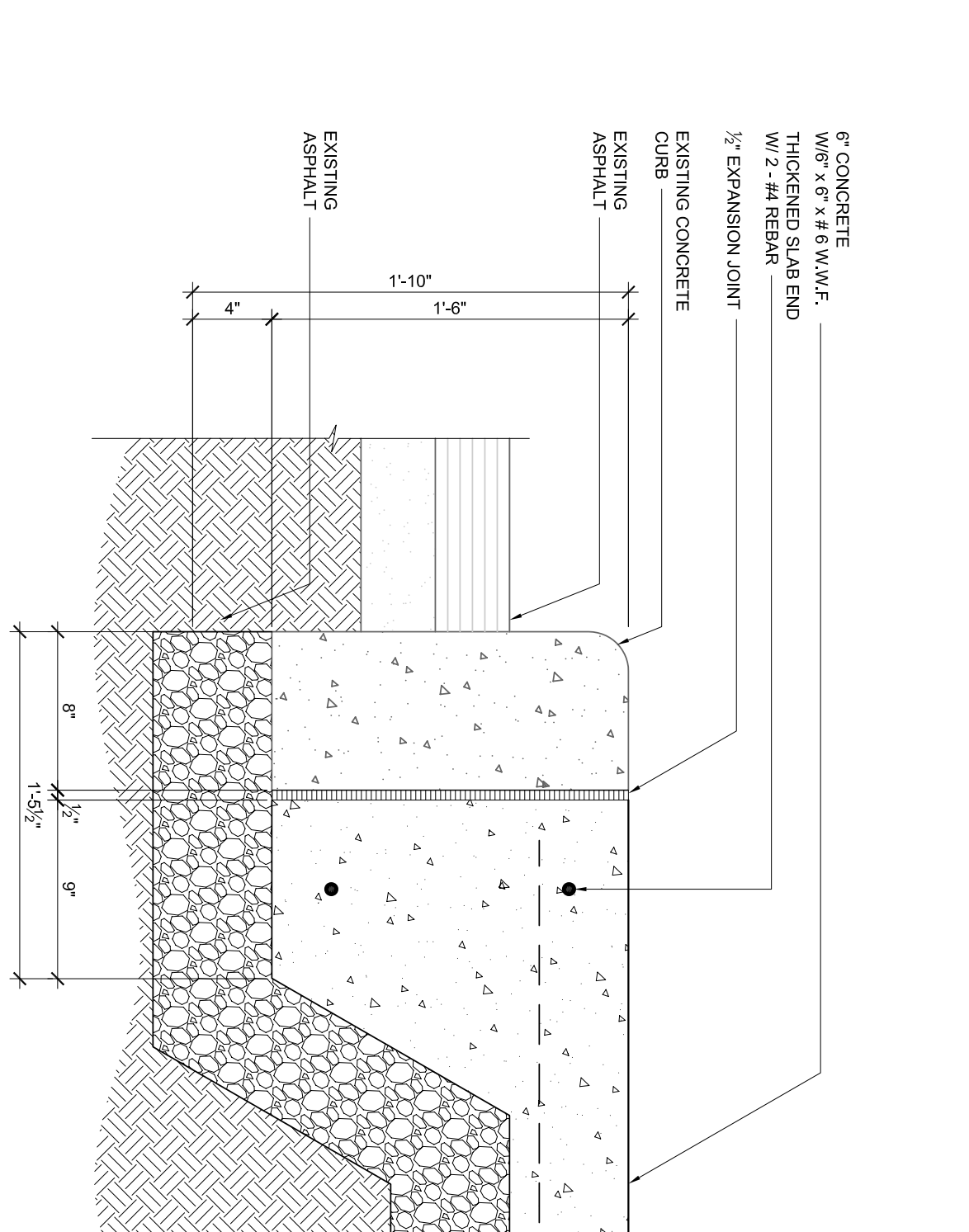

AS 08
CURB / CONCRETE PAVING
SCALE: 1-1/2\"/>

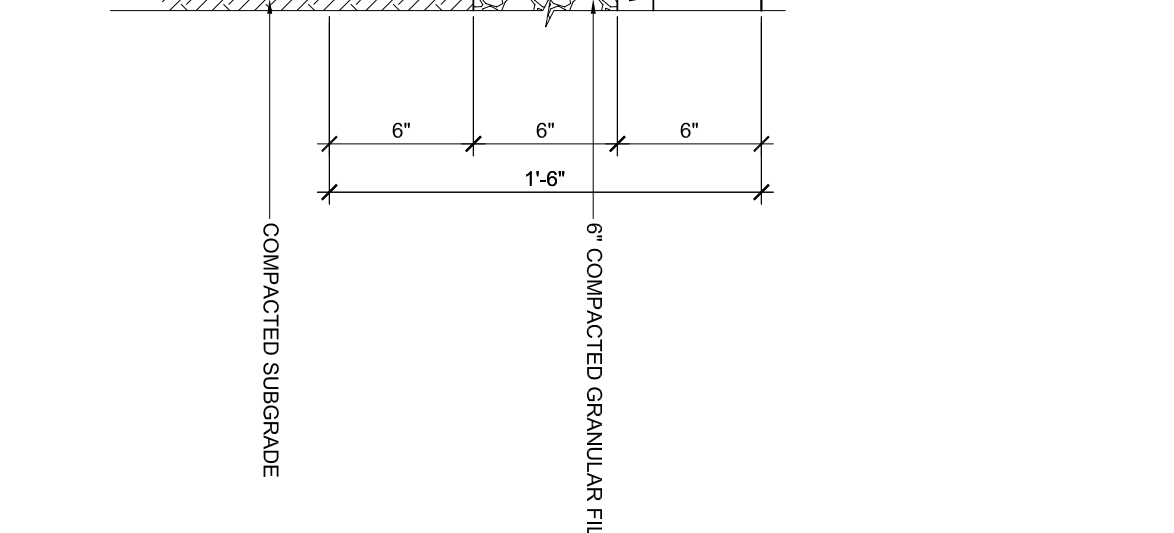

AS 03
TYP. BRICK PAVING
SCALE: 1-1/2\"/>

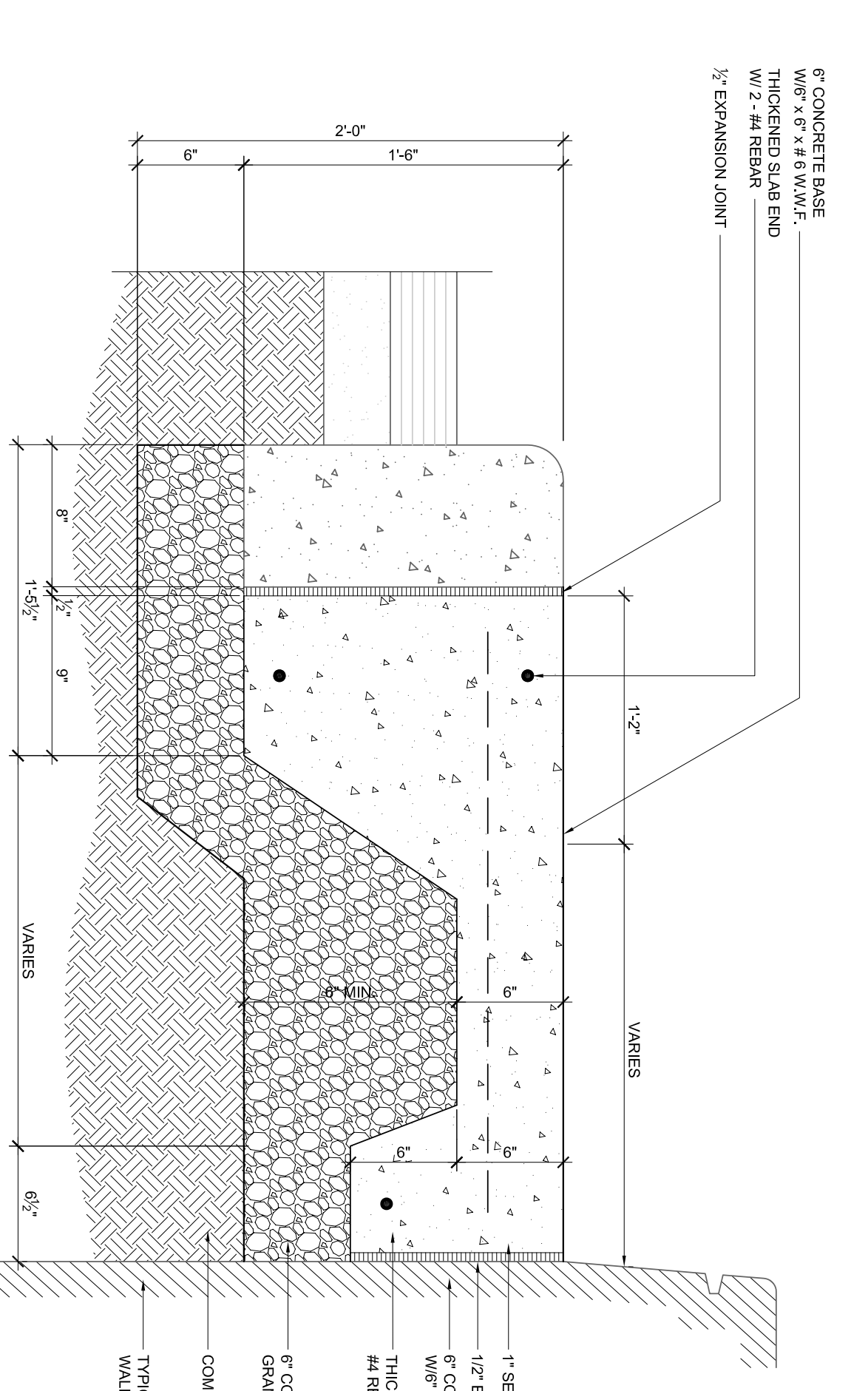

AS 08
TYPICAL CURB / PAVING DETAIL
SCALE: 1-1/2\"/>

GENERAL NOTES:

- THIS IS AN INSTRUMENT OF SERVICE ONLY AND IS THE PROPERTY OF MER&A. IT IS TO BE USED ONLY FOR THE PROJECT AND SITE SPECIFICALLY IDENTIFIED HEREIN.
- ALL DIMENSIONS ARE UNLESS OTHERWISE SPECIFIED.
- ALL MATERIALS AND METHODS SHALL BE IN ACCORDANCE WITH THE LATEST EDITIONS OF THE SPECIFICATIONS AND STANDARD DRAWINGS OF THE AMERICAN INSTITUTE OF STEEL CONSTRUCTION, INC. (AISC).
- ALL MATERIALS AND METHODS SHALL BE IN ACCORDANCE WITH THE LATEST EDITIONS OF THE SPECIFICATIONS AND STANDARD DRAWINGS OF THE AMERICAN INSTITUTE OF STEEL CONSTRUCTION, INC. (AISC).
- ALL MATERIALS AND METHODS SHALL BE IN ACCORDANCE WITH THE LATEST EDITIONS OF THE SPECIFICATIONS AND STANDARD DRAWINGS OF THE AMERICAN INSTITUTE OF STEEL CONSTRUCTION, INC. (AISC).
- ALL MATERIALS AND METHODS SHALL BE IN ACCORDANCE WITH THE LATEST EDITIONS OF THE SPECIFICATIONS AND STANDARD DRAWINGS OF THE AMERICAN INSTITUTE OF STEEL CONSTRUCTION, INC. (AISC).
- ALL MATERIALS AND METHODS SHALL BE IN ACCORDANCE WITH THE LATEST EDITIONS OF THE SPECIFICATIONS AND STANDARD DRAWINGS OF THE AMERICAN INSTITUTE OF STEEL CONSTRUCTION, INC. (AISC).
- ALL MATERIALS AND METHODS SHALL BE IN ACCORDANCE WITH THE LATEST EDITIONS OF THE SPECIFICATIONS AND STANDARD DRAWINGS OF THE AMERICAN INSTITUTE OF STEEL CONSTRUCTION, INC. (AISC).
- ALL MATERIALS AND METHODS SHALL BE IN ACCORDANCE WITH THE LATEST EDITIONS OF THE SPECIFICATIONS AND STANDARD DRAWINGS OF THE AMERICAN INSTITUTE OF STEEL CONSTRUCTION, INC. (AISC).
- ALL MATERIALS AND METHODS SHALL BE IN ACCORDANCE WITH THE LATEST EDITIONS OF THE SPECIFICATIONS AND STANDARD DRAWINGS OF THE AMERICAN INSTITUTE OF STEEL CONSTRUCTION, INC. (AISC).

MER&A ASSOCIATES
4455 LATHROP, SUITE 1111
SEASIDE, WA 98138
PH: 206.465.1111
F: 206.465.1111
WWW.MERANDASSOCIATES.COM

CAPITOL PARK IMPROVEMENT PROJECT

Distribution: Capitol Park Residential & Improvements

Project No.	0705
Client	UWST INC
Design	CM
Check	CM
Approve	CM
Date	1/27/07
Scale	See Drawings

AS 8.1