

01 PLANTERS "A" ENLARGED
AS 1.1
 SCALE: 1/4"=1'-0"

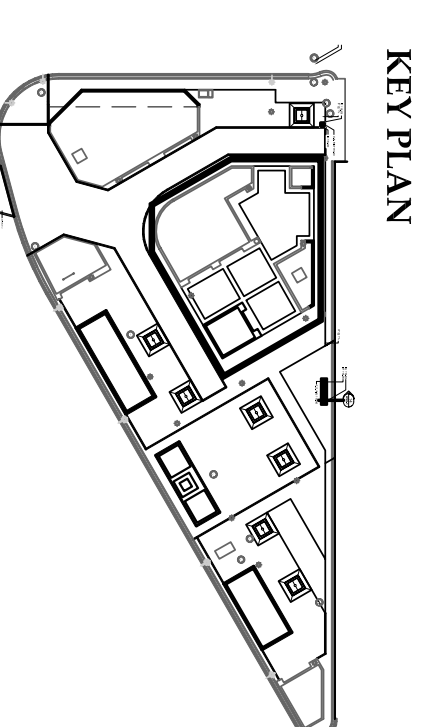

FIXTURE LEGEND:	
	LAMP POLE BY DETROIT PARKS AND RECREATION
	LAMP POLE BY CITY OF DETROIT PUBLIC LIGHTING DEPARTMENT

WALL LEGEND:	
	EXISTING RETAINING WALLS
	NEW RETAINING WALLS

GENERAL NOTES:

1. SHALL BE A MINIMUM OF 6" SERVICE ONLY AND THE PROPERTY OF MERZ & ASSOCIATES.
2. WALL DIMENSIONS ARE TAKEN FROM FINISHED FACE OF SURFACES.
3. ALL DIMENSIONS SHALL BE TAKEN FROM FINISHED FACE OF SURFACES UNLESS OTHERWISE NOTED.
4. ALL DIMENSIONS SHALL BE TAKEN FROM FINISHED FACE OF SURFACES UNLESS OTHERWISE NOTED.
5. ALL DIMENSIONS SHALL BE TAKEN FROM FINISHED FACE OF SURFACES UNLESS OTHERWISE NOTED.
6. CONTRACTOR SHALL VERIFY ALL DIMENSIONS AND REPORT TO ARCHITECT IMMEDIATELY UPON DISCOVERY OF ANY DISCREPANCIES.
7. ALL EXISTING CONDITIONS ARE TO BE MAINTAINED UNLESS OTHERWISE NOTED.
8. ALL EXISTING CONDITIONS ARE TO BE MAINTAINED UNLESS OTHERWISE NOTED.
9. ALL EXISTING CONDITIONS ARE TO BE MAINTAINED UNLESS OTHERWISE NOTED.
10. ALL EXISTING CONDITIONS ARE TO BE MAINTAINED UNLESS OTHERWISE NOTED.

MERZ & ASSOCIATES
 ARCHITECTS & URBAN DESIGNERS
 440 E. LAFAYETTE, SUITE 211
 ANN ARBOR, MI 48106
 TEL: 734.769.1100
 FAX: 734.769.1101
 WWW.MERZANDASSOCIATES.COM

DESIGN TEAM	
Architect	Merz & Associates
Engineer	Merz & Associates
Interior Designer	Merz & Associates
Landscaper	Merz & Associates
Lighting Designer	Merz & Associates
Sign Designer	Merz & Associates
Specialty Consultant	Merz & Associates

REVISIONS		
NO.	DATE	DESCRIPTION
01	08.28.09	ISSUED FOR PERMIT
02	09.05.09	REVISIONS TO PERMIT
03	09.22.09	REVISIONS TO PERMIT
04	09.22.09	REVISIONS TO PERMIT
05	09.22.09	REVISIONS TO PERMIT
06	09.22.09	REVISIONS TO PERMIT
07	09.22.09	REVISIONS TO PERMIT
08	09.22.09	REVISIONS TO PERMIT
09	09.22.09	REVISIONS TO PERMIT
10	09.22.09	REVISIONS TO PERMIT

APPROVALS	
DATE	11/27/07
SCALE	See Drawing
AS 2.1	