

3 WORKING DAYS
BEFORE YOU DIG,
CALL MISS DIG,
1-800-482-7171
For the Division of Public Works

REVISIONS	DESCRIPTION	CHKD	APPD	DATE
A	ADDED DIMENSIONS, SURVEYOR'S COMMENT AND CERTIFICATE			4-28-08

DESIGNED BY: MW
CHECKED BY: MH
APPROVED BY: MH

DESIGNED BY: MW
CHECKED BY: MH
APPROVED BY: MH

LOWER WOODWARD CROSS STREETS IMPROVEMENTS
CITY OF DETROIT - DOWNTOWN DEVELOPMENT AUTHORITY

TOPOGRAFICAL SURVEY
GRISWOLD -
MATCHLINE (STA 725+00) TO MATCHLINE (STA 750+75) TO STATE
SCALE: 1"=20'

Hamilton anderson
16000 Woodward Avenue, Detroit, MI 48228
Phone: (313) 967-4700
Fax: (313) 967-4700
www.hamiltonanderson.com

UES
2020 Madison Street, Suite 200, Detroit, MI 48226
Phone: (313) 527-7845
Fax: (313) 527-7845
www.ues.com

MANSELL
18255 Mack Avenue, Detroit, MI 48228
Phone: (313) 277-3900
Fax: (313) 277-3900
www.mansell.com

DDA
DOWNTOWN DEVELOPMENT AUTHORITY
500 Griswold, Suite 2200, Detroit, MI 48226
Phone: (313) 863-8993
Fax: (313) 863-8993

MDA-P/D/S/R: RESUBMIT NO.	REF. NO.	CONTRACT NO.	FILE NO.
	DE080010T		
DRAWING NO.	1-7-8		

NOTE: REFER SHIT # 1-1-1 FOR BENCHMARK INFORMATION.

BASE BID

SURVEYOR'S COMMENT

SMA HAS LOCATED THE ROAD RIGHTS-OF-WAY USING EVIDENCE OF BOUNDARY OCCUPATION BY THE ADJACENT BUILDINGS, RECORD PLATS AND THE CITY OF DETROIT CARTOGRAPHIC MAPS. THE LIMITS OF CAPITAL PARK WERE DETERMINED FROM DATA PROVIDED BY THE CITY OF DETROIT. THE LIMITS OF CAPITAL PARK ARE INCONSISTENT WITH THE EXISTING PHYSICAL LIMITS (PLANTERS, WALKS, ETC.).

SURVEYOR'S STATEMENT

WE HEREBY STATE THAT ALL INFORMATION SHOWN HEREON IS TRUE AND CORRECT TO THE BEST OF OUR KNOWLEDGE AND BELIEF AND IS FROM ADEQUATE FIELD MEASUREMENTS UNDER OATH AND BY ME.

EDWARD P. OTTOURKE
PROFESSIONAL SURVEYOR No. 16937

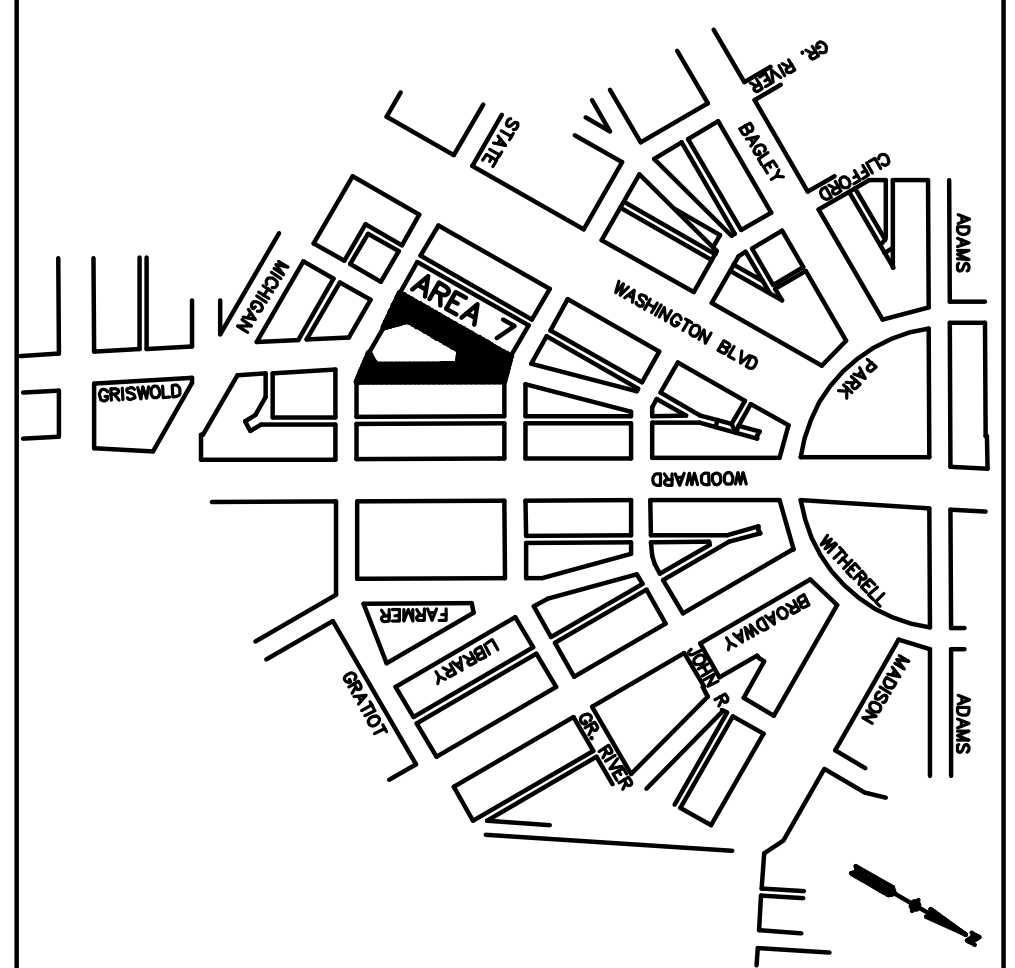
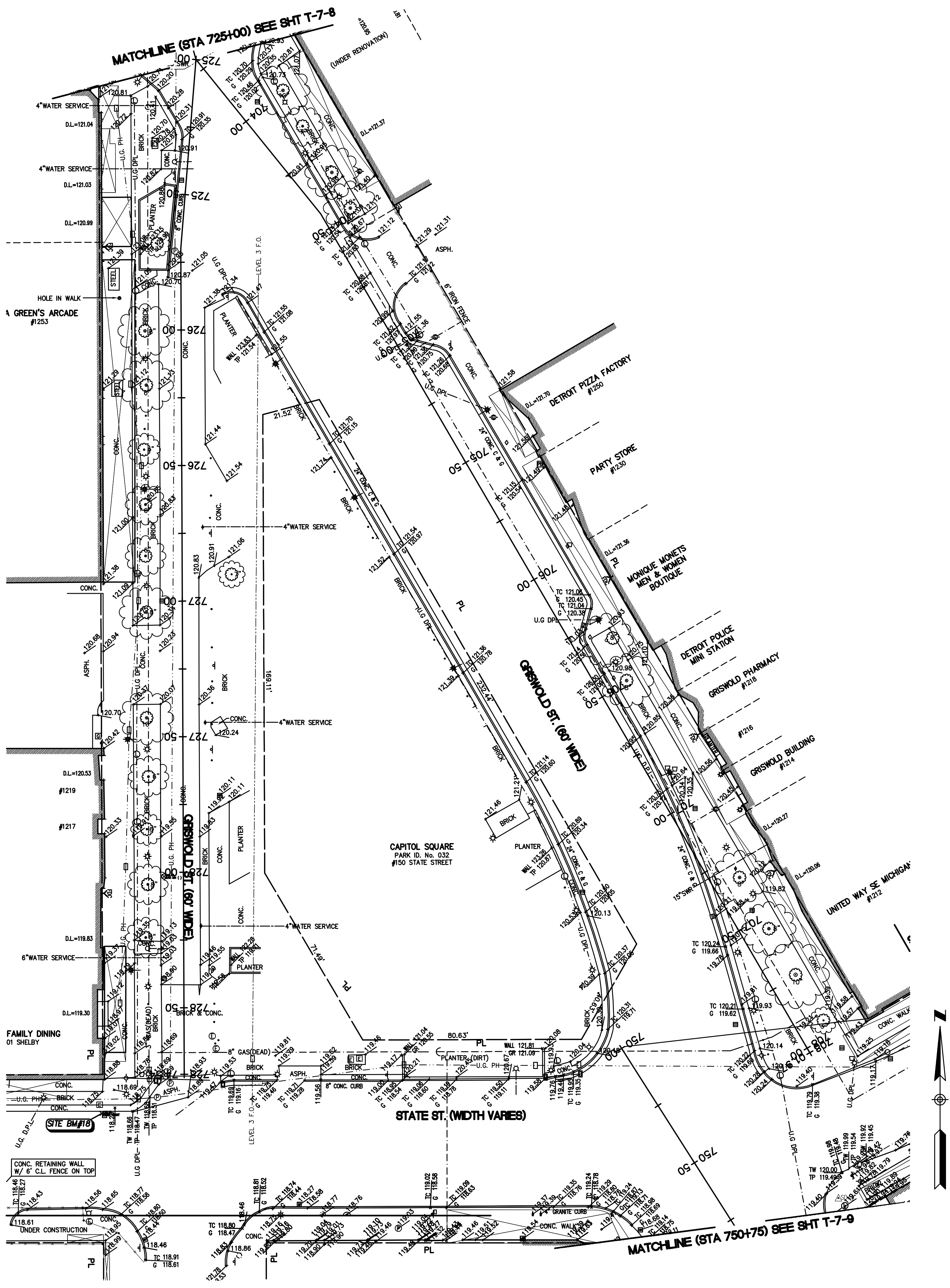
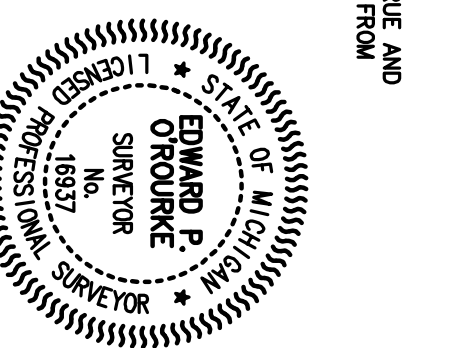

- SURVEY LEGEND**
- MANHOLE
 - CATCH BASIN
 - ⊖ SEWER CLEAN OUT
 - ⊕ GAS METER
 - ⊕ GAS SHUT OFF VALVE
 - ⊕ VALVE BOX
 - ⊕ GATE VALVE & WELL
 - ⊕ WATER SHUT OFF VALVE
 - ⊕ FIRE HYDRANT
 - ⊕ HAND HOLE
 - ⊕ ELECTRIC RISER OR METER
 - ⊕ TELEPHONE RISER
 - ⊕ CABLE TV RISER
 - ⊕ UTILITY POLE
 - ⊕ UTILITY POLE W/ LAMP EXTENSION (ARROW INDICATES DIRECTION OF ARM)
 - ⊕ LIGHT POLE
 - ⊕ LIGHT POLE WITH LAMP EXTENSION
 - ⊕ TRAFFIC SIGNAL
 - ⊕ POLE WITH TRAFFIC SIGNAL (OVER ROAD)
 - ⊕ DAY WIRE
 - ⊕ GROUND LEVEL OR DECORATIVE LIGHTING
 - ⊕ FLAG POLE
 - ⊕ PHONE OR PHONE BOOTH
 - ⊕ CHAIN LINK FENCE (CL)
 - ⊕ METAL OR CONC. POST
 - ⊕ MAILBOX
 - ⊕ SIGN
 - ⊕ PARKING METER
 - ⊕ BENCH
 - ⊕ PROPERTY LINES
 - ⊕ ABUTMENTS
 - ⊕ STUMP
 - CONSPICUOUS TREE
 - DECIDUOUS TREE
 - DECIDUOUS SHRUB
 - * CONSPICUOUS SHRUB
 - ⊕ TRAVERSE POINT
 - ⊕ SIA POINT NO.
 - ⊕ SPOT ELEVATION
 - TC TOP OF CURB ELEVATION
 - TE TOP OF GUTTER ELEVATION
 - TE TOP OF PAVEMENT ELEVATION
 - EM EDGE OF METAL ELEVATION
 - TW TOP OF WALK ELEVATION
 - OR GROUND ELEVATION
 - U.G. UNDERGROUND
 - F.O. FIBER OPTIC
 - CONC. CONCRETE
 - ASPH. ASPHALT
 - L.S. LAUNDRY
 - F.F. FINISH FLOOR ELEVATION
 - D.L. DOOR LEAD ELEVATION