

DEPARTMENT OF PUBLIC WORKS DETROIT  
CITY ENGINEER'S OFFICE - DIVISION OF PAVING DESIGN  
STREET PAVING PLAN

CARD NO.  INDEX TOPO. NO. 78 108  
 RECORD NO.

NAME OF STREET FROM 36.34 S. OF S.P.L. KIRKWOOD TO S.P.L. OF DAYTON  
 ASSGN. NO. 290-3  
 SHEET 1 OF 1 SHEETS

TYPE OF PAVEMENT 8: 6: 8 ONE COURSE CONCRETE, INTERGRAL CURB WIDTH 30

REQUESTED BY APPLICATION 248-123 DATE 4-29-46

SEWER REVISIONS

C-323A	C-380	C-733
C-323B	C-381	C-734
C-323C	C-382	C-735
C-323D	C-383	C-736
C-323E	C-384	C-737
C-323F	C-385	C-738
C-323G	C-386	C-739
C-323H	C-387	C-740
C-323I	C-388	C-741
C-323J	C-389	C-742

NOTE: BEFORE STARTING CONSTRUCTION CONTRACTOR MUST CHECK WITH UTILITIES FOR LOCATIONS OF EXISTING STRUCTURES WHETHER OR NOT INDICATED ON PLANS

PLAN SCALE DISTORTED  
 LOTS & ALLEYS - 1" = 100'  
 STREET WIDTHS - 1" = 50'

DRAINAGE COMPLETED  
 PAVING COMPLETED

QUANTITIES	ESTIMATED	FINAL
EXCAVATION CU. YDS.	LOTS	CITY
NEW CURB LIN. FT.	LOTS	CITY
PAVING SQ. YDS.	LOTS	CITY
SIDEWALK SQ. FT.	LOTS	CITY
MANHOLES ADJUST	LOTS	CITY
BASINS ADJUST	LOTS	CITY
SEWER 12" LIN. FT.	LOTS	CITY
SEWER 18" LIN. FT.	LOTS	CITY

HOR. SCALE 1" = 100'	BOOK 1576	PAGE 68
VERT. SCALE 1" = 2'	DATE DRAWING 8-28-47	46
PLAN	W.C. PROFILE	W.C. COMPUTED
CHECKED S.S.	GRADE	LENGTH
1407	251	70362
1201	1	60
1527	251	16362
TOTAL 2L	LENGTH	CITY
1527	251	16362
COST ADVERTISING	LOTS	
COST INSPECTION		

DESIGNED BY S.A.T. SWITZ  
 DRAWN BY W.I. COFFERT  
 CHECKED BY J.A.S. ROBERTSON  
 APPROVED J. J. [Signature]  
 ENGINEER OF STREETS  
 ASSIST. CITY ENGINEER

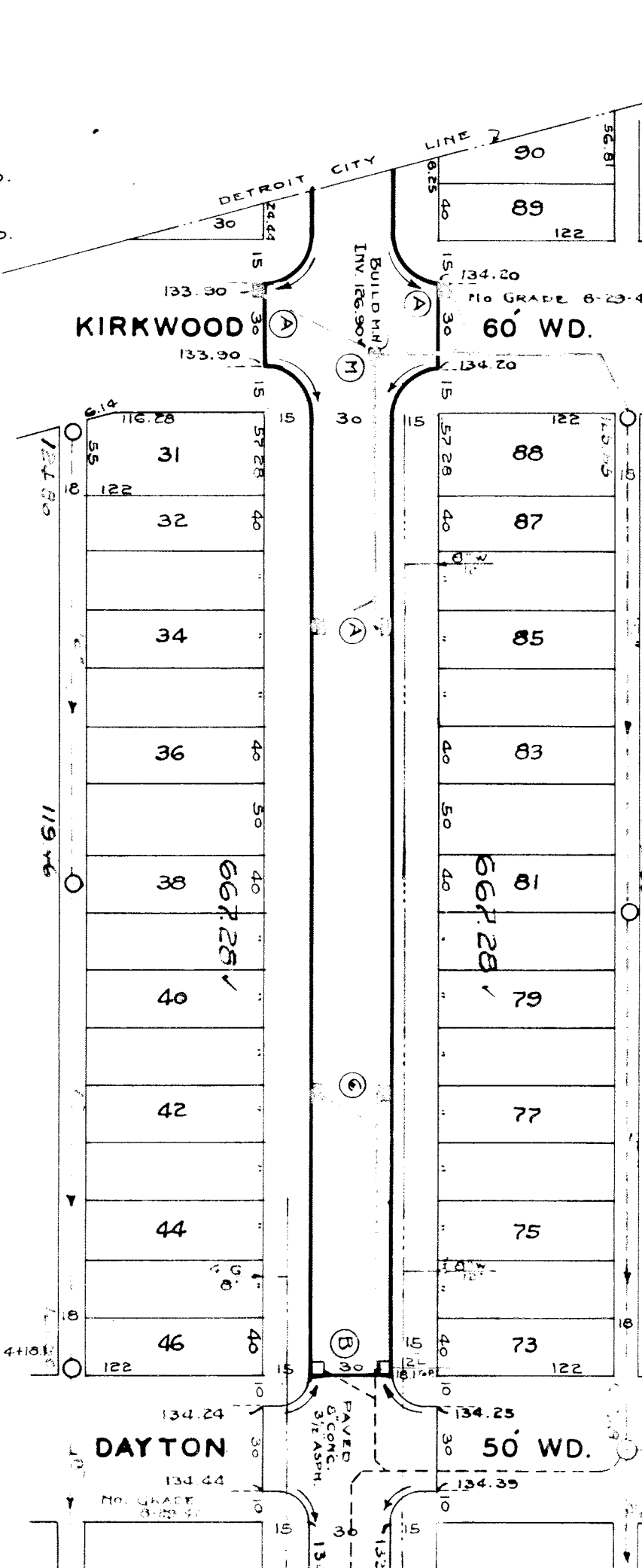

134.24gp 133.94gp  
 134.24gp 134.34gp  
 134.04 134.34  
 133.94 134.34  
 133.84 134.24  
 133.94 134.14  
 133.94 134.04  
 133.94 134.04  
 133.94 134.04  
 134.14 134.04  
 133.95 Ret. 133.92  
 134.24 Curb 134.25

12" L. Basin 4+16.1

APPLICATION No. 248-123

- BENCH MARKS
- PL. B.M. 108-250A N.E. Cor. Evergreen + Kirkwood 133.496 ✓
  - B.M. Arrow Hgd. N.W. Cor. Grandville + Kirkwood 137.45 ✓
  - B.M. Arrow Hgd. S.W. Cor. Grandville + Dayton 137.22 ✓
  - PL. B.M. 108-251, N.E. Cor. Auburn + Paul 135.232 ✓
- Ar-A Construct 4 std. 18"x12" V Basins + connect to exist sewer as shown.  
 Contractor to furnish std. flat top pipe, catch basins, frames, gaskets.  
 Ar-B Adjust tops of 2 exist basins.  
 Ar-C Build 1 std. MH complete.  
 Contractor shall backfill all sewer trenches with approved sand-gravel material.  
 Ar-D Construct 2 modified 18"x12" V Basins using one foot length of 18" straight pipe over the 'Y' to use shallow outlet.

