

DEPARTMENT OF PUBLIC WORKS DETROIT

CITY ENGINEERS OFFICE - DIVISION OF PAVING DESIGN

STREET PAVING PLAN

FERGUSON

NAME OF STREET: S.P.L. OF VASSAR  
 FROM: N.P.L. OF ST. MARTINS  
 SHEET NO. 1 OF 1  
 SHEETS

INDEX, T.O.P. NO. 63105  
 RECORD NO. 63105

DESIGNED BY	L. G. VAN TUYL
DRAWN BY	KANSIMAN
TRACED BY	HK
CHECKED BY	Simon - R. R. Brown
APPROVED BY	<i>[Signature]</i>
DATE DRAWING	4-23-49
DATE OF FIELD WORK	4-23-49

NO. SCALE	1/2" = 2'	NO. SCALE	1/2" = 100'
PLAN	HK	PROFILE	HK
CHECKED	LA.V.T.	CHECKED	D.B.
CITY	13	CITY	13
TOTAL	1392.00	TOTAL	696.00

QUANTITIES	ESTIMATED	FINAL
EXCAVATION CU. YDS.	649	410
NEW CURB LIN. FT.	1963	410
PAVING 6" G. B. SQ. YDS.	674	13
72665 4" x 12"	815	13
SIDEWALK 4" SQ. FT.	15	13
MANHOLES 42"	1	1
ADJUST COARSE CONSTRUCT	1	1
ADJUST 12" x 18" Y. C.B.	1	1
18" x 18" Y. C.B.	1	1
6" CONC. 18" x 18" Y. C.B.	1	1

SEWER	REVISIONS	DATE
	OLD MAP	9-3-43
SUPPLEMENTARY DETAILS		
C-334A	C-587	C-739B
C-325	C-524	C-733
C-326A	C-585	C-739
C-327	C-586	C-739A

NOTE: BEFORE STARTING CONSTRUCTION CONTRACTOR MUST CHECK WITH UTILITIES FOR LOCATIONS OF EXISTING STRUCTURES WHETHER OR NOT INDICATED ON PLANS.

PLAN SCALE DISTORTED

LOTS & ALLEYS 1/2" = 100'

STREET WIDTHS 1" = 50'

DRAINAGE COMPLETED 11-23-49

PAVING COMPLETED C.C. 11-23-49

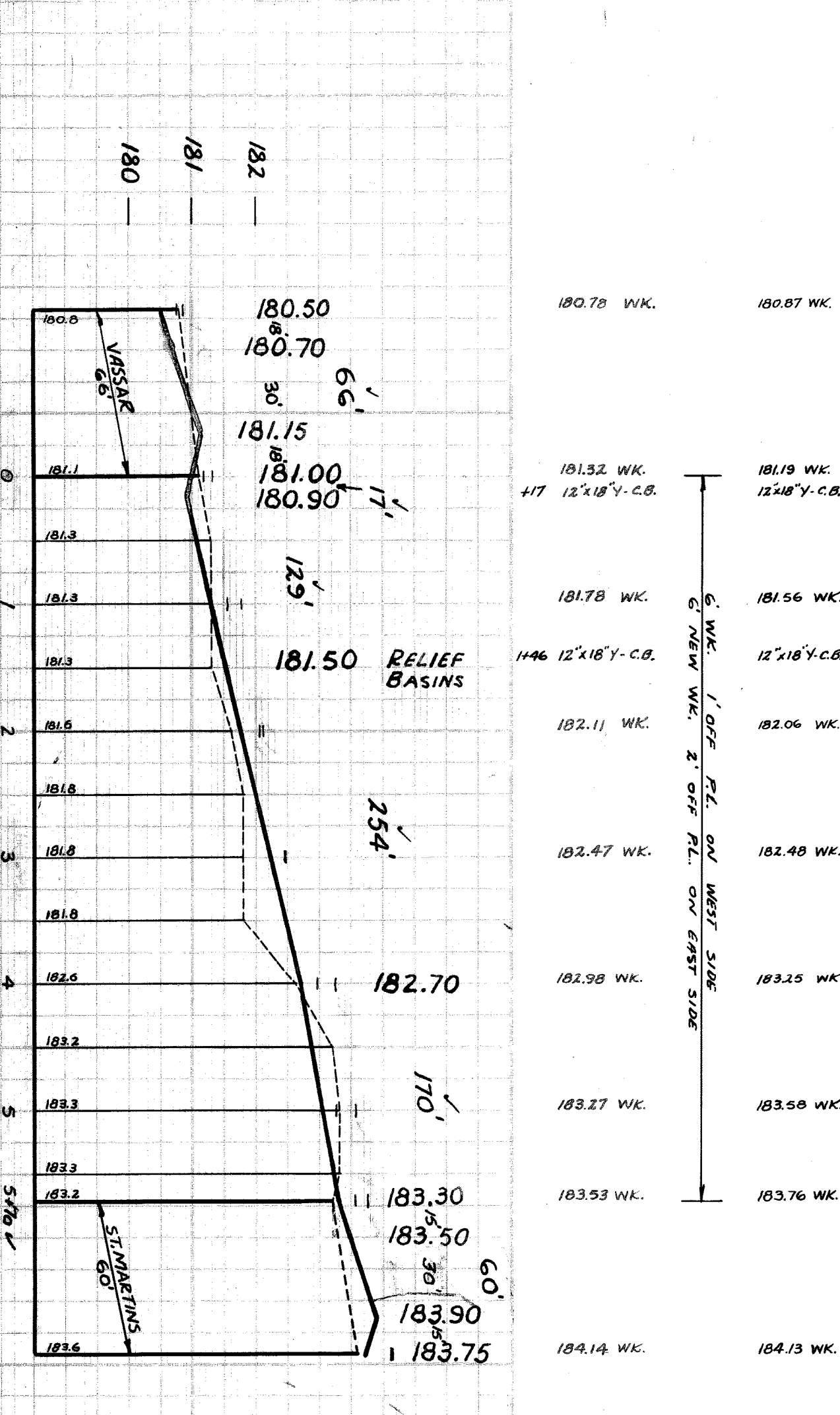
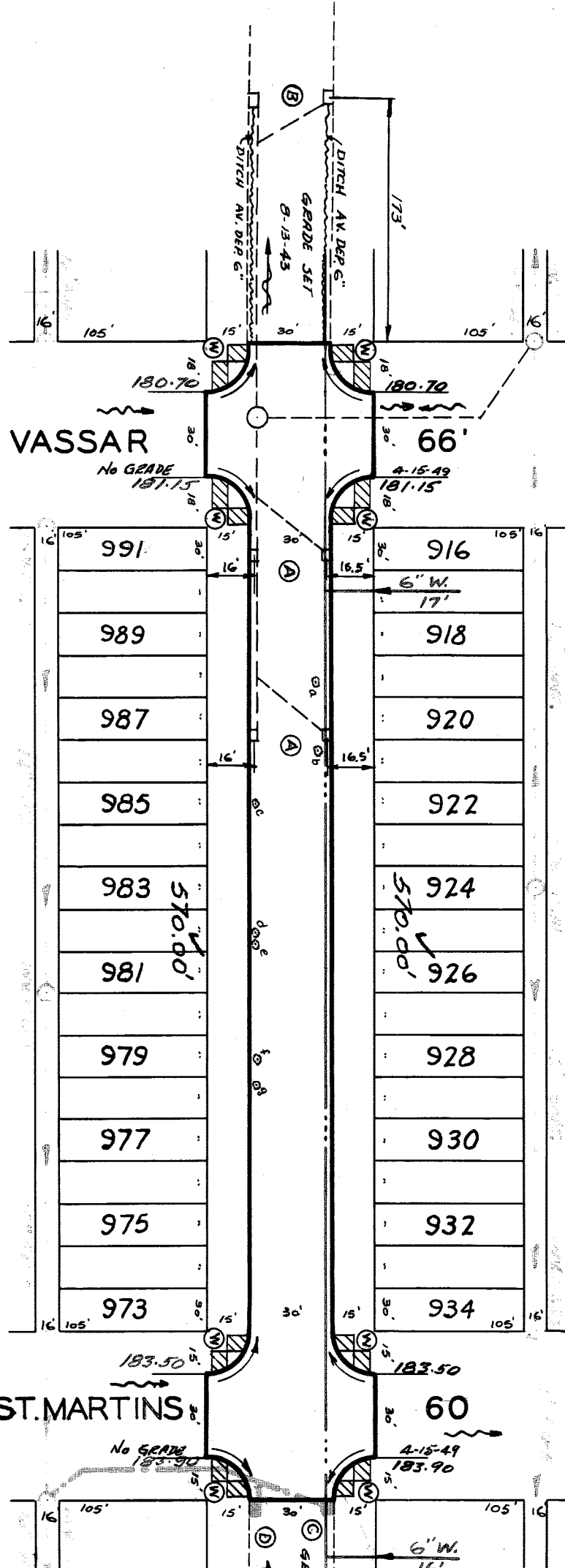

NO.	SIZE	DISK FORM & PL.
a	4-6"	39.0
b	2-4" x 2-6"	40.5
c	1-8"	17.5
d	1-8"	16.5
e	1-10"	17.5
f	1-6"	18.0
g	1-5"	17.5

- NOTE -
- ALL CURBS WITHIN STREET INTERSECTIONS TO BE SEPARATE TYPE II OR INTEGRAL TYPE III (UNLESS OTHERWISE NOTED)
  - AT (M) CONSTRUCT 26 SQ. FT. OF STD. 4" CONCRETE WALK.
  - AT (A) ADJUST TOPS OF 4 EXISTING 18"x12" Y. BASINS USING FLAT TYPE FRAMES & GRATES.
  - AT (B) ADJUST TOPS OF 2 EXISTING CATCH BASINS, IF NECESSARY, AT UNIT COST FOR CATCH BASIN ADJUSTMENTS.
  - AT (C) CONSTRUCT 1 MODIFIED 12" DOME TYPE "L" BASIN COMPLETE, WITH 1/2 TRAP & CONNECT TO EXISTING OUTLETS AS SHOWN. BASIN 1/2 TRAP TO BE ENCASED IN 6" OF CLASS "C" CONCRETE.
  - AT (D) CONSTRUCT 1 STD. 18"x12" Y. DOME TYPE BASIN COMPLETE, & CONNECT TO EXISTING OUTLETS AS SHOWN.
  - CONTRACTOR SHALL CONSTRUCT UNIFORM WHERE SHOWN ON PLAN TO DEPTH INDICATED, OR AS REQUIRED IN FIELD. 26 SQ. YDS. INCLUDED UNDER EXCAVATION TOTALS FOR COSTS.
  - ADJUST TOPS OF 2 WATER MANHOLES, MANHOLE.
  - ADJUST TOP OF 1 EXISTING SEWER MANHOLE.
  - RECONSTRUCT CONE OF 1 EXISTING SEWER MANHOLE.
  - BACKFILL SEWER PIPE TRENCHES UNDER PROPOSED PAVEMENT WITH APPROVED SAND-GRAVEL MATERIAL; ELSEWHERE FILL & TAMP WITH APPROVED EARTH LAYERS AS REQUIRED.
  - CONTRACTOR TO GRUB & REMOVE 13-4"x12" TREES AS INDICATED ON PLAN, AT UNIT COST PER TREE.
  - DIET ROADWAYS AT ENDS OF PAVEMENT SHALL BE GRADED BACK & STONED 6" DEEP UNIFORMITY, FOR A DISTANCE OF 10' TO MEET EXISTING GRADES, REGULARLY. INCLUDED UNDER EXCAVATION TOTALS FOR COST.
  - CONTRACTOR SHALL FURNISH ALL NECESSARY MATERIALS, INCLUDING CASTINGS & SHALL Haul ALL SALVAGEABLE MATERIALS TO DRW. YARD AT STATE FINE & JOHN G.

93937