

Lewis & Clark

A-3030 B.P. 1-31-38

148.42 ✓
147.17 ✓
145.81 ✓
145.54 ✓
145.56 ✓
143.57 ✓
Installed 3-22-38

DENCH MARKS
ON Top Plug - N.W. Cor. NEVADA & DWYER
ON Top Plug - S.E. Cor. STOCKTON & DWYER
ON Top Plug - S.W. Cor. HILDAL & DWYER
ON Top Plug - S.E. Cor. ROBINWOOD & DWYER
ON Top Plug - S.E. Cor. 7 MILE ROAD & DWYER
Dwyer & 7 Mile Road On N.E. Cor. A + On East End Of A Doorstep To The Upstairs Entrance To 619 143.57

DEPARTMENT OF PUBLIC WORKS DETROIT
CITY ENGINEER'S OFFICE DIVISION OF PAVING DESIGN
STREET PAVING PLAN
NAME OF STREET: **DWYER** (Est. 8-5-39)
FROM: **NEVADA**
TO: **SEVEN MILE RD**
TYPE OF PAVEMENT: CLASS B BITUMAC. 2 1/2 IN. AGG. WITH 26 4 30
586.52 FORCED PAVING C.C. PROC. 7-5-39

Table with columns: PLAN, CHECKED, DATE, PROFILE, GRADE, CONSUMED, etc.

Table with columns: QUANTITIES, CITY, LOTS, etc.

Table with columns: CIRCLES, CITY, LOTS, etc.

Table with columns: CITY, LOTS, etc.

5'-6" TYPICAL CLASS B UNDER CONST.
W.P.A. 504*

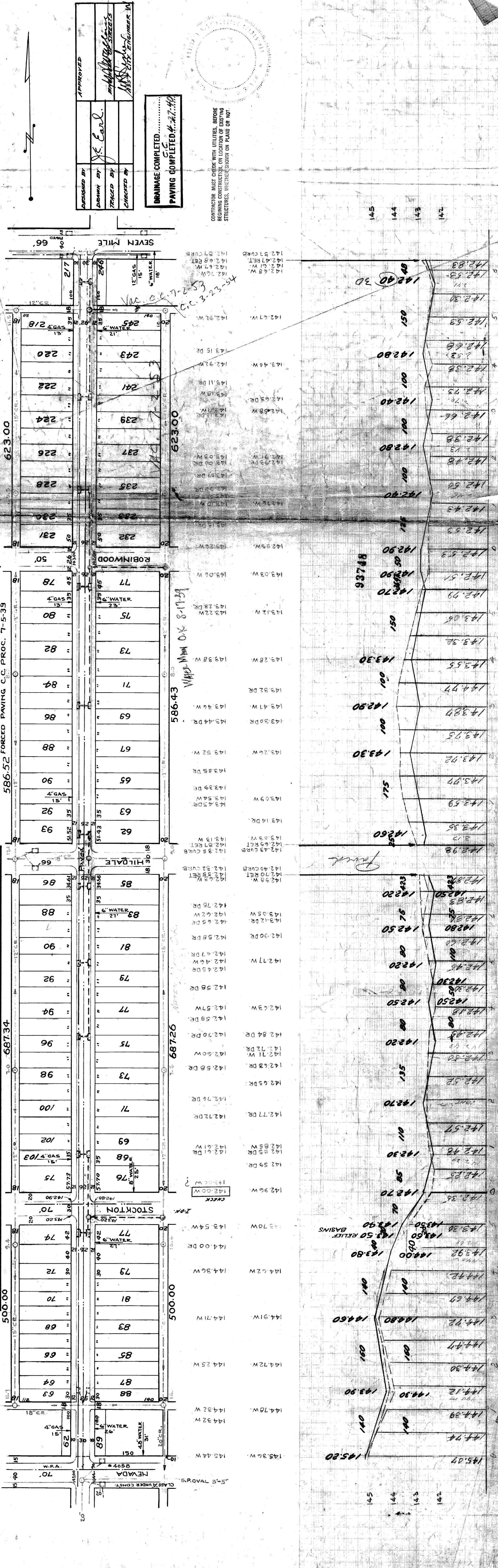

APPROVED
DESIGNED BY: J.C. Earl
DRAWN BY: J.C. Earl
TRAILED BY: J.C. Earl
CHECKED BY: J.C. Earl
DRAINAGE COMPLETED 4-27-38
PAVING COMPLETED 4-27-38

CONTRACTOR MUST CHECK WITH UTILITIES, BEFORE BEGINNING CONSTRUCTION ON LOCATION OF EXISTING STRUCTURES, WHETHER SURFACE OR NOT.

