

REVISED BY	<i>O.D. M.A.F. 2-17-41</i>	
REVISION	<i>QUANTITY CHANGE DUE TO INCREASE IN PAVEMENT LENGTH 11-19-53 C.B.</i>	
DATE	<i>11-19-53</i>	
SUPPLEMENTARY DETAILS		
C-324A	C-587	C-739B
C-325	C-524	C-733
C-326A	C-585	C-739
C-327	C-586	C-739A
C-1608		

NOTE:
BEFORE STATING CONSTRUCTION CONTRACTOR MUST CHECK WITH UTILITIES FOR LOCATIONS OF EXISTING STRUCTURES WHETHER OR NOT INDICATED ON PLANS.

PLAN SCALE DISTORTED

LOTS & ALLEYS 1"=100' ✓

STREET WIDTHS 1"=50' ✓

By *Paving Contractor*
DRAINAGE COMPLETED 6-6-41 & 8-6-53

PAVING COMPLETED C.C. 12-15-53

QUANTITIES		ESTIMATED		FINAL	
QUANTITY	UNIT	AMOUNT	CITY	AMOUNT	CITY
1768	48	343	48		
4075	137	137	137		
	10	10	10		
	626	626	626		
	1	1	1		
	6	6	6		
	1	1	1		
	1	1	1		
	1	1	1		
	1	1	1		
	1	1	1		

DESIGNED BY	J. FLANIGAN
DRAWN BY	N. KAWMAS
CHECKED BY	Fickson Dehm
APPROVED BY	<i>W. J. Schaeffer</i> ENGINEER
DATE	2-11-53
DATE	3-19-53
DATE	11-19-53

DESIGNED BY J. FLANIGAN
DRAWN BY N. KAWMAS
CHECKED BY Fickson Dehm
APPROVED BY *W. J. Schaeffer*
ENGINEER

DEPARTMENT OF PUBLIC WORKS DETROIT
CITY ENGINEERS' OFFICE - DIVISION OF PAVING DESIGN
STREET PAVING PLAN
DECATUR

CONTRACT NO. PW R257W

FROM 44643'S. OF S.P.L. WESTFIELD -
TO 957'S. OF S.P.L. W. CHICAGO

ONE COURSE CONCRETE - INTERNAL CURB
8" UNIFORM AT STREET INTERSECTIONS EXCEPT AS NOTED

CONTRACT APPROVED C.C.
PET. # 4480 IRVIN F. STURM 1-20-53

RECORD NO. 53-C
INDEX TOPO NO. 70' 82'

NAME OF STREET: 44643'S. OF S.P.L. WESTFIELD -
STREET: 957'S. OF S.P.L. W. CHICAGO

SHEET 1 OF 1 SHEETS
SECTION NO. 4480
MOUTH 30' 8.36'

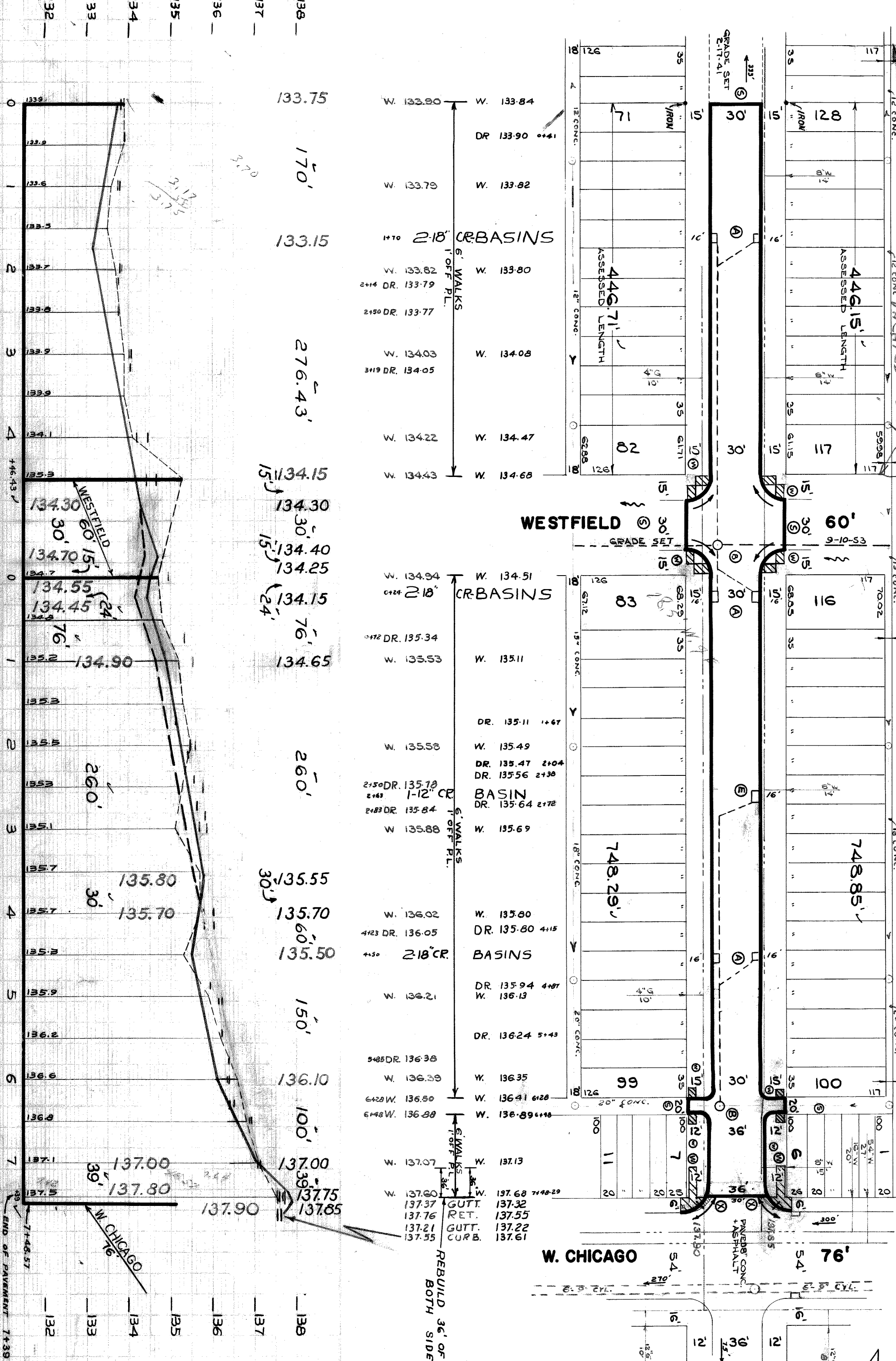

NOTE

FOR SYMBOLS (A) ETC. SEE STD DETAIL DRAWING C-327

AT (X) WIDEN EXISTING RETURNS AT W. CHICAGO INTERSECTION, TO 36' USE 8" UNIF. CONC. BASE + 3 1/2" ASPH. + 5" IN WALKS 5.0' OFF P.L.

QUANTITY CHANGE 11-19-53
DUE TO INCREASE IN PAVEMENT LENGTH
CITY

EXCAVATION	+5 CU YDS
8" 6" UNIF + 3 1/2" ASPH	+39 SQ YDS
-6" UNIF + 3 1/2" ASPH	-6 SQ YDS
-20 L.F.T. C.B.	-20 L.F.T.

PRELIMINARY FIELD SURVEY MADE 4-2-53

93679