

CONTRACT NO. PW 1840F

DEPARTMENT OF PUBLIC WORKS DETROIT
CITY ENGINEER'S OFFICE - DIVISION OF PAVING DESIGN
STREET PAVING PLAN

ASSIGN NO. 325 AW10
PETITION NO. _____
NAME OF STREET SEVEN MILE RD.
FROM 40' W.O.F. EVERGREEN
TO W.P.L. OF WESTMORELAND

INDEX TOP NO. 72
NO. 114
RECORD NO. 40' W.O.F.
SHEET 8 OF 16 SHEETS
WIDTH 2-12' WIDENING

DESIGNED BY W. OWENS
DRAWN BY
TRACED BY
CHECKED BY
APPROVED
ENGINEER OF SURVEY
ASSISTANT ENGINEER

Table with columns: HOR. SCALE, VER. SCALE, BOOK, LEVELS, DATE, PROFILE, GRADE, UNCHECKED, CHECKED, CITY, TOTAL, DIST. ADVERTISING, COBT INSPECTION.

Table with columns: QUANTITIES, ESTIMATED, FINAL, CITY, LOTS, CITY, LOTS, CITY, LOTS.

NOTE: BEFORE STARTING CONSTRUCTION CONTRACTORS MUST CHECK WITH UTILITIES FOR LOCATIONS OF EXISTING STRUCTURES WHETHER OR NOT INDICATED ON PLANS.
PLAN SCALE DISTORTED
LOTS & ALLEYS: 1" = 40'
STREET WIDTHS: 1" = 40'
DRAINAGE COMPLETED 10-10-52
Paving Widening 2-12 Streets N+52
PAVING COMPLETED C.C. 10-14-52

Table with columns: SEWER, REVISIONS, SUPPLEMENTARY DETAILS.

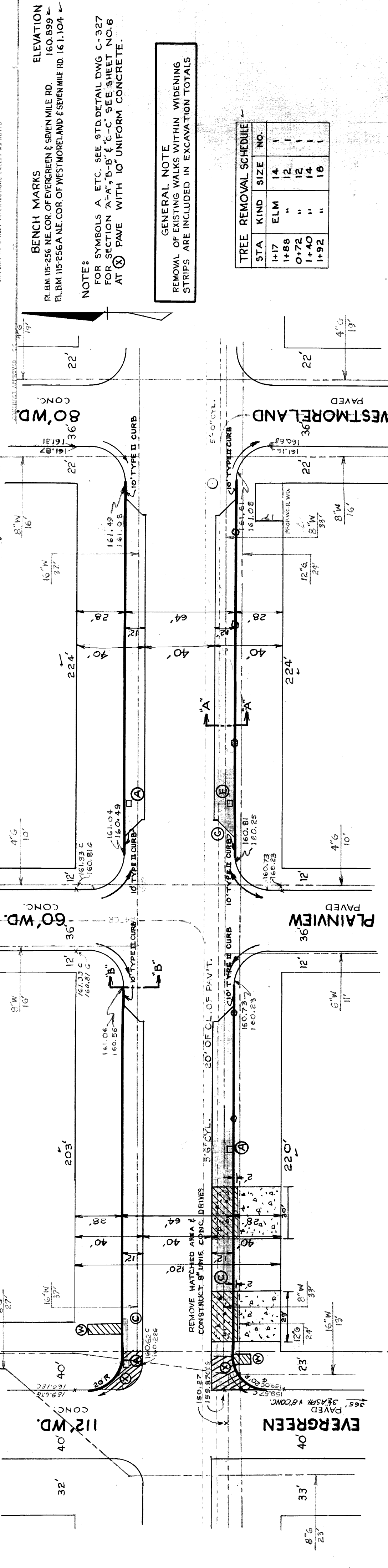

BENCH MARKS
P.L.M. 115-256 N.E. COR. OF EVERGREEN & SEVEN MILE RD. 160.899
P.L.M. 115-256A N.E. COR. OF WESTMORELAND & SEVEN MILE RD. 161.104

NOTE:
FOR SYMBOLS A, ETC. SEE STD. DETAIL DWG C-327
FOR SECTION "A-A", "B-B" & "C-C" SEE SHEET NO. 6
AT (X) PAVE WITH 10" UNIFORM CONCRETE.

GENERAL NOTE
REMOVAL OF EXISTING WALKS WITHIN WIDENING STRIPS ARE INCLUDED IN EXCAVATION TOTALS

TREE REMOVAL SCHEDULE table with columns: STA, KIND, SIZE, NO.

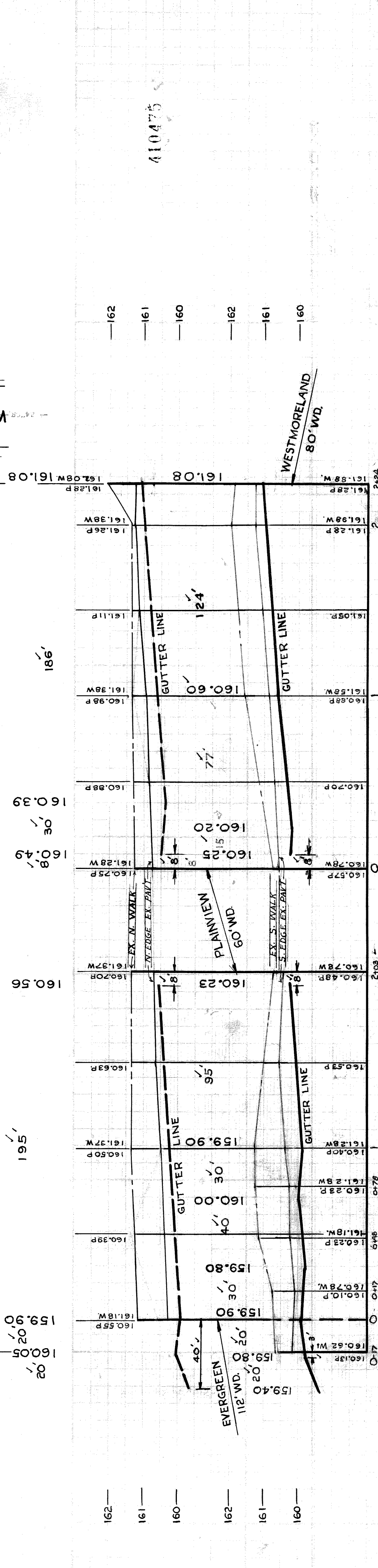

410475