

E885075

EASEMENT AGREEMENT

LI15386 PA941

THIS AGREEMENT, effective this 30th day of March, 1964, between the GRAND TRUNK WESTERN RAILROAD COMPANY, a Michigan corporation, hereinafter called the party of the first part, and CITY OF DETROIT, a municipal corporation of the State of Michigan, hereinafter called the "City", party of the second part.

W I T N E S S E T H :

RECORDED JUL 9 1964 AT 1249 P
BARNARD J. YOUNGBLOOD, Register of Deeds

WAYNE COUNTY 26. MICHIGAN

That said party of the first part, for and in consideration of the sum of Two Hundred Fifty Dollars (\$250.00) and other valuable consideration to it in hand paid, the receipt whereof is hereby acknowledged, does, by these presents, grant unto said party of the second part, its successors and assigns, an easement for street and municipal purposes over and across its right-of-way and tracks, all within the parcels of land described as follows:

PARCEL 1

A strip of land 70 feet in width across the Grand Trunk Western Railroad 60 foot right-of-way in the City of Detroit, County of Wayne, State of Michigan, described as follows:

BEGINNING at the intersection of the Westerly line of the Grand Trunk Western Railroad and the Southerly line of widened Lafayette Street, one hundred twenty (120) feet in width, said point being forty one and fifty seven hundredths (41.57) feet Easterly of the intersection of the said Southerly line of Lafayette Street widened and the Easterly line of relocated Orleans Street;

THENCE Northerly along the Westerly line of the Grand Trunk Western Railroad right-of-way seventy and seventeen hundredths (70.17) feet;

THENCE Easterly parallel with the Southerly line of widened Lafayette Street Sixty and fifteen hundredths (60.15) feet to the Easterly right-of-way line of the Grand Trunk Western Railroad;

THENCE Southerly along the Easterly line of the Grand Trunk Western Railroad seventy and seventeen hundredths (70.17) feet to the Southerly line of widened Lafayette Street;

E885075

LI15386 PA942

THENCE Westerly along the said Southerly line sixty and fifteen hundredths (60.15) feet to point of beginning.

PARCEL 2

A strip of land 60 feet in width across the Grand Trunk Western Railroad 60 foot right-of-way in the City of Detroit, County of Wayne, State of Michigan, described as follows:

BEGINNING at the intersection of the Westerly line of the Grand Trunk Western Railroad and the Northerly line of widened Larned Street, one hundred twenty (120) feet in width, said point being fifty three and thirty five hundredths (53.35) feet Easterly of the intersection of the said Northerly line of Larned Street widened and the Easterly line of relocated Orleans Street;

THENCE Southerly along the Westerly line of the Grand Trunk Western Railroad right of way sixty and fifteen hundredths (60.15) feet;

THENCE Easterly parallel with the Northerly line of widened Larned Street sixty and fifteen hundredths (60.15) feet to the Easterly right-of-way line of the Grand Trunk Western Railroad;

THENCE Northerly along the Easterly line of the Grand Trunk Western Railroad sixty and fifteen hundredths (60.15) feet to the Northerly line of widened Larned Street;

THENCE Westerly along the said Northerly line sixty and fifteen hundredths (60.15) feet to point of beginning.

PARCEL 3

All that part of Lot 8 of the Plat of the Subdivision of Lot 4, Witherell Farm as recorded in Liber 1, page 19 of Plats, Wayne County Records lying between the north line of Larned Street, 60 feet wide, and a line 60 feet north of and parallel to the north line of said Larned Street, 60 feet wide.

PARCEL 4

All that part of the west 35 feet of Lot 25 of the Plat of the Subdivision of Lot 4 Witherell Farm as recorded in Liber 1, page 19 of Plats, Wayne County Records lying between the south line of Lafayette Avenue, 50 feet wide, and a line 70 feet south of and parallel to the south line of said Lafayette Avenue, 50 feet wide.

DESCRIPTION CORRECT

Engr of Streets

By H. H. Altman 4-3-64

All as shown on Plan A-81-62, dated January 1, 1963,
attached hereto and made a part hereof.

The party of the first part reserves to itself all right,
title and interest in and to the above-described land, which does
not directly interfere with the use of the easement for street
purposes and municipal purposes over and across its right-of-way and
tracks herein granted, including but not limited to the right to
construct, maintain, repair, enlarge, alter, use, operate, remove,
renew, demolish or replace a track or tracks, power, communication
and signal lines and all conduits, wire devices, pole guides,
anchors, accessories, works and appurtenances and any other structure,
fixture or facility, which said right does not directly interfere
with the easement for street purposes and municipal purposes only.

The easement herein granted is for street purposes and
municipal purposes only, including the right to construct and main-
tain the street, the road embankment and drainage facilities, and
said easement shall exist only for so long as the same is required
in connection with said street and municipal purposes. In the event
said easement shall cease to be used for street and municipal
purposes, the party of the second part agrees to execute a release
and discharge of said easement in recordable form.

The terms and conditions of this easement shall be binding
upon the successors and assigns of the parties hereto.

IN WITNESS WHEREOF, the parties hereto have set their hands and seals this 30th day of March, 1964.

Signed, Sealed and Delivered in the Presence of:

F. J. Surmacz
F. J. Surmacz

M. A. Davis
M. A. Davis

M. L. Sanderson
M. L. Sanderson

W. C. Schoenrock
W. C. Schoenrock

George Weible
George Weible

Dorothea Crossman
Dorothea Crossman

GRAND TRUNK WESTERN RAILROAD COMPANY

By H. A. Sanders
H. A. Sanders
131 W. Lafayette Blvd., Detroit 26, Mich.
Its Vice President

Attest:

Forbes B. Henderson
Forbes B. Henderson
131 W. Lafayette Blvd., Detroit 26, Mich.
Its Secretary

CITY OF DETROIT, MICHIGAN

G. J. Saam
Its G. J. Saam
Deputy Controller
1110 City-County Building
Detroit, Michigan 48226

| | |
|---------------|-------------------------|
| O.T.W. APPROV | |
| <u>WBN</u> | LEGAL DEPT. |
| <u>FSH</u> | AS TO FORM |
| <u>TR</u> | CHIEF ENGR. |
| | REAL ESTATE & TAX DEPT. |
| | SUPT. OF COMMUNIC. |

APPROVED AS TO FORM AND EXECUTION SUBJECT TO APPROVAL AND CONFIRMATION BY COMMON COUNCIL

[Signature]
Acting Corporation Counsel

CONFIRMED BY THE COMMON COUNCIL

JUN 23 1964

[Signature]
DEPUTY CITY CLERK

THIS INSTRUMENT WAS DRAFTED BY R. P. CO... 131 W. S... LAFAYETTE BLVD. DETROIT 26, MICHIGAN

STATE OF MICHIGAN }
COUNTY OF WAYNE } SS.

On this 30th day of March, 1964, before me personally appeared H. A. SANDERS and FORBES B. HENDERSON, to me personally known, who being by me severally duly sworn, did say that they are, respectively, the Vice President and the Secretary of the GRAND TRUNK WESTERN RAILROAD COMPANY, a corporation created and existing under the laws of the State of Michigan and that the seal affixed to the foregoing instrument is the corporate seal of the said corporation, and that the said instrument was signed and sealed in behalf of said corporation by authority of its Board of Directors; and the said H. A. SANDERS and FORBES B. HENDERSON do severally acknowledge the said instrument to be the free act and deed of the said corporation.

Walter C. Schoenrock
Notary Public, Wayne County, Michigan

My commission expires:

WALTER C. SCHOENROCK
Notary Public, Wayne County, Mich.
My Commission expires: Dec. 31, 1967

STATE OF MICHIGAN }
COUNTY OF WAYNE } SS.

On this 21st day of April, 1964, before me personally appeared B. J. Sloan, who being by me duly sworn, did say that he is Deputy Controller of the City of Detroit, County of Wayne, State of Michigan, and B. J. Sloan hereby acknowledges said instrument to be the free act and deed of said City.

Dorothea Crossman
Notary Public, Wayne County, Michigan
Dorothea Crossman

My commission expires: Dec. 30, 1966

LI 15386 PA 946

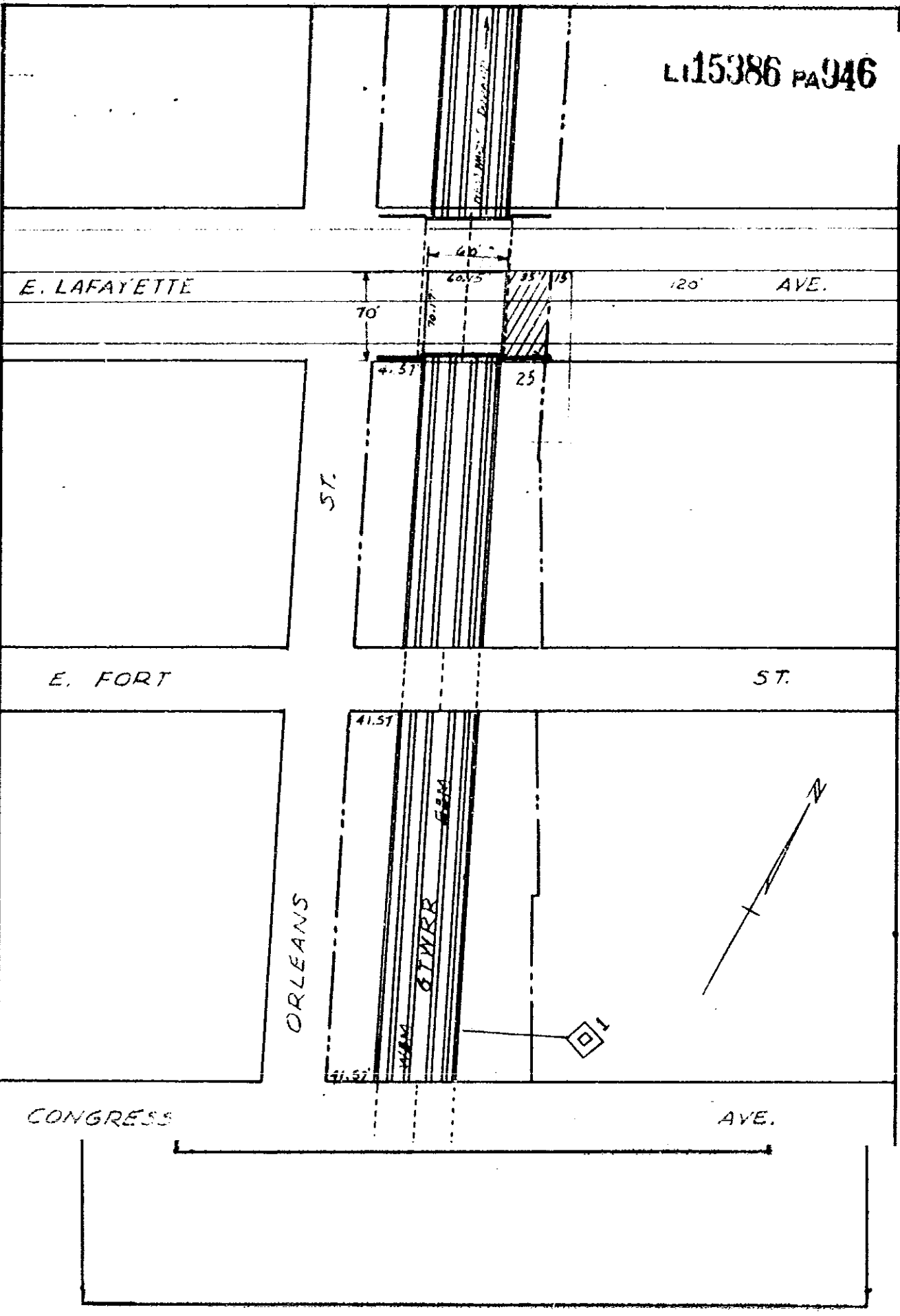

LI15386 PA947

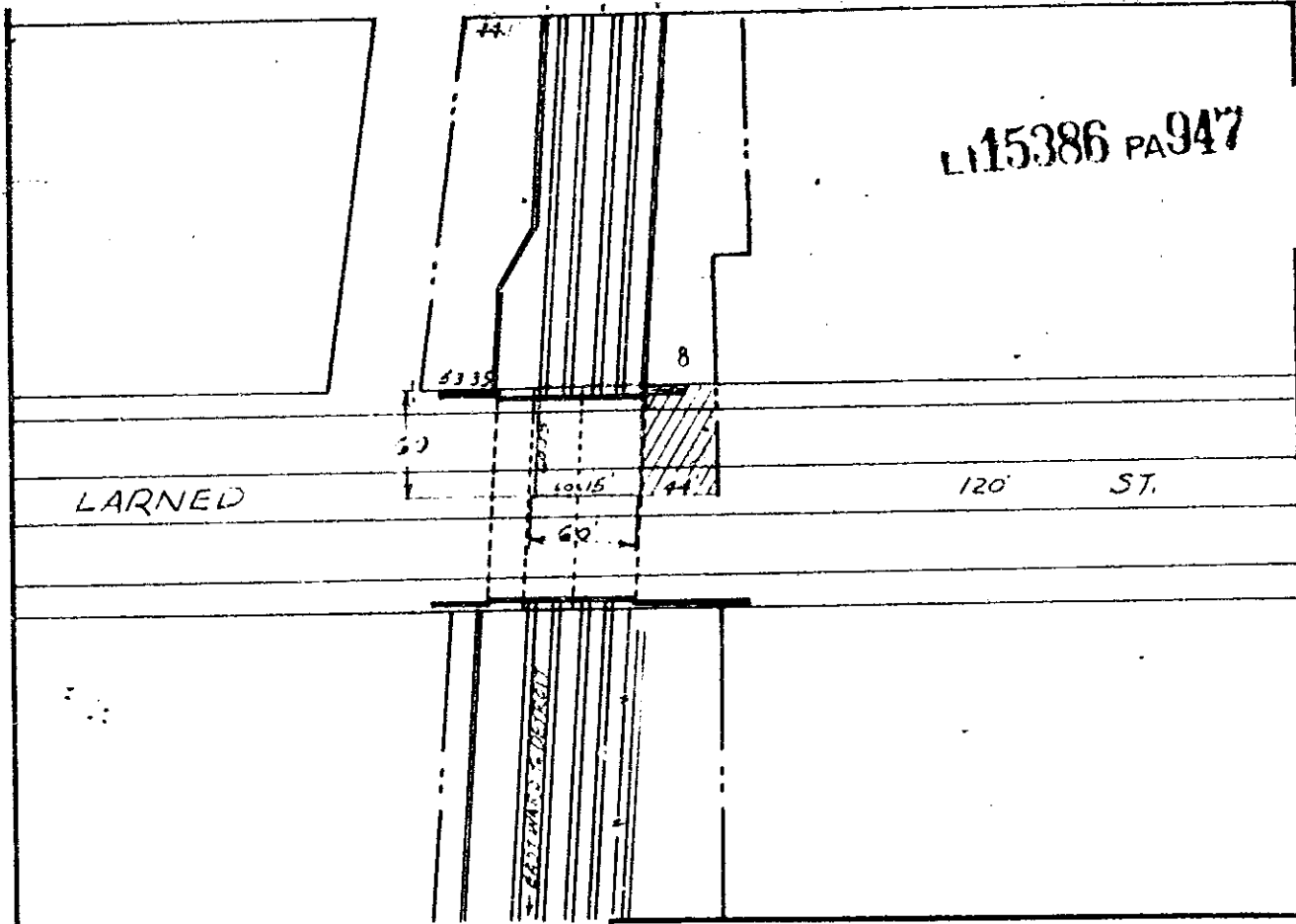

GRAND TRUNK WESTERN RAILROAD COMPANY
Detroit Division Holly Subdivision

DETROIT, WAYNE COUNTY, MICHIGAN

EASEMENT-AGREEMENT

CITY OF DETROIT

Office of Division Engineer
Detroit, Michigan

Scale - 1" = 100'
Plan No. A-81-62

January 1, 1963
File No. 27-220

Boundaries of G.T.W.R.R. Co.
Boundaries of land covered by agreement
Portions of Lot 8 and Lot 25 covered
by agreement

W. H. Hagerstrom
Division Engineer

