

SOUTHFIELD EXP'Y
 CURVE DATA
 Δ = 0° 51' 30"
 ΔD = 0° 26' 00"
 RD = 13,222.11'
 T = 99.04'
 E = 198.08'
 M = 0.337'
 P.I. Sta. 355+09.99

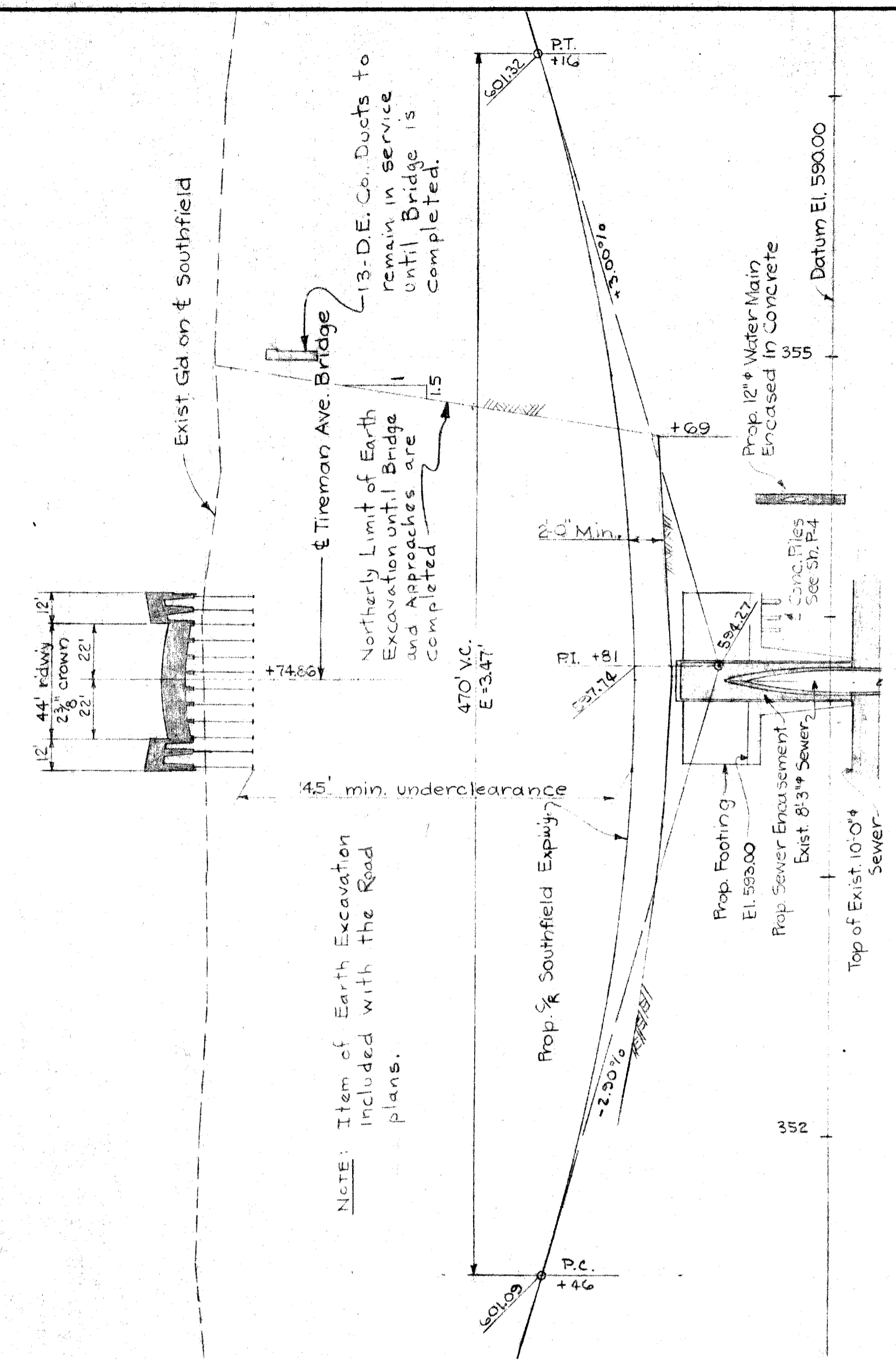

PROFILE ALONG & SOUTHFIELD
 Scales Horiz 1"=40'
 Vert 1"=4'

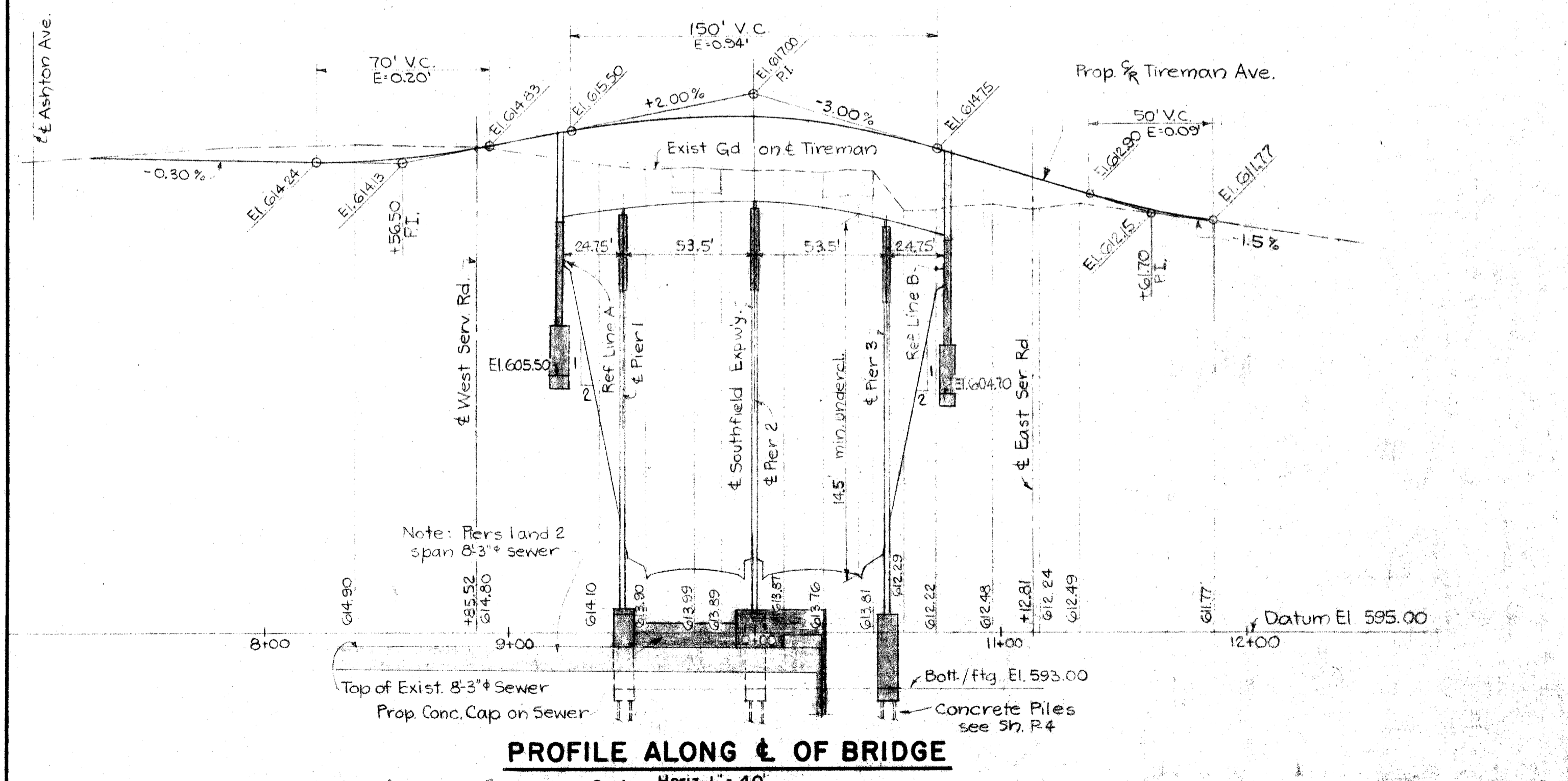
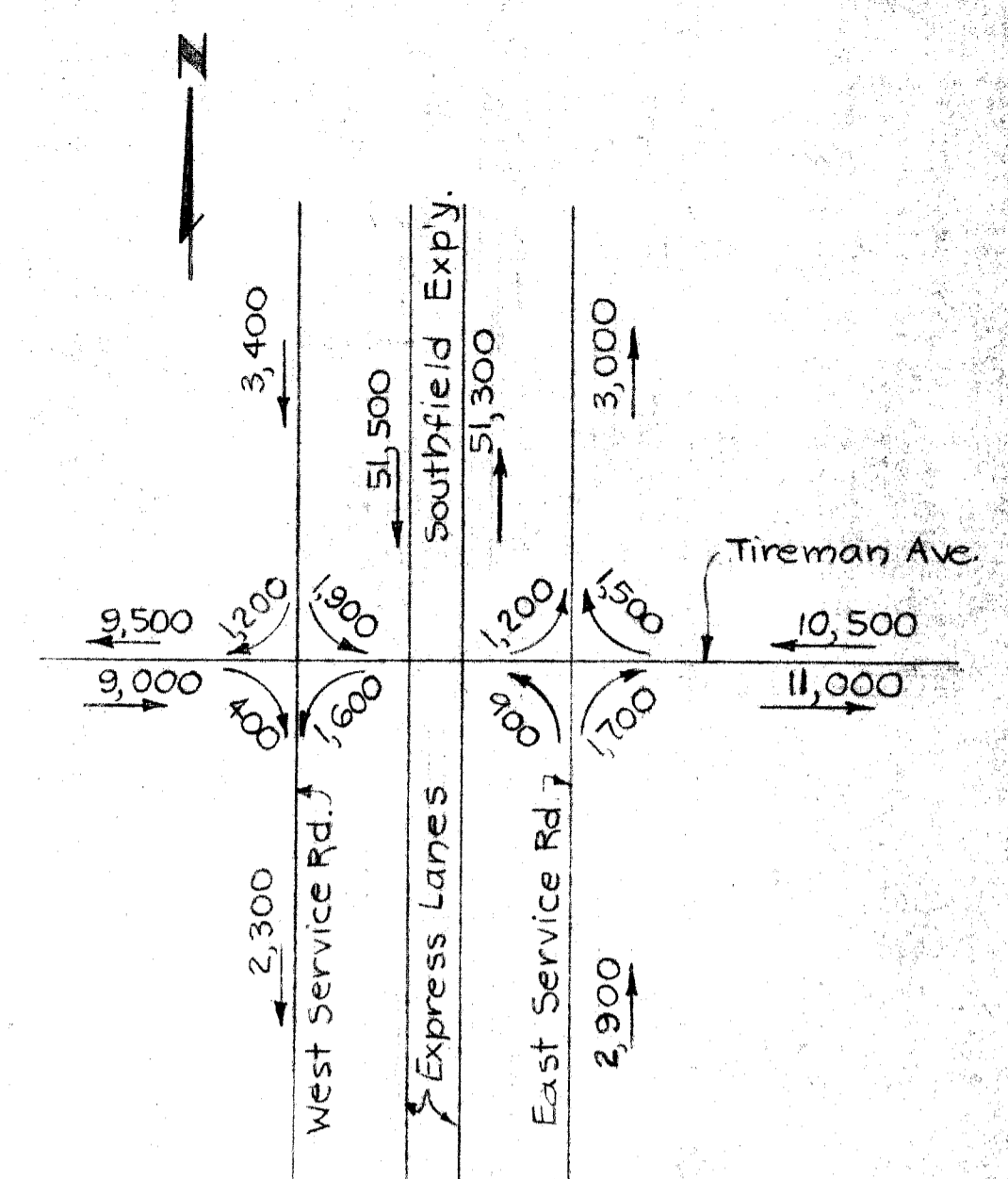

GENERAL NOTES:
 For Bench Marks and Datum Information, refer to Survey Drawing, Sh. No. P-2.
 The work covered by the plans includes the construction of the Proposed Bridge & Pumphouse; Approach Paving & Drainage; Reinf. Conc. Cap for the existing 8'-3" sewer; placing the Slope Paving to the limits shown; and placing the For. Mat'l. Grade A.
 All other work except as noted above is included in the Road Plans.

PRELIMINARY PLAN A

STATE FILE	BRIDGE	B2 of 82-22-17
	ROAD	

2. Checker's Rev. H-4-58 L.M. v. W.G.W.	REVISIONS	DATE	12-12-59
3. Rev. S.F.I.d. Profile 3-26-59 AJP/LM			
4. Added Traffic Diag. 4-6-59 L.M.			
DRAWN BY L.R. Martilla	CHECKED BY W.G. Walker	DATE	12-3-58
TRACED BY	CHECKED BY	DATE	
CORRECT			
APPROVED W. W. Johnson ENGINEER OF DESIGN, STRUCTURES AND EXPRESSWAYS	APPROVED K. D. Merriam ENGINEER OF BRIDGES AND STRUCTURES		
CHIEF ENGINEER			

BOARD OF
WAYNE COUNTY ROAD COMMISSIONERS
 DETROIT, MICHIGAN
 MICHAEL J. O'BRIEN
 WILLIAM E. KREGER
 CHARLES L. WILSON

CONTROL SECTION NO 82192-30404
SOUTHFIELD EXPRESSWAY
TIREMAN AVENUE CROSSING
GENERAL DRAWING
 STATE PROJECT
82192
 COUNTY JOB
909
 ISSUE NO. **4**
 DATE 12-14-59
 SHEET NO.
P1