

CITY OF DETROIT
DEPARTMENT OF PUBLIC WORKS
IN CO-OPERATION WITH
MICHIGAN DEPARTMENT OF TRANSPORTATION
AND
FEDERAL HIGHWAY ADMINISTRATION

THE IMPROVEMENTS COVERED BY THESE PLANS SHALL BE DONE IN ACCORDANCE WITH THE MICHIGAN DEPARTMENT OF TRANSPORTATION 1990 STANDARD SPECIFICATIONS AND SUPPLEMENTAL SPECIFICATIONS

FEDERAL PROJECT NO.STP 9882 (037)
 FEDERAL ITEM NO.RR 1563
 CONTROL SECTION NO. STE 82252 JOB NO. 39765A
 ENHANCEMENT NO. 96-171

INDEX OF SHEETS

1. LANDSCAPE PLAN
2. LANDSCAPE PLAN
3. LANDSCAPE PLAN
4. LANDSCAPE PLAN
5. LANDSCAPE DETAILS
6. PLANTING DETAILS AND NOTES

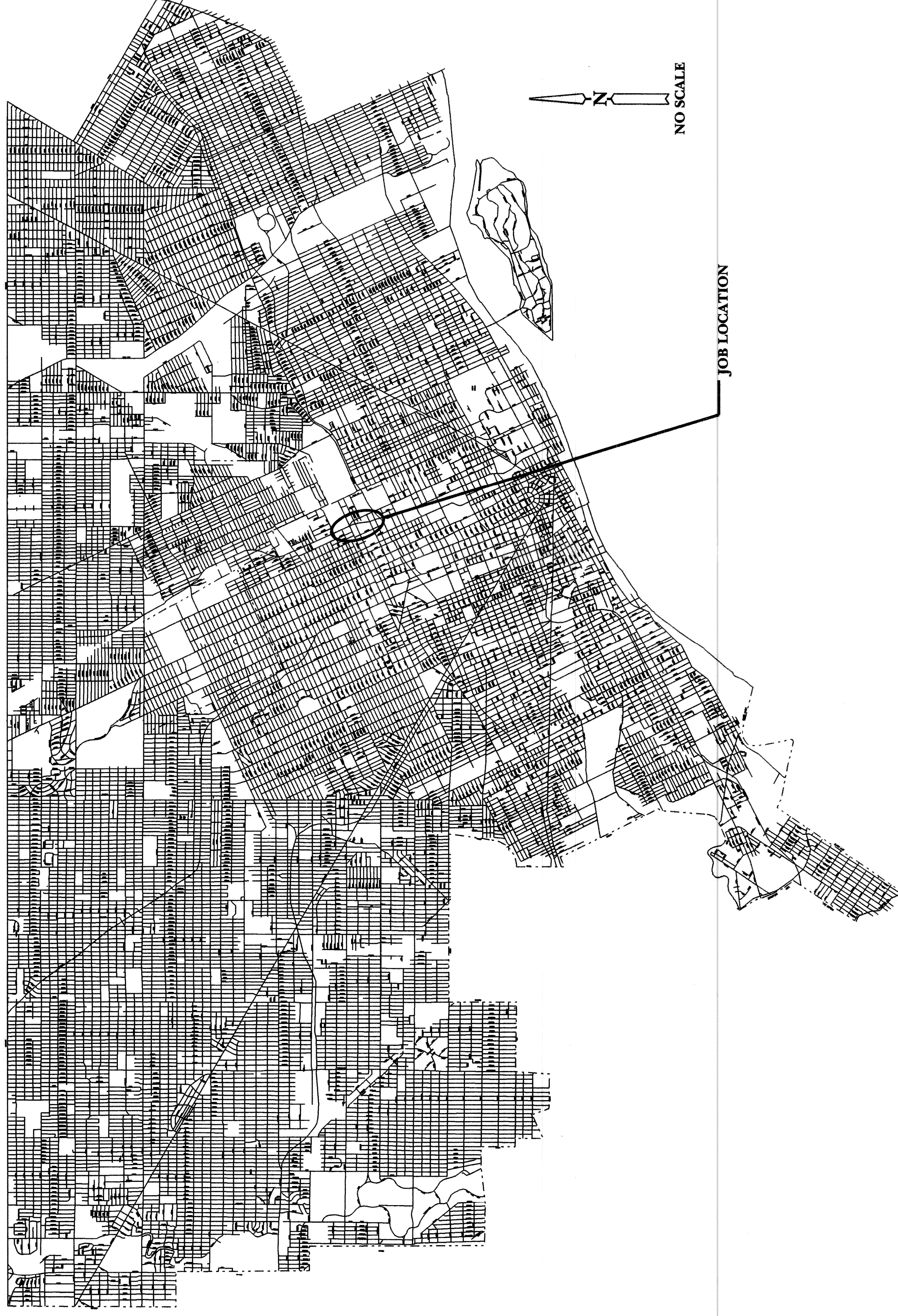

PLAN PREPARED BY: JAMES C. SCOTT & ASSOCIATES, INC. <small>300 E LONG LAKE ROAD FLOOR 200 BLOOMFIELD HILLS MICHIGAN 48303 TELEPHONE (248) 646-6564 FAX (248) 646-4838</small>		CONTRACT NO. _____ CED NO. _____ PW-6885
FOR DEPARTMENT OF PUBLIC WORKS LOCAL AUTHORITY APPROVAL CITY OF DETROIT CITY ENGINEERING DIVISION DEPARTMENT OF PUBLIC WORKS		AND MISCELLANEOUS CONSTRUCTION ON I-75 SERVICE DRIVES FROM CLAY TO GRAND TRUNK R.R.
RECOMMENDED FOR APPROVAL _____ <small>ENGINEER OF TRINITY</small> DATE _____	RECOMMENDED FOR APPROVAL _____ <small>ENGINEER OF TRANSPORTATION</small> DATE _____	APPROVED _____ <small>CITY ENGINEER</small> DATE _____
APPROVED _____ <small>CITY ENGINEER</small> DATE _____	DATE APRIL , 1998	

CITY OF DETROIT
DEPARTMENT OF PUBLIC WORKS
IN CO-OPERATION WITH
MICHIGAN DEPARTMENT OF TRANSPORTATION

THE IMPROVEMENTS COVERED BY THESE PLANS SHALL BE DONE IN ACCORDANCE WITH THE STANDARD SPECIFICATIONS AND SUPPLEMENTAL SPECIFICATIONS TO THE STANDARD SPECIFICATIONS FOR HIGHWAY CONSTRUCTION, 1990 EDITION.

AND
FEDERAL HIGHWAY ADMINISTRATION

FEDERAL PROJECT NO. STP 9882 (037)
 FEDERAL ITEM NO. RR 1563

CONTROL SECTION NO. STE 82252 JOB NO. 39765A
 ENHANCEMENT NO. 96-171

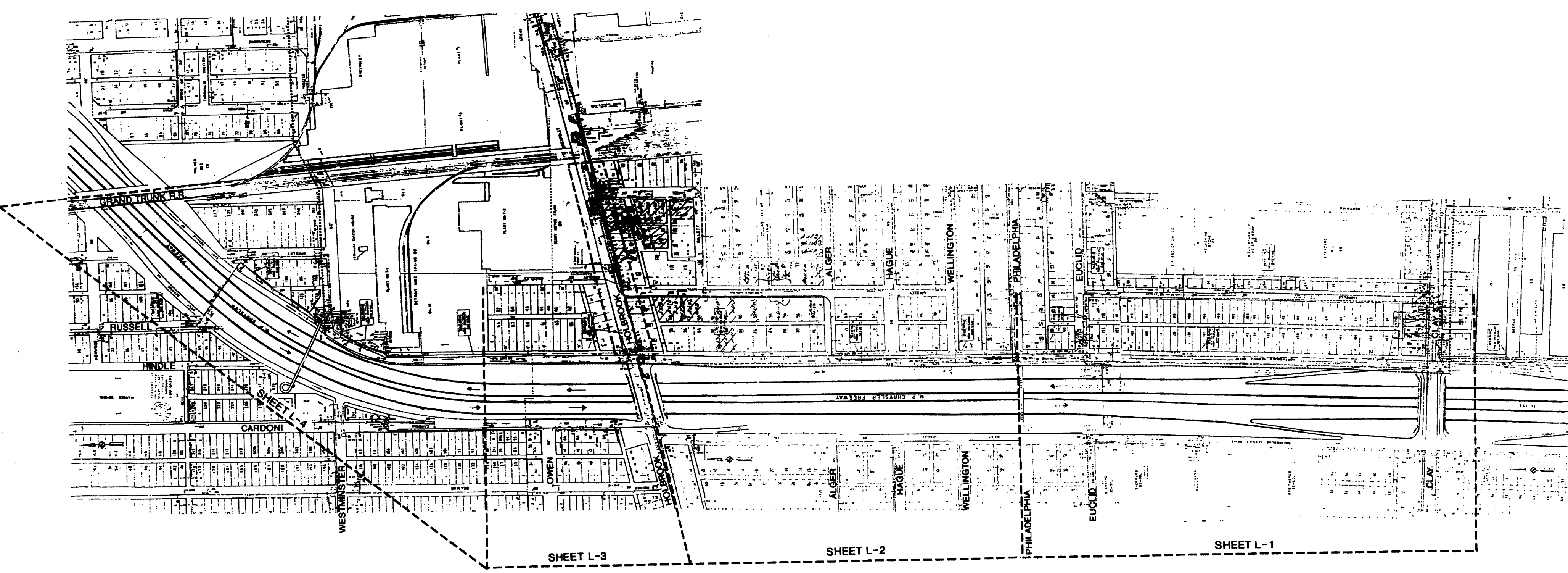

INDEX OF SHEETS

1. LANDSCAPE PLAN
2. LANDSCAPE PLAN
3. LANDSCAPE PLAN
4. LANDSCAPE PLAN
5. LANDSCAPE DETAILS
6. PLANTING DETAILS AND NOTES

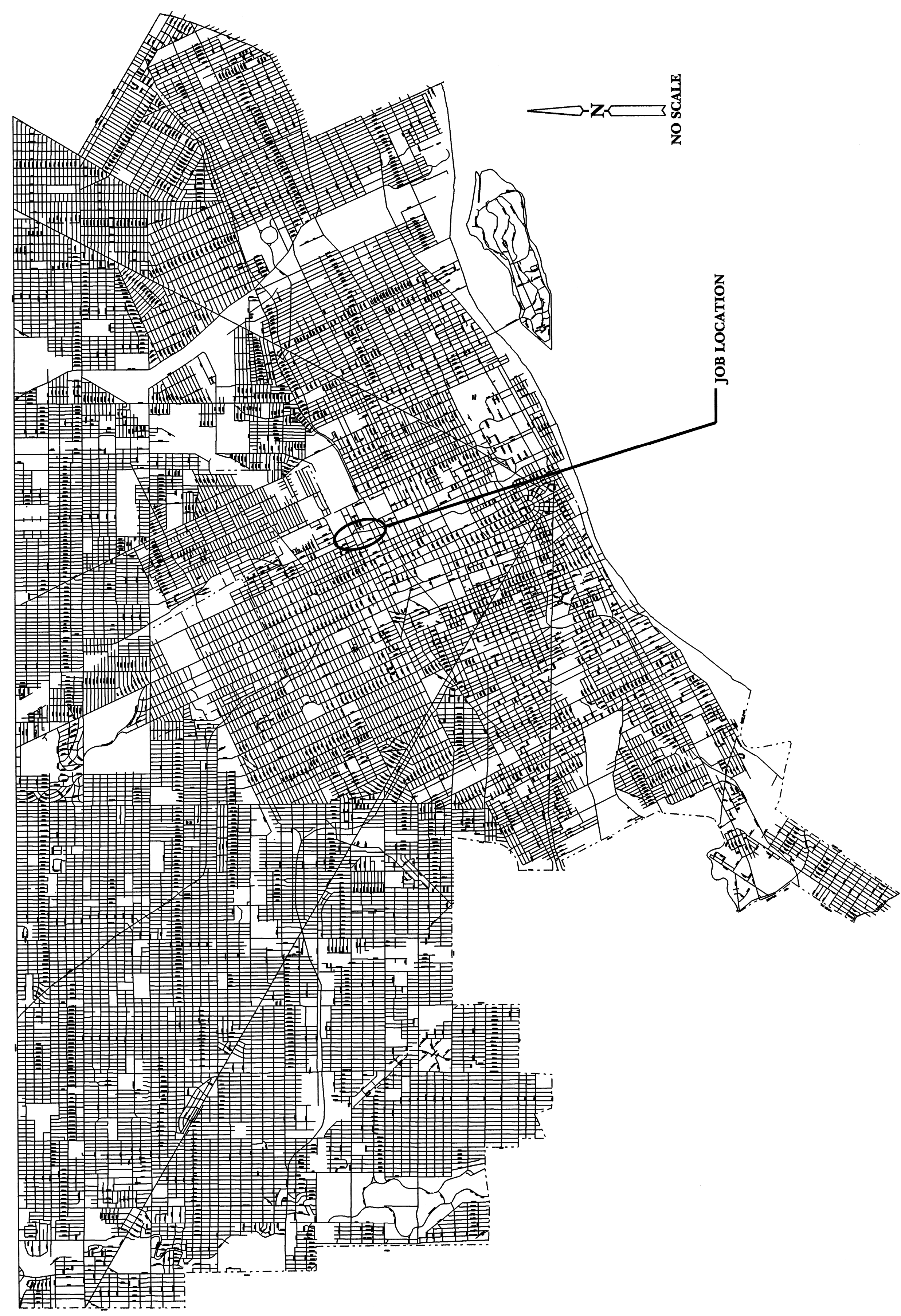

CALL MISS DIG
 3 WORKING DAYS PRIOR
 TO CONSTRUCTION
 1-800-482-7171

PLAN PREPARED BY: JAMES C. SCOTT & ASSOCIATES, INC. <small>300 E. LONG LAKE ROAD BLOOMFIELD HILLS MICHIGAN 48303 P.O. BOX 5 TELEPHONE: (248) 646-5564 FAX: (248) 646-4838</small>		CONTRACT NO. 76685 CED NO. PW-6865
CONTRACT FOR: LANDSCAPE IMPROVEMENTS <small>INSTALLATION OF CURBS, SIDEWALKS AND TRUNK SERVICE DRIVES FROM CLAY TO GRAND TRUNK R.R.</small>		FOR: DEPARTMENT OF PUBLIC WORKS LOCAL AUTHORITY APPROVAL CITY OF DETROIT CITY ENGINEERING DIVISION DEPARTMENT OF PUBLIC WORKS
RECOMMENDED FOR APPROVAL <small>DATE</small>	RECOMMENDED FOR APPROVAL <small>DATE</small>	APPROVED <small>DATE</small>
RECOMMENDED FOR APPROVAL <small>DATE</small>	APPROVED <small>DATE</small>	APPROVED <small>DATE</small>
DATE		APRIL, 1998

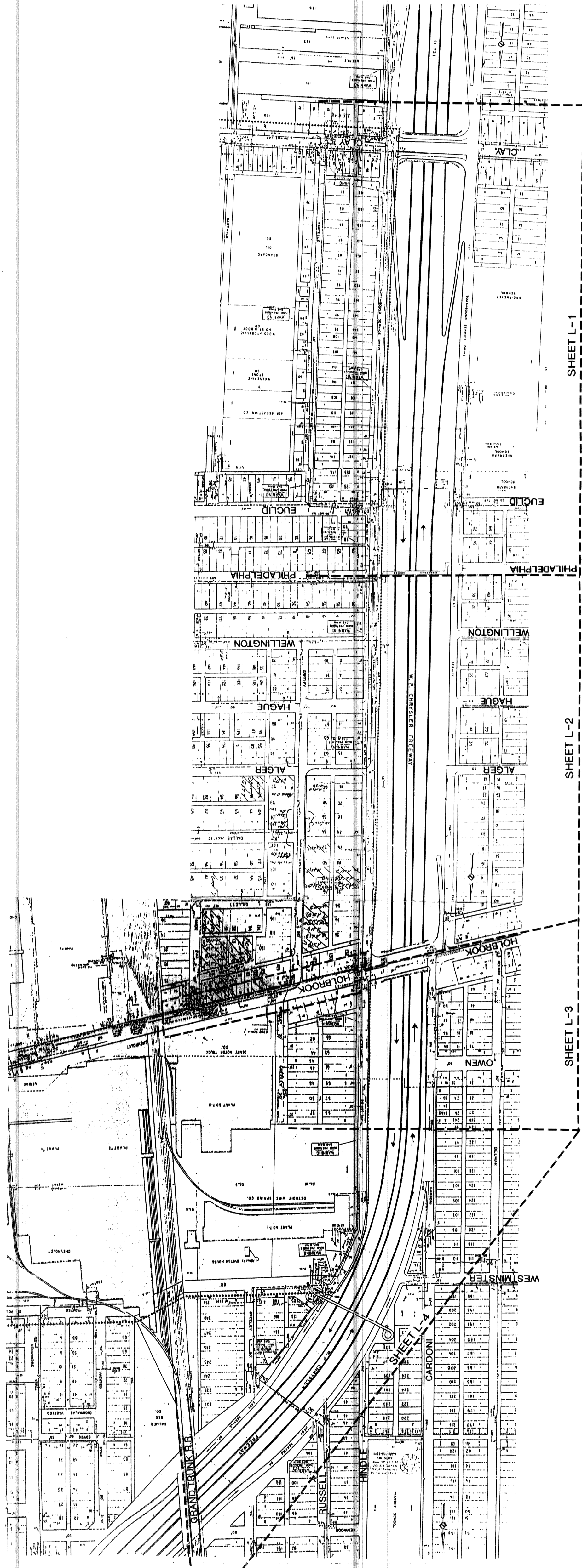

SCALE: 1" = 200'

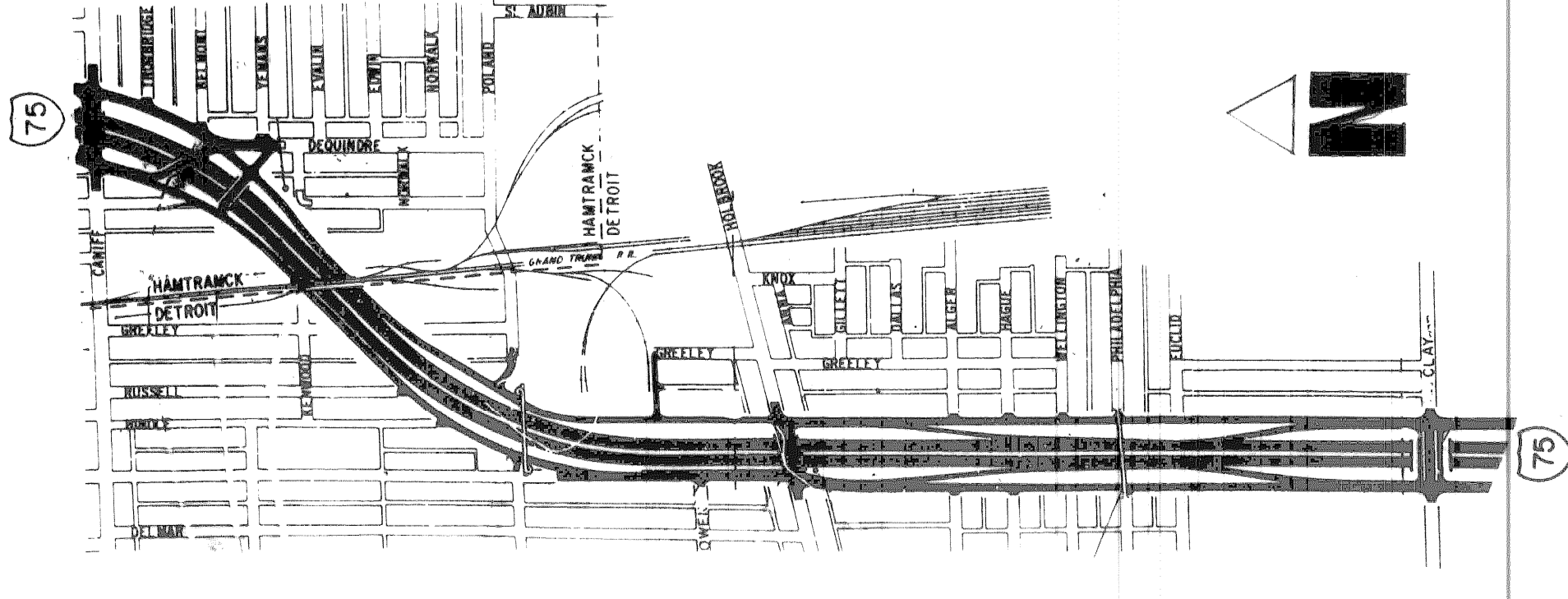

LOCATION MAP
NO SCALE

SHEET INDEX

CITY OF DETROIT

- L-1 LANDSCAPE PLAN
- L-2 LANDSCAPE PLAN
- L-3 LANDSCAPE PLAN
- L-4 LANDSCAPE PLAN

DETAILS AND NOTES

- L-5 LANDSCAPE DETAILS
- L-6 PLANTING DETAILS AND NOTES

I-75 SERVICE DRIVE LANDSCAPE IMPROVEMENTS

JAMES C. SCOTT
& ASSOCIATES, INC.
LANDSCAPE ARCHITECTS
SITE PLANNERS
300 E. LONG LAKE ROAD
BLOOMFIELD HILLS,
MICHIGAN 48304
248 646-6564



CITY OF DETROIT
DEPARTMENT OF PUBLIC WORKS

IN CO-OPERATION WITH

MICHIGAN DEPARTMENT OF TRANSPORTATION

AND

FEDERAL HIGHWAY ADMINISTRATION

FEDERAL PROJECT NO.STP 9882 (037)

FEDERAL ITEM NO.RR 1563

CONTROL SECTION NO. STE 82252 JOB NO. 39765A
 ENHANCEMENT NO. 96-171

THE IMPROVEMENTS COVERED BY THESE PLANS SHALL BE DONE IN ACCORDANCE WITH THE MICHIGAN DEPARTMENT OF TRANSPORTATION 1990 STANDARD SPECIFICATIONS AND SUPPLEMENTAL SPECIFICATIONS.

INDEX OF SHEETS

1. LANDSCAPE PLAN
2. LANDSCAPE PLAN
3. LANDSCAPE PLAN
4. LANDSCAPE PLAN
5. LANDSCAPE DETAILS
6. PLANTING DETAILS AND NOTES

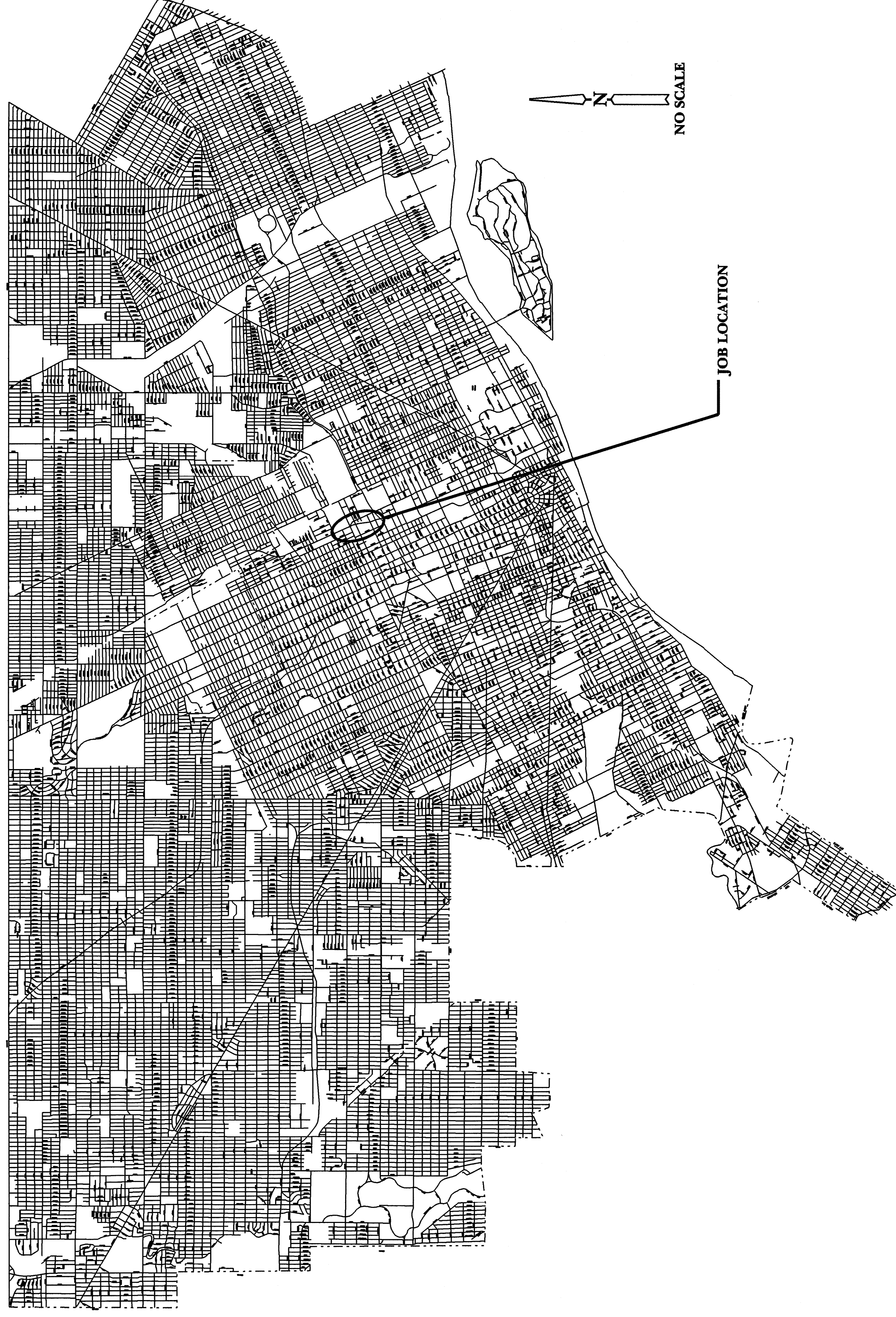

PLAN PREPARED BY:
JAMES C. SCOTT & ASSOCIATES, INC.
 300 E. LONG LAKE ROAD
 BLOOMFIELD HILLS, MICHIGAN 48303
 TELEPHONE: (248) 646-5554 FAX: (248) 646-4538

CONTRACT FOR LANDSCAPE IMPROVEMENTS
 AND MISCELLANEOUS CONSTRUCTION ON I-75
 SERVICE DRIVES FROM CLAY TO GRAND TRUNK
 R.R.

FOR DEPARTMENT OF PUBLIC WORKS

LOCAL AUTHORITY APPROVAL
 CITY OF DETROIT
 CITY ENGINEERING DIVISION
 DEPARTMENT OF PUBLIC WORKS

RECOMMENDED FOR APPROVAL	NUMBER OF SHEETS	DATE
RECOMMENDED FOR APPROVAL	NUMBER OF SHEETS	DATE
APPROVED	DATE	DATE
APPROVED	CITY NUMBER	DATE

DATE APRIL, 1998

NO SCALE

JOB LOCATION

NO SCALE

NO SCALE

JAMES C. SCOTT & ASSOCIATES, INC.
 LANDSCAPE ARCHITECTS
 SITE PLANNERS
 300 E. LONG LAKE ROAD
 BLOOMFIELD HILLS,
 MICHIGAN 48304
 248 846 6544

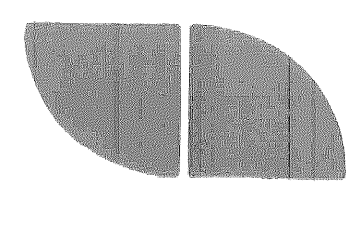

- SYMBOL KEY:**
- STREET LAMP
 - UTILITY POLE
 - TRAFFIC POLE
 - FIRE HYDRANT
 - ⊕ MANHOLE
 - ⊖ CATCH BASIN

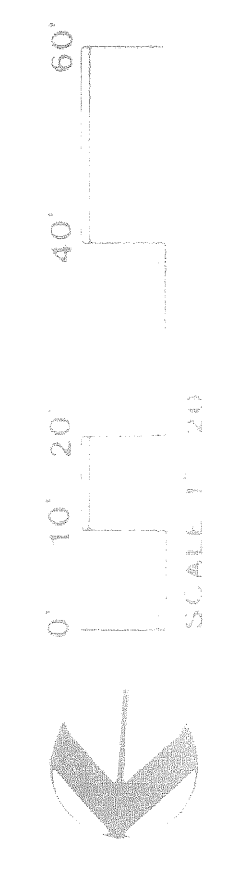
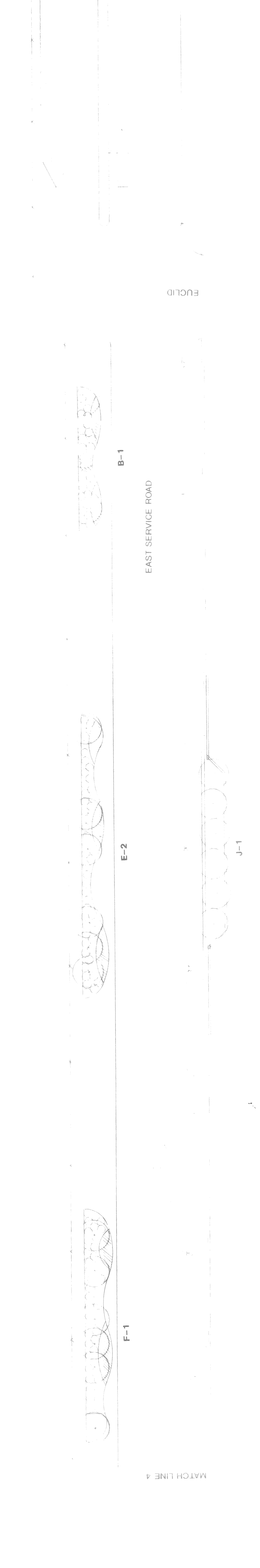
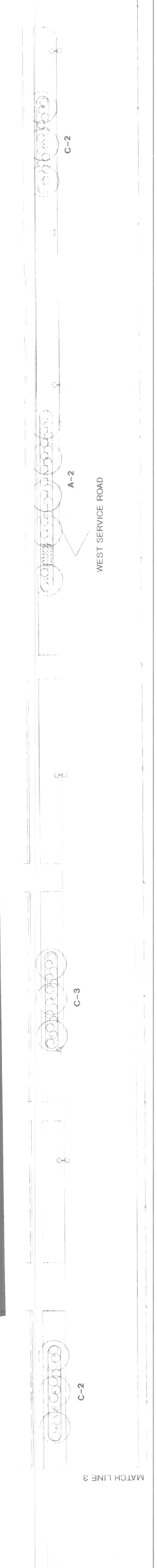
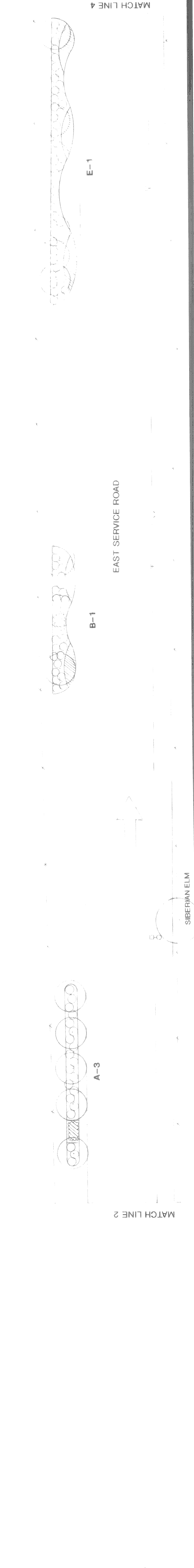
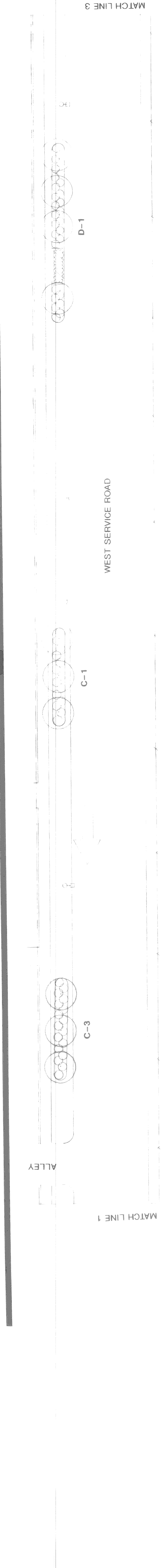
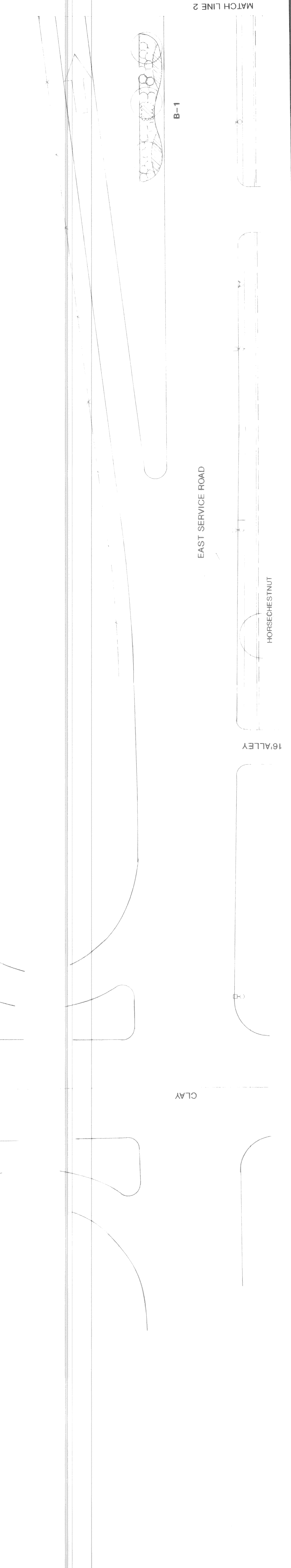
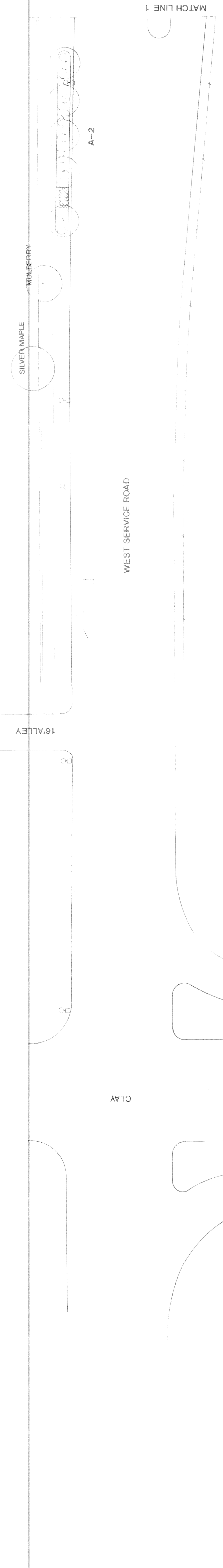

NOTE: FOR ALL LANDSCAPE BED PLANTINGS SEE DETAIL SHEET L-5
 I-75 SERVICE DRIVE LANDSCAPE IMPROVEMENTS
 LANDSCAPE PLAN L-1

DRAWN: 12-5-97
 REVISION: 1-16-98

PHILADELPHIA
 MATCH LINE 6
 18' GATE

MATCH LINE 5

MATCH LINE 1

MATCH LINE 2

MATCH LINE 3

MATCH LINE 4

MATCH LINE 3

MATCH LINE 4

B-1

EAST SERVICE ROAD

E-2

F-1

J-1

A-2

B-1

D-1

E-1

A-3

C-2

A-2

C-3

B-1

A-3

C-1

C-3

16 ALLEY

WEST SERVICE ROAD

EAST SERVICE ROAD

WEST SERVICE ROAD

EAST SERVICE ROAD

WEST SERVICE ROAD

EUCLID

SIBIRIAN ELM

SILVER MAPLE

MINIBERRY

CLAY

CLAY

ALLEY

HORSECHESTNUT

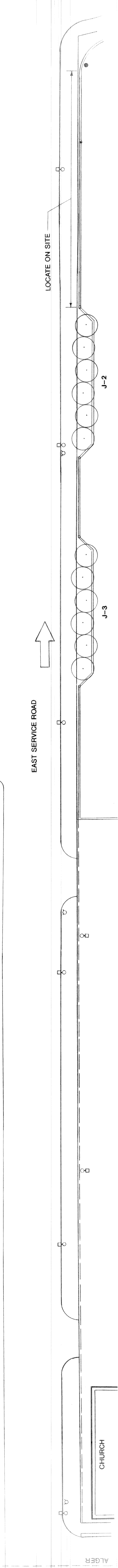
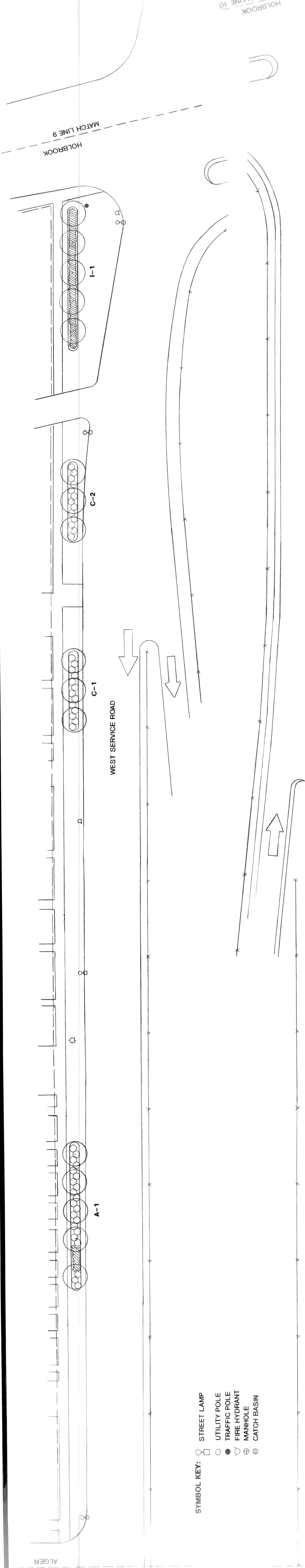
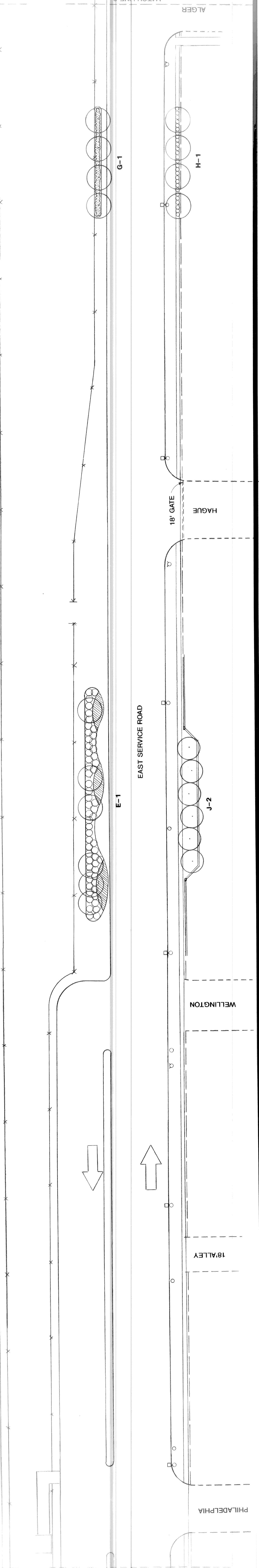
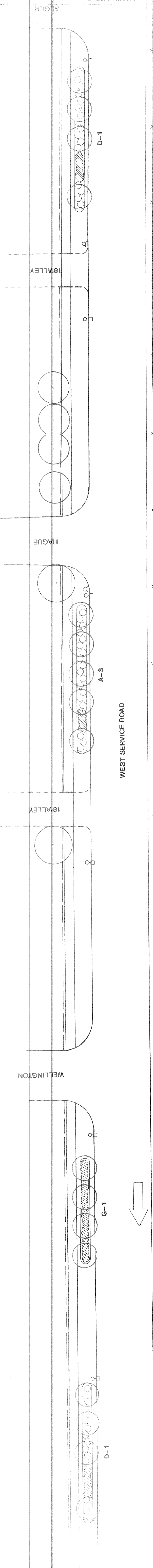

- SYMBOL KEY:**
- STREET LAMP
 - UTILITY POLE
 - TRAFFIC POLE
 - FIRE HYDRANT
 - MANHOLE
 - ⊕ CATCH BASIN

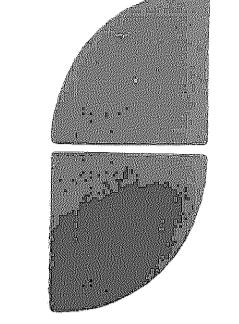
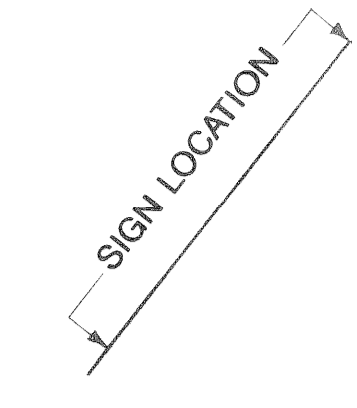

JAMES C. SCOTT
& ASSOCIATES, INC.
LANDSCAPE ARCHITECTS
SITE PLANNERS
300 E. LONG LAKE ROAD
BLOOMFIELD HILLS,
MICHIGAN 48304
248.636.5514

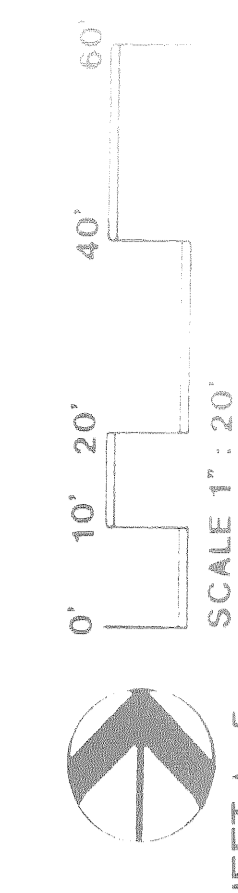

NOTE: FOR ALL LANDSCAPE BED PLANTINGS SEE DETAIL SHEET L-5
I-75 SERVICE DRIVE LANDSCAPE IMPROVEMENTS
 LANDSCAPE PLAN L-2

DRAWN: 12-6-97
 REVISION: 1-16-98

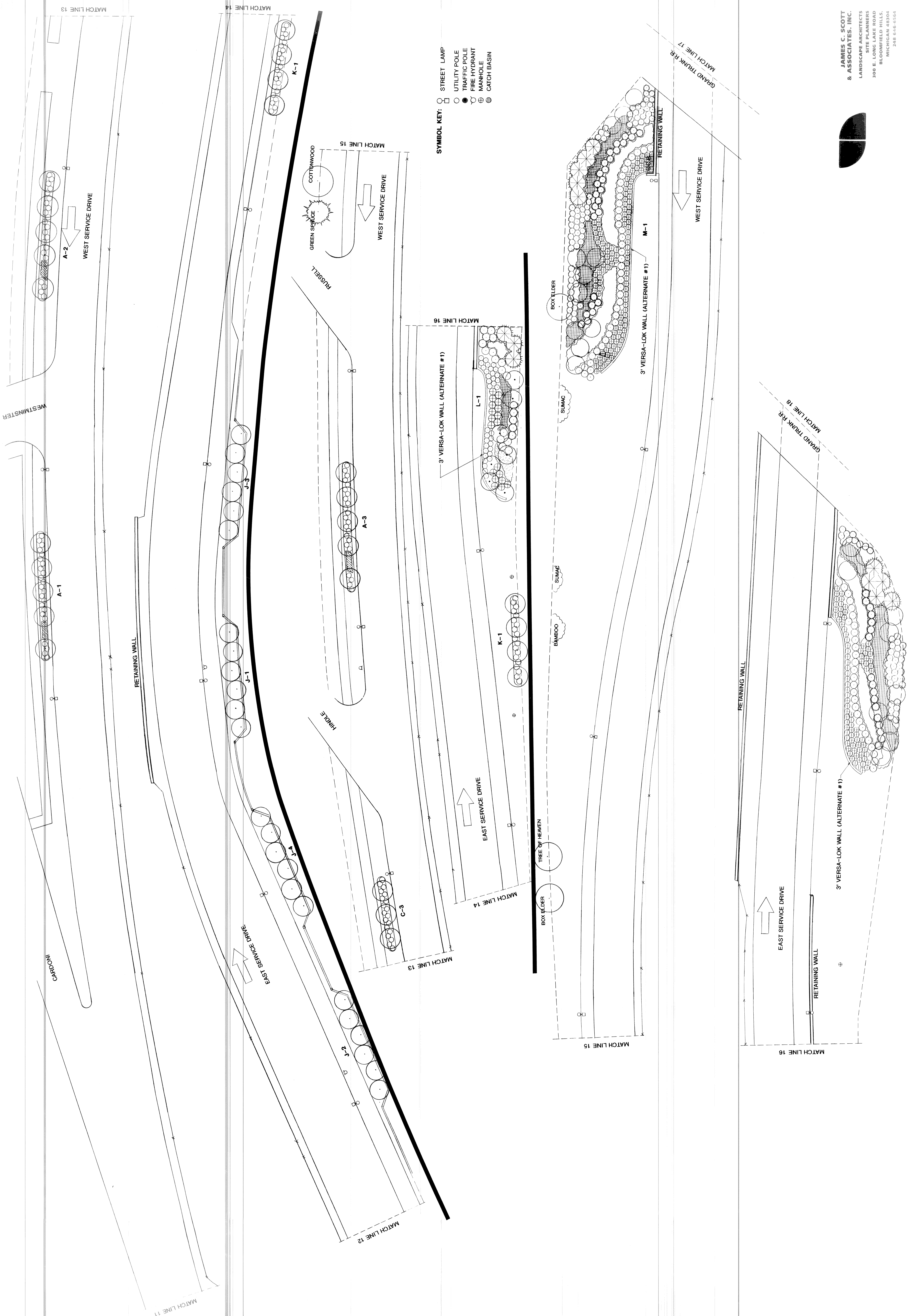

- SYMBOL KEY:**
- STREET LAMP
 - UTILITY POLE
 - TRAFFIC POLE
 - FIRE HYDRANT
 - ⊕ MANHOLE
 - ⊕ CATCH BASIN

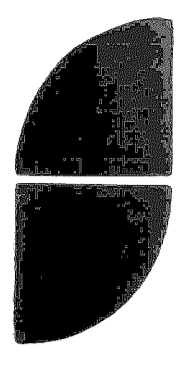

JAMES C. SCOTT & ASSOCIATES, INC.
 LANDSCAPE ARCHITECTS
 SITE PLANNERS
 300 E. LONG LAKE ROAD
 BLOOMFIELD HILLS, MICHIGAN 48304
 248.656.6564

NOTE: FOR ALL LANDSCAPE BED PLANTINGS SEE DETAIL SHEET L-5

I-75 SERVICE DRIVE LANDSCAPE IMPROVEMENTS
 LANDSCAPE PLAN L-4

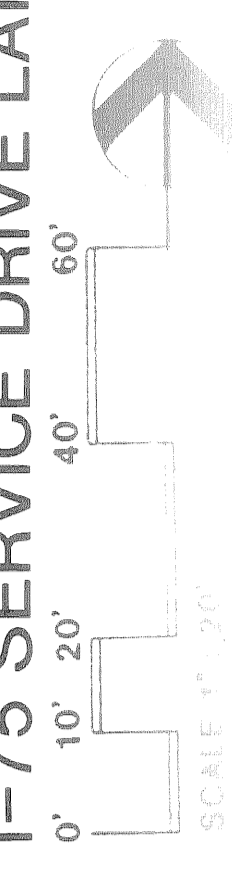

PROWALA 10-10-07 REVISED 11-16-07

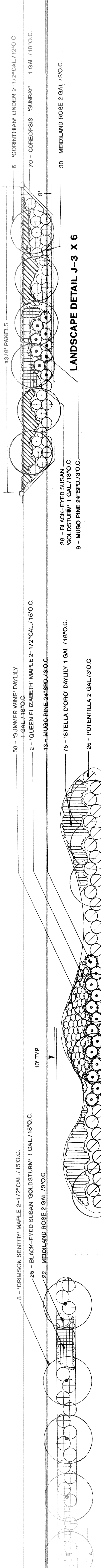

LANDSCAPE DETAIL A-1 X 2

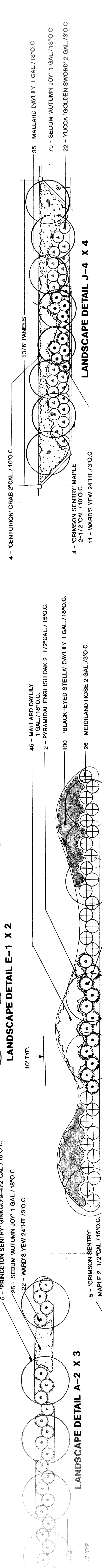

LANDSCAPE DETAIL A-2 X 3

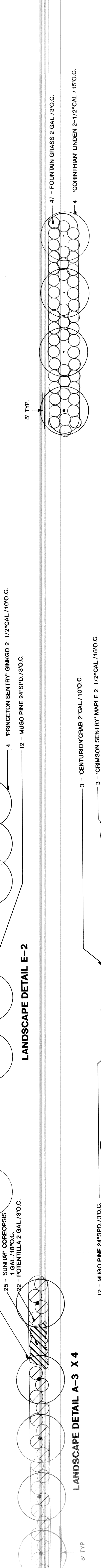

LANDSCAPE DETAIL A-3 X 4

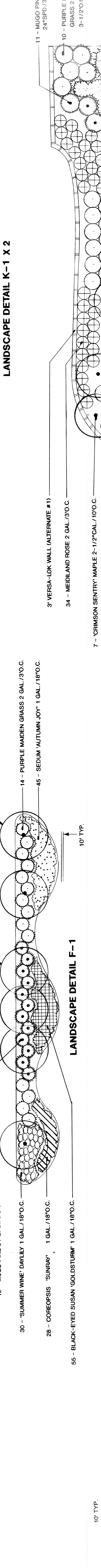

LANDSCAPE DETAIL B-1 X 3

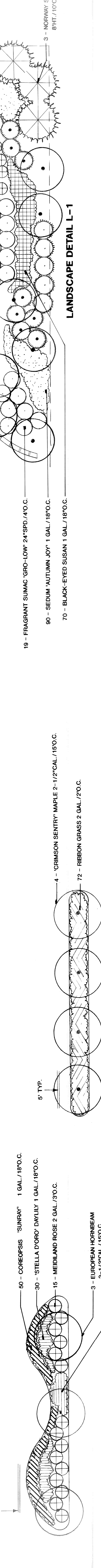

LANDSCAPE DETAIL C-1 X 3

LANDSCAPE DETAIL G-1 X 3

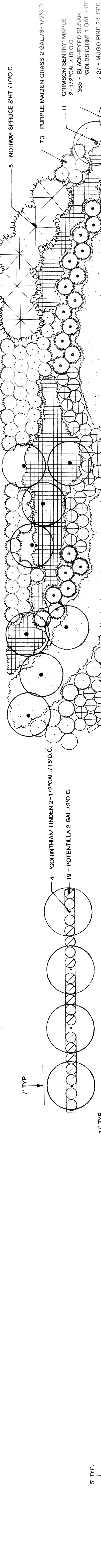

LANDSCAPE DETAIL H-1

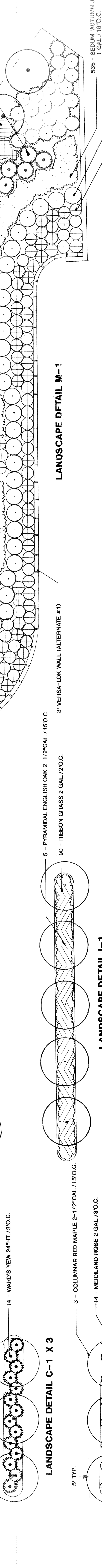

LANDSCAPE DETAIL I-1

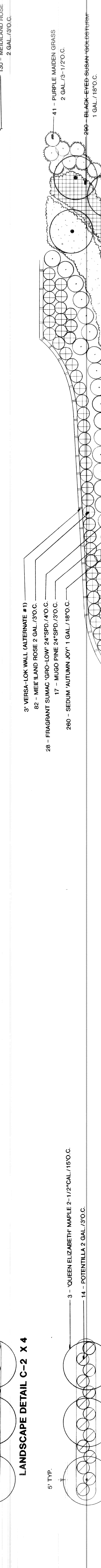

LANDSCAPE DETAIL J-1 X 5

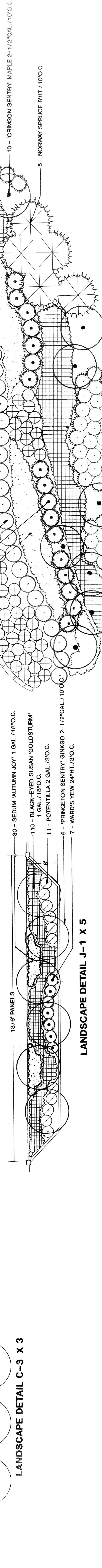

LANDSCAPE DETAIL K-1 X 2

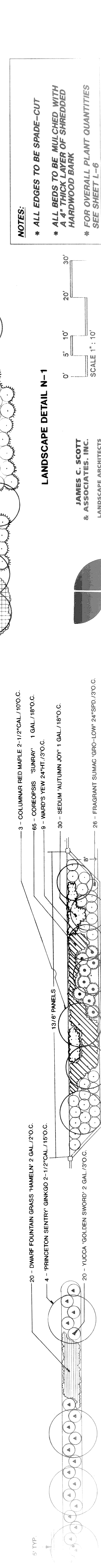

LANDSCAPE DETAIL L-1



LANDSCAPE DETAIL M-1

LANDSCAPE DETAIL N-1

NOTES:
 * ALL EDGES TO BE SPADE-CUT
 * ALL BEDS TO BE MULCHED WITH A 4" THICK LAYER OF SHREDDED HARDWOOD BARK
 * FOR OVERALL PLANT QUANTITIES SEE SHEET L-6

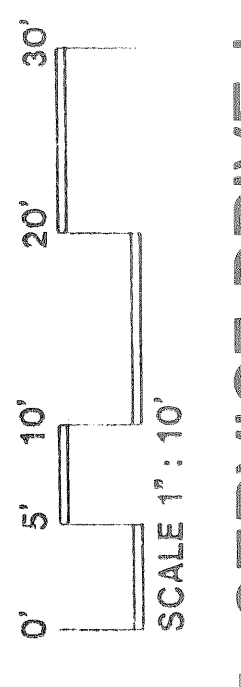

JAMES C. SCOTT & ASSOCIATES, INC.
 LANDSCAPE ARCHITECTS
 SITE PLANNERS
 300 E. LONG LAKE ROAD
 BLOOMFIELD HILLS, MICHIGAN 48304
 248.856.6544

I-75 SERVICE DRIVE LANDSCAPE IMPROVEMENTS
 DRAWN: 12-5-97
 REVISION: 1-16-98, 2-15-98

PLANTING TREES, EVERGREENS & SHRUBS

1. Dig plant pocket for deciduous and evergreen trees a minimum of 30" wide and 6" deeper than root ball unless otherwise specified.
2. Dig plant pocket for shrubs a minimum of 12" wider than the root ball and 6" deeper than root ball unless otherwise specified.
3. Loosen subsoil to a depth of 4". Loosen earth on sides of pocket to break any of the glaze caused by digging.
4. Set plants at the same or slightly higher depth than at the nursery.
5. Fill prepared soil to the depth of ball, pack firmly, and puddle with water.
6. Loosen and remove burlap and all lacing from upper half of ball.
7. Backfill with prepared soil which, after compaction, is flush with surrounding ground level.
8. Cover entire plant pocket area with 5"-6" mulch.
9. Prune, wrap, & brace or guy as specified.

NOTES:

When plants are furnished in containers, the containers shall be completely removed at the time of planting.

All excavated material must be removed from the site immediately.

All heights are shown before pruning.

All depths are shown after setting.

Trees and shrubbery shall not be planted within 5' and 3' respectively of the nearest edge of metal - except near structures and guard rails, and where inaccessible to vehicles.

MISCELLANEOUS NOTES

- ALL PLANTING BEDS WILL BE OUTLINED IN SPRAY PAINT FOR LOCATION AND SIZE AND WILL BE PROTECTED BY CONSTRUCTION MANAGER/LANDSCAPE ARCHITECT BEFORE PROCEEDING.
- ALL PLANTING BEDS THAT ARE LOCATED IN AN EXISTING GRASS/NATIVE AREA WILL BE SPRAYED WITH "ROUNDUP" AT THE RECOMMENDED RATIO AND TIME PERIOD BEFORE STRIPPING AND DISPOSING OFF SITE OF THE NATIVE COVER. IN CASE OF RAIN BEFORE THE RECOMMENDED RATIO FOR THE CHEMICAL TO FULLY REACT, THE BEDS WILL BE RE-SPRAYED (AT NO ADDITIONAL COST).
- ALL STAKES AND GUYING MATERIALS SHALL BE REMOVED AT THE DIRECTION OF THE DISTRICT RESOURCE SPECIALIST.
- GUY WIRE SHIELDS AROUND TREES SHALL BE RUBBER.
- GUY WIRE/SUPPORT TAPE SHALL BE INSTALLED TO ALLOW FOR SOME SLACK IN THE WIRE.
- THE LANDSCAPE CONTRACTOR IS RESPONSIBLE TO ADD TOPSOIL, SEED AND MULCH TO ALL DISTURBED AREAS TO MATCH EXISTING AREAS PER CURRENT MDOT STANDARDS AND SPECIFICATIONS.

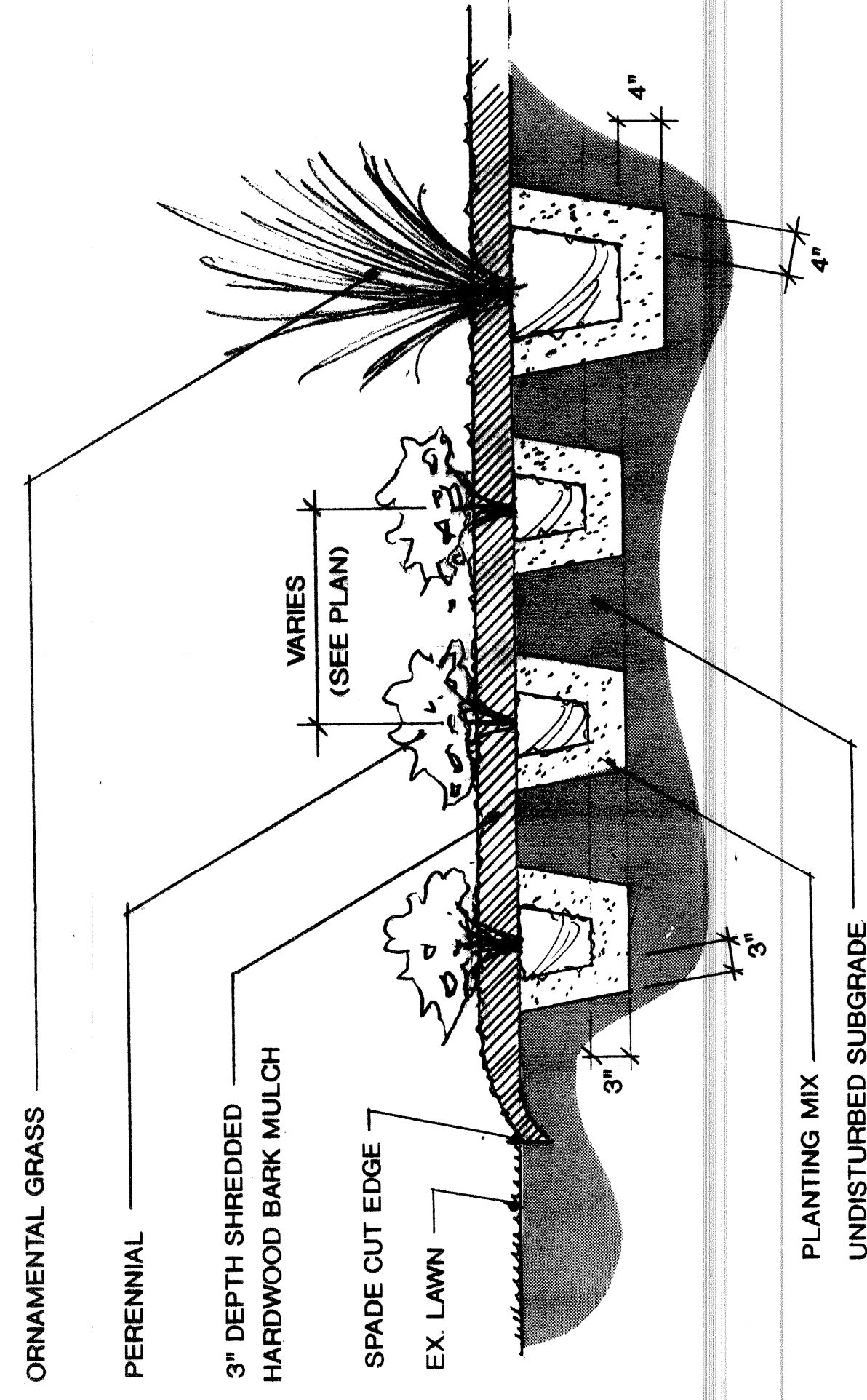

PERENNIAL / ORNAMENTAL GRASS PLANTING DETAIL

SCALE: 1"=1'-0"

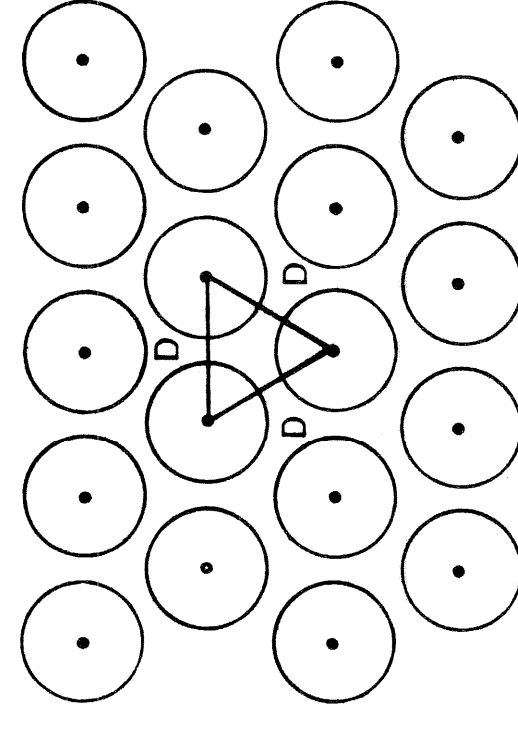

PERENNIAL / FLOWER SPACING DETAIL

NO SCALE

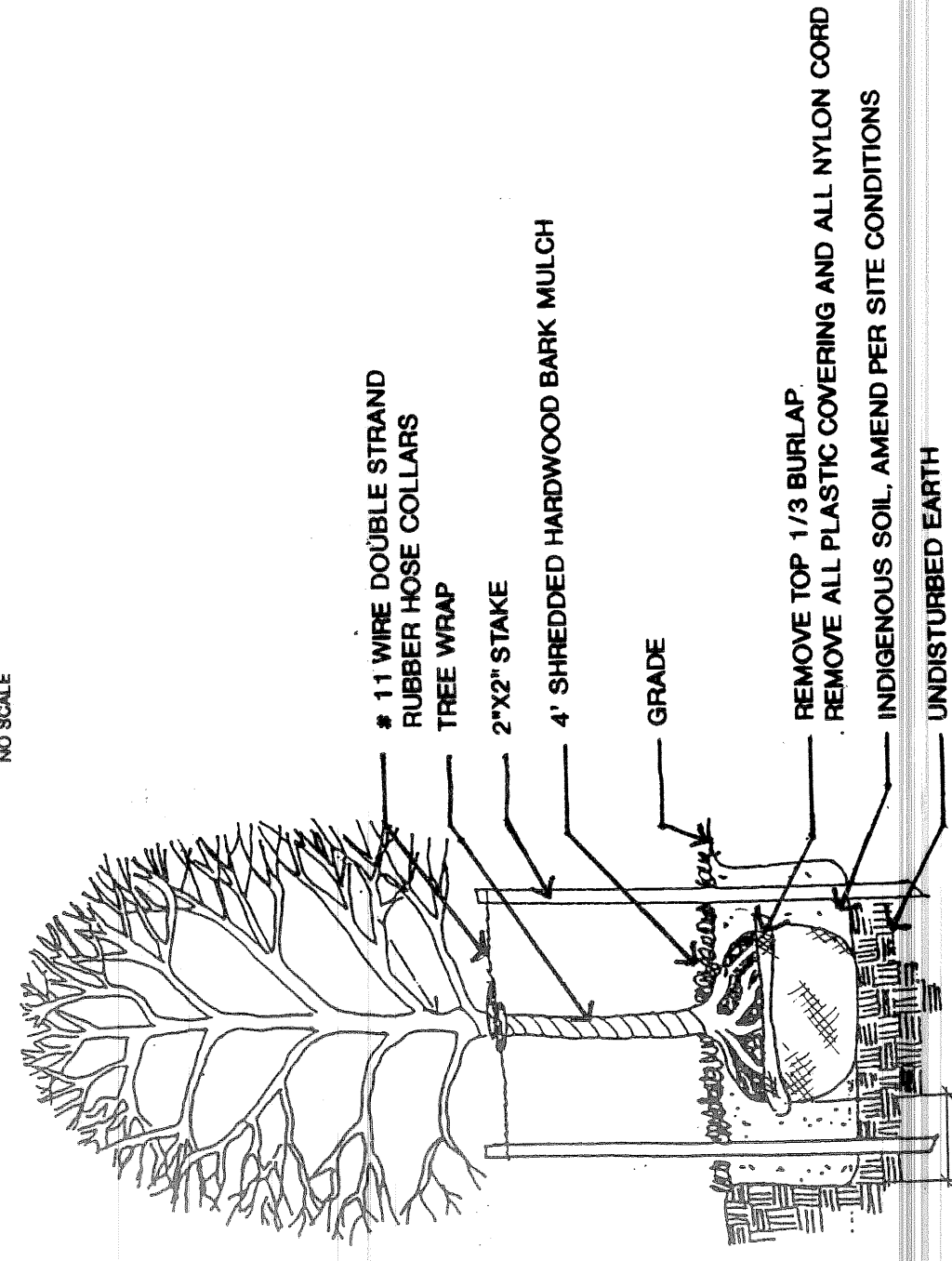

DECIDUOUS TREE DETAIL

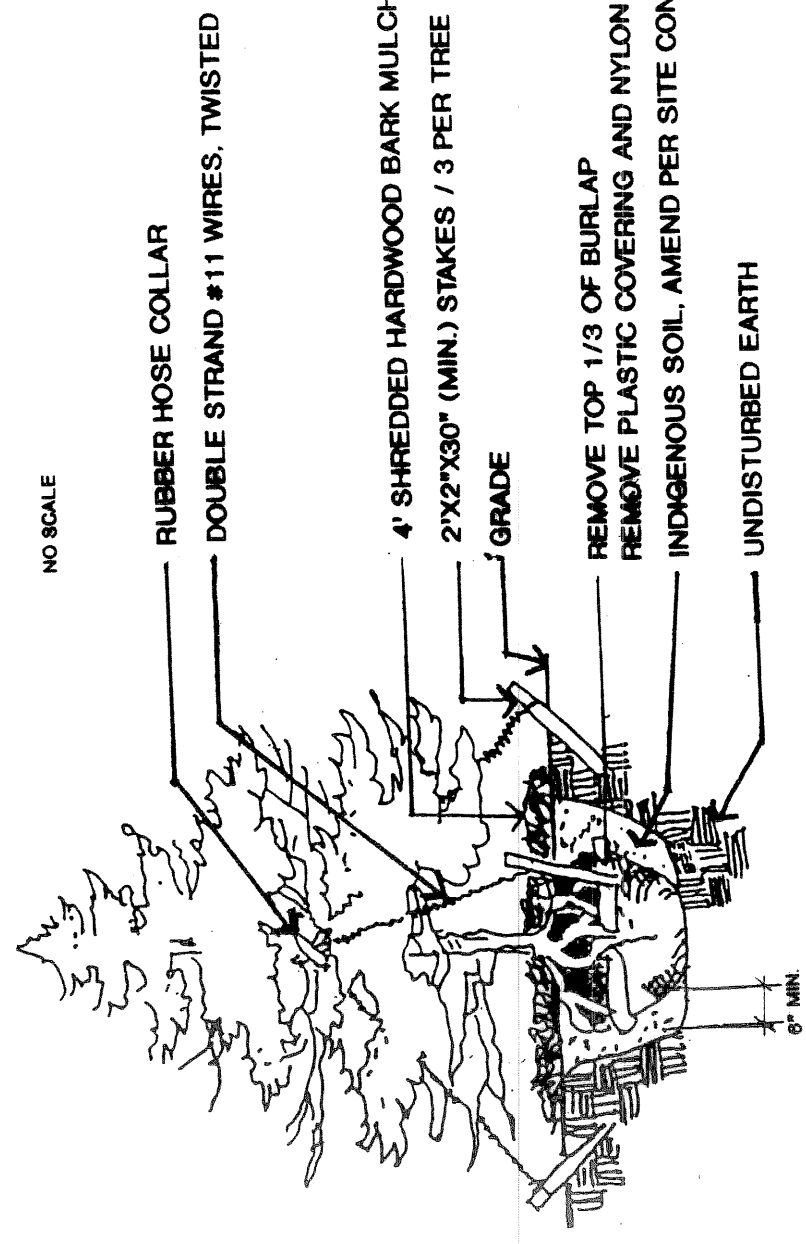

EVERGREEN TREE DETAIL

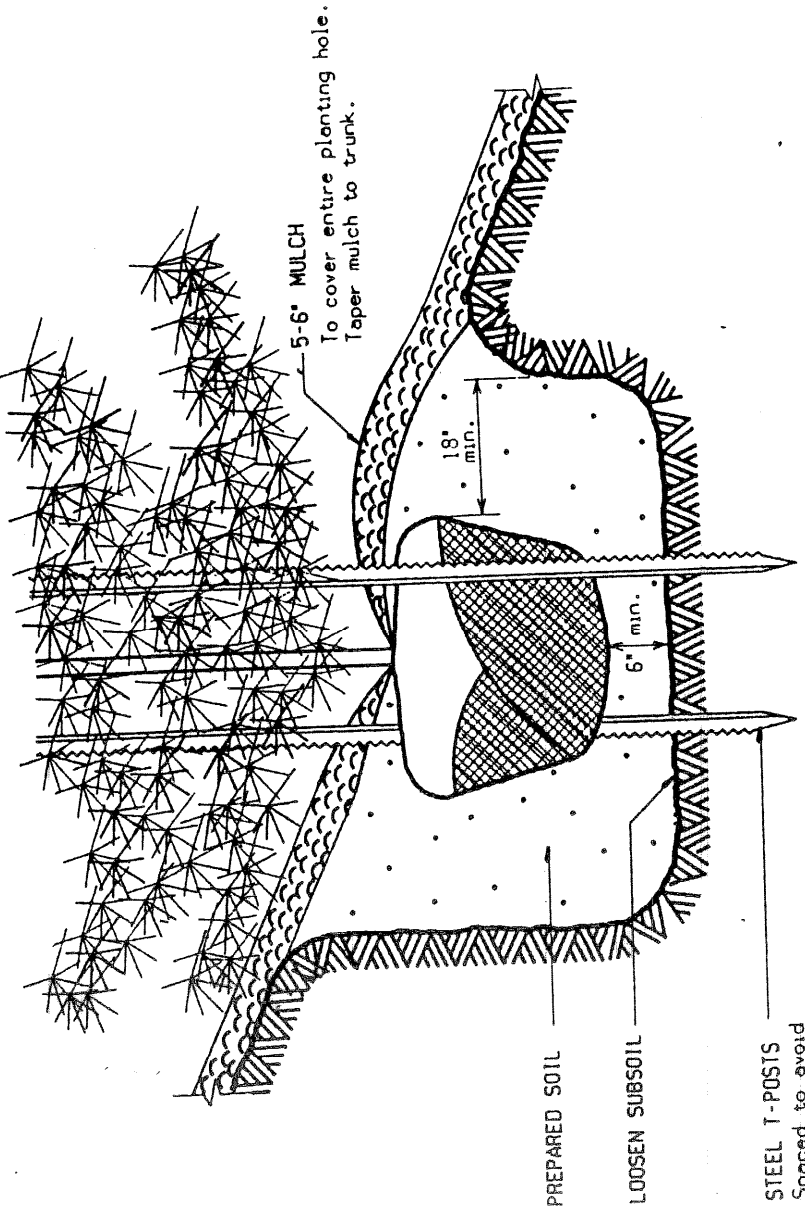

SLOPE PLANTING DETAIL

NO SCALE

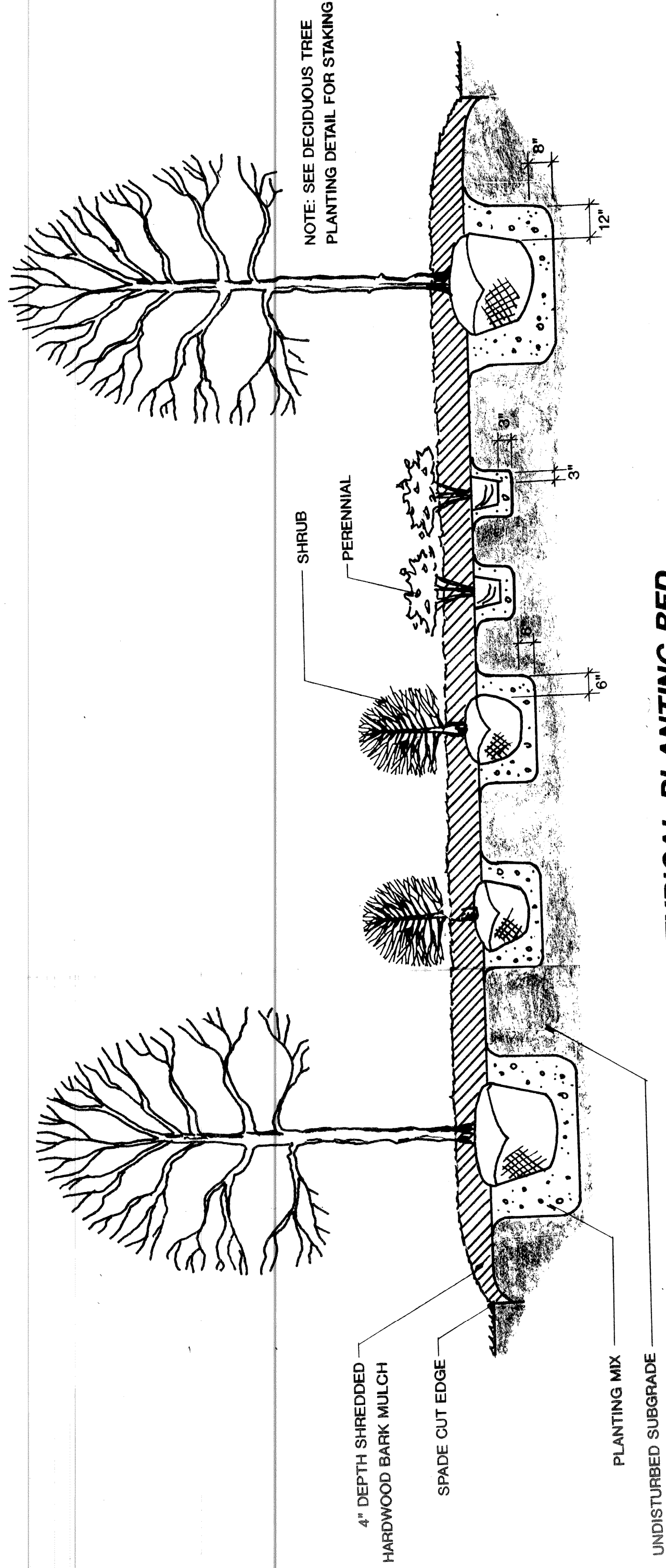

TYPICAL PLANTING BED

NO SCALE

PLANT LIST

Qty.	Item	Size	Root	Remark
13	Acer campestre "Queen Elizabeth"	2 1/2" cal.	B & B	5' Branch
38	Acer rubrum "Crimson Sentry"	2 1/2" cal.	B & B	5' Branch
30	Acer rubrum "Columbiane"	2 1/2" cal.	B & B	5' Branch
61	Acer rubrum "Columbiane"	2 1/2" cal.	B & B	5' Branch
43	Malus "Centurion"	2" cal.	B & B	Full
9	Euonymus alatus "Alatum"	2 1/2" cal.	B & B	5' Branch
15	Quercus robur "Fastigiata"	2 1/2" cal.	B & B	5' Branch
48	Tilia cordata "Corzani"	2 1/2" cal.	B & B	5' Branch
13	Picea abies	8" ht.	B & B	Full
254	Norway Spruce	2 gal.	Cont.	Full
243	Rhus aromatica "Gro-Low"	2 gal.	Cont.	Full
597	Rosa scarlet medallion "Mekrotal"	2 gal.	Cont.	Full
148	Yucca filamentosa "Golden Sword"	2 gal.	Cont.	Full
159	Phlox paniculata "Comactum"	24" spd.	B & B	Full
208	Faxea x media "Wardii"	24" ht.	B & B	Full
138	Miscanthus sinensis "Purpureus"	2 gal.	Cont.	Full
94	Pennisetum alopecuroides "Hameln"	2 gal.	Cont.	Full
84	Phalaris plectra	2 gal.	Cont.	Full
306	Cyperus	1 gal.	Cont.	Full
1,088	Cyperus	1 gal.	Cont.	Full
100	Hemerocallis "Stella"	1 gal.	Cont.	Full
185	Hemerocallis "Walden"	1 gal.	Cont.	Full
240	Hemerocallis "Stella D'oro"	1 gal.	Cont.	Full
130	Hemerocallis "Summerwine"	1 gal.	Cont.	Full
1,548	Rudbeckia hirta "Goldsturm"	1 gal.	Cont.	Full
1,615	Autumn Joy Sedum	1 gal.	Cont.	Full
300 c.y.	Shredded bark Mulch			4" Depth

JAMES C. SCOTT & ASSOCIATES, INC.
 LANDSCAPE ARCHITECTS
 SITE PLANNERS
 300 E. LONG LAKE ROAD
 BLOOMINGHURST, MICHIGAN 48304
 248.646.6564