

CURVE DATA
 $\Delta = 13^{\circ}-41'-50''$
 $D = 3^{\circ}-00'-00''$
 $R = 1909.859'$
 $T = 229.381'$
 $L = 456.574'$
 $E = 13.725'$
 $PC = 473+97.259$
 $PI = 476+26.640$
 $PT = 478+53.833$

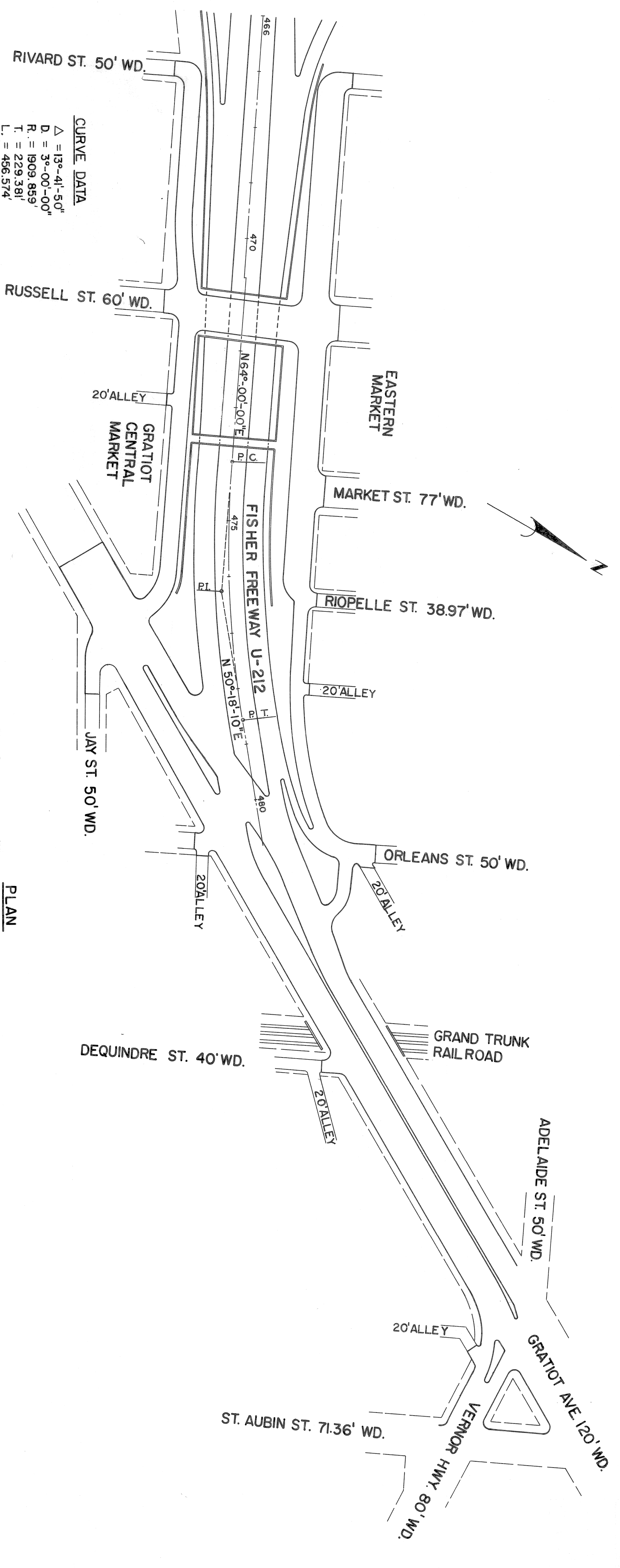
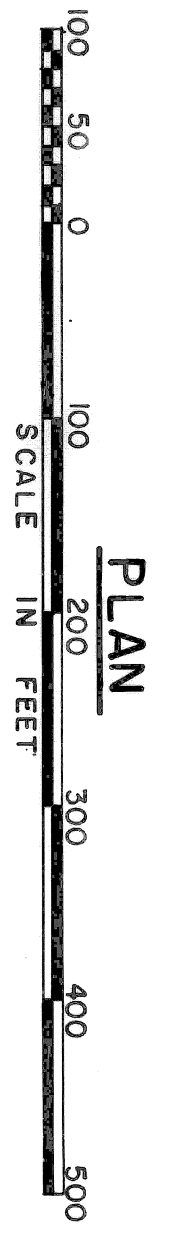
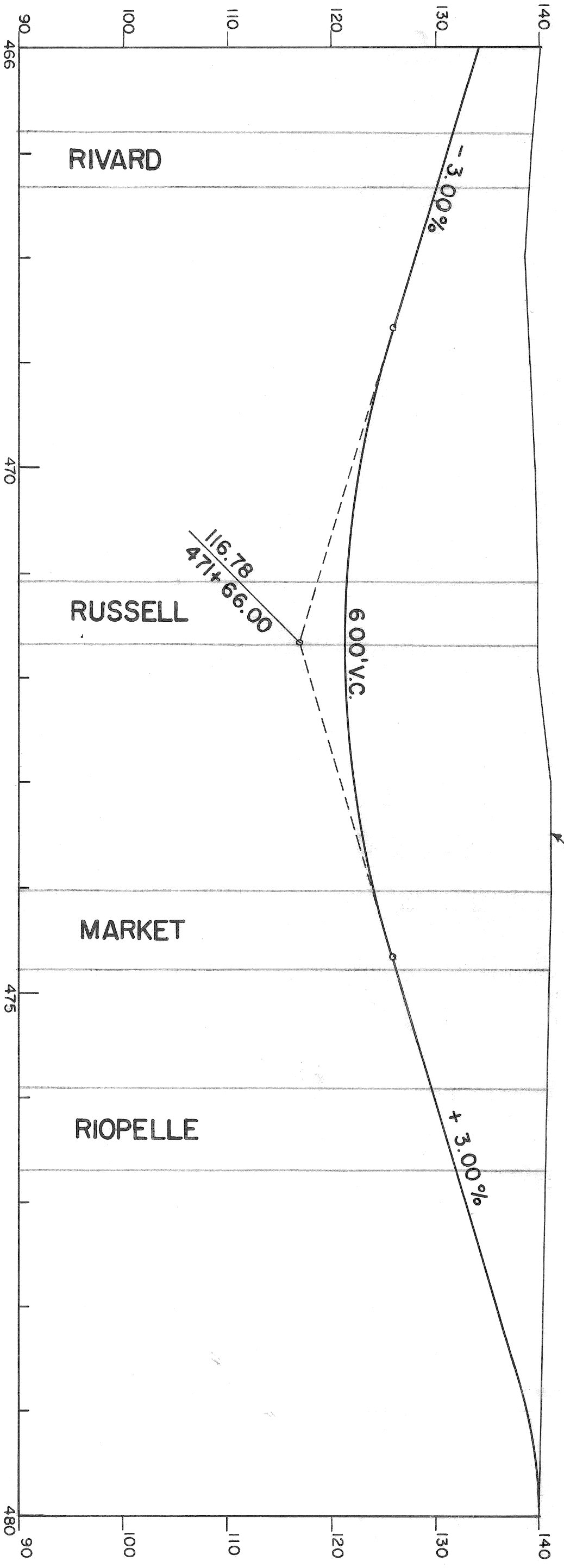

PROFILE
 SCALE HORIZONTAL 1" = 50'
 SCALE VERTICAL 1" = 10'

SQUAD LEADER	DATE
DRAWN BY	CHECKED BY
CORRECT	

CITY OF DETROIT
 DEPARTMENT OF PUBLIC WORKS
 CITY ENGINEERS OFFICE
 BUREAU OF HIGHWAYS AND EXPRESSWAYS

APPROVED _____
 MICHIGAN STATE HIGHWAY DEPARTMENT
 U-212 FISHER FREEWAY
 RIVARD ST. TO ST. AUBIN ST.

ISSUE NO.	DATE
CITY JOB SHEET NO.	
STATE PROJECT	

REV. 5-66