

STAGE I

NOTE: MAINTAIN TWO LANES OF TRAFFIC AT ALL TIMES.

QUANTITIES		
ITEM	UNIT	AMOUNT
LIGHTED ARROW, TYPE A, FURN.	EA	1
LIGHTED ARROW, TYPE A, OPER.	EA	1
BARRICADE, TYPE II, LIGHTED, FURN.	EA	16
BARRICADE, TYPE II, LIGHTED, OPER.	EA	14
BARRICADE, TYPE III, LIGHTED	EA	4
TEMPORARY CONCRETE BARRIER	LF	170
MINOR TRAFFIC DEVICES	LS	1
SIGN, TYPE B, TEMPORARY	SF	136

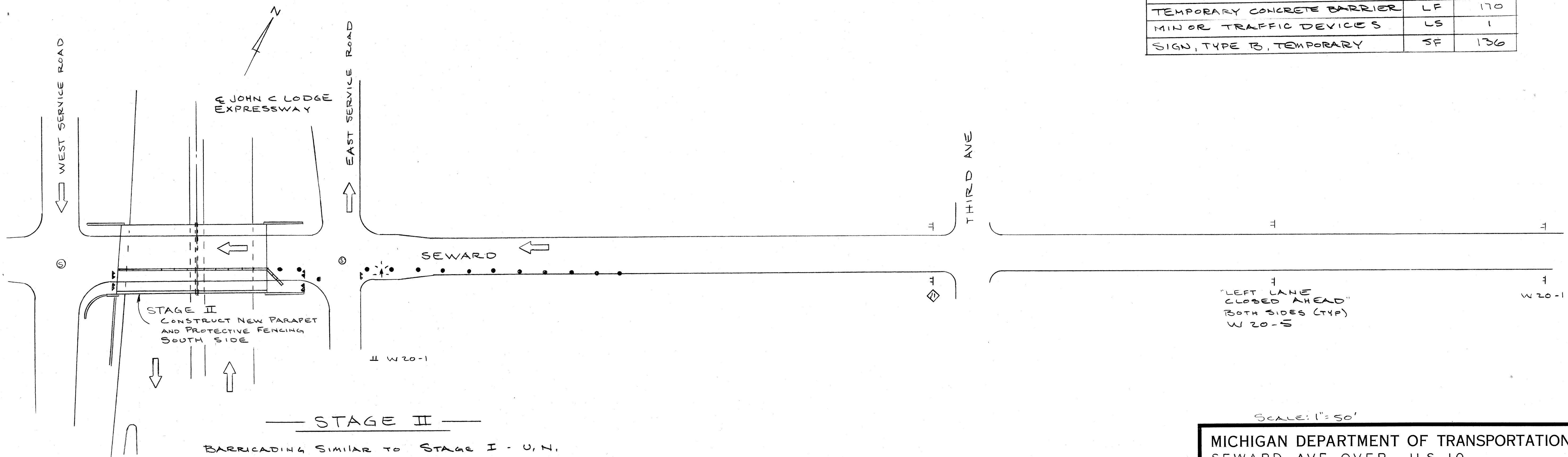

STAGE II

BARRICADING SIMILAR TO STAGE I - U.N.

PLANS PREPARED BY
CITY OF DETROIT
 DEPARTMENT OF PUBLIC WORKS
 CITY ENGINEERS OFFICE

APPROVED: *T.E. McGowan*
 STRUCTURAL ENGINEER

JOB No.
 79-22-26 P

SCALE: 1" = 50'

MICHIGAN DEPARTMENT OF TRANSPORTATION
 SEWARD AVE OVER US 10
 SCREENING AND RAILING REPLACEMENT
 STAGING AND CONSTRUCTION SIGNING

REVISIONS			
NO.	DESCRIPTION	DATE	BY

SQUAD BOSS: A. FRIEDMAN 9-24-81
 DRAWN BY: [Signature] 9-24-81
 CHECKED BY: [Signature] 9-24-81
 SHEET OF

S 04 OF 82112

FED. ROAD DIST. NO.	STATE	PROJECT NO.	FISCAL YEAR	SHEET NO.	TOTAL SHEETS
	MICH.				
ROUTE	STATE PROJECT	COUNTY	TOWNSHIP	SHEET NO.	TOTAL SHEETS
		WAYNE			

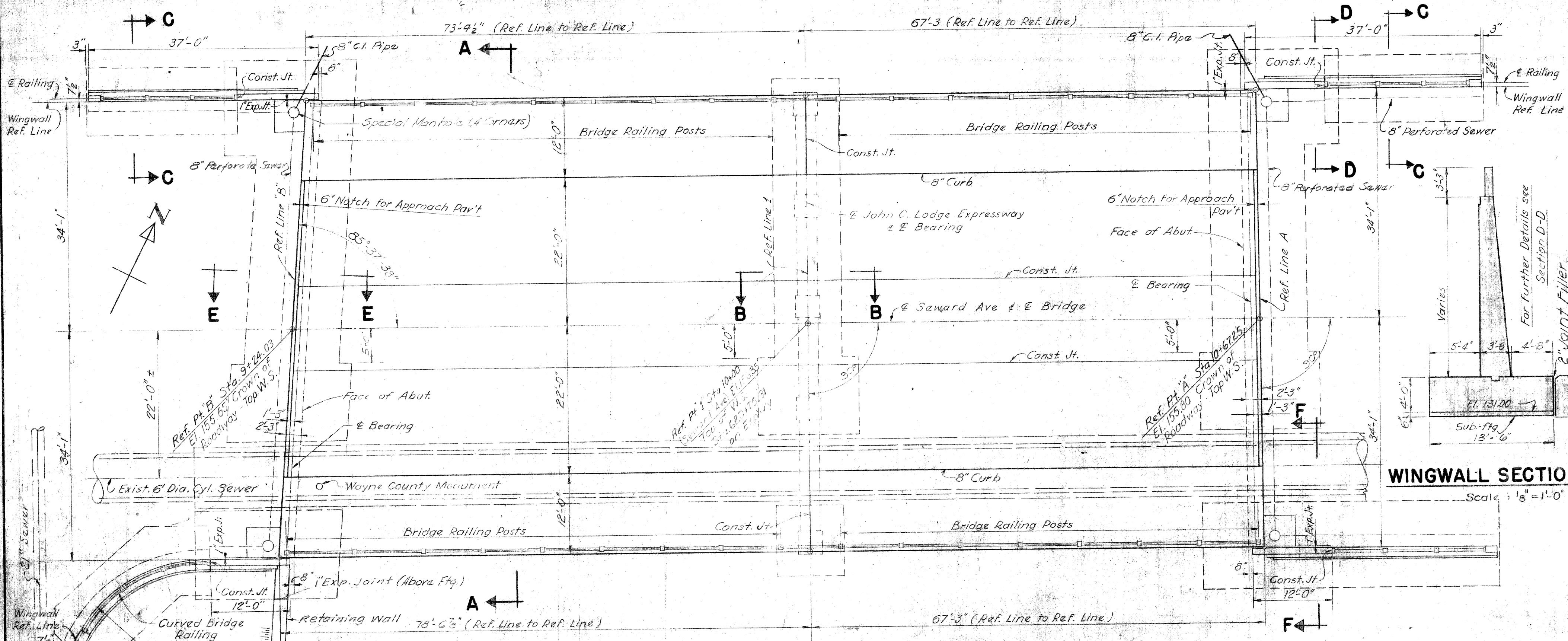

PLAN
Scale: 3/32" = 1'-0"
200'-0" V.C.

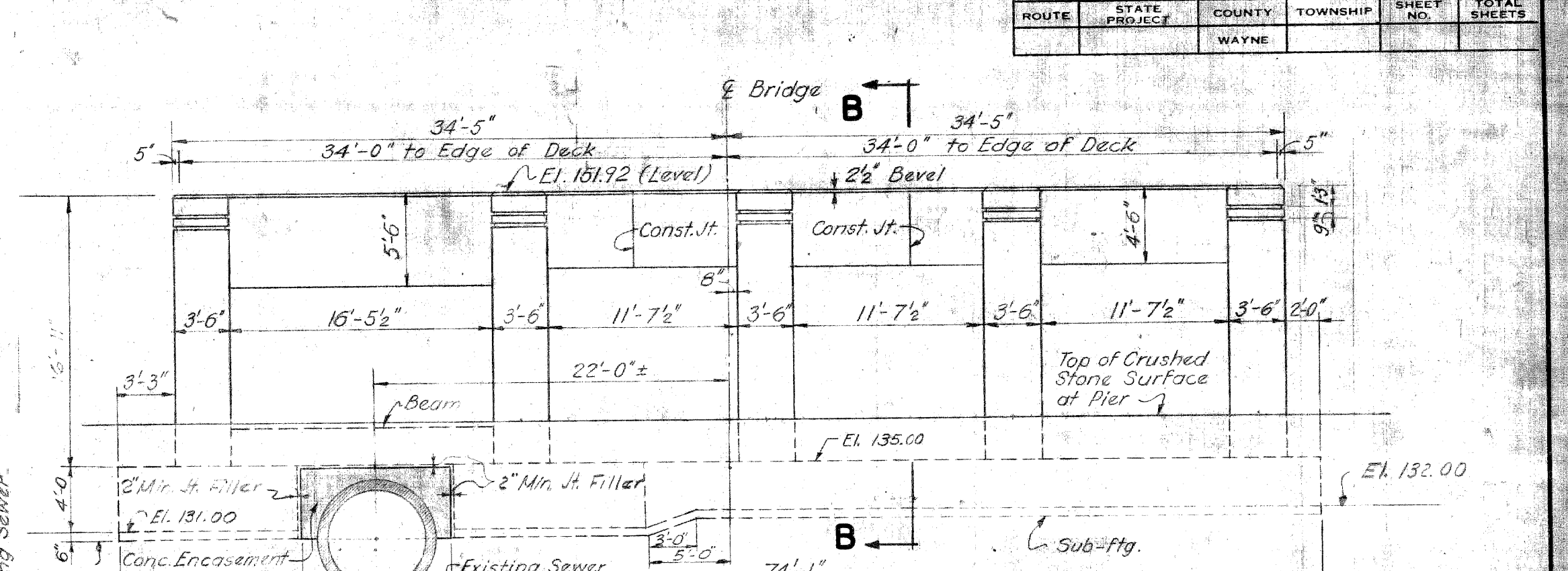

ELEVATION OF PIER
Scale: 1/8" = 1'-0"

FOOTING PRESSURES
IN LBS. PER SQ. FT.

	Max. Toe from D.L.	Allowable R=1.0	Max. Toe from D.L. & LL	Allowable R=1.5	Average D.L.	Average D.L. & LL
Abutments	4180	6550	4690	9530	3320	3820
Pier	3490	6550	4200	9530	3490	4200
Walls	4960	6550	-	-	2760	-

Design Specifications:
Michigan State Highway Department's Specifications
for the Design of Highway Bridges, 1936 Edition. Deflection
from Live Load and Impact equal not more than 1/1000 of the Span Length.

Loading:
H 20 - S16 - 44
Concrete:
Footings, Grade A (6A)
Above Footings, Grade A (6B)
Superstructure, Grade A (6B)

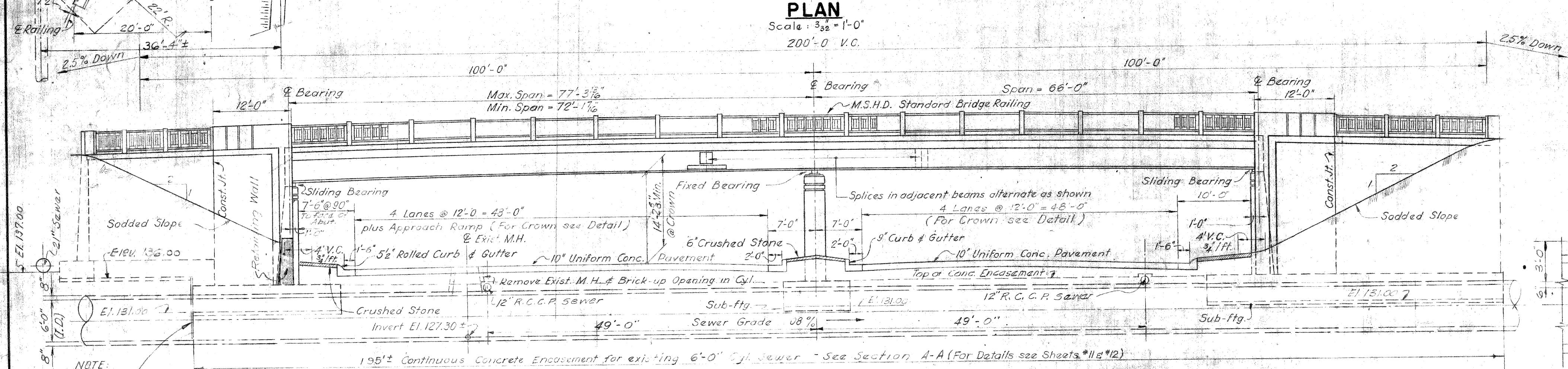

SOUTH ELEVATION
Scale: 3/32" = 1'-0"

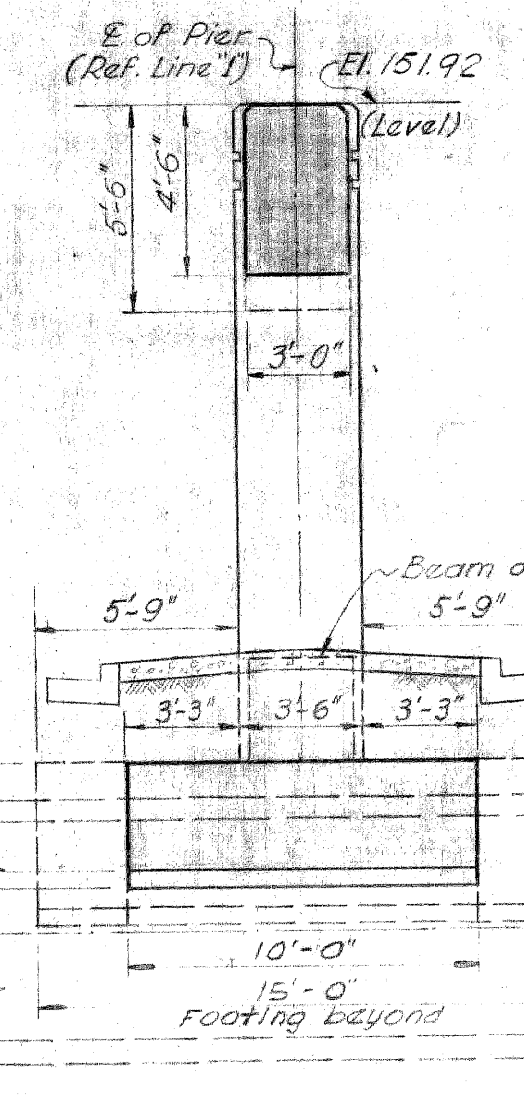

PIER SECTION B-B
Scale: 3/16" = 1'-0"

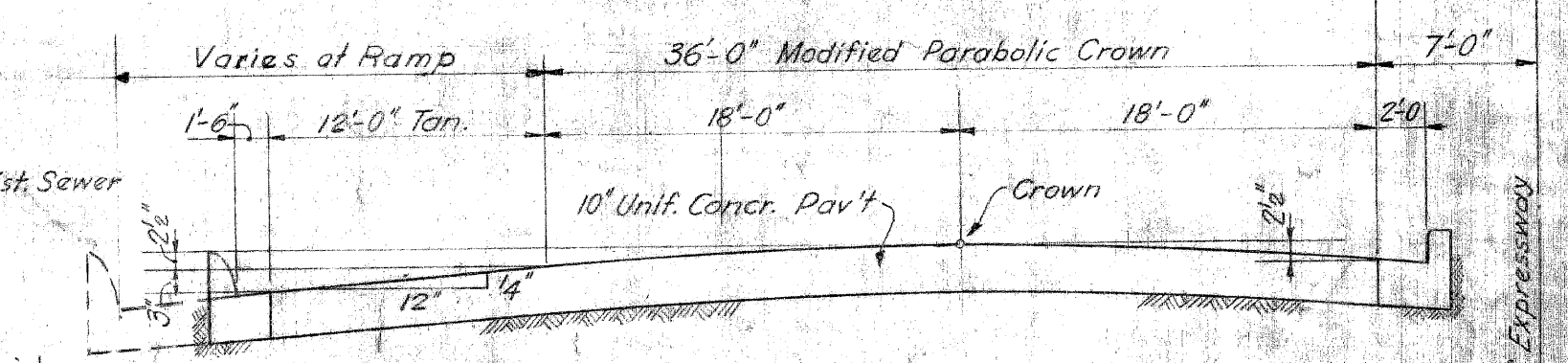

TYPICAL EXPRESSWAY CROWN DETAIL
Scale: None

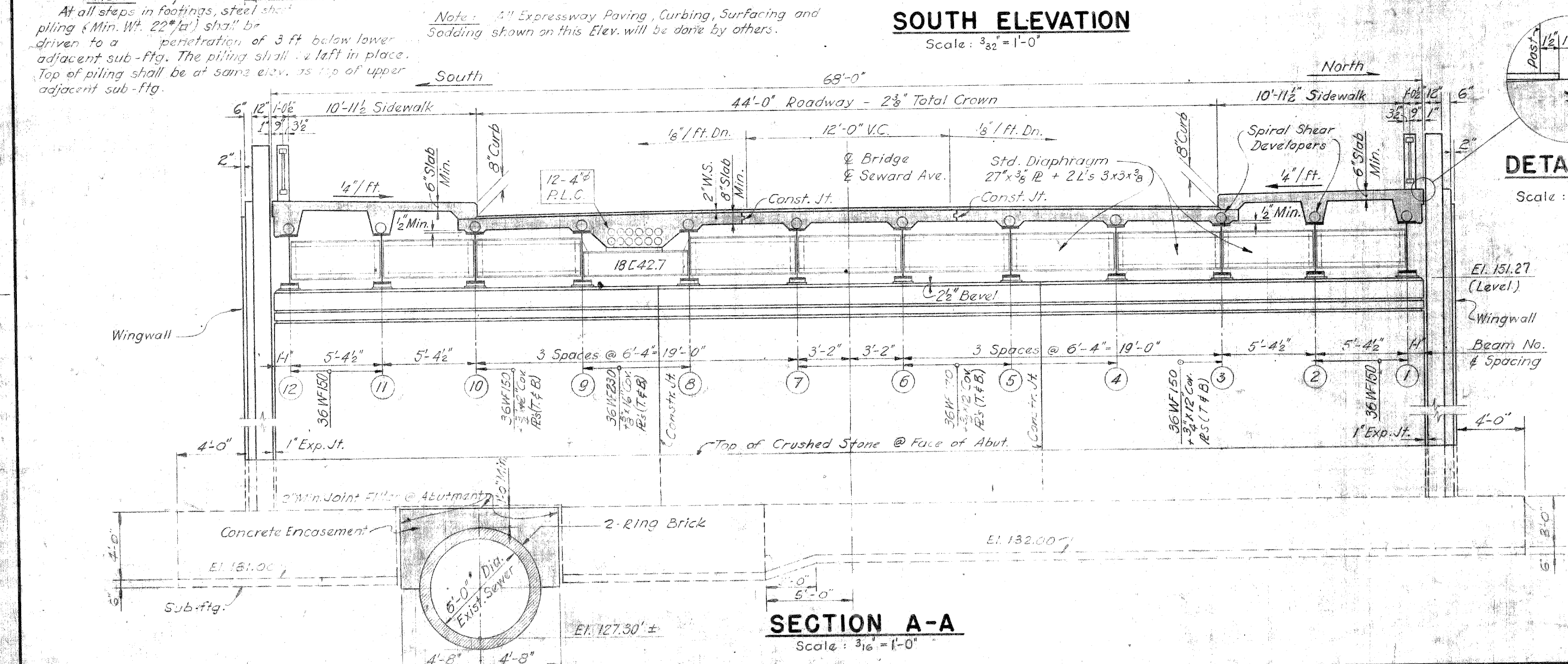

SECTION A-A
Scale: 3/16" = 1'-0"

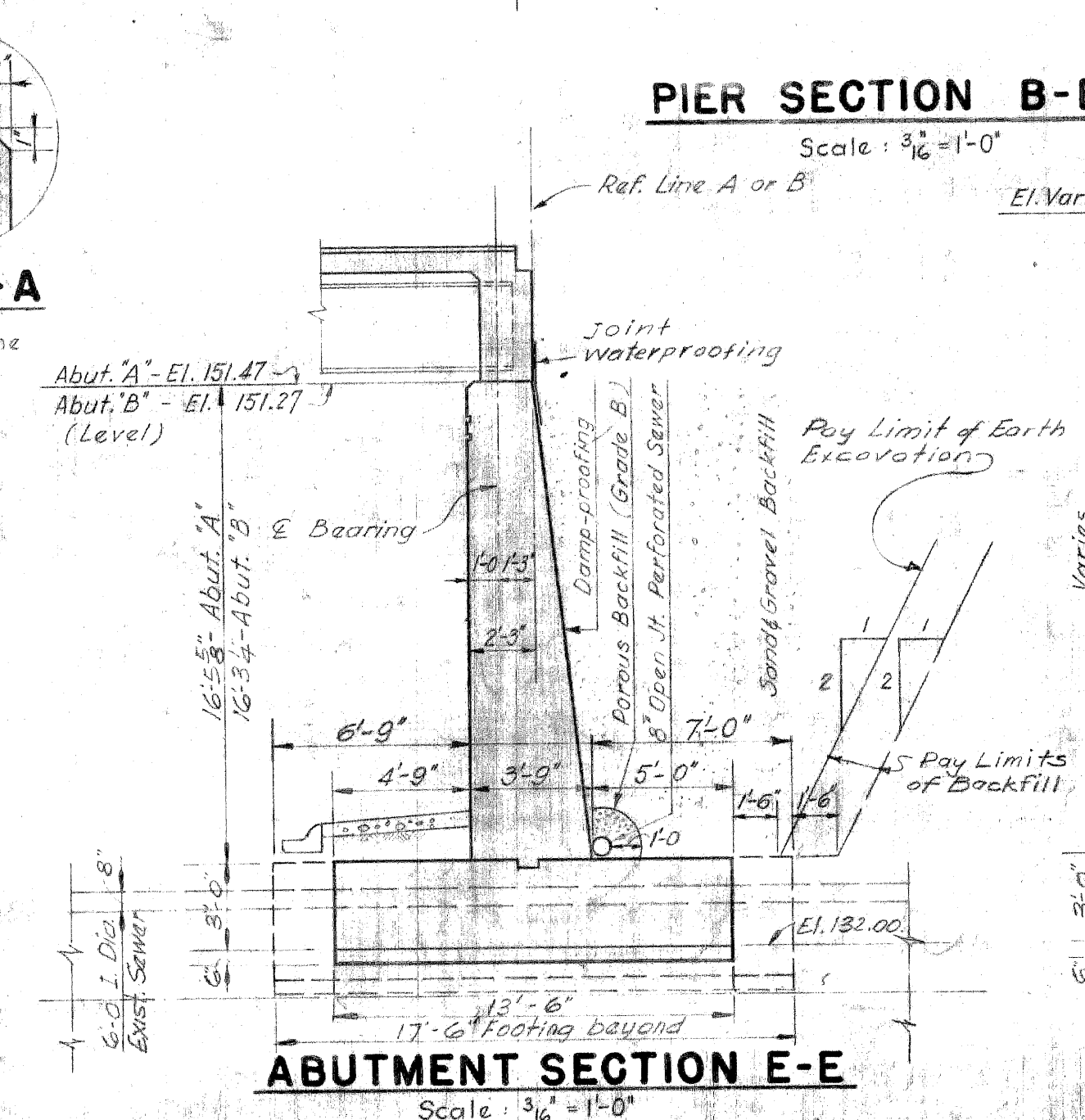

ABUTMENT SECTION E-E
Scale: 3/16" = 1'-0"

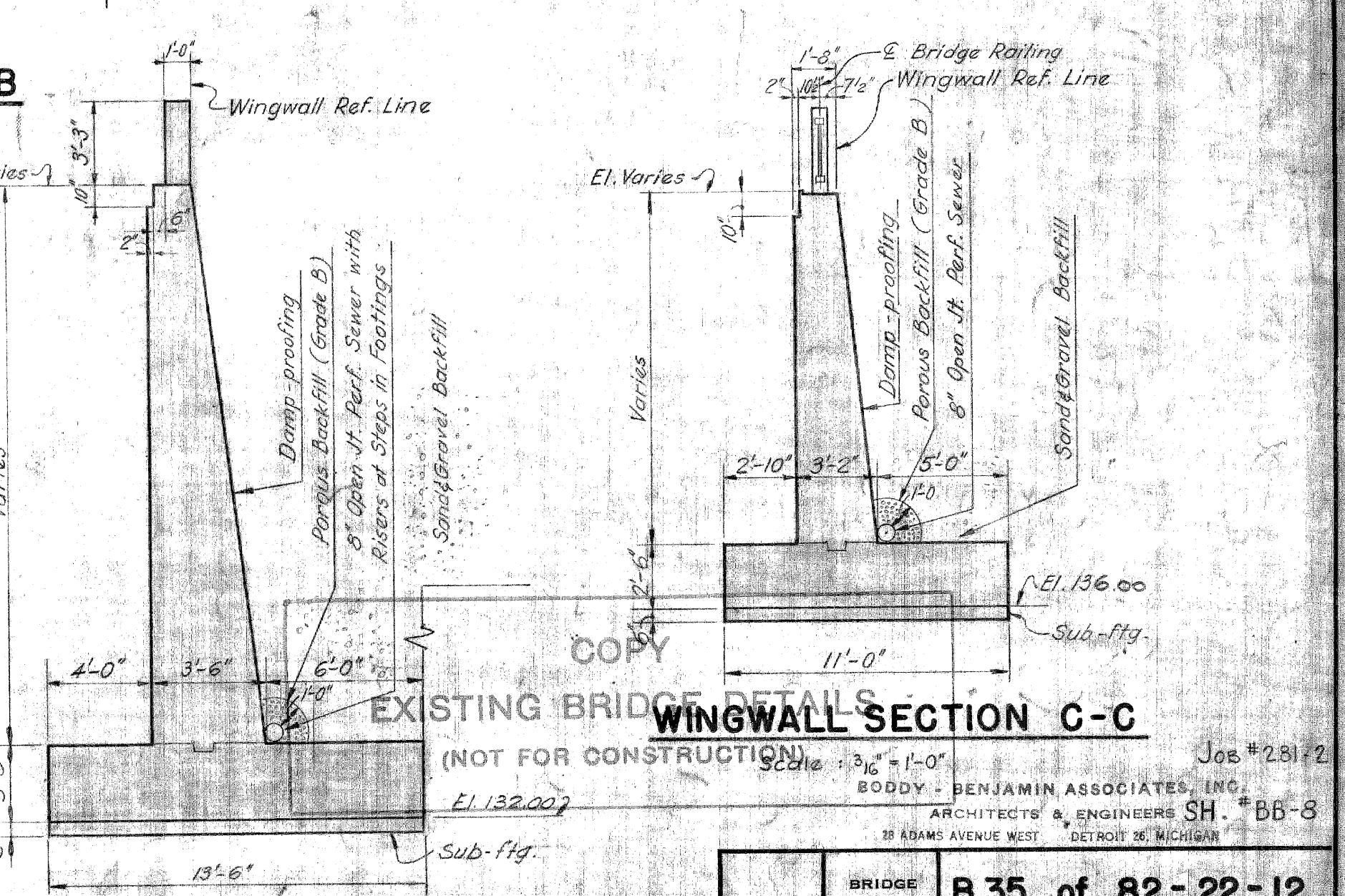

WINGWALL SECTION D-D
Scale: 3/16" = 1'-0"

WINGWALL SECTION C-C
Scale: 3/16" = 1'-0"

REVISIONS

2) Length of Expressway	1) Minor Revisions of Existing Sewer
3) Minor Revisions 11-13-52 T.A.	added 11-26-53 D.L.L.

DRAWN BY H. NAGELS
CHECKED BY C. L. PIEN
DATE 7-11-52
APPROVED [Signature]
ENGINEER OF DESIGN, STRUCTURES AND EXPRESSWAYS

APPROVED [Signature]
ENGINEER OF BRIDGES AND STRUCTURES
APPROVED [Signature]
COUNTY HIGHWAY ENGINEER

BOARD OF WAYNE COUNTY ROAD COMMISSIONERS
DETROIT, MICHIGAN
MICHAEL J. O'BRIEN
JOHN P. O'HARA
CHARLES L. WILSON

JOHN C. LODGE EXPRESSWAY
SEWARD AVENUE CROSSING
GENERAL PLAN OF STRUCTURE

STATE PROJECT	82-128	COUNTY JOB	865
ISSUE NO.	4	SHEET NO.	9
DATE	2-10-53		

504 of 82112