

SCALE: 1" = 100'

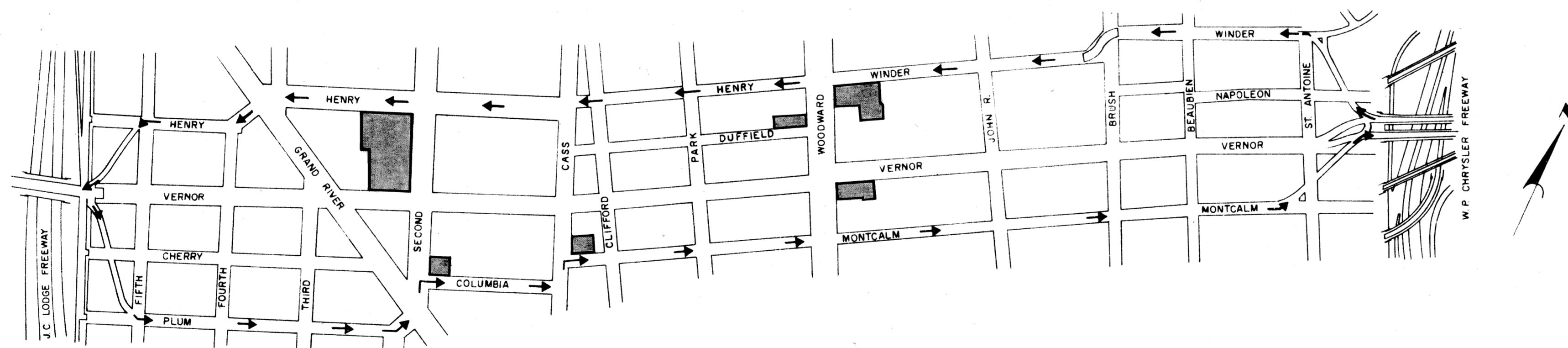

VERNOR HIGHWAY DETOUR PLAN

SCALE: 1" = 400'

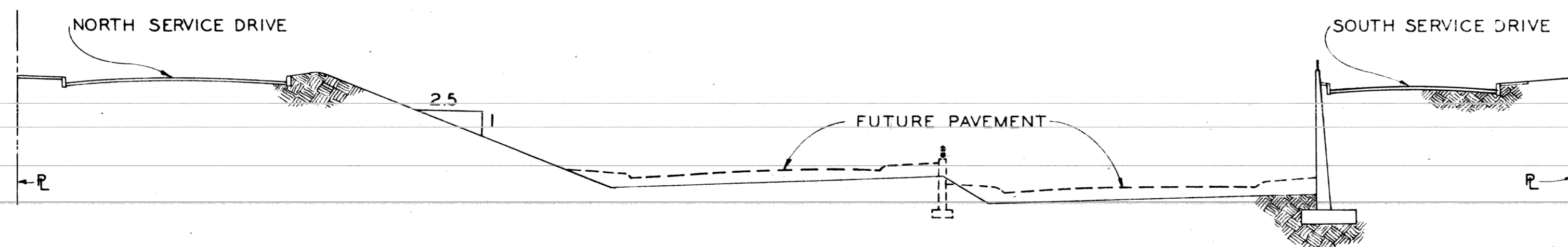

TYPICAL CROSS-SECTION

**ITEMS IN CONTRACT**

**UTILITY ALTERATIONS**

**SEWERS**  
 First-Hamilton Relief Sewer Reconstruction  
 Third Ave. Sewer Relocation  
 Fourth Ave. Sewer Connection  
 4'-6" Cylinder Sewer Crossing East of Fourth Ave.  
 Miscellaneous Alterations

**WATER MAINS**  
 Header Main-North Side and South Side  
 Miscellaneous Alterations

**LIGHTING**  
 Alterations to city power, communications and lighting facilities  
 Service Drive Lighting

**BRIDGES AND STRUCTURES**

N'bd to W'bd turning Rdwy over E'bd. Turning Rdwy and Fisher Freeway ----- S-15 of 82195B  
 E'bd. Exit Ramp over E'bd. Turning Rdwy ----- S-16 of 82195B  
 W'bd. Entrance Ramp over N'bd. and S'bd. Turning Rdwy ----- S-17 of 82195B  
 Third Avenue ----- S-18 of 82195D  
 Grand River Avenue ----- S-19 of 82195D  
 Second Avenue ----- S-20 of 82195D  
 Pumping Station ----- D-01 of 82195D

**Retaining Walls**  
 Along North and South Sides of Freeway and along Entrance Ramp  
 Median Retaining Wall

**SURFACE STREETS**

Grading, Drainage and Paving- North Service Drive from Fourth to Second  
 Grading, Drainage and Paving- South Service Drive from Fourth to Second  
 Grading, Drainage and Paving of Detours for Grand River, Second and Third  
 Miscellaneous Alley Connections

**DEPRESSED FREEWAY**

Grading  
 Drainage  
 Fencing

COORD	DESCRIPTION	DRN	CHK'D	AP'VD	DATE
REVISIONS LOCATED BY COORDINATES ON SHEET					

REFERENCE DRAWINGS	DESIGNED BY	APPROVED:
	DRAWN BY F. A. Callabiano	
	TRACED BY	
	CHECKED BY G. D. Milz	

**CITY OF DETROIT**  
 DEPARTMENT OF PUBLIC WORKS  
 CITY ENGINEERS OFFICE  
 BUREAU OF HIGHWAYS AND EXPRESSWAYS

<b>FISHER FREEWAY</b>	
PLAN OF PROPOSED CONSTRUCTION CONTRACT	
LODGE FREEWAY TO SECOND	

SHEET	OF	SHEETS
JOB No. 1002(1) & (2)		
DRWG No. F-2A		
DATE	9-29-64	

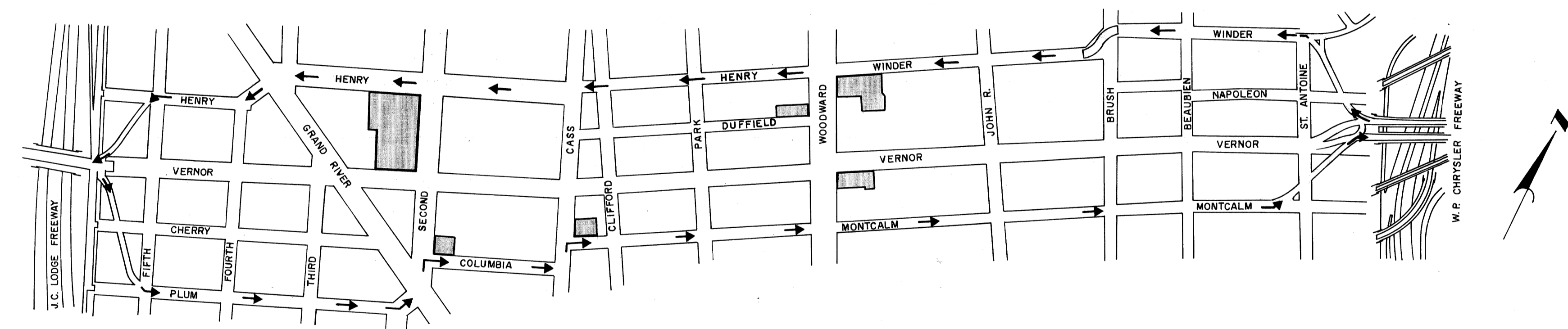
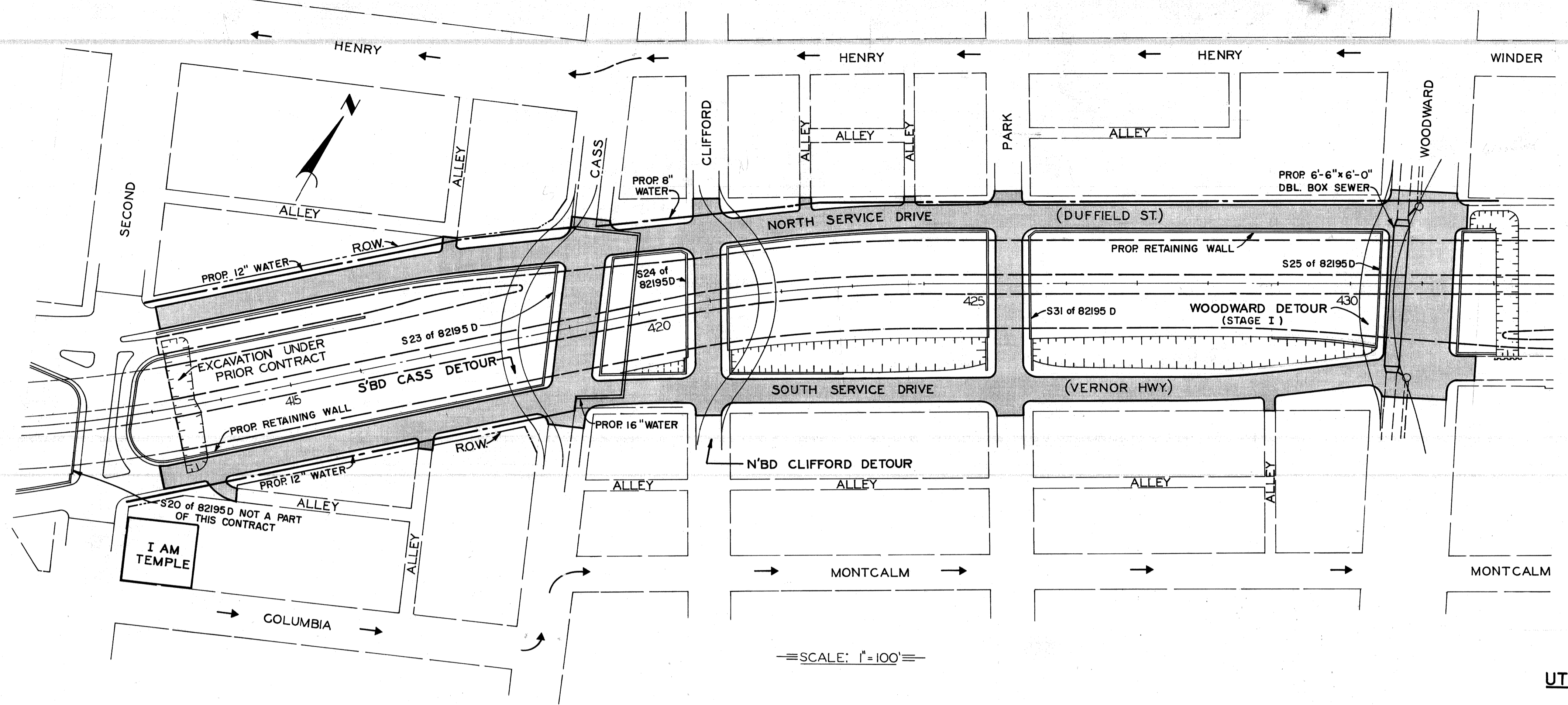

VERNOR HIGHWAY DETOUR PLAN  
SCALE: 1" = 400'

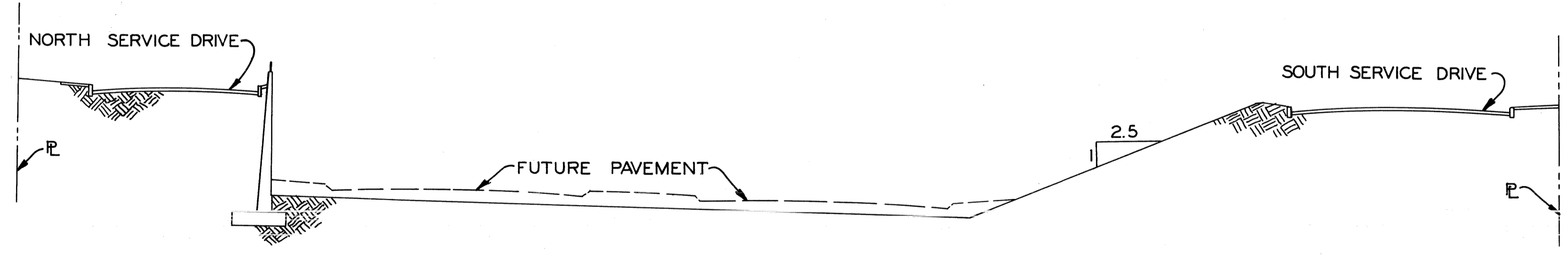

TYPICAL CROSS-SECTION

**ITEMS IN CONTRACT**

**UTILITY ALTERATIONS**

- SEWERS**
- Woodward Ave. Sewer Reconstruction.
- Miscellaneous Sewer Alterations.
- WATER**
- Relocation of 16" Cass Ave. Water Main.
- North Side Header Main.
- South Side Header Main.
- Miscellaneous Alterations.

- PLC**
- Miscellaneous Alterations to City Power, Communications, and Lighting Facilities.

**BRIDGES AND STRUCTURES**

- Cass Ave. . . . . S23 of 82195D
- Clifford St. . . . . S24 of 82195D
- Park Ave. . . . . S31 of 82195D
- Woodward Ave. . . . . S25 of 82195D
- Retaining Walls North and South Side of Freeway and along Exit Ramp.

**SERVICE DRIVES**

- North and South Service Drives - Grading, Drainage, Paving, and Lighting from Second to Woodward.

**DEPRESSED FREEWAY**

- Rough Grading, Drainage, Sodding and Fencing.

DESIGNED BY	M. POLITO
DRAWN BY	
TRACED BY	
CHECKED BY	N. McLEAN
APPROVED:	CITY ENGINEER

**CITY OF DETROIT**  
 DEPARTMENT OF PUBLIC WORKS  
 CITY ENGINEERS OFFICE  
 BUREAU OF HIGHWAYS AND EXPRESSWAYS

**FISHER FREEWAY**  
 PLAN OF PROPOSED CONSTRUCTION CONTRACT  
 SECOND TO WOODWARD

SHEET	OF	SHEETS
CONTRACT No.		
DRWG No. <b>F3</b>		
DATE <b>JUNE 1, 1964</b>		

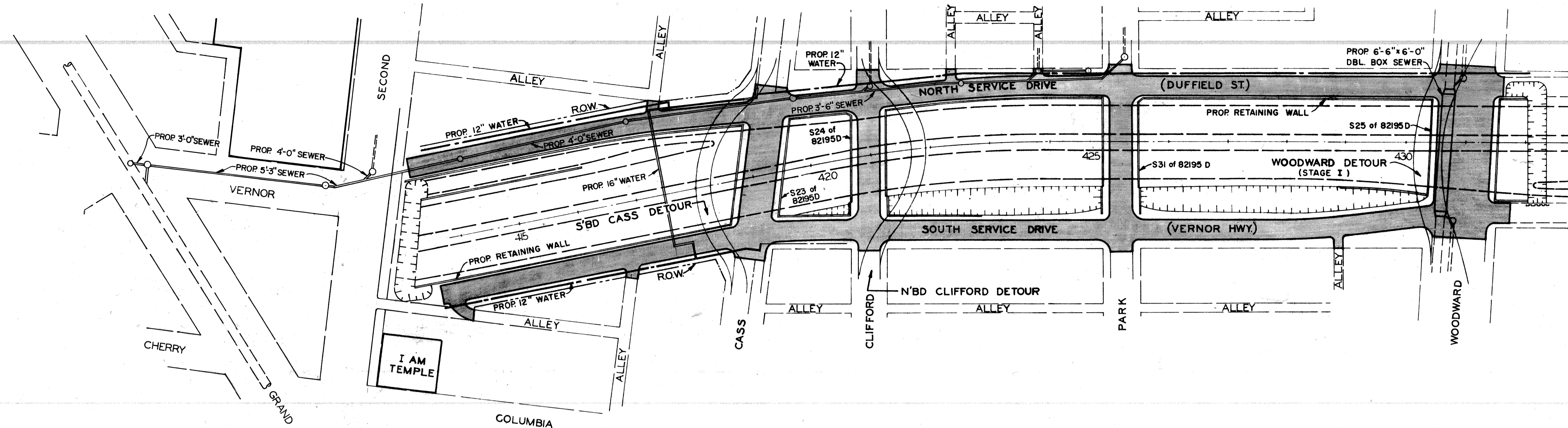

**ITEMS IN CONTRACT**

**UTILITY ALTERATIONS**

**SEWERS**

Interceptor Sewer - Park Ave. to Grand River  
 Connecting Sewer in Henry St  
 Woodward Ave. Sewer Reconstruction.  
 Miscellaneous Sewer Alterations.

**WATER**

Relocation of 16" Cass Ave. Water Main.  
 North Side Header Main.  
 South Side Header Main.  
 12" in Plum St and Fourth Ave.  
 Miscellaneous Alterations.

**PLC**

Miscellaneous Alterations to City Power, Communications, and Lighting Facilities.

**BRIDGES AND STRUCTURES**

Cass Ave. . . . . S23 of 82195D  
 Clifford St. . . . . S24 of 82195D  
 Park Ave. . . . . S31 of 82195D  
 Woodward Ave. . . . . S25 of 82195D  
 Retaining Walls North and South Side of Freeway and along Exit Ramp.

**SERVICE DRIVES**

North and South Service Drives - Grading, Drainage, Paving, and Lighting from Second to Woodward.

**DEPRESSED FREEWAY**

Rough Grading, Drainage, and Fencing

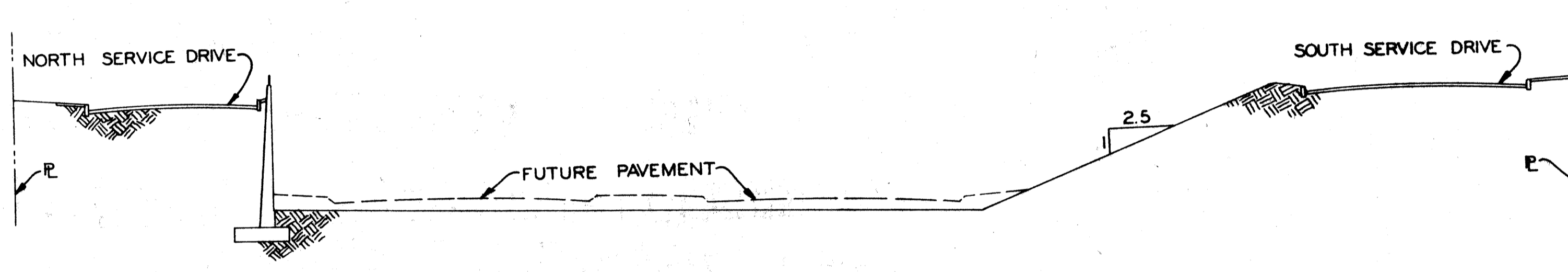
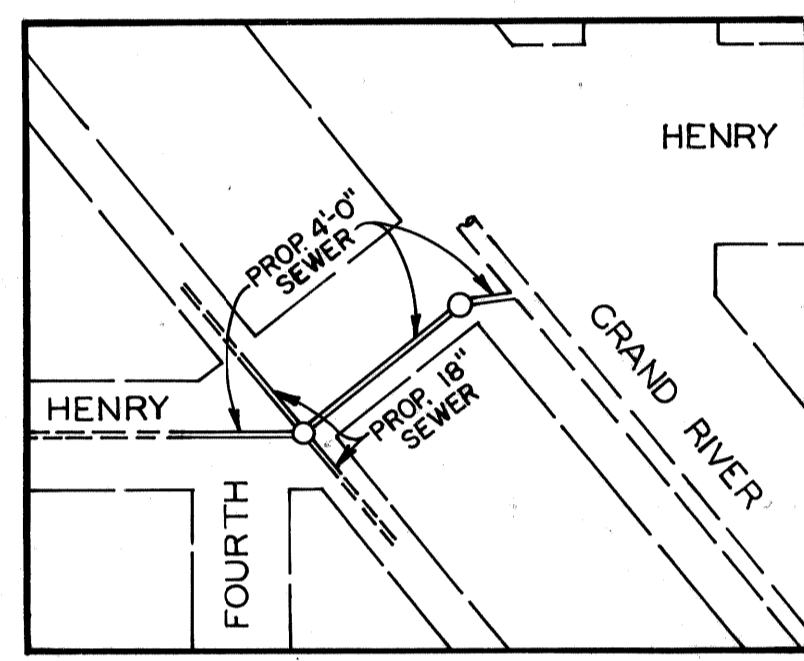

**TYPICAL CROSS-SECTION**

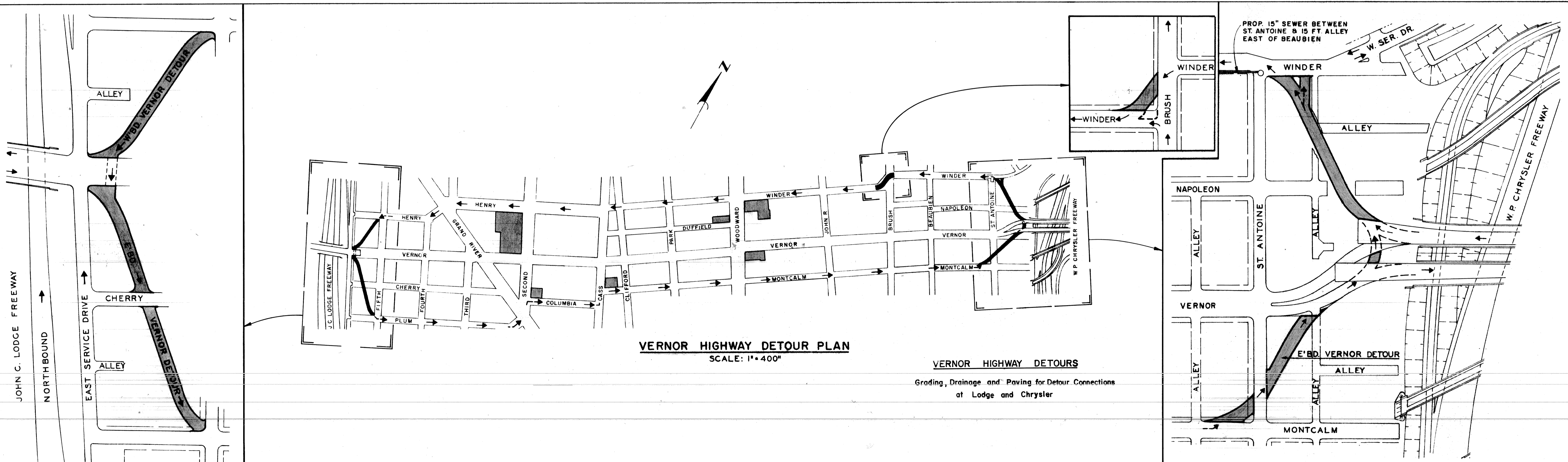

COORD	DESCRIPTION	DRN	CHK	APVD	DATE
	REVISIONS LOCATED BY COORDINATES ON SHEET				

REFERENCE DRAWINGS	DESIGNED BY	APPROVED:
	F.A.C. & M.A.P.	
	DRAWN BY	
	G.D.M. & N.McL.	
	TRACED BY	
	CHECKED BY	

**CITY OF DETROIT**  
 DEPARTMENT OF PUBLIC WORKS  
 CITY ENGINEERS OFFICE  
 BUREAU OF HIGHWAYS AND EXPRESSWAYS

**FISHER FREEWAY**  
 PLAN OF PROPOSED CONSTRUCTION CONTRACT  
 SECOND TO WOODWARD

SHEET	OF	SHEETS
CONTRACT NO. 1002(1) & (2), 897B (6)		
DRWG No. F-3A		
DATE 9-28-64		

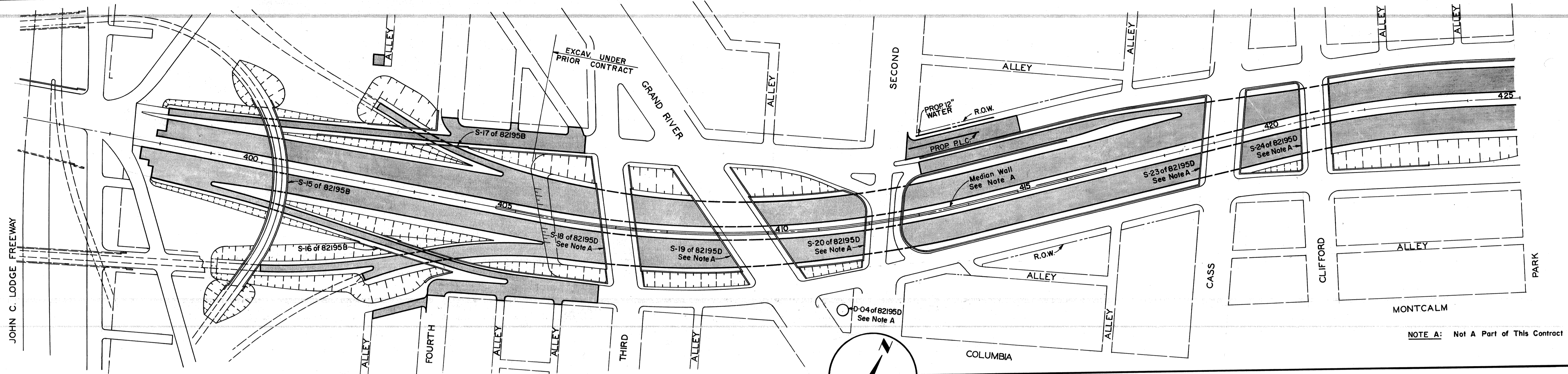

NOTE A: Not A Part of This Contract

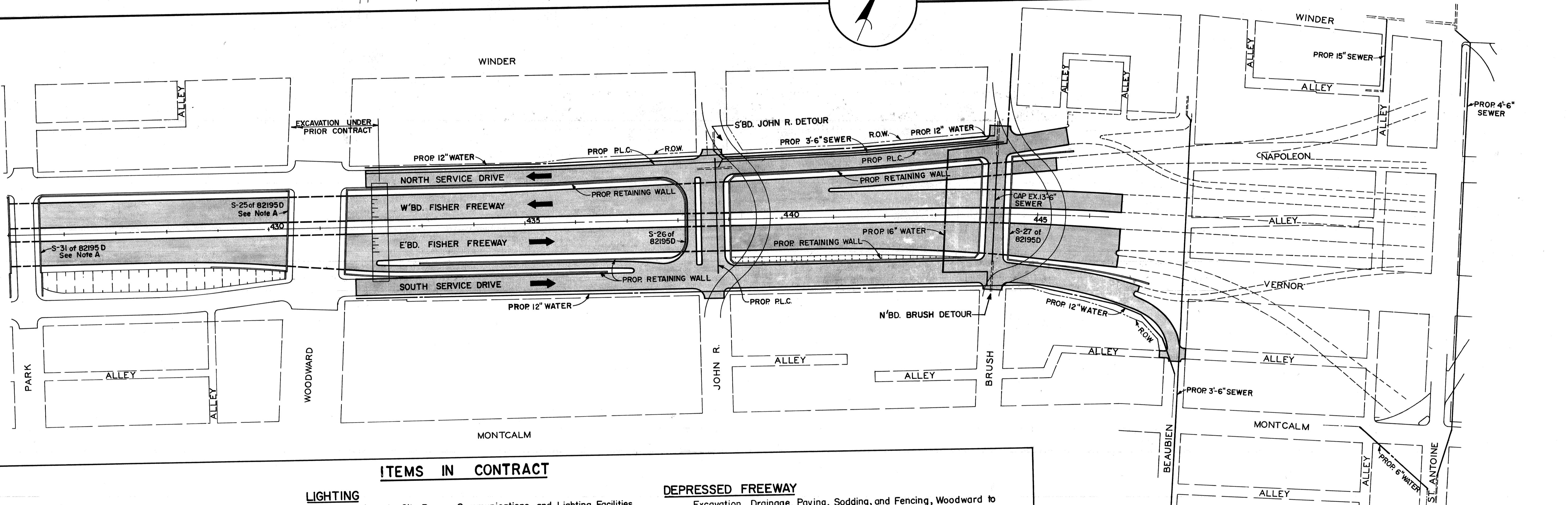

**ITEMS IN CONTRACT**

**SEWERS**

Interceptor Sewer North Service Drive, John R. to Brush  
 Cap Existing 13'-6" Sewer in Brush  
 Reconstruct Beaubien Sewer, Napoleon to Columbia  
 Reconstruct St. Antoine Sewer, Winder to Montcalm  
 Miscellaneous Sewer Alterations

**LIGHTING**

Alterations to City Power, Communications, and Lighting Facilities  
 North Service Drive Lighting, Woodward to Brush  
 South Service Drive Lighting, Woodward to Beaubien  
 Freeway Lighting, Lodge to West of Beaubien

**DEPRESSED FREEWAY**

Excavation, Drainage, Paving, Sodding, and Fencing, Woodward to West of Beaubien and Lodge to Third

Paving and Sodding, Third to Woodward

**BRIDGES AND STRUCTURES**

John R. St. - S26 of 82195D  
 Brush St. - S27 of 82195D  
 Retaining Walls North and South Side of Freeway and along Exit Ramp at John R. and portion of Wall along Exit Ramp at Second.  
 N'bd. to W'bd. Turning Roadway - S15 of 82195B  
 Grand River Exit Ramp - S16 of 82195B  
 Grand River Entrance Ramp - S17 of 82195B

**WATER**

Header Main in North Service Drive, Woodward to Brush and East of Second  
 Header Main in South Service Drive, Woodward to Beaubien  
 Relocation of Brush Main with 16" Water Crossing  
 Connections at Montcalm and St. Antoine  
 Miscellaneous Water Alterations

**SERVICE DRIVES**

North Service Drive - Woodward to Brush and South Service Drive - Woodward to Beaubien, Grading, Drainage, and Paving  
 North Service Drive - East of Second, Grading and Paving  
 North and South Service Drives - Fourth to Third, Grading, Drainage, and Paving

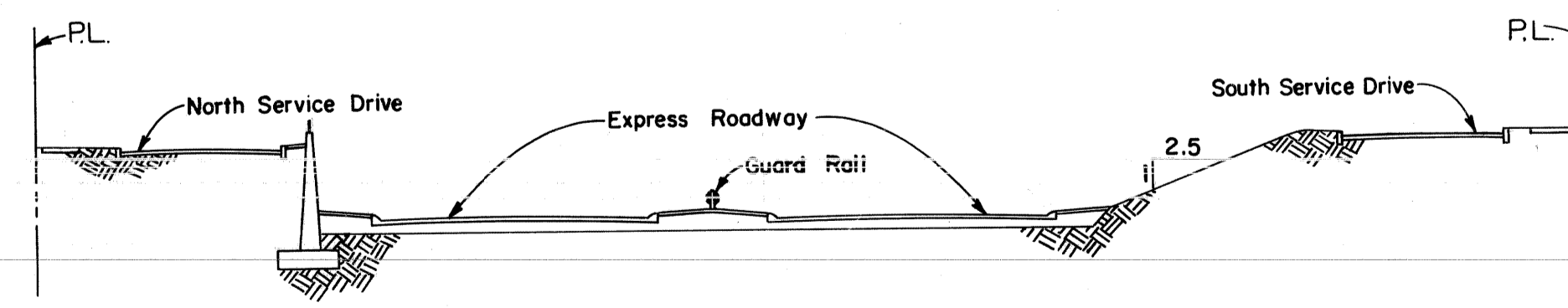

**FISHER FREEWAY**

**PLAN OF PROPOSED CONSTRUCTION CONTRACT  
 LODGE FREEWAY TO BEAUBIEN**

SHEET \_\_\_ OF \_\_\_ SHEETS  
 CONTRACT NO. 1002(1), 1002(2), & 897B6  
 DRWG. NO. F-4A  
 DATE Mar. 31, 1965

**CITY OF DETROIT**  
 DEPARTMENT OF PUBLIC WORKS  
 CITY ENGINEERS OFFICE  
 BUREAU OF HIGHWAYS AND EXPRESSWAYS

DESIGNED BY	M. POLITO	APPROVED:	
DRAWN BY			
TRACED BY			
CHECKED BY	N. McLEAN		

REVISIONS LOCATED BY COORDINATES ON SHEET

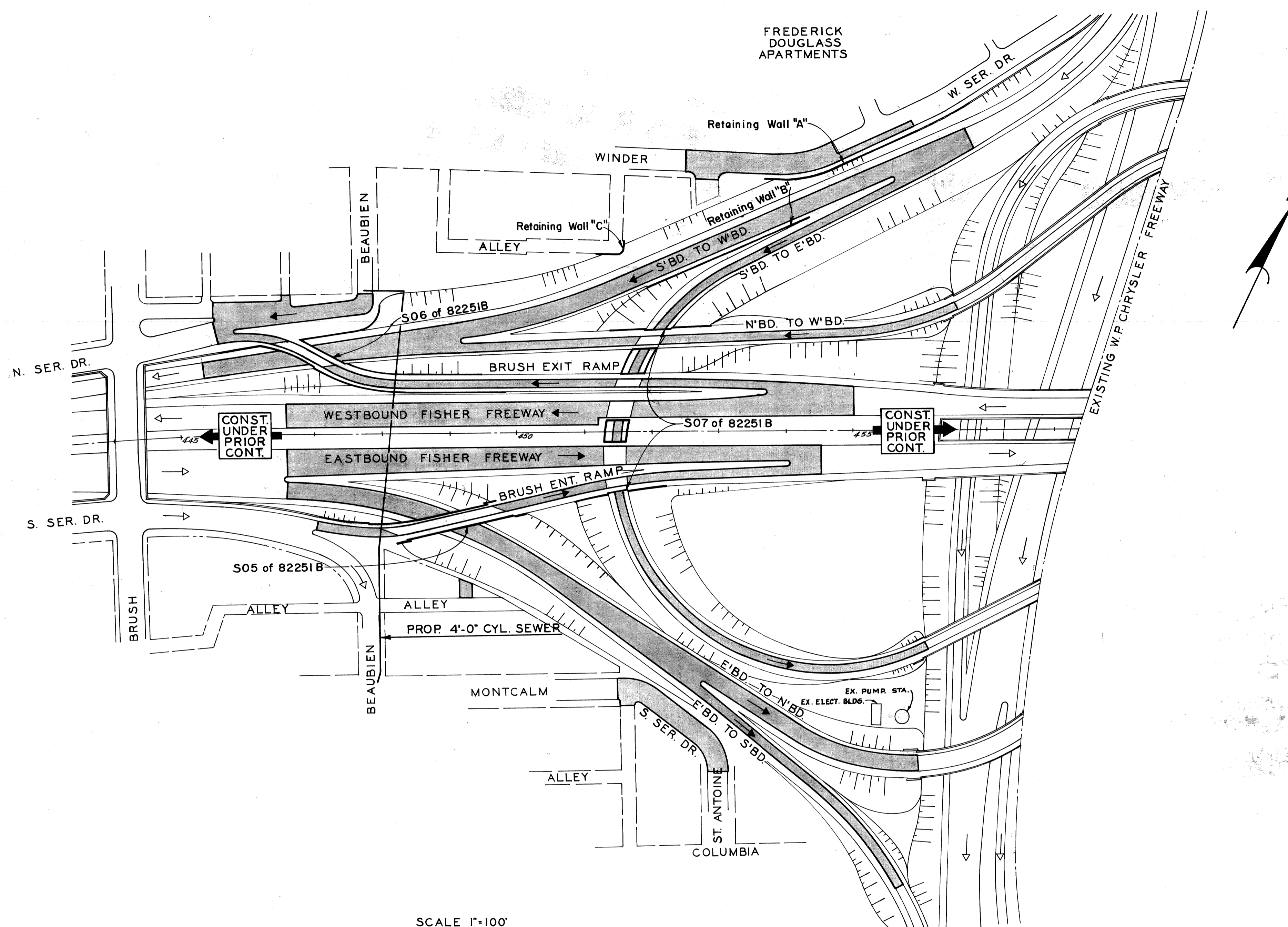

**ITEMS IN CONTRACT**

**UTILITY ALTERATIONS**

**SEWERS**

- Beaubien St. Sewer Relocation
- Miscellaneous Alterations

**LIGHTING**

- Freeway Lighting West of Beaubien to Chrysler
- Alterations to City Power, Communications and Lighting Facilities
- Service Drive Lighting

**SERVICE DRIVES**

**GRADING, DRAINAGE, AND PAVING**

- North Service Drive - St. Antoine East to Existing Service Drive
- North Service Drive - East of Brush to Beaubien
- South Service Drive - Montcalm to St. Antoine

**DEPRESSED FREEWAY**

- Grading, Drainage, Subbase, Paving, Sodding and Fencing

**BRIDGES AND STRUCTURES**

- Brush Entrance Ramp ----- S05 of 82251 B
- Brush Exit Ramp ----- S06 of 82251 B
- Fisher Freeway, Brush Entrance and Exit Ramps, and N'bd. to W'bd. Turning Roadway over S'bd. to E'bd. Turning Roadway ----- S07 of 82251 B

**Retaining Walls**

- At Winder Street - Wall "A"
- Between S'bd. to W'bd. and S'bd. to E'bd. Turning Roadways - Wall "B"
- At Alley near S'bd. to W'bd. Turning Roadway - Wall "C"

SCALE 1"=100'

<table border="1" style="width: 100%; border-collapse: collapse;"> <tr> <td style="width: 10%;">COORD.</td> <td style="width: 50%;">DESCRIPTION</td> <td style="width: 10%;">DRN</td> <td style="width: 10%;">CHK'D</td> <td style="width: 10%;">AP'VD</td> <td style="width: 10%;">DATE</td> </tr> <tr> <td colspan="6">REVISIONS LOCATED BY COORDINATES ON SHEET</td> </tr> </table>		COORD.	DESCRIPTION	DRN	CHK'D	AP'VD	DATE	REVISIONS LOCATED BY COORDINATES ON SHEET						REFERENCE DRAWINGS DESIGNED BY DRAWN BY TRACED BY CHECKED BY	DESIGNED BY DRAWN BY TRACED BY CHECKED BY	APPROVED:  CITY ENGINEER	CITY OF DETROIT DEPARTMENT OF PUBLIC WORKS CITY ENGINEERS OFFICE BUREAU OF HIGHWAYS AND EXPRESSWAYS	<b>FISHER FREEWAY</b>  PLAN OF PROPOSED CONSTRUCTION CONTRACT BRUSH TO CHRYSLER FREEWAY	SHEET ___ OF ___ SHEETS CONTRACT No. 897 B 6 DRWG No. F-5 DATE MAY 20, 1965
		COORD.	DESCRIPTION	DRN	CHK'D	AP'VD	DATE												
REVISIONS LOCATED BY COORDINATES ON SHEET																			
G. D. MILZ CITY ENGINEER	F. A. CALTABIANO																		