

86-22-28  
 STEEL SHEETING LOCATION  
 # 502-04 ASHLAND  
 9/28/86  
 J. DREWS P.C.

Sheet Section Identification

Job Number

Page

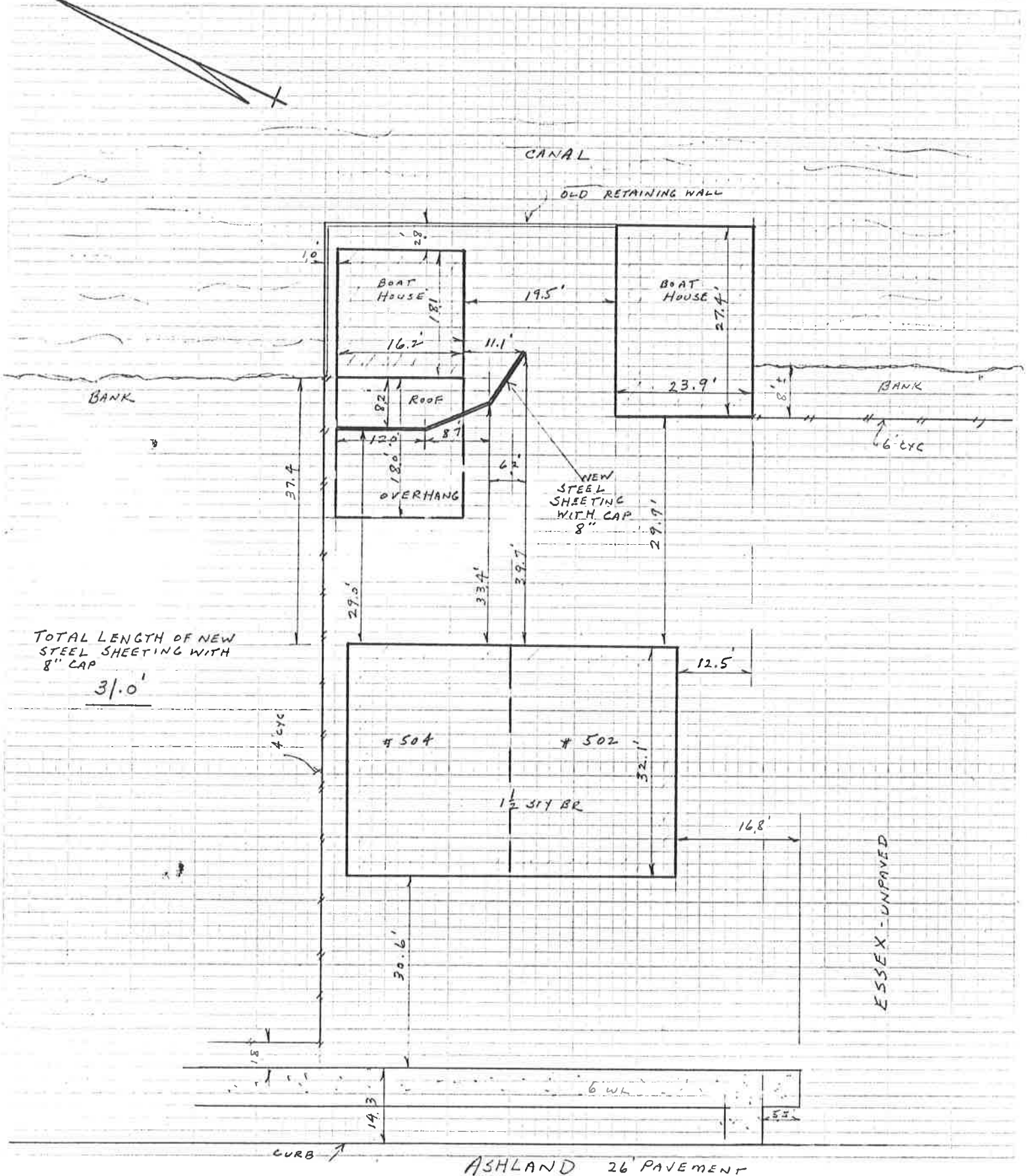

TOTAL LENGTH OF NEW  
 STEEL SHEETING WITH  
 8" CAP  
31.0'

ESSEX - UNPAVED

ASHLAND 26' PAVEMENT

SUBJECT INDIVIDUAL LOCATION COST DETAIL

DETAIL 502 ASHLAND STREET

FLOOD CONTROL

DATE MAY 16, 1986

JOB NO. 86-22-28

SHEET NO. OF SHEETS

MADE BY W. RANKIN

CHECKED BY

LABOR 2,487.48

EQUIPMENT 1,541.45

MATERIAL 1,016.26

JOBSITE DIRECT COST 215.35

INDIRECT JOBSITE COST 352.84

GENERAL LIABILITY INSURANCE 414.47

PLUS - 10% OVERHEAD 602.79

PLUS - 10% PROFIT 994.60

PLUS - 1% BOND 76.25

TOTAL TO DATE \$ 7,701.49



1101 (7/84)

# COPY FORCE ACCOUNT STATEMENT

This information required by MDOT in order to record charges on force account work performed.

FILE 104

C. S. ID. - Job No. \_\_\_\_\_

Fed. Item No. \_\_\_\_\_ Year \_\_\_\_\_ Route No. \_\_\_\_\_

Fed. No. \_\_\_\_\_

Length and Type of Work MANPOWER FOR 502 ASHLAND

To Accompany Recommendation No. \_\_\_\_\_ Date \_\_\_\_\_

Contractor O'LAUGHLIN CONSTRUCTION COMPANY  
Address 24460 NOVI ROAD  
NOVI, MICHIGAN 48050

| PAYROLL AND EQUIPMENT RENTAL                                                                                                     |               | Date—Month of <u>MARCH</u> 19 <u>86</u> |  |  |     | Total Hours | Rate  | Amount          | Credit Time |
|----------------------------------------------------------------------------------------------------------------------------------|---------------|-----------------------------------------|--|--|-----|-------------|-------|-----------------|-------------|
| Name of Employee                                                                                                                 | Class of Work |                                         |  |  |     |             |       |                 |             |
| ROY WASHINGTON                                                                                                                   | FOREMAN       |                                         |  |  | 4.0 | 4.0         | 22.78 | 91.12           |             |
|                                                                                                                                  |               |                                         |  |  | 4.5 | 4.5         | 44.99 | 202.46          |             |
| PHILIP CHAMBERS                                                                                                                  | FOREMAN       |                                         |  |  | 8.0 | 8.0         | 29.99 | 239.92          |             |
|                                                                                                                                  |               |                                         |  |  | 4.5 | 4.5         | 32.15 | 144.68          |             |
| AL MATTISON                                                                                                                      | LABORER       |                                         |  |  | 8.0 | 8.0         | 21.43 | 171.44          |             |
|                                                                                                                                  |               |                                         |  |  | 4.5 | 4.5         | 32.15 | 144.68          |             |
| CYNTHIA GRIER                                                                                                                    | LABORER       |                                         |  |  | 8.0 | 8.0         | 21.43 | 171.44          |             |
| <b>SUB-TOTAL</b>                                                                                                                 |               |                                         |  |  |     |             |       | <b>1,165.74</b> |             |
| Itemize % of Workmen's Comp., Old Age Pension, Social Security, Unemployment Compensation, Public Liability and Property Damage. |               |                                         |  |  |     |             |       | Total           |             |

| STATEMENT OF BILLS FOR MATERIALS AND FREIGHT    |                |      | Amount | Date of Payment |
|-------------------------------------------------|----------------|------|--------|-----------------|
| Date                                            | Purchased from | Item |        |                 |
|                                                 |                |      |        |                 |
|                                                 |                |      |        |                 |
|                                                 |                |      |        |                 |
| Attach Original Bills for Materials and Freight |                |      | Total  |                 |

I hereby certify that the above is a true and correct statement of labor performed and materials used in executing the work and that any materials taken from Contractor's stock represent actual cost paid for such materials. This work is covered by preliminary Authorization No. \_\_\_\_\_, Extra No. \_\_\_\_\_, dated \_\_\_\_\_

*R. L. Boyatzis*  
Contractor

Checked by \_\_\_\_\_ Resident or Project Engineer      Approved by \_\_\_\_\_ District Engineer      Date \_\_\_\_\_





# COPY

## FORCE ACCOUNT STATEMENT

*This information required by MDOT in order to record charges on force account work performed.*

FILE 104

C. S. ID. - Job No. \_\_\_\_\_

Fed. Item No. \_\_\_\_\_ Year \_\_\_\_\_ Route No. \_\_\_\_\_

Fed. No. \_\_\_\_\_

Contractor O'LAUGHLIN CONSTRUCTION COMPANY  
 Address 24460 NOVI ROAD  
NOVI, MICHIGAN 48050

Length and Type of Work MANPOWER FOR 502 ASHLAND

To Accompany Recommendation No. \_\_\_\_\_ Date \_\_\_\_\_

| PAYROLL AND EQUIPMENT RENTAL                                                                                                     |                | Date--Month of |  |  |  |     |  |  |  |             |       |        |  |  |  |  |  |  |             |  |
|----------------------------------------------------------------------------------------------------------------------------------|----------------|----------------|--|--|--|-----|--|--|--|-------------|-------|--------|--|--|--|--|--|--|-------------|--|
| Name of Employee                                                                                                                 | Class of Work  |                |  |  |  |     |  |  |  | Total Hours | Rate  | Amount |  |  |  |  |  |  | Credit Time |  |
| PATRICK McCUE                                                                                                                    | SUPERINTENDENT |                |  |  |  | 25  |  |  |  | 2.0         | 35.00 | 70.00  |  |  |  |  |  |  |             |  |
| GORDON PENNER                                                                                                                    | FOREMAN        |                |  |  |  | 2.0 |  |  |  | 2.0         | 35.33 | 70.66  |  |  |  |  |  |  |             |  |
| ARVIL WRIGHT                                                                                                                     | LABORER        |                |  |  |  | 8.0 |  |  |  | 8.0         | 23.55 | 188.40 |  |  |  |  |  |  |             |  |
|                                                                                                                                  |                |                |  |  |  | 2.0 |  |  |  | 2.0         | 32.15 | 64.30  |  |  |  |  |  |  |             |  |
|                                                                                                                                  |                |                |  |  |  | 8.0 |  |  |  | 8.0         | 21.43 | 171.44 |  |  |  |  |  |  |             |  |
| SUB-TOTAL                                                                                                                        |                |                |  |  |  |     |  |  |  |             |       | 564.80 |  |  |  |  |  |  |             |  |
| Itemize % of Workmen's Comp., Old Age Pension, Social Security, Unemployment Compensation, Public Liability and Property Damage. |                |                |  |  |  |     |  |  |  |             |       | Total  |  |  |  |  |  |  |             |  |

| STATEMENT OF BILLS FOR MATERIALS AND FREIGHT    |                |      |        |  |                 |  |  |
|-------------------------------------------------|----------------|------|--------|--|-----------------|--|--|
| Date                                            | Purchased from | Item | Amount |  | Date of Payment |  |  |
|                                                 |                |      |        |  |                 |  |  |
|                                                 |                |      |        |  |                 |  |  |
|                                                 |                |      |        |  |                 |  |  |
|                                                 |                |      |        |  |                 |  |  |
|                                                 |                |      |        |  |                 |  |  |
|                                                 |                |      |        |  |                 |  |  |
|                                                 |                |      |        |  |                 |  |  |
|                                                 |                |      |        |  |                 |  |  |
|                                                 |                |      |        |  |                 |  |  |
| Attach Original Bills for Materials and Freight |                |      | Total  |  |                 |  |  |

I hereby certify that the above is a true and correct statement of labor performed and materials used in executing the work and that any materials taken from Contractor's stock represent actual cost paid for such materials. This work is covered by preliminary Authorization No. \_\_\_\_\_, Extra No. \_\_\_\_\_, dated \_\_\_\_\_

Checked by \_\_\_\_\_ Approved by \_\_\_\_\_ Date \_\_\_\_\_

*R. J. Bogard*  
Contractor





1101 (7/84)

**FORCE ACCOUNT STATEMENT**  
*This information required by MDOT in order to record charges on force account work performed.*

FILE 104

C. S. ID. - Job No. \_\_\_\_\_

Fed. Item No. \_\_\_\_\_ Year \_\_\_\_\_ Route No. \_\_\_\_\_

Fed. No. \_\_\_\_\_

Length and Type of Work EQUIPMENT FOR 502 ASHLAND

To Accompany Recommendation No. \_\_\_\_\_ Date \_\_\_\_\_

Contractor OLAUGHLIN CONSTRUCTION COMPANY  
 Address 24460 NOVI ROAD  
NOVI, MICHIGAN 48050

| PAYROLL AND EQUIPMENT RENTAL                                                                                                     |               | Date—Month of |  |  |  | 19 <u>86</u> |      | Amount | Credit Time   |
|----------------------------------------------------------------------------------------------------------------------------------|---------------|---------------|--|--|--|--------------|------|--------|---------------|
| Name of Employee                                                                                                                 | Class of Work |               |  |  |  | Total Hours  | Rate |        |               |
| INGERSOLL 175 COMPRESSOR                                                                                                         |               |               |  |  |  | 28           |      |        |               |
| 90 POUND BREAKER                                                                                                                 |               |               |  |  |  | 12.5         | 12.5 | 15.86  | 198.25        |
| GMC 3/4 TON DIESEL PICKUP                                                                                                        |               |               |  |  |  | 12.5         | 12.5 | 2.31   | 28.88         |
| BOBCAT 843                                                                                                                       |               |               |  |  |  | 4.0          | 4.0  | 8.89   | 35.56         |
| FORD 3/4 TON GAS PICKUP                                                                                                          |               |               |  |  |  | 12.5         | 12.5 | 25.31  | 316.38        |
|                                                                                                                                  |               |               |  |  |  | 12.5         | 12.5 | 13.53  | 169.13        |
| <b>SUB-TOTAL</b>                                                                                                                 |               |               |  |  |  |              |      |        | <b>748.20</b> |
| Itemize % of Workmen's Comp., Old Age Pension, Social Security, Unemployment Compensation, Public Liability and Property Damage. |               |               |  |  |  |              |      |        | Total         |

| STATEMENT OF BILLS FOR MATERIALS AND FREIGHT    |                |      | Amount | Date of Payment |
|-------------------------------------------------|----------------|------|--------|-----------------|
| Date                                            | Purchased from | Item |        |                 |
|                                                 |                |      |        |                 |
|                                                 |                |      |        |                 |
|                                                 |                |      |        |                 |
|                                                 |                |      |        |                 |
|                                                 |                |      |        |                 |
|                                                 |                |      |        |                 |
|                                                 |                |      |        |                 |
|                                                 |                |      |        |                 |
| Attach Original Bills for Materials and Freight |                |      | Total  |                 |

I hereby certify that the above is a true and correct statement of labor performed and materials used in executing the work and that any materials taken from Contractor's stock represent actual cost paid for such materials. This work is covered by preliminary Authorization No. \_\_\_\_\_, Extra No. \_\_\_\_\_, dated \_\_\_\_\_

R. L. [Signature]  
 Contractor

Checked by \_\_\_\_\_ Resident or Project Engineer      Approved by \_\_\_\_\_ District Engineer      Date \_\_\_\_\_



**COPY**  
**FORCE ACCOUNT STATEMENT**  
 This information required by MDOT in order to record charges on force account work performed.

FILE 104

C. S. ID. - Job No. \_\_\_\_\_

Fed. Item No. \_\_\_\_\_ Year \_\_\_\_\_ Route No. \_\_\_\_\_

Fed. No. \_\_\_\_\_

Length and Type of Work EQUIPMENT FOR 502 ASHLAND

To Accompany Recommendation No. \_\_\_\_\_ Date \_\_\_\_\_

Contractor O'LAUGHLIN CONSTRUCTION COMPANY  
 Address 24460 NOVI ROAD  
NOVI, MICHIGAN 48050

| PAYROLL AND EQUIPMENT RENTAL                                                                                                     |               | Date—Month of |  |     |             | 19 <u>86</u> |       | Amount | Credit Time |
|----------------------------------------------------------------------------------------------------------------------------------|---------------|---------------|--|-----|-------------|--------------|-------|--------|-------------|
| Name of Employee                                                                                                                 | Class of Work |               |  |     | Total Hours | Rate         |       |        |             |
| BOBCAT 843 WITH BACKHOE                                                                                                          |               |               |  | 27  |             |              |       |        |             |
| 90 POUND BREAKER                                                                                                                 |               |               |  | 2.5 |             | 2.5          | 33.81 | 84.53  |             |
| 90 POUND BREAKER                                                                                                                 |               |               |  | 2.5 |             | 2.5          | 2.31  | 5.78   |             |
| CHEVY 3/4 TON DIESEL PICKUP                                                                                                      |               |               |  | 2.5 |             | 2.5          | 2.31  | 5.78   |             |
| GMC 3/4 TON DIESEL PICKUP                                                                                                        |               |               |  | 2.5 |             | 2.5          | 8.89  | 22.23  |             |
| INGERSOLL 375 COMPRESSOR                                                                                                         |               |               |  | 1.0 |             | 1.0          | 8.89  | 8.89   |             |
|                                                                                                                                  |               |               |  | 2.5 |             | 2.5          | 31.58 | 78.95  |             |
| SUB-TOTAL                                                                                                                        |               |               |  |     |             |              |       | 206.16 |             |
| Itemize % of Workmen's Comp., Old Age Pension, Social Security, Unemployment Compensation, Public Liability and Property Damage. |               |               |  |     |             |              |       | Total  |             |

| STATEMENT OF BILLS FOR MATERIALS AND FREIGHT    |                |      | Amount | Date of Payment |
|-------------------------------------------------|----------------|------|--------|-----------------|
| Date                                            | Purchased from | Item |        |                 |
|                                                 |                |      |        |                 |
|                                                 |                |      |        |                 |
|                                                 |                |      |        |                 |
| Attach Original Bills for Materials and Freight |                |      | Total  |                 |

I hereby certify that the above is a true and correct statement of labor performed and materials used in executing the work and that any materials taken from Contractor's stock represent actual cost paid for such materials. This work is covered by preliminary Authorization No. \_\_\_\_\_, Extra No. \_\_\_\_\_, dated \_\_\_\_\_

Contractor

Checked by \_\_\_\_\_ Resident or Project Engineer      Approved by \_\_\_\_\_ District Engineer      Date \_\_\_\_\_



























1986

502-4 ASHLAND

MANPOWER EQUIPMENT

|      |        |       |
|------|--------|-------|
| 3-24 | 36777  | 18261 |
| 3-27 | 38917  | 20616 |
| 28   | 116574 | 74820 |
| 4-25 | 56480  | 40448 |

March 25 thru May 16

248748<sup>v</sup> 154145

Site width 63 feet

Sheet piling 31 feet. 16 feet under boat house roof.