

86-22-28

STEEL SHEETING LOCATION

14530 - # 14546 - 14556

SCRIPPS

8/28/86

J. DREWS, P.C.

Geographical Area

Page

SCRIPPS

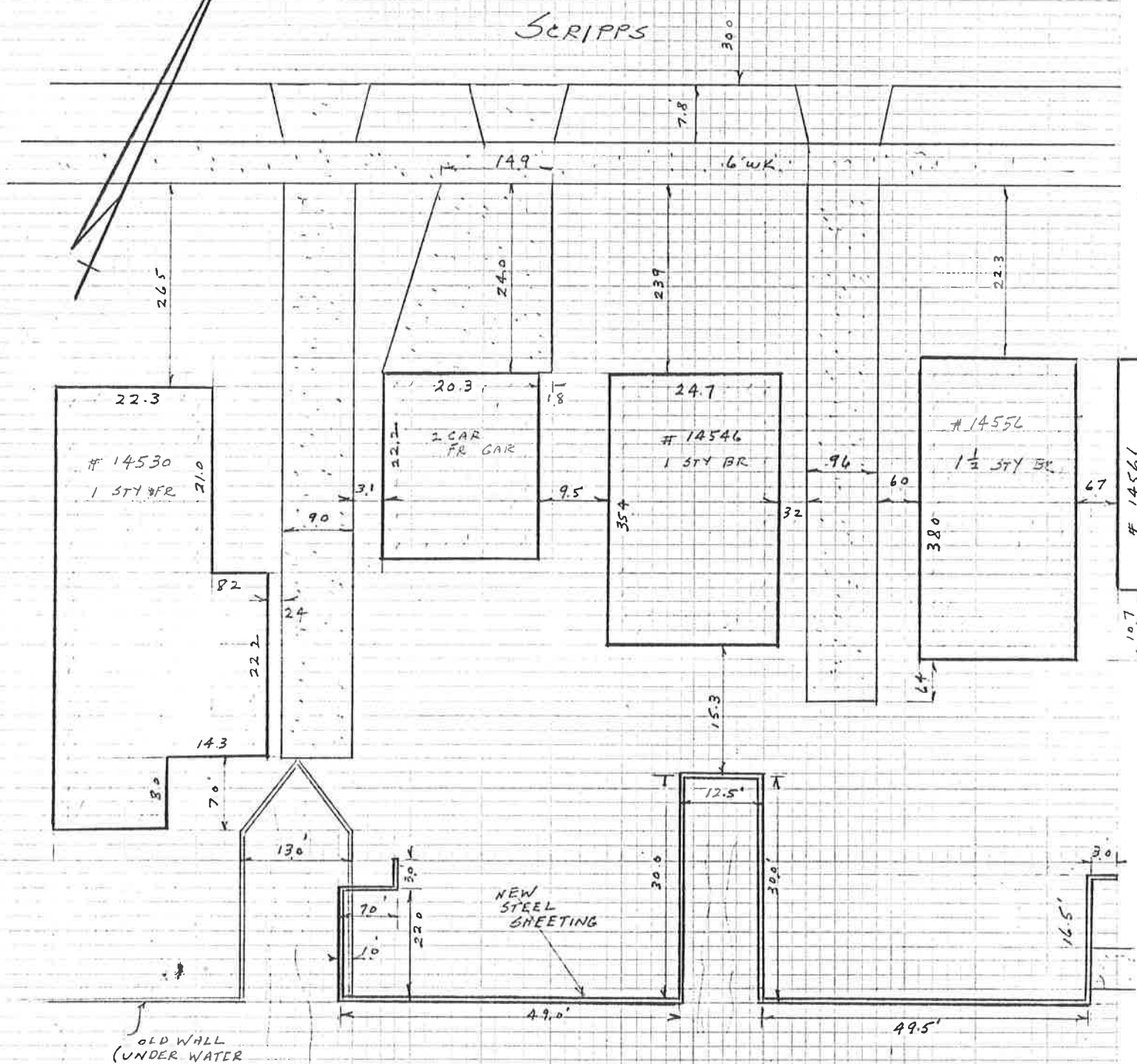

TOTAL STEEL SHEETING
WITH 8" CAP
222.5

CANAL

Top Creek Flood Control

14546 SCRIPTS

MANPOWER

EQUIPMENT

MAT'L

MISC

7-17	137528	67797		
18	147489	62207		
21	118816	86000		
22	118816	111935		
23	128480	110668		
24	133430	95232		
25	138616	88654		
29	11696	-		
30	22614	1778		
31	19800	5227		

308.56

May 27 thru Aug 1

9772.85

6294.98

308.56

8-6	236.90	85.87		
7	594.05	257.89		
8	742.39	504.79		
13	99.00	73.56	1672.34	922.11
18	374.16	82.50		
19	511.54	300.40		
20	229.44	139.91		
22	118.54	25.87		
25	898.52	275.88		
8-28	154.02	17.78		
9-2	88.68	27.06		

Aug 18 thru Sept 4

2374.90

869.40

TOTAL

13820.09

8086.49

Sheet pile 131.5 feet
 Site width 60 feet
 Boat well 30' x 12.5'



FORCE ACCOUNT STATEMENT
 This information required by MDOT in order to record charges on force account work performed.

C. S. ID. - Job No. _____
 Fed. Item No. _____ Year _____ Route No. _____
 Fed. No. 14546 SCRIPPS
 Length and Type of Work CAP, backfill
 To Accompany Recommendation No. _____ Date _____

Contractor O'LAUGHLIN CONST CO.
 Address _____

PAYROLL AND EQUIPMENT RENTAL		Date—Month of <u>AUGUST</u> 19____				Total Hours	Rate	Amount	Credit Time	
<u>ARVIL WRIGHT</u>	<u>LABORER</u>			<u>7</u>		<u>8</u>	<u>24.75</u>	<u>198.00</u>		
<u>CYNTHIA GREER</u>	<u>OPERATOR</u>			<u>3</u>		<u>3</u>	<u>19.59</u>	<u>58.77</u>		
<u>AL MATTISON</u>	<u>LABORER</u>			<u>8</u>		<u>8</u>	<u>24.75</u>	<u>198.00</u>		
<u>SAM WASHINGTON</u>	<u>CARPENTER</u>			<u>1</u>		<u>1</u>	<u>33.12</u>	<u>33.12</u>		
<u>ROY WASHINGTON</u>	<u>FOREMAN</u>			<u>4</u>		<u>4</u>	<u>26.54</u>	<u>106.16</u>		
<u>SUB-TOTAL</u>								<u>594.05</u>		
<u>FORD F150 GAS P/U</u>				<u>8</u>		<u>8</u>	<u>13.53</u>	<u>108.24</u>		
<u>LINCOLN 225 WELDER</u>				<u>6</u>		<u>6</u>	<u>4.86</u>	<u>29.16</u>		
<u>BOBCAT 843 LOADER</u>				<u>3</u>		<u>3</u>	<u>28.31</u>	<u>84.93</u>		
<u>CHEV DIESEL P/U</u>				<u>4</u>		<u>4</u>	<u>8.98</u>	<u>35.56</u>		
<u>SUB-TOTAL</u>								<u>257.89</u>		
Itemize % of Workmen's Comp., Old Age Pension, Social Security, Unemployment Compensation, Public Liability and Property Damage.								Total	<u>851.94</u>	

STATEMENT OF BILLS FOR MATERIALS AND FREIGHT				Amount	Date of Payment
Date	Purchased from	Item			
<u>8-7</u>	<u>Sheet piling</u>	<u>30-40' (3.45) 1800 ft²</u>		<u>6210 -</u>	
Attach Original Bills for Materials and Freight				Total	

I hereby certify that the above is a true and correct statement of labor performed and materials used in executing the work and that any materials taken from Contractor's stock represent actual cost paid for such materials. This work is covered by preliminary Authorization No. _____, Extra No. _____, dated _____

Checked by _____ Approved by [Signature] Date _____
 Resident or Project Engineer District Engineer Contractor

