

WOODWARD AVE.

J.L. HUDSON & Co.

WOODWARD
178'-10"

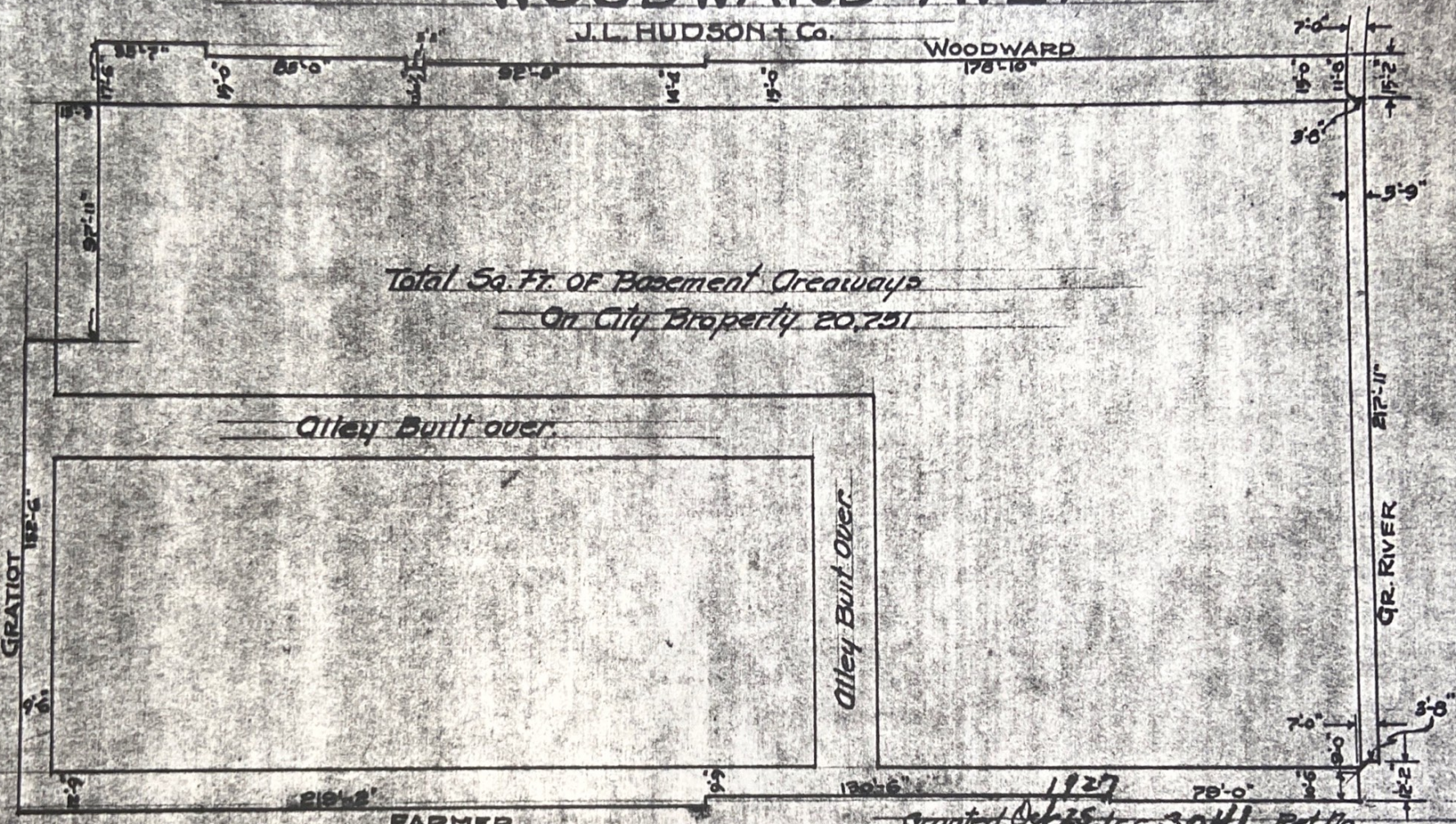

Total Sq. Ft. of Basement Creeways
On City Property 20,751

Alley Built over.

Alley Built Over.

GRATIOT 118'-2"

GR. RIVER 57'-11"

FARMER

1927 granted Oct 25 Dec. 30 41 Pet No.

DEPARTMENT OF PUBLIC WORKS
CITY ENGINEER'S OFFICE
DETROIT, MICH.

TITLE Petitioner
 Owner in Fee _____
 Tax by _____
 Occupant - J.L. Hudson & Co.
 DRAWN BY W.F.C. APPROVED BY _____
 SCALE _____ DATE _____
 FIELD BOOK NO. _____ PG. _____ FILE _____

E1 P.334

See 6-12-45 J.C.C. pg. 1214

see J.C.C. 3041-10/25/27