

312 GRATIOT AVE.

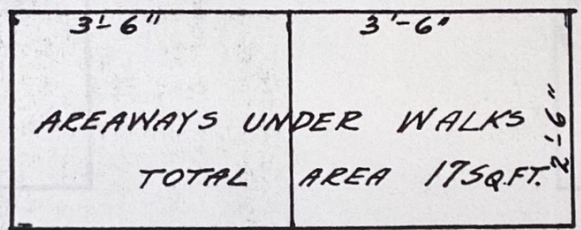

GRANTED J.C.C. PET. NO

DEPARTMENT OF PUBLIC WORKS CITY ENGINEER'S OFFICE DETROIT, MICH.	
TITLE <u>PETR.</u>	
OWNER IN FEE _____	
TAX BY _____	
OCCUPANT: <u>J. P. LIEBERMAN & CO</u>	
DRAWN BY <u>J.L.</u>	APPROVED BY _____
SCALE _____	DATE _____
FIELD BOOK NO. _____	PG. _____ FILE _____