

1441 PARK PL.

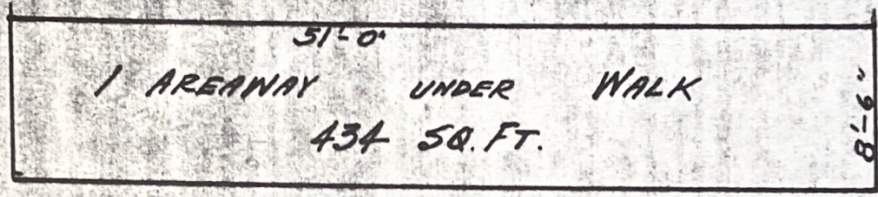

GRANTED J.C.C. PET. NO.

DEPARTMENT OF PUBLIC WORKS  
CITY ENGINEER'S OFFICE  
DETROIT, MICH.

---

TITLE PETR.

OWNER IN FEE \_\_\_\_\_

TAX BY \_\_\_\_\_

OCCUPANT KNIGHT MENARD CO

---

DRAWN BY J.L. APPROVED BY \_\_\_\_\_

SCALE \_\_\_\_\_ DATE \_\_\_\_\_

FIELD BOOK NO. \_\_\_\_\_ PG. \_\_\_\_\_ FILE \_\_\_\_\_