

# S. E. COR. CONGRESS & BATES ST'S. (#1)

TOTAL AREA 282 SQ. FT.

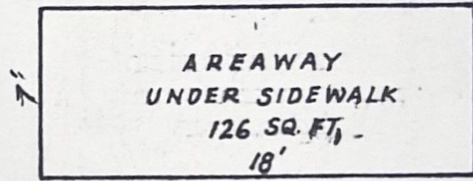
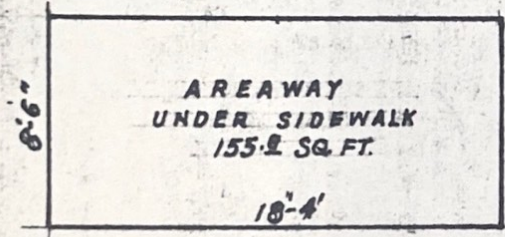

GRANTED J.C.C. PET. No.

DEPARTMENT OF PUBLIC WORKS  
CITY ENGINEER'S OFFICE  
DETROIT, MICH.

---

TITLE PET'R

OWNER IN FEE \_\_\_\_\_

TAX BY \_\_\_\_\_

OCCUPANT BOYDELL CO.

DRAWN BY F.N.P. APPROVED BY \_\_\_\_\_

SCALE \_\_\_\_\_ DATE \_\_\_\_\_

FIELD BOOK NO. \_\_\_\_\_ PG. \_\_\_\_\_ FILE \_\_\_\_\_