

48 HENRY N.E. COR. PARK AVE.

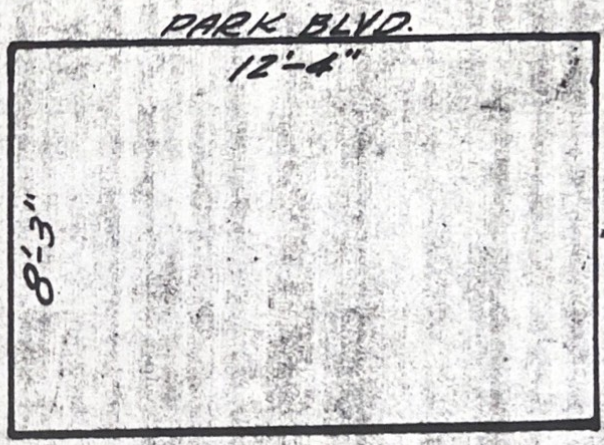
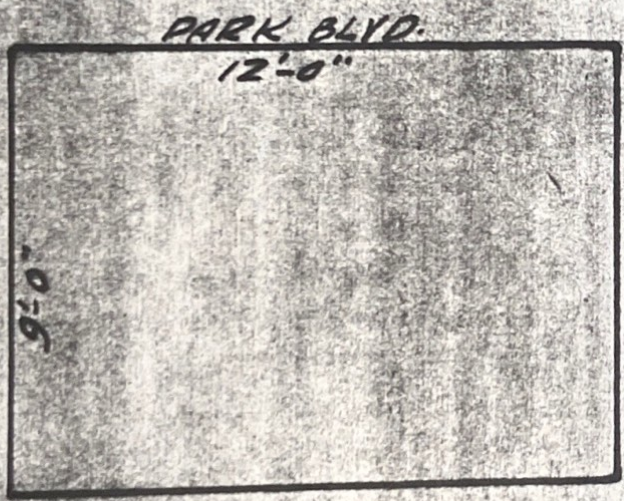

2-AREA WAYS
 UNDER WALK
 TOTAL 210-SQ. FT.

| | | | |
|--|--|----------------------|---------|
| GRANTED | | J.C.C. | PET.No. |
| DEPARTMENT OF PUBLIC WORKS CITY ENGINEER'S OFFICE DETROIT, MICH. | | | |
| TITLE <u>PET'R.</u> | | | |
| OWNER <u>IN FEE</u> | | | |
| TAX BY | | | |
| OCCUPANT <u>JOHN SCHMITKE</u> | | | |
| DRAWN BY <u>C.A.B.</u> | | APPROVED BY _____ | |
| SCALE _____ | | DATE _____ | |
| FIELD BOOK NO. _____ | | PG. _____ FILE _____ | |