

409 MONROE AVE.

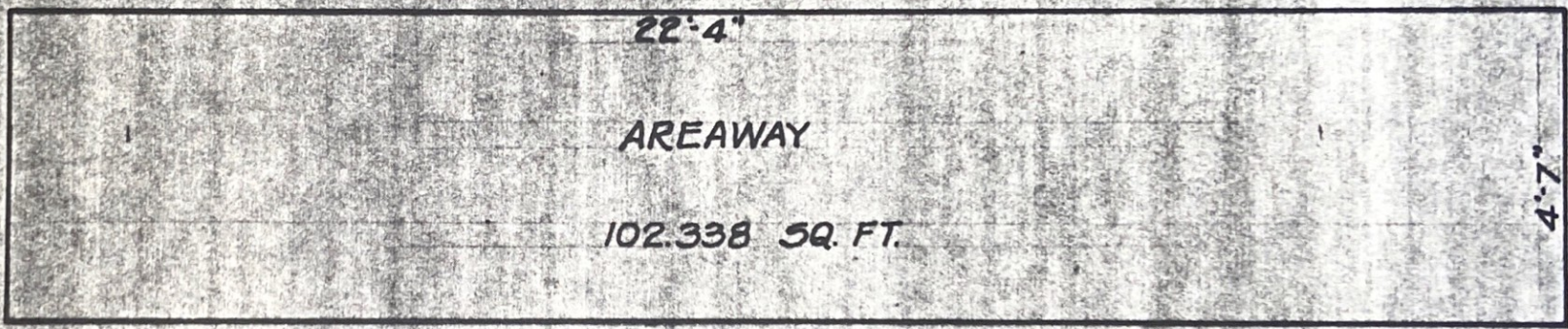

AREAWAY

102.338 SQ. FT.

4'-7"

GRANTED J.C.C. PET. NO.

DEPARTMENT OF PUBLIC WORKS CITY ENGINEER'S OFFICE DETROIT, MICH.	
TITLE <u>PETR.</u>	
TAX BY _____	
OCCUPANT <u>W. W. PAUTOS</u>	
DRAWN BY <u>O.M.R.</u>	APPROVED BY _____
SCALE <u>3/8" = 1'-0"</u>	DATE _____
FIELD BOOK NO. _____	PG. _____ FILE _____