

350 JEFFERSON E.

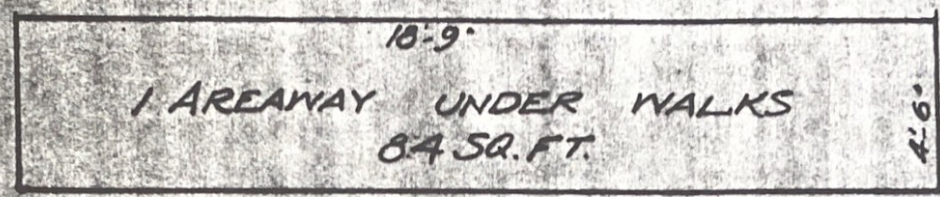

GRANTED J.C.G. PET.No.

DEPARTMENT OF PUBLIC WORKS
CITY ENGINEER'S OFFICE
DETROIT, MICH.

TITLE PET'R

OWNER IN FEE _____

TAX BY _____

OCCUPANT M. CONNELL - KERR CO.

DRAWN BY _____ APPROVED BY _____

SCALE _____ DATE _____

FIELD BOOK NO. _____ PG. _____ FILE _____