

N^o. 200 MONROE AVE.

TOTAL AREA 381 SQ FT

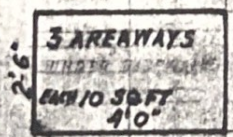
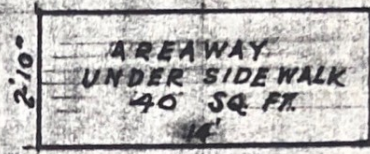

GRANTED J.C.C. PET. NO. _____

DEPARTMENT OF PUBLIC WORKS
CITY ENGINEER'S OFFICE
DETROIT, MICH.

TITLE PET'R.

OWNER IN FEE _____

TAX BY _____

OCCUPANT STRIM'S TOOL-HARDWARE STORE

DRAWN BY F.R.R. APPROVED BY _____

SCALE _____ DATE _____

FIELD BOOK NO. _____ PG. _____ FILE _____