

N<sup>OS.</sup> 130-132 MONROE AVE

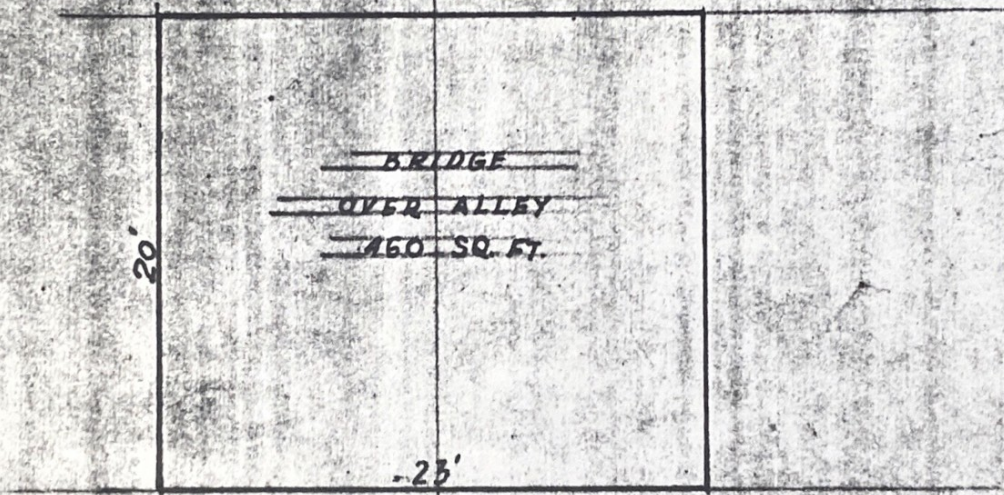

GRANTED J.C.C. PET. NO.           

**DEPARTMENT OF PUBLIC WORKS**  
**CITY ENGINEER'S OFFICE**  
**DETROIT, MICH.**

---

TITLE PET'R.  
 OWNER IN FEE             
 TAX BY             
 OCCUPANT PALACE THEATER.

DRAWN BY F.N.P. APPROVED BY             
 SCALE            DATE             
 FIELD BOOK NO.            PG.            FILE