



June 22, 2018

City of Detroit Department of Public Works  
City Engineering & Street Maintenance Divisions  
Coleman A. Young Municipal Center  
2 Woodward Avenue, Suite 611  
Detroit, Michigan 48226

Re: Notice of Migration of Contamination  
From 737 Military Street, Detroit, MI, Tax ID 16016484 (MDOT Parcel 5508)  
Potentially toward W. Fisher Service Drive right-of-way to the north, Military Street right-of-way to the east,  
And/or alley rights-of-way to the west and south  
Notification No. 5508-ROW

To whom it may concern:

The Mannik & Smith Group, Inc. ("MSG"), on behalf of the Michigan Department of Transportation ("MDOT"), has directed or conducted underground environmental testing at 737 Military Street, Detroit, Michigan ("the Site") in relation to the Gordie Howe International Bridge project underway in the vicinity of the rights-of-way referenced above ("the subject properties").

The Michigan Department of Environmental Quality ("MDEQ") requires distribution of the enclosed a Notice of Migration of Contamination form when there is evidence that environmental contamination at one property has or may have affected nearby properties. Hazardous substance(s) were identified in soil and/or groundwater sample(s) collected at the Site at concentration(s) that exceed Generic Residential Cleanup Criteria and Screening Levels established by the MDEQ.

At this time, it is not known if the subject properties have been affected by the environmental contamination at the Site. Also, the identification of hazardous substance(s) at the Site does not necessarily mean a hazardous situation or immediate danger currently exists. MSG, on behalf of the MDOT, is providing this notice to you as a precautionary measure and for your general awareness of environmental conditions at the Site.

Please review the enclosed document and if you have any questions regarding the Notice of Migration of Contamination please contact Karen Williams of the MDEQ at 586-753-3884. If you have general questions regarding the contents of this letter please contact Walter Bolt of MSG at 734-397-3100, extension 6025 or Jim Woodruff of the MDOT at 517-241-9115.

Sincerely,

Walter J. Bolt, CPG  
Project Manager  
Environmental Owners Representative Consultant  
Gordie Howe International Bridge Project

CC: Jim Woodruff – MDOT  
Karen Williams – MDEQ RRD Project Manager  
Paul Max – General Manager, Environmental Affairs, City of Detroit BSEED  
Anita Harrington – Environmental Specialist II, City of Detroit BSEED

For DEQ Use Only
ITS # _____
Site ID # _____
Category Code: _____

**NOTICE OF MIGRATION OF CONTAMINATION (FORM EQP4482 REV. 4/16)**

*(Under the authority of Part 201, Natural Resources and Environmental Protection Act, 1994 Act 451, as amended, (NREPA) and the Rules promulgated thereunder)*

An owner or operator of property that is a facility, and/or who is subject to MCL324.20107a, and who has reason to believe that a hazardous substance is emanating from, has emanated from, or is likely to be emanating from the property and migrating beyond the boundaries of the property that he or she owns or operates is required under R 299.51017(1) and MCL 324.20114(1)(b)(ii) & (iii) to notify the Michigan Department of Environmental Quality (DEQ) and affected property owners. Submission of this notice does not fulfill the notification requirements of MCL 324.21309a.

The notice must be provided within 45 days (MCL 324.20107a) or within 30 days (MCL 324.20114) after the owner or operator has reason to believe that hazardous substances have migrated, or are likely to have migrated, to or beyond the boundary of his or her property (see R 299.51017 for exceptions that apply to parties subject to MCL 324.20107a).

Use of this form is mandatory for the notice required by R 299.51017(1) and may also be used by parties subject to MCL 324.20114(1)(b)(ii) & (iii). This form may also be used to provide notice to affected property owners as required by those rules.

If a person holds a permit for an oil and gas well under Part 615, Supervisor of Wells, of the NREPA and there is a release from the oil and gas exploration or production activities, that person shall give notice to the DEQ and to the owner of the surface rights of the property.

If a person holds an easement and there is a release from the easement holder's activities, that person shall provide notice to the DEQ and to the grantor of the easement, or the grantor's successor in interest, if any.

Completing this notice in no way relieves a person who is subject to MCL 324.20114 from the responsibility to undertake required response activities.

This notice must be sent to the DEQ office that serves the county in which the property is located. A list of DEQ offices is available at [www.michigan.gov/deqducare](http://www.michigan.gov/deqducare), or by calling the Remediation and Redevelopment Division's Lansing office at 517-284-5187. The DEQ will not prepare acknowledgement of receipt of these notices. The sender is responsible for sending the report using a method that provides proof of delivery if such proof is desired. Please label the outside of the envelope "Migration Notice." Additional guidelines for the compliance with the requirements of R 299.51017(1) or MCL 324.20114(1)(b)(ii) & (iii) are available at [www.michigan.gov/deqducare](http://www.michigan.gov/deqducare).

THIS NOTICE IS PROVIDED PURSUANT TO:      R 299.51017          MCL 324.20114(1)      
*(check both, if applicable)*

Please provide the following information as completely as possible.

1. Name and location of the property that hazardous substances are emanating from:	Status relative to the property: (Check one or both, as applicable.)
Name: MI Dept. of Transportation (MDOT) Parcel 5508	Owner <input checked="" type="checkbox"/>
Address: 737 Military Street	Operator <input type="checkbox"/>
Location: Michigan	
City/County: Detroit/Wayne	
Property Tax Identification Number, or if applicable, the ward and item number: 16016484	
Latitude (decimal degrees): 42.308093 °N	Longitude (decimal degrees): -83.101762 °W
Reference Point for Latitude and Longitude:	
Center of Site: <input checked="" type="checkbox"/>	Main/front door: <input type="checkbox"/>
	Front gate/main entrance: <input type="checkbox"/>
	Other: <input type="checkbox"/>
Collection Method:	
Survey: <input type="checkbox"/>	Interpolation: <input type="checkbox"/>
	GPS: <input type="checkbox"/>



2. Provide any additional ID numbers associated with the property (e.g., EPA ID No., BEA No., Part 213 facility ID No., etc.):

GHIB MDOT Parcel 5508; MERA Site ID# 82002800; CNTS-RRD-16-001

3. Name, address, and telephone number of the property owner, operator, or other party submitting the notice:

Name: MDOT Bureau of Development, Environmental Services Section  
Address: 425 W. Ottawa Street, P.O. Box 30050  
City/State: Lansing, MI, 48909  
Telephone Number: 517-241-9115

4. Name, address and telephone number of a contact person familiar with the content of the notice:

Name: Walter Bolt of The Mannik & Smith Group, Inc. Environmental Owner's Rep Consultant to MDOT  
Address: 2365 Haggerty Road South  
City/State: Canton, MI 48188  
Telephone Number: 734-397-3100 x. 6025

5. If this Notice is provided pursuant to R 299.51017, provide the address and other location information for the *adjacent* property(s) onto which contamination is migrating, has migrated, or is likely to migrate.

If this Notice is provided pursuant to MCL Section 324.20114(1), provide the address and other location information for *each* property onto which contamination has migrated. Notice should be sent to the property owner of record. If the impacted property is owned by the State of Michigan, notice should be sent to the department managing the property (e.g., a prison, state park, etc.). Notices to the Michigan Department of Transportation (MDOT) for state owned roadways should be sent to Contaminated Site Specialist, Environmental Services Section, MDOT-Bureau of Development, 425 W. Ottawa Street, P.O. Box 30050, Lansing, MI 48909. If the impacted property is owned by the State of Michigan, notice should be sent to the department managing the property (i.e. a prison, state park, etc.).

Address: 745 Military Street  
City/State: Detroit, MI  
Property Tax ID number: 16016483.002L  
Other: DIB Detroit LLC  
Notified? No  Yes  Date: June 22, 2018

Address: 749 Military Street  
City/State: Detroit, MI  
Property Tax ID number: 16016483.001  
Other: MDOT Parcel 5506  
Notified? No  Yes  Date: June 22, 2018

Address: 731/733 Military Street  
City/State: Detroit, MI  
Property Tax ID number: 16016485  
Other: MDOT Parcel 5509  
Notified? No  Yes  Date: June 22, 2018

Address: 730, 742 Dragoon Street  
City/State: Detroit, MI  
Property Tax ID number: 16016694-711  
Other: MDOT Parcel 5505  
Notified? No  Yes  Date: June 22, 2018

Address: 6044 W. Fort Street  
City/State: Detroit, MI  
Property Tax ID number: 16000307  
Other: MDOT Parcel 5519  
Notified? No  Yes  Date: June 22, 2018



MICHIGAN DEPARTMENT OF ENVIRONMENTAL QUALITY  
REMEDIATION AND REDEVELOPMENT DIVISION

Address: MDOT I-75 Right-of-Way  
City/State: Detroit, MI  
Property Tax ID number: NA  
Other: Control Section 82194, Sheet 114, Parcel 2030  
Notified? No  Yes  Date: June 22, 2018

Address: 27700 Donald Court  
City/State: Warren, MI, 48092-2793  
Property Tax ID number: NA  
Other: MDEQ, Southeast Michigan District Office  
Office of Drinking Water & Municipal Assistance Division  
Notified? No  Yes  Date: June 22, 2018

Address: 2 Woodward Avenue, Ste. 611  
City/State: Detroit, MI, 48226  
Property Tax ID number: NA  
Other: City of Detroit (West Fisher Service Drive, Military Street, and alleys adjacent to 737 Military Street / 16016484)  
Notified? No  Yes  Date: June 22, 2018

Address: 27175 Energy Way  
City/State: Novi, MI, 48377  
Property Tax ID number: NA  
Other: International Transmission Company (ITC) (utility holder)  
Notified? No  Yes  Date: June 22, 2018

Address: 735 Randolph Street, Ste. 1900  
City/State: Detroit, MI, 48226  
Property Tax ID number: NA  
Other: Great Lakes Water Authority (utility holder)  
Notified? No  Yes  Date: June 22, 2018

Address: 12775 Lydon Street  
City/State: Detroit, MI, 48227  
Property Tax ID number: NA  
Other: Comcast/Xfinity (utility holder)  
Notified? No  Yes  Date: June 22, 2018

Address: 208 S. Akard Street  
City/State: Dallas, TX, 75202  
Property Tax ID number: NA  
Other: AT&T Headquarters (utility holder)  
Notified? No  Yes  Date: June 22, 2018

Address: One Energy Plaza, Ste. 1935  
City/State: Detroit, MI, 48226  
Property Tax ID number: NA  
Other: Detroit Edison, DTE (utility holder)  
Notified? No  Yes  Date: June 22, 2018

Address: 6425 Huber Street  
City/State: Detroit, MI, 48211  
Property Tax ID number: NA  
Other: Detroit Water & Sewerage Department (utility holder) – via email  
Notified? No  Yes  Date: June 22, 2018

Address: 3245 E. Jefferson Avenue, Ste. 100  
City/State: Detroit, MI, 48207  
Property Tax ID number: NA  
Other: Detroit Health Department – via email  
Notified? No  Yes  Date: June 22, 2018

(Attach additional pages as needed) PLEASE SEE ATTACHED MAP OF PROPERTY TAX ID NUMBERS.

# MAP OF PROPERTY TAX ID NUMBERS

ADDRESS	TAX ID
A 742 DRAGOON	16016711
B 730 DRAGOON	16016694710
C 749 MILITARY	16016483.001
D 745 MILITARY	16016483.002L
E 737 MILITARY	16016484
F 731 MILITARY	16016485
G 6044 W FORT	16000307



Date Saved: 6/18/2018 1:37:40 PM  
Path: S:\Projects\Project K-OMDOT0070\ENGAPPS\GIS\Map\_Files\Notification Maps\5508\_TaxID\_Map.mxd

Coordinate System: UTM Zone 17 N IntFt  
Projection: Transverse Mercator  
Datum: NAD 1983 CORS96



**FIGURE 1**  
PROPERTY TAX ID NUMBERS  
ADJACENT TO 5508  
Gordie Howe International Bridge  
Detroit, Michigan

DATE 6/18/2018	DRAWN BY MH	DESIGNED BY LHK	PROJECT NO. MDOT0070
-------------------	----------------	--------------------	-------------------------



Service Layer Credits: Source: Esri, DigitalGlobe, GeoEye, Earthstar Geographics, CNES/Airbus DS, USDA, USGS, AeroGRID, IGN, and the GIS User Community  
\* All locations approximate. Not a legal survey.





6. Complete the Table on Page 6 of this Form for each hazardous substance which has migrated, or is likely to have migrated, beyond the property boundary at a concentration that exceeds a Generic Residential Cleanup Criterion developed by the DEQ pursuant to MCL 324.20120a(1). Complete and attach additional copies of Page 6, if necessary, to list all hazardous substances that must be reported. Include a scaled map or drawing that shows the location of sampling points identified on the Table on Page 6, the property boundaries, and the adjacent property owners if providing notice pursuant to R 299.1017(1) or all impacted property owners if providing notice pursuant to MCL 324.20114(1).
7. Provide a summary of the information which shows that contamination is emanating from, or has emanated from, and is present beyond the boundary of the source property at a concentration which exceeds the generic residential criteria developed by the DEQ pursuant to MCL 324.20120a(1)(a). This summary shall identify the environmental media affected, specific hazardous substances, and the concentrations of those hazardous substances in all affected environmental media at the property boundary and in any sample locations beyond the property boundary. The summary shall also describe the basis for the conclusion that the contamination is emanating, has emanated, or is present beyond the boundary of the source property, including whether the conclusion is based on groundwater analytical data or fate and transport modeling, both, or neither.
8. If the person making this notice has reason to believe that a migrating hazardous substance has affected, or is likely to affect, a private or public water supply, then that water supply must be identified here:

NA

- |   | YES                                 | NO                                  |
|---|-------------------------------------|-------------------------------------|
| 9. Is this notice being submitted within the timeframes established under R 299.51017 and/or MCL 324.20114(1), as applicable? | <input checked="" type="checkbox"/> | <input type="checkbox"/>            |
| 10. Is this notice in addition to a notice that was submitted prior to December 21, 2002? (R 299.51017(4)(c))                 | <input type="checkbox"/>            | <input checked="" type="checkbox"/> |
| 11. Is this notice related to an oil and gas well permit (R 299.51017(2))? Permit #:  | <input type="checkbox"/>            | <input checked="" type="checkbox"/> |
| 12. Is this notice related to an easement (R 299.51017(3))? (NOTE: All easement grantors <i>must</i> receive this notice.)    | <input type="checkbox"/>            | <input checked="" type="checkbox"/> |
| 13. Has surface water been affected (R 299.51017(1))? (If yes, please identify the affected surface water body.)              | <input type="checkbox"/>            | <input checked="" type="checkbox"/> |

**CERTIFICATION:**

*With my signature below, I certify that I am the owner of the facility or that I am legally authorized to execute this notice on behalf of the owner or operator named on this form, and that to the best of my knowledge and belief the above representations are complete and accurate. I understand that intentionally submitting false information to the DEQ is a felony and may result in fines up to \$25,000 for each violation.*

Signature Walter J. Bolt  
(Owner or person legally authorized to bind the person making this report)

Date June 22, 2018

Name (Typed or Printed) Walter J. Bolt

Title (Typed or Printed) Project Manager, Environmental Owners Representative Consultant, Gordie Howe International Bridge Project, on behalf of Michigan Department of Transportation



MICHIGAN DEPARTMENT OF ENVIRONMENTAL QUALITY  
REMEDATION AND REDEVELOPMENT DIVISION

See Item 6 on Page 5 of this Form for instructions to be used in completing this table. Attach additional pages if necessary. The information to be included in each column of the table is:

- Column A Name of hazardous substance.
- Column B Chemical Abstract Service (CAS) Number for the hazardous substance.
- Column C Maximum hazardous substance concentration measured on the property, expressed in parts per billion (e.g., ug/L or ug/Kg). Report maximum concentration separately for each environmental medium.
- Column D Sample location for Column C (relate to label on map).
- Column E Environmental medium in which concentrated concentration reported in Column C was measured (e.g., soil or groundwater).
- Column F Distance from point of maximum measured concentration (Column D) to property boundary, in direction of contaminant migration, if direction is known or can reasonably be inferred. If direction is unknown, list distance to nearest property boundary.
- Column G Direction of contaminant migration, if known.
- Column H Concentration closest to property boundary, if known. If a concentration lower than the maximum concentration reported in Column C has been measured at a point closer to the property boundary in the direction of contaminant migration, use Column H to list the concentration that was measured closest to the property boundary in the direction of contaminant migration.
- Column I Sample location for Column H (relate to label on map).
- Column J Environmental medium for measurement reported in Column H, if applicable.

A Hazardous Substance	B CAS Number	C Maximum Concentration	D Sample Location for "C"	E Environmental Medium for "C"	F Distance to Property Boundary	G Direction of Migration	H Boundary Concentration	I Sample Location for "H"	J Environmental Medium for "H"
Copper	7440-50-8	69,000	5508_SB-03A_0-2_S_SOM_20180330	Soil	5 feet	Unknown	---	---	---
Mercury	7439-97-6	280	5508_SB-02_0-2_S_SOM_20180307	Soil	5 feet	Unknown	---	---	---
Selenium	7782-49-2	3,300	5508_SB-03A_0-2_S_SOM_20180330	Soil	5 feet	Unknown	---	---	---
Zinc	7440-66-6	280,000	5508_SB-02_0-2_S_SOM_20180307	Soil	5 feet	Unknown	---	---	---
Asbestos	1332-21-4	21,700,000 (2.17%)	5508_SB-03A_0-2_S_SOM_20180330	Soil	5 feet	Unknown	---	---	---
Selenium	7782-49-2	19	5508_SB-02_6-11_GW_SOM_20180307	Groundwater	5 feet	Unknown	---	---	---

Total Number Samples Collected: 7 soil, 2 groundwater Total Number of Samples Exceeding Criteria: 7 soil, 2 groundwater

**A scaled map or drawing showing these locations and the property boundaries must be submitted with this Notice  
PLEASE SEE ATTACHED FIGURE 2**

**LEGEND**

- SITE
- BORING LOCATION
- LIMITS OF EXISTING STRUCTURE(S)  
(APPROXIMATE)
- ESTIMATED AREA OF IMPACT BY METALS
- ESTIMATED AREA OF IMPACT BY ASEBESTOS

ACRONYMS	
GSIPC	Groundwater Surface Water Interface
PSIC	Particulate Soil Inhalation Criteria
NE	No Exceedance

ABBREVIATIONS	
Cu	Copper
Hg	Mercury
Se	Selenium
Zn	Zinc

LOCATION ID	5508_SB-03A*	5508_SB-03
DEPTH (FT)	0 - 2	4 - 6
SAMPLE DATE	3/30/2018	3/7/2018
Metals	-	-
Cu	69,000 GSIPC	NE
Se	3,300 GSIPC	1,000 GSIPC
Zn	240,000 GSIPC	NE
Other	-	-
Asbestos (%)	2.17 % PSIC **	NE

LOCATION ID	5508_SB-01	5508_SB-01	5508_SB-01
DEPTH (FT)	0 - 2	0 - 2 (DUP)	4 - 6
SAMPLE DATE	3/7/2018	3/7/2018	3/7/2018
Metals	-	-	-
Se	1,500 GSIPC	1,600 GSIPC	1,000 GSIPC

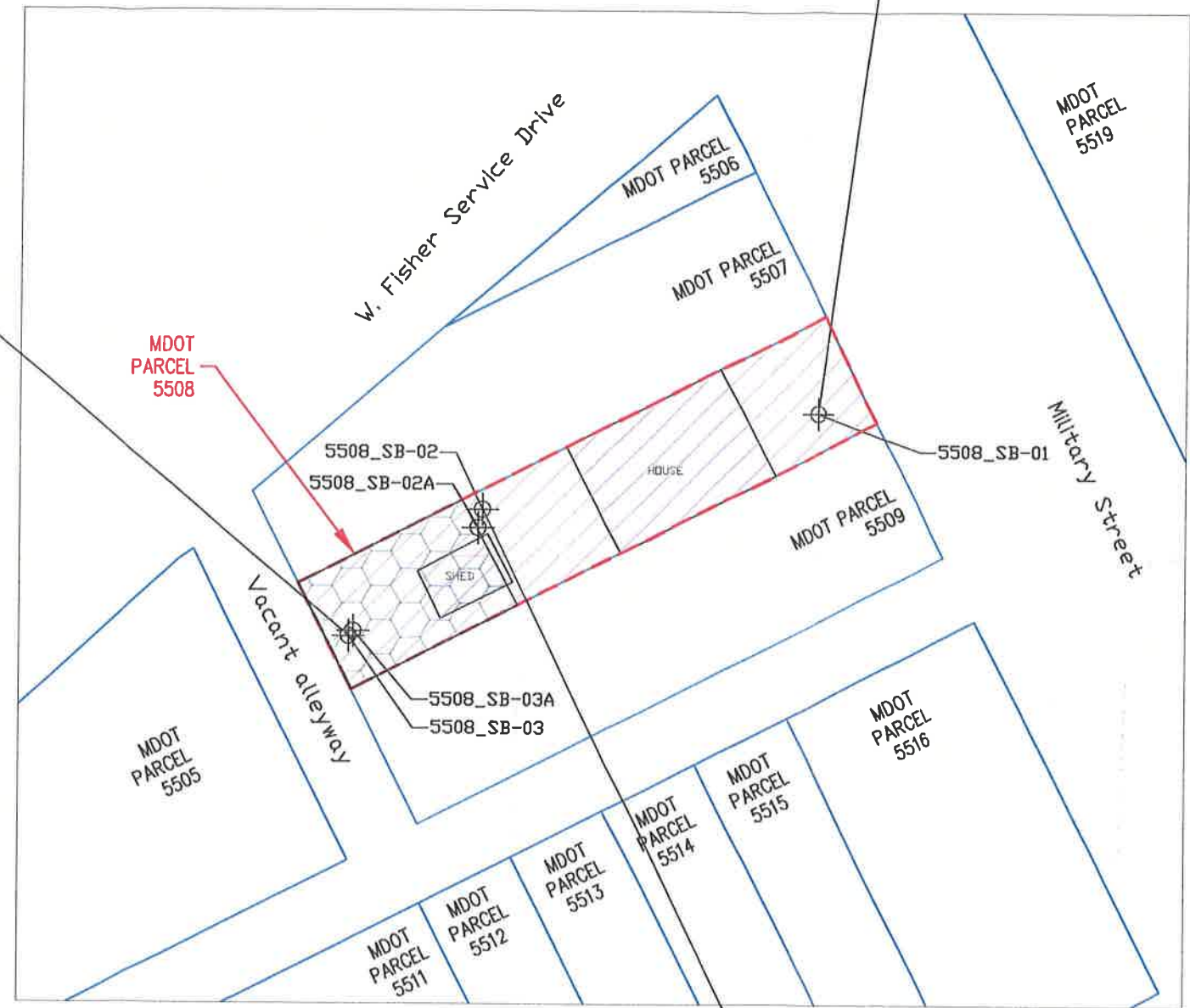

LOCATION ID	5508_SB-02	5508_SB-02A*
DEPTH (FT)	0 - 2	4 - 6
SAMPLE DATE	3/7/2018	3/30/2018
Metals	-	-
Hg	280 GSIPC	NE
Se	1,700 GSIPC	2,400 GSIPC
Zn	280,000 GSIPC	NE

NOTES:  
 1. Concentrations are reported in micrograms per kilogram ( $\mu\text{g}/\text{kg}$ ), unless otherwise indicated.  
 2. Refer to Table 1 of the PSI Report for a detailed summary of analytical data compared to residential GCC.  
 3. Samples were analyzed for VOCs, PNAs, MI-10 metals, and PCBs. VOCs and PNAs were either not detected or detected at concentrations below residential GCC. PCBs were not detected.  
 4. Shallow samples were analyzed for asbestos.  
 \*Resampled due to sample damage.  
 \*\*Result from resampling. There was sufficient volume of original sample to analyze for asbestos and results were not detected.



DRAWN BY: W. TRAM	DATE DRAWN: 04/25/2018
CHECKED BY: M. CARRIERE	DATE CHECKED: 04/26/2018
PAGE 7 OF 7	

**SE**  
 Somat Engineering, Inc.  
 3031 WEST GRAND BOULEVARD, SUITE 228  
 DETROIT, MI 48202  
 PHONE: (313) 963-2721  
 FAX: (313) 963-2736

PREPARED FOR:

FIGURE 2  
 SOIL RESIDENTIAL EXCEEDANCE MAP  
 PRELIMINARY SITE INVESTIGATION  
 INTERCHANGE AREA MDOT PARCEL 5508  
 737 Military Street, Detroit, Michigan