

For DEQ Use Only ITS # _____ Site ID # _____ Category Code: _____
--

**NOTICE OF MIGRATION OF CONTAMINATION (FORM EQP4482 REV. 4/16)**

*(Under the authority of Part 201, Natural Resources and Environmental Protection Act, 1994 Act 451, as amended, (NREPA) and the Rules promulgated thereunder)*

An owner or operator of property that is a facility, and/or who is subject to MCL324.20107a, and who has reason to believe that a hazardous substance is emanating from, has emanated from, or is likely to be emanating from the property and migrating beyond the boundaries of the property that he or she owns or operates is required under R 299.51017(1) and MCL 324.20114(1)(b)(ii) & (iii) to notify the Michigan Department of Environmental Quality (DEQ) and affected property owners. Submission of this notice does not fulfill the notification requirements of MCL 324.21309a.

The notice must be provided within 45 days (MCL 324.20107a) or within 30 days (MCL 324.20114) after the owner or operator has reason to believe that hazardous substances have migrated, or are likely to have migrated, to or beyond the boundary of his or her property (see R 299.51017 for exceptions that apply to parties subject to MCL 324.20107a).

Use of this form is mandatory for the notice required by R 299.51017(1) and may also be used by parties subject to MCL 324.20114(1)(b)(ii) & (iii). This form may also be used to provide notice to affected property owners as required by those rules.

If a person holds a permit for an oil and gas well under Part 615, Supervisor of Wells, of the NREPA and there is a release from the oil and gas exploration or production activities, that person shall give notice to the DEQ and to the owner of the surface rights of the property.

If a person holds an easement and there is a release from the easement holder's activities, that person shall provide notice to the DEQ and to the grantor of the easement, or the grantor's successor in interest, if any.

Completing this notice in no way relieves a person who is subject to MCL 324.20114 from the responsibility to undertake required response activities.

This notice must be sent to the DEQ office that serves the county in which the property is located. A list of DEQ offices is available at [www.michigan.gov/deqducare](http://www.michigan.gov/deqducare), or by calling the Remediation and Redevelopment Division's Lansing office at 517-284-5187. The DEQ will not prepare acknowledgement of receipt of these notices. The sender is responsible for sending the report using a method that provides proof of delivery if such proof is desired. Please label the outside of the envelope "Migration Notice." Additional guidelines for the compliance with the requirements of R 299.51017(1) or MCL 324.20114(1)(b)(ii) & (iii) are available at [www.michigan.gov/deqducare](http://www.michigan.gov/deqducare).

THIS NOTICE IS PROVIDED PURSUANT TO:      R 299.51017          MCL 324.20114(1)      
*(check both, if applicable)*

Please provide the following information as completely as possible.

- |  |   |
|--|---|
| 1. Name and location of the property that hazardous substances are emanating from: | 2. Status relative to the property:<br><small>(Check one or both, as applicable.)</small> |
|--|---|

Name: MI Dept. of Transportation (MDOT) Parcels 5075 & 5076      Owner      
 Address: 6330 W. Jefferson Ave. & 6319, 6327, & 6333 Buelow Ct.      Operator      
 Location: Michigan  
 City/County: Detroit/Wayne  
 Property Tax Identification Number, or if applicable, the ward and item number: 18000156, 18000162.001, 18000162.002L, & 18000163.001

Latitude (decimal degrees): 42.300167 °N      Longitude (decimal degrees): -83.099530 °W

Reference Point for Latitude and Longitude:  
 Center of Site:     Main/front door:     Front gate/main entrance:     Other:   
 Collection Method:    Survey:     Interpolation:     GPS:



2. Provide any additional ID numbers associated with the property (e.g., EPA ID No., BEA No., Part 213 facility ID No., etc.):

GHIB MDOT Parcels 5075 & 5076; MERA Site ID# 82002800; CNTS-RRD-16-001

3. Name, address, and telephone number of the property owner, operator, or other party submitting the notice:

Name: MDOT Bureau of Development, Environmental Services Section  
Address: 425 W. Ottawa Street, P.O. Box 30050  
City/State: Lansing, MI, 48909  
Telephone Number: 517-241-9115

4. Name, address and telephone number of a contact person familiar with the content of the notice:

Name: Walter Bolt of The Mannik & Smith Group, Inc. Environmental Owner's Rep Consultant to MDOT  
Address: 2365 Haggerty Road South  
City/State: Canton, MI 48188  
Telephone Number: 734-397-3100 x. 6025

5. If this Notice is provided pursuant to R 299.51017, provide the address and other location information for the adjacent property(s) onto which contamination is migrating, has migrated, or is likely to migrate.

If this Notice is provided pursuant to MCL Section 324.20114(1), provide the address and other location information for each property onto which contamination has migrated. Notice should be sent to the property owner of record. If the impacted property is owned by the State of Michigan, notice should be sent to the department managing the property (e.g., a prison, state park, etc.). Notices to the Michigan Department of Transportation (MDOT) for state owned roadways should be sent to Contaminated Site Specialist, Environmental Services Section, MDOT-Bureau of Development, 425 W. Ottawa Street, P.O. Box 30050, Lansing, MI 48909. If the impacted property is owned by the State of Michigan, notice should be sent to the department managing the property (i.e. a prison, state park, etc.).

Address: 6300 West Jefferson Avenue  
City/State: Detroit, MI  
Property Tax ID number: 18000157-61  
Other: MDOT Parcel 5077  
Notified? No  Yes  Date: October 30, 2017

Address: 650 S. Livernois Avenue  
City/State: Detroit, MI  
Property Tax ID number: 18007234  
Other: MDOT Parcel 5078  
Notified? No  Yes  Date: October 30, 2017

Address: 6342 W. Jefferson Avenue  
City/State: Detroit, MI  
Property Tax ID number: 18000154-5  
Other: MDOT Parcel 5072  
Notified? No  Yes  Date: October 30, 2017

Address: 2 Woodward Avenue, Ste. 611  
City/State: Detroit, MI, 48226  
Property Tax ID number: NA  
Other: City of Detroit (West Jefferson Avenue, Buelow Court, and alleys adjacent to 6330 W. Jefferson Ave. [18000156] and 6319, 6327, 6333 Buelow Ct. [18000162.001, 18000162.002L, 18000163.001])  
Notified? No  Yes  Date: October 30, 2017

Address: 735 Randolph  
City/State: Detroit, MI, 48226  
Property Tax ID number: NA  
Other: Detroit Water & Sewerage Department (utility holder)  
Notified? No  Yes  Date: October 30, 2017



MICHIGAN DEPARTMENT OF ENVIRONMENTAL QUALITY  
REMEDIATION AND REDEVELOPMENT DIVISION

Address: One Energy Plaza, Ste. 1935  
City/State: Detroit, MI, 48226  
Property Tax ID number: NA  
Other: Detroit Edison, DTE (utility holder)

Notified? No  Yes  Date: October 30, 2017

Address: 27175 Energy Way  
City/State: Novi, MI, 48377  
Property Tax ID number: NA  
Other: International Transmission Company (ITC) (utility holder)

Notified? No  Yes  Date: October 30, 2017

Address: 735 Randolph Street, Ste. 1900  
City/State: Detroit, MI, 48226  
Property Tax ID number: NA  
Other: Great Lakes Water Authority (utility holder)

Notified? No  Yes  Date: October 30, 2017

Address: 12775 Lydon Street  
City/State: Detroit, MI, 48227  
Property Tax ID number: NA  
Other: Comcast/Xfinity (utility holder)

Notified? No  Yes  Date: October 30, 2017

Address: 208 S. Akard Street  
City/State: Dallas, TX, 75202  
Property Tax ID number: NA  
Other: AT&T Headquarters (utility holder)

Notified? No  Yes  Date: October 30, 2017

(Attach additional pages as needed) PLEASE SEE ATTACHED MAP OF PROPERTY TAX ID NUMBERS.



# MAP OF PROPERTY TAX ID NUMBERS

Date Saved: 12/19/2016 12:48:11 PM  
Path: S:\Projects\Project K-OMDOT0070\ENGAPPS\GIS\Map\_Files\Requested Maps\5075\_ & 5076\_Offsite\_Property\_Tax\_ID.mxd







6. Complete the Table on Page 6 of this Form for each hazardous substance which has migrated, or is likely to have migrated, beyond the property boundary at a concentration that exceeds a Generic Residential Cleanup Criterion developed by the DEQ pursuant to MCL 324.20120a(1). Complete and attach additional copies of Page 6, if necessary, to list all hazardous substances that must be reported. Include a scaled map or drawing that shows the location of sampling points identified on the Table on Page 6, the property boundaries, and the adjacent property owners if providing notice pursuant to R 299.1017(1) or all impacted property owners if providing notice pursuant to MCL 324.20114(1).
7. Provide a summary of the information which shows that contamination is emanating from, or has emanated from, and is present beyond the boundary of the source property at a concentration which exceeds the generic residential criteria developed by the DEQ pursuant to MCL 324.20120a(1)(a). This summary shall identify the environmental media affected, specific hazardous substances, and the concentrations of those hazardous substances in all affected environmental media at the property boundary and in any sample locations beyond the property boundary. The summary shall also describe the basis for the conclusion that the contamination is emanating, has emanated, or is present beyond the boundary of the source property, including whether the conclusion is based on groundwater analytical data or fate and transport modeling, both, or neither.
8. If the person making this notice has reason to believe that a migrating hazardous substance has affected, or is likely to affect, a private or public water supply, then that water supply must be identified here:

NA

- |   | YES                                 | NO                                  |
|---|-------------------------------------|-------------------------------------|
| 9. Is this notice being submitted within the timeframes established under R 299.51017 and/or MCL 324.20114(1), as applicable? | <input checked="" type="checkbox"/> | <input type="checkbox"/>            |
| 10. Is this notice in addition to a notice that was submitted prior to <i>December 21, 2002</i> ? (R 299.51017(4)(c))         | <input type="checkbox"/>            | <input checked="" type="checkbox"/> |
| 11. Is this notice related to an oil and gas well permit (R 299.51017(2))? Permit #:  | <input type="checkbox"/>            | <input checked="" type="checkbox"/> |
| 12. Is this notice related to an easement (R 299.51017(3))? (NOTE: All easement grantors <i>must</i> receive this notice.)    | <input type="checkbox"/>            | <input checked="" type="checkbox"/> |
| 13. Has surface water been affected (R 299.51017(1))? (If yes, please identify the affected surface water body.)              | <input type="checkbox"/>            | <input checked="" type="checkbox"/> |

**CERTIFICATION:**

*With my signature below, I certify that I am the owner of the facility or that I am legally authorized to execute this notice on behalf of the owner or operator named on this form, and that to the best of my knowledge and belief the above representations are complete and accurate. I understand that intentionally submitting false information to the DEQ is a felony and may result in fines up to \$25,000 for each violation.*

Signature Walter J. Bolt Date 10/30/2017  
(Owner or person legally authorized to bind the person making this report)

Name (Typed or Printed) Walter J. Bolt

Title (Typed or Printed) Project Manager, Environmental Owners Representative Consultant, Gordie Howe International Bridge Project



TABLE 1

## DEQ NOTICE OF MIGRATION ATTACHMENT

A	B	C	D	E	F	G	H	I	J
Hazardous Substance	CAS Number	Maximum Concentration	Sample Location for "C"	Environmental Medium for "C"	Distance to Property Boundary	Direction of Migration	Boundary Concentration	Sample Location for "H"	Environmental Medium for "H"
Phenanthrene	85-01-8	3,000	5075_SB-05_0-2_S_PM_20161122	Soil	95 feet	Unknown	-	-	-
Arsenic	7440-38-2	62,000	5075_SB-04_0-2_S_PM_20161122	Soil	85 feet	Unknown	-	-	-
Cadmium	7440-43-9	3,500	5075_SB-05_0-2_S_PM_20161122	Soil	95 feet	Unknown	-	-	-
Chromium (Total)	7440-47-3	39,000	5075_SB-02_0-2_S_PM_20161122	Soil	15 feet	Unknown	-	-	-
Copper	7440-50-8	360,000	5075_SB-02_0-2_S_PM_20161122	Soil	15 feet	Unknown	-	-	-
Lead - Fine Fraction	7439-92-1	480,000	5075_DUP-01_S_PM_20161122*	Soil	95 feet	Unknown	-	-	-
Zinc	7440-66-6	760,000	5075_DUP-01_S_PM_20161122*	Soil	95 feet	Unknown	-	-	-
Cyanide (Total)	57-12-5	1,000	5075_SB-02_2-4_S_PM_20161122	Soil	15 feet	Unknown	-	-	-

Total Number of Samples Collected: 38

Total Number of Samples Exceeding Criteria: 18

## Footnote:

\* Duplicate sample corresponding to 5075\_SB-05\_0-2\_S\_PM\_20161122

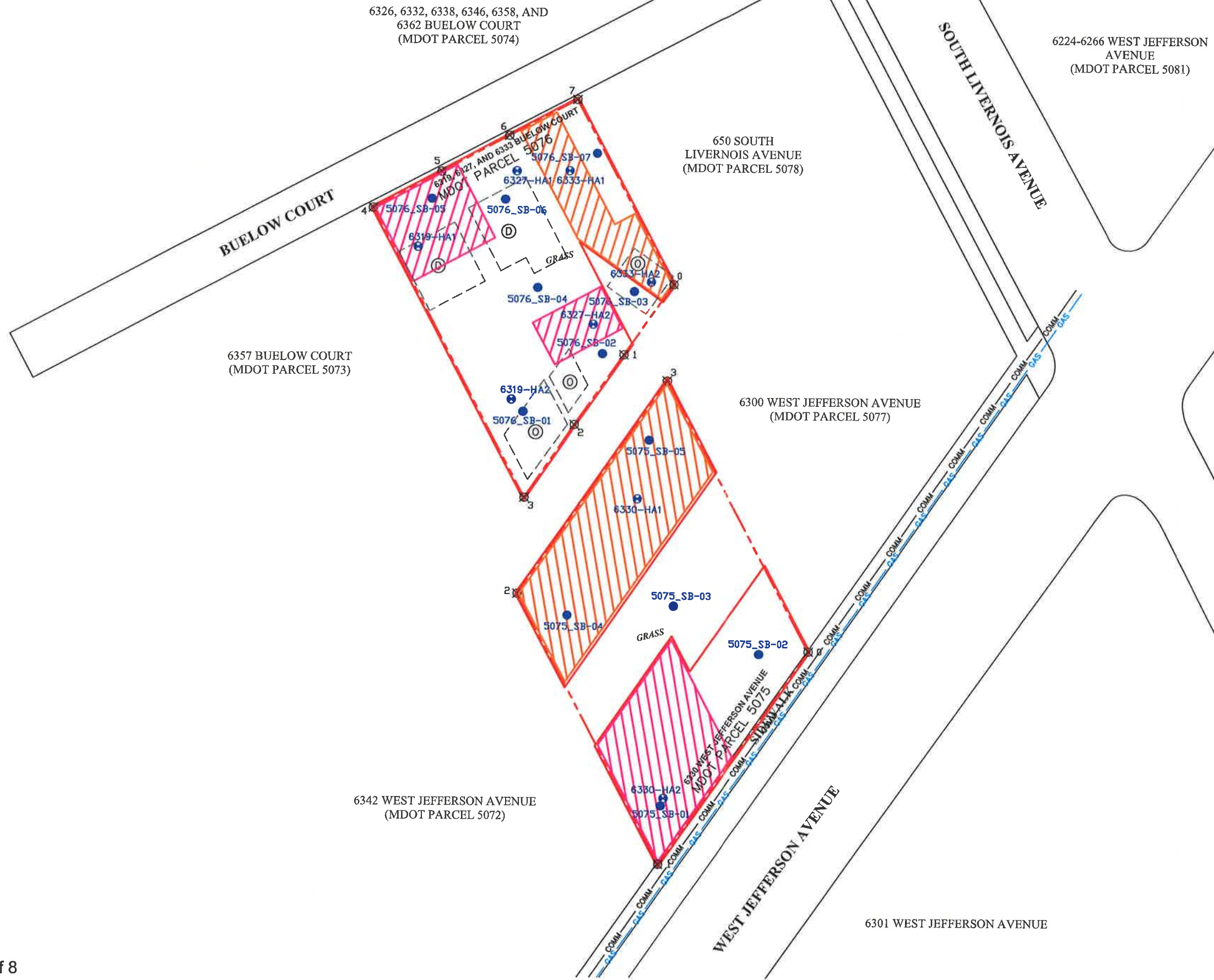

- LEGEND:**
- SUBJECT PROPERTY
  - APPROXIMATE FORMER/HISTORICAL SITE FEATURES
  - GAS
  - COMMUNICATION LINE
  - PARCEL CORNER
  - FORMER DWELLING
  - FORMER OUTBUILDING
  - SOIL BORING
  - ECT SOIL BORING (2004)
  - ESTIMATED EXTENT OF SOIL IMPACT ABOVE THE PART 201 RESIDENTIAL AND NONRESIDENTIAL DC GCC
  - ESTIMATED EXTENT OF SOIL IMPACT ABOVE THE PART 201 RESIDENTIAL DC GCC
  - ESTIMATED EXTENT OF SOIL IMPACT ABOVE THE PART 201 RESIDENTIAL GCC

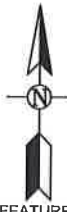

**FIGURE 2**  
SAMPLE LOCATION MAP WITH ESTIMATED EXTENT OF IMPACT

PROJ: MDOT PARCELS 5075 AND 5076  
6330 WEST JEFFERSON AVENUE AND  
6319, 6327, AND 6333 BUELOW COURT  
DETROIT, MI

THIS IS NOT A LEGAL SURVEY	DRN BY: KS	DATE: 1/4/2017
VERIFY SCALE	CHKD BY: NL	SCALE: 1" = 40'
IF NOT 1" ON THIS SHEET, ADJUST SCALES ACCORDINGLY.	FILE NAME: 01-7940-1-023F00R00	