



February 15, 2018

City of Detroit Department of Public Works  
City Engineering & Street Maintenance Divisions  
Coleman A. Young Municipal Center  
2 Woodward Avenue, Suite 611  
Detroit, Michigan 48226

Re: Notice of Migration of Contamination  
From 6114 W. Fort Street, Detroit, MI, Tax ID 16000303 (MDOT Parcel 5514)  
Potentially toward West Fort Street/M-85 right-of-way to the south and/or alley right-of-way to the north  
Notification No. 5514-ROW

To whom it may concern:

The Mannik Smith Group, Inc. ("MSG"), on behalf of the Michigan Department of Transportation ("MDOT"), has directed or conducted underground environmental testing at 6114 West Fort Street, Detroit, Michigan ("the Site") in relation to the Gordie Howe International Bridge project underway in the vicinity of the rights-of-way referenced above ("the subject properties").

The Michigan Department of Environmental Quality ("MDEQ") requires distribution of the enclosed a Notice of Migration of Contamination form when there is evidence that environmental contamination at one property has or may have affected nearby properties. Hazardous substance(s) were identified in soil and/or groundwater sample(s) collected at the Site at concentration(s) that exceed Generic Residential Cleanup Criteria and Screening Levels established by the MDEQ.

At this time, it is not known if the subject properties have been affected by the environmental contamination at the Site. Also, the identification of hazardous substance(s) at the Site does not necessarily mean a hazardous situation or immediate danger currently exists. MSG, on behalf of the MDOT, is providing this notice to you as a precautionary measure and for your general awareness of environmental conditions at the Site.

Please review the enclosed document and if you have any questions regarding the Notice of Migration of Contamination please contact Karen Williams of the MDEQ at 586-753-3884. If you have general questions regarding the contents of this letter please contact Walter Bolt of MSG at 734-397-3100, extension 6025 or Jim Woodruff of the MDOT at 517-241-9115.

Sincerely,

Walter J. Bolt, CPG  
Project Manager  
Environmental Owners Representative Consultant  
Gordie Howe International Bridge Project

CC: Jim Woodruff – MDOT  
Karen Williams – MDEQ RRD Project Manager  
Paul Max – General Manager, Environmental Affairs, City of Detroit BSEED  
Anita Harrington – Environmental Specialist II, City of Detroit BSEED

RECEIVED FEB 22 2018

TECHNICAL SKILL.  
CREATIVE SPIRIT.

5514.Notice Cover Letter.DetroitDPW.docx

For DEQ Use Only ITS # _____ Site ID # _____ Category Code: _____
--

**NOTICE OF MIGRATION OF CONTAMINATION (FORM EQP4482 REV. 4/16)**

*(Under the authority of Part 201, Natural Resources and Environmental Protection Act, 1994 Act 451, as amended, (NREPA) and the Rules promulgated thereunder)*

An owner or operator of property that is a facility, and/or who is subject to MCL324.20107a, and who has reason to believe that a hazardous substance is emanating from, has emanated from, or is likely to be emanating from the property and migrating beyond the boundaries of the property that he or she owns or operates is required under R 299.51017(1) and MCL 324.20114(1)(b)(ii) & (iii) to notify the Michigan Department of Environmental Quality (DEQ) and affected property owners. Submission of this notice does not fulfill the notification requirements of MCL 324.21309a.

The notice must be provided within 45 days (MCL 324.20107a) or within 30 days (MCL 324.20114) after the owner or operator has reason to believe that hazardous substances have migrated, or are likely to have migrated, to or beyond the boundary of his or her property (see R 299.51017 for exceptions that apply to parties subject to MCL 324.20107a).

Use of this form is mandatory for the notice required by R 299.51017(1) and may also be used by parties subject to MCL 324.20114(1)(b)(ii) & (iii). This form may also be used to provide notice to affected property owners as required by those rules.

If a person holds a permit for an oil and gas well under Part 615, Supervisor of Wells, of the NREPA and there is a release from the oil and gas exploration or production activities, that person shall give notice to the DEQ and to the owner of the surface rights of the property.

If a person holds an easement and there is a release from the easement holder's activities, that person shall provide notice to the DEQ and to the grantor of the easement, or the grantor's successor in interest, if any.

Completing this notice in no way relieves a person who is subject to MCL 324.20114 from the responsibility to undertake required response activities.

This notice must be sent to the DEQ office that serves the county in which the property is located. A list of DEQ offices is available at [www.michigan.gov/deqducare](http://www.michigan.gov/deqducare), or by calling the Remediation and Redevelopment Division's Lansing office at 517-284-5187. The DEQ will not prepare acknowledgement of receipt of these notices. The sender is responsible for sending the report using a method that provides proof of delivery if such proof is desired. Please label the outside of the envelope "Migration Notice." Additional guidelines for the compliance with the requirements of R 299.51017(1) or MCL 324.20114(1)(b)(ii) & (iii) are available at [www.michigan.gov/deqducare](http://www.michigan.gov/deqducare).

THIS NOTICE IS PROVIDED PURSUANT TO: R 299.51017  MCL 324.20114(1)   
*(check both, if applicable)*

Please provide the following information as completely as possible.

1. Name and location of the property that hazardous substances are emanating from: \_\_\_\_\_ Status relative to the property: \_\_\_\_\_  
(Check one or both, as applicable.)

Name: MI Dept. of Transportation (MDOT) Parcel 5514 Owner   
Address: 6114 West Fort Street Operator   
Location: Michigan  
City/County: Detroit/Wayne  
Property Tax Identification Number, or if applicable, the ward and item number: 16000303

Latitude (decimal degrees): 42.307750 °N Longitude (decimal degrees): -83.101585 °W

Reference Point for Latitude and Longitude:  
Center of Site:  Main/front door:  Front gate/main entrance:  Other:

Collection Method: Survey:  Interpolation:  GPS:



2. Provide any additional ID numbers associated with the property (e.g., EPA ID No., BEA No., Part 213 facility ID No., etc.):

GHIB MDOT Parcel 5514; MERA Site ID# 82002800; CNTS-RRD-16-001

3. Name, address, and telephone number of the property owner, operator, or other party submitting the notice:

Name: MDOT Bureau of Development, Environmental Services Section  
Address: 425 W. Ottawa Street, P.O. Box 30050  
City/State: Lansing, MI, 48909  
Telephone Number: 517-241-9115

4. Name, address and telephone number of a contact person familiar with the content of the notice:

Name: Walter Bolt of The Mannik & Smith Group, Inc. Environmental Owner's Rep Consultant to MDOT  
Address: 2365 Haggerty Road South  
City/State: Canton, MI 48188  
Telephone Number: 734-397-3100 x. 6025

5. If this Notice is provided pursuant to R 299.51017, provide the address and other location information for the adjacent property(s) onto which contamination is migrating, has migrated, or is likely to migrate.

If this Notice is provided pursuant to MCL Section 324.20114(1), provide the address and other location information for each property onto which contamination has migrated. Notice should be sent to the property owner of record. If the impacted property is owned by the State of Michigan, notice should be sent to the department managing the property (e.g., a prison, state park, etc.). Notices to the Michigan Department of Transportation (MDOT) for state owned roadways should be sent to Contaminated Site Specialist, Environmental Services Section, MDOT-Bureau of Development, 425 W. Ottawa Street, P.O. Box 30050, Lansing, MI 48909. If the impacted property is owned by the State of Michigan, notice should be sent to the department managing the property (i.e. a prison, state park, etc.).

Address: 6118 W. Fort St. Notified? No  Yes  Date: February 15, 2018  
City/State: Detroit, MI  
Property Tax ID number: 16000302  
Other: Michael and Debra Schmidt

Address: 6110 W. Fort St. Notified? No  Yes  Date: February 15, 2018  
City/State: Detroit, MI  
Property Tax ID number: 16000304  
Other: MDOT Parcel 5515

Address: MDOT M-85 Right-of-Way Notified? No  Yes  Date: February 15, 2018  
City/State: Detroit, MI  
Property Tax ID number: NA  
Other: West Fort Street (M-85) adjacent to 6114 W. Fort Street / 16000303, east of Dragoon Street, west of Military Street

Address: 27700 Donald Court Notified? No  Yes  Date: February 15, 2018  
City/State: Warren, MI, 48092-2793  
Property Tax ID number: NA  
Other: MDEQ, Southeast Michigan District Office  
Office of Drinking Water & Municipal Assistance Division

Address: 2 Woodward Avenue, Ste. 611 Notified? No  Yes  Date: February 15, 2018  
City/State: Detroit, MI, 48226  
Property Tax ID number: NA  
Other: City of Detroit (West Fort Street and alley adjacent to 6114 W. Fort St. / 16000303)



MICHIGAN DEPARTMENT OF ENVIRONMENTAL QUALITY  
REMEDIATION AND REDEVELOPMENT DIVISION

Address: 27175 Energy Way  
City/State: Novi, MI, 48377  
Property Tax ID number: NA  
Other: International Transmission Company (ITC) (utility holder)  
Notified? No  Yes  Date: February 15, 2018

Address: 735 Randolph Street, Ste. 1900  
City/State: Detroit, MI, 48226  
Property Tax ID number: NA  
Other: Great Lakes Water Authority (utility holder)  
Notified? No  Yes  Date: February 15, 2018

Address: 12775 Lydon Street  
City/State: Detroit, MI, 48227  
Property Tax ID number: NA  
Other: Comcast/Xfinity (utility holder)  
Notified? No  Yes  Date: February 15, 2018

Address: 208 S. Akard Street  
City/State: Dallas, TX, 75202  
Property Tax ID number: NA  
Other: AT&T Headquarters (utility holder)  
Notified? No  Yes  Date: February 15, 2018

Address: One Energy Plaza, Ste. 1935  
City/State: Detroit, MI, 48226  
Property Tax ID number: NA  
Other: Detroit Edison, DTE (utility holder)  
Notified? No  Yes  Date: February 15, 2018

Address: 6425 Huber Street  
City/State: Detroit, MI, 48211  
Property Tax ID number: NA  
Other: Detroit Water & Sewerage Department (utility holder) – via email  
Notified? No  Yes  Date: February 15, 2018

Address: 3245 E. Jefferson Avenue, Ste. 100  
City/State: Detroit, MI, 48207  
Property Tax ID number: NA  
Other: Detroit Health Department – via email  
Notified? No  Yes  Date: February 15, 2018

(Attach additional pages as needed) PLEASE SEE ATTACHED MAP OF PROPERTY TAX ID NUMBERS.

# MAP OF PROPERTY TAX ID NUMBERS



Date Saved: 2/14/2018 9:28:55 AM  
 Path: S:\Projects\Project K-O\MDOT0070\ENGAPPS\GIS\Map\_Files\Notification Maps\5514\_TaxID\_Map.mxd



**FIGURE 1**  
 PROPERTY TAX ID NUMBERS  
 ADJACENT TO 5514  
 Gordie Howe International Bridge  
 Detroit, Michigan

DATE 2/14/2018	DRAWN BY MH	DESIGNED BY LHK	PROJECT NO. MDOT0070
-------------------	----------------	--------------------	-------------------------





6. Complete the Table on Page 6 of this Form for each hazardous substance which has migrated, or is likely to have migrated, beyond the property boundary at a concentration that exceeds a Generic Residential Cleanup Criterion developed by the DEQ pursuant to MCL 324.20120a(1). Complete and attach additional copies of Page 6, if necessary, to list all hazardous substances that must be reported. Include a scaled map or drawing that shows the location of sampling points identified on the Table on Page 6, the property boundaries, and the adjacent property owners if providing notice pursuant to R 299.1017(1) or all impacted property owners if providing notice pursuant to MCL 324.20114(1).
7. Provide a summary of the information which shows that contamination is emanating from, or has emanated from, and is present beyond the boundary of the source property at a concentration which exceeds the generic residential criteria developed by the DEQ pursuant to MCL 324.20120a(1)(a). This summary shall identify the environmental media affected, specific hazardous substances, and the concentrations of those hazardous substances in all affected environmental media at the property boundary and in any sample locations beyond the property boundary. The summary shall also describe the basis for the conclusion that the contamination is emanating, has emanated, or is present beyond the boundary of the source property, including whether the conclusion is based on groundwater analytical data or fate and transport modeling, both, or neither.
8. If the person making this notice has reason to believe that a migrating hazardous substance has affected, or is likely to affect, a private or public water supply, then that water supply must be identified here:

NA

- |   | YES                                 | NO                                  |
|---|-------------------------------------|-------------------------------------|
| 9. Is this notice being submitted within the timeframes established under R 299.51017 and/or MCL 324.20114(1), as applicable? | <input checked="" type="checkbox"/> | <input type="checkbox"/>            |
| 10. Is this notice in addition to a notice that was submitted prior to December 21, 2002? (R 299.51017(4)(c))                 | <input type="checkbox"/>            | <input checked="" type="checkbox"/> |
| 11. Is this notice related to an oil and gas well permit (R 299.51017(2))?<br>Permit #:                                       | <input type="checkbox"/>            | <input checked="" type="checkbox"/> |
| 12. Is this notice related to an easement (R 299.51017(3))?<br>(NOTE: All easement grantors <i>must</i> receive this notice.) | <input type="checkbox"/>            | <input checked="" type="checkbox"/> |
| 13. Has surface water been affected (R 299.51017(1))?<br>(If yes, please identify the affected surface water body.)           | <input type="checkbox"/>            | <input checked="" type="checkbox"/> |

**CERTIFICATION:**

With my signature below, I certify that I am the owner of the facility or that I am legally authorized to execute this notice on behalf of the owner or operator named on this form, and that to the best of my knowledge and belief the above representations are complete and accurate. I understand that intentionally submitting false information to the DEQ is a felony and may result in fines up to \$25,000 for each violation.

Signature Walter J. Bolt Date February 15, 2018  
(Owner or person legally authorized to bind the person making this report)

Name (Typed or Printed) Walter J. Bolt

Title (Typed or Printed) Project Manager, Environmental Owners Representative Consultant, Gordie Howe International Bridge Project



See Item 6 on Page 5 of this Form for instructions to be used in completing this table. Attach additional pages if necessary. The information to be included in each column of the table is:

- Column A Name of hazardous substance.
- Column B Chemical Abstract Service (CAS) Number for the hazardous substance.
- Column C Maximum hazardous substance concentration measured on the property, expressed in parts per billion (e.g., ug/L or ug/Kg). Report maximum concentration separately for each environmental medium.
- Column D Sample location for Column C (relate to label on map).
- Column E Environmental medium in which concentration reported in Column C was measured (e.g., soil or groundwater).
- Column F Distance from point of maximum measured concentration (Column D) to property boundary, in direction of contaminant migration, if direction is known or can reasonably be inferred. If direction is unknown, list distance to nearest property boundary.
- Column G Direction of contaminant migration, if known.
- Column H Concentration closest to property boundary, if known. If a concentration lower than the maximum concentration reported in Column C has been measured at a point closer to the property boundary in the direction of contaminant migration, use Column H to list the concentration that was measured closest to the property boundary in the direction of contaminant migration.
- Column I Sample location for Column H (relate to label on map).
- Column J Environmental medium for measurement reported in Column H, if applicable.

**PLEASE SEE ATTACHED TABLE 1**

A Hazardous Substance	B CAS Number	C Maximum Concentration	D Sample Location for "C"	E Environmental Medium for "C"	F Distance to Property Boundary	G Direction of Migration	H Boundary Concentration	I Sample Location for "H"	J Environmental Medium for "H"

Total Number Samples Collected: \_\_\_\_\_ Total Number of Samples Exceeding Criteria: \_\_\_\_\_

**A scaled map or drawing showing these locations and the property boundaries must be submitted with this Notice**  
**PLEASE SEE ATTACHED FIGURE 2**

TABLE 1

DEQ NOTICE OF MIGRATION ATTACHMENT

A	B	C	D	E	F	G	H	I	J
Hazardous Substance	CAS Number	Maximum Concentration	Sample Location for "C"	Environmental Medium for "C"	Distance to Property Boundary	Direction of Migration	Boundary Concentration	Sample Location for "H"	Environmental Medium for "H"
Tetrachloroethylene	127-18-4	1,600	5514_SB-01_0-2_S_SOM_20171025	Soil	10 feet	Unknown	-	-	-
Trichloroethene	79-01-6	750	5514_SB-02_0-2_S_SOM_20171025	Soil	5 feet	Unknown	-	-	-
Benzo(a)pyrene	50-32-8	7,900	5514_SB-02_0-2_S_SOM_20171025	Soil	5 feet	Unknown	-	-	-
Fluoranthene	206-44-0	17,000	5514_SB-02_0-2_S_SOM_20171025	Soil	5 feet	Unknown	-	-	-
Naphthalene	91-20-3	810	5514_SB-02_0-2_S_SOM_20171025	Soil	5 feet	Unknown	-	-	-
Phenanthrene	85-01-8	13,000	5514_SB-02_0-2_S_SOM_20171025	Soil	5 feet	Unknown	-	-	-
Cadmium	7440-43-9	2,900	5514_SB-02_0-2_S_SOM_20171025	Soil	5 feet	Unknown	-	-	-
Chromium (Total)	7440-47-3	110,000	5514_SB-02_0-2_S_SOM_20171025	Soil	5 feet	Unknown	-	-	-
Copper	7440-50-8	100,000	5514_SB-01_0-2_S_SOM_20171025	Soil	10 feet	Unknown	-	-	-
Lead - Fine Fraction	7439-92-1	470,000	5514_SB-02_0-2_S_SOM_20171025	Soil	5 feet	Unknown	-	-	-
Lead - Coarse Fraction	7439-92-1	720,000	5514_SB-02_0-2_S_SOM_20171025	Soil	5 feet	Unknown	-	-	-
Selenium	7782-49-2	1,700	5514_SB-02_0-2_S_SOM_20171025	Soil	5 feet	Unknown	-	-	-
Silver	7440-22-4	3,400	5514_SB-02_0-2_S_SOM_20171025	Soil	5 feet	Unknown	-	-	-
Zinc	7440-66-6	350,000	5514_SB-02_0-2_S_SOM_20171025	Soil	5 feet	Unknown	-	-	-

Total Number of Samples Collected: 5

Total Number of Samples Exceeding Criteria: 5



**LEGEND**

- SITE
- + BORING LOCATION
- POLE-MOUNTED TRANSFORMER
- LIMITS OF EXISTING BUILDING (APPROXIMATE)
- ESTIMATED AREA OF IMPACT BY VOCs
- ESTIMATED AREA OF IMPACT BY SVOCs
- ESTIMATED AREA OF IMPACT BY METALS

ACRONYMS	
DCC	Direct Contact Criteria
DWPC	Drinking Water Protection Criteria
GSIPC	Groundwater Surface Water Interface Protection Criteria
NE	No Exceedance
SVOC	Semi-Volatile Organic Compound
VOC	Volatile Organic Compound

ABBREVIATIONS	
Cd	Cadmium
Cr, Tot	Chromium, Total
Cu	Copper
Pb (coarse)	Lead, Coarse Fraction
Pb (fine)	Lead, Fine Fraction
Se	Selenium
Ag	Silver
Zn	Zinc

- NOTES:
1. Concentrations are reported in micrograms per kilogram ( $\mu\text{g}/\text{kg}$ ).
  2. Refer to Table 1 of the PSI Report for a detailed summary of analytical data compared to residential GCC.
  3. All samples were analyzed for VOCs, SVOCs, MI-10 metals, and PCBs. PCBs were not detected.
  4. All shallow samples were analyzed for asbestos. Asbestos was either not detected or detected at levels below residential GCC.

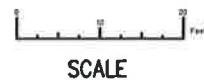

LOCATION ID	5514_SB-01	5514_SB-01
DEPTH (FT)	0 - 2	6 - 8
SAMPLE DATE	10/25/2017	10/25/2017
VOCs	GSIPC, DWPC	DWPC
Metals	-	-
	Cu 100,000 GSIPC	NE
	Se 1,100 GSIPC	NE
	Zn 190,000 GSIPC	NE

LOCATION ID	5514_SB-02	5514_SB-02	5514_SB-02
DEPTH (FT)	0 - 2	6 - 8	6 - 8
SAMPLE DATE	10/25/2017	10/25/2017	10/25/2017
VOCs	DWPC	DWPC	DWPC
SVOCs	GSIPC, DWPC, DCC	NE	GSIPC, DWPC, DCC
Metals	-	-	-
	Cd 2,900 GSIPC	NE	NE
	Cr, Tot 110,000 GSIPC, DWPC	NE	NE
	Cu 96,000 GSIPC	NE	NE
	Pb (coarse) 720,000 DCC	NE	NE
	Pb (fine) 470,000 DCC	NE	NE
	Se 1,700 GSIPC	860 GSIPC	1,400 GSIPC
	Ag 3,400 GSIPC	NE	NE
	Zn 350,000 GSIPC	NE	NE

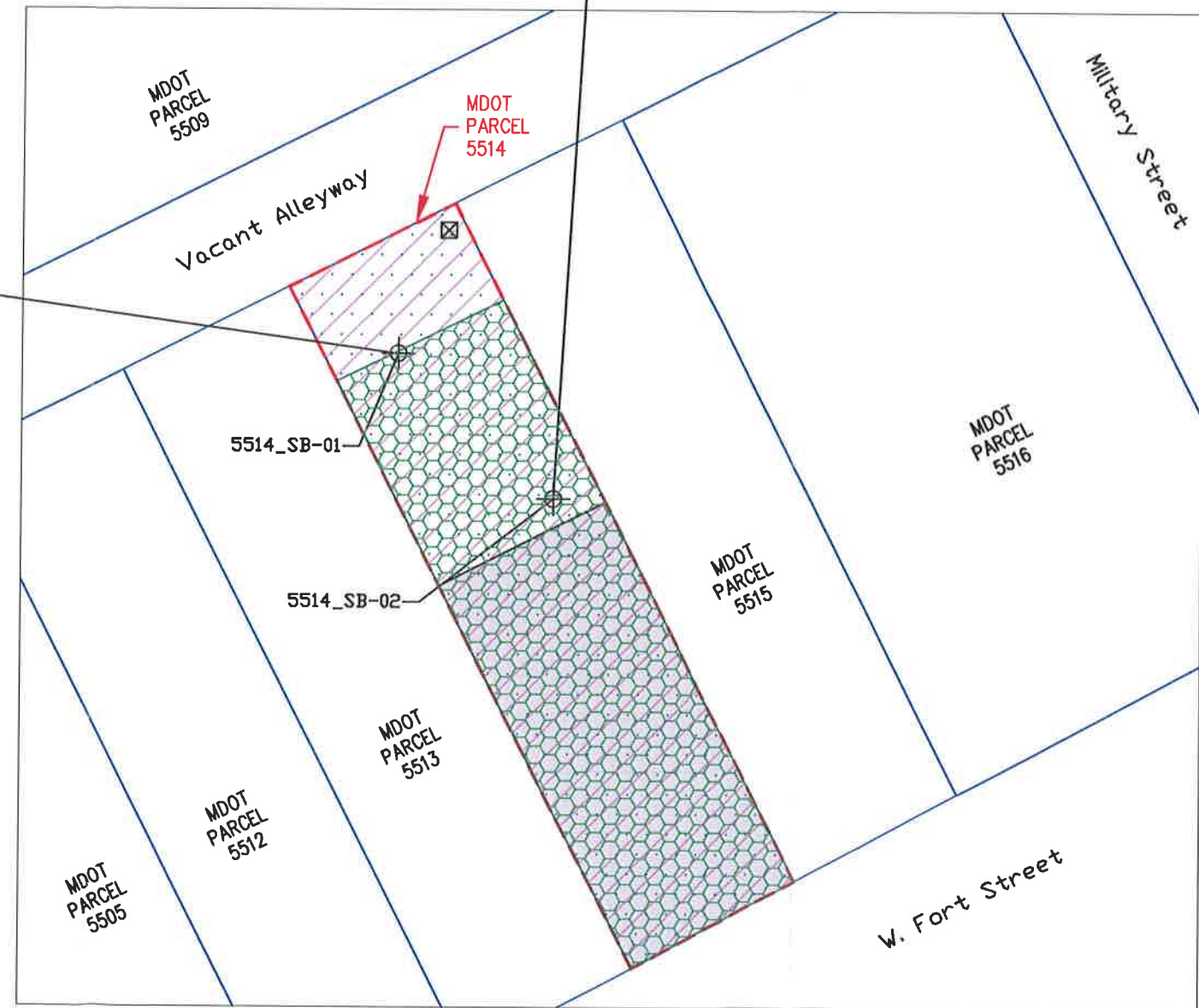

DRAWN BY:  
W. TRAM

DATE DRAWN:  
11/20/2017

CHECKED BY:  
M. CARRIERE

DATE CHECKED:  
11/21/2017

PAGE 8 OF 8



Somat Engineering, Inc.

3031 WEST GRAND BOULEVARD, SUITE 228  
DETROIT, MI 48202

PHONE: (313) 963-2721  
FAX: (313) 963-2736

PREPARED FOR:



FIGURE 2  
SOIL RESIDENTIAL EXCEEDANCE MAP  
PRELIMINARY SITE INVESTIGATION  
INTERCHANGE AREA MDOT PARCEL 5514  
6114 W. Fort Street, Detroit MI