



July 12, 2019

City of Detroit Department of Public Works
City Engineering & Street Maintenance Divisions
Coleman A. Young Municipal Center
2 Woodward Avenue, Suite 611
Detroit, Michigan 48226

Re: Notice of Migration of Contamination
From 5840, 5880, 5894 W. Jefferson Ave. and/or 5833, 5853, 5857, 5861, 5867 Reeder St., Detroit, MI,
Tax IDs 16000037-41, 16000076, 16000079-82 (MDOT Parcels 5112_5112, 5112_5114, 5112_5117)
Potentially toward W. Jefferson Avenue right-of-way to the south; Reeder Street right-of-way to the north;
S. Cavalry Street right-of-way to the west; and/or alley rights-of-way to the east and within the Site
Notification No. 5112.5114.5117-ROW

To whom it may concern:

The Mannik Smith Group, Inc. ("MSG"), on behalf of the Michigan Department of Transportation ("MDOT"), has directed or conducted underground environmental testing at 5840, 5880, 5894 W. Jefferson Avenue and 5833, 5853, 5857, 5861, 5867 Reeder Street, Detroit, Michigan ("the Site") in relation to the Gordie Howe International Bridge project underway in the vicinity of the rights-of-way referenced above ("the subject properties").

The Michigan Department of Environment, Great Lakes, and Energy ("EGLE"), formerly the Department of Environmental Quality, requires distribution of the enclosed a Notice of Migration of Contamination form when there is evidence that environmental contamination at one property has or may have affected nearby properties. Hazardous substance(s) were identified in soil and/or groundwater sample(s) collected at the Site at concentration(s) that exceed Generic Residential Cleanup Criteria and Screening Levels established by the EGLE.

At this time, it is not known if the subject properties have been affected by the environmental contamination at the Site. Also, the identification of hazardous substance(s) at the Site does not necessarily mean a hazardous situation or immediate danger currently exists. MSG, on behalf of the MDOT, is providing this notice to you as a precautionary measure and for your general awareness of environmental conditions at the Site.

Please review the enclosed document and if you have any questions regarding the Notice of Migration of Contamination please contact Karen Williams of the EGLE at 586-753-3884. If you have general questions regarding the contents of this letter please contact Walter Bolt of MSG at 734-397-3100, extension 6025 or Jim Woodruff of the MDOT at 517-241-9115.

Sincerely,

Walter J. Bolt, CPG
Project Manager
Environmental Owners Representative Consultant
Gordie Howe International Bridge Project

CC: Jim Woodruff – MDOT
Karen Williams – EGLE RRD Project Manager
Paul Max – General Manager, Environmental Affairs, City of Detroit BSEED
Anita Harrington – Environmental Specialist II, City of Detroit BSEED

RECEIVED JUL 17 2019

TECHNICAL SKILL.
CREATIVE SPIRIT.

5112.5114.5117 Notice Cover Letter.DetroitDPW.docx

RECEIVED JUL 17 2019



<p>For DEQ Use Only ITS # _____ Site ID # _____ Category Code: _____</p>
--

NOTICE OF MIGRATION OF CONTAMINATION (FORM EQP4482 REV. 4/16)

(Under the authority of Part 201, Natural Resources and Environmental Protection Act, 1994 Act 451, as amended, (NREPA) and the Rules promulgated thereunder)

An owner or operator of property that is a facility, and/or who is subject to MCL324.20107a, and who has reason to believe that a hazardous substance is emanating from, has emanated from, or is likely to be emanating from the property and migrating beyond the boundaries of the property that he or she owns or operates is required under R 299.51017(1) and MCL 324.20114(1)(b)(ii) & (iii) to notify the Michigan Department of Environmental Quality (DEQ) and affected property owners. Submission of this notice does not fulfill the notification requirements of MCL 324.21309a.

The notice must be provided within 45 days (MCL 324.20107a) or within 30 days (MCL 324.20114) after the owner or operator has reason to believe that hazardous substances have migrated, or are likely to have migrated, to or beyond the boundary of his or her property (see R 299.51017 for exceptions that apply to parties subject to MCL 324.20107a).

Use of this form is mandatory for the notice required by R 299.51017(1) and may also be used by parties subject to MCL 324.20114(1)(b)(ii) & (iii). This form may also be used to provide notice to affected property owners as required by those rules.

If a person holds a permit for an oil and gas well under Part 615, Supervisor of Wells, of the NREPA and there is a release from the oil and gas exploration or production activities, that person shall give notice to the DEQ and to the owner of the surface rights of the property.

If a person holds an easement and there is a release from the easement holder's activities, that person shall provide notice to the DEQ and to the grantor of the easement, or the grantor's successor in interest, if any.

Completing this notice in no way relieves a person who is subject to MCL 324.20114 from the responsibility to undertake required response activities.

This notice must be sent to the DEQ office that serves the county in which the property is located. A list of DEQ offices is available at www.michigan.gov/deqducare, or by calling the Remediation and Redevelopment Division's Lansing office at 517-284-5187. The DEQ will not prepare acknowledgement of receipt of these notices. The sender is responsible for sending the report using a method that provides proof of delivery if such proof is desired. Please label the outside of the envelope "Migration Notice." Additional guidelines for the compliance with the requirements of R 299.51017(1) or MCL 324.20114(1)(b)(ii) & (iii) are available at www.michigan.gov/deqducare.

THIS NOTICE IS PROVIDED PURSUANT TO: R 299.51017 MCL 324.20114(1)
(check both, if applicable)

Please provide the following information as completely as possible.

<p>1. Name and location of the property that hazardous substances are emanating from:</p> <p>Name: MI Dept. of Transportation (MDOT) Parcels 5112, 5114, & 5117 Address: 5840, 5880, & 5894 West Jefferson Avenue & 5833, 5853, 5857, 5861, & 5867 Reeder Street Location: Michigan City/County: Detroit/Wayne Property Tax Identification Number, or if applicable, the ward and item number: 16000037-41, 16000076, & 16000079-82</p> <p>Latitude (decimal degrees): 42.303100 Longitude (decimal degrees): 83.095103 Reference Point for Latitude and Longitude: Center of Site: <input checked="" type="checkbox"/> Main/front door: <input type="checkbox"/> Front gate/main entrance: <input type="checkbox"/> Other: <input type="checkbox"/> Collection Method: Survey: <input type="checkbox"/> Interpolation: <input type="checkbox"/> GPS: <input checked="" type="checkbox"/></p>	<p>2. Status relative to the property: (Check one or both, as applicable.)</p> <p>Owner <input checked="" type="checkbox"/> Operator <input type="checkbox"/></p>
--	--



2. Provide any additional ID numbers associated with the property (e.g., EPA ID No., BEA No., Part 213 facility ID No., etc.):

Gordie Howe International Bridge Parcels 5112_5112, 5112_5114, & 5112_5117;
EPA Handler ID MIK694333063; MERA Site ID 82002800; CNTS-RRD-16-001

3. Name, address, and telephone number of the property owner, operator, or other party submitting the notice:

Name: MDOT Bureau of Development, Environmental Services Section
Address: 425 W. Ottawa Street, P.O. Box 30050
City/State: Lansing, MI, 48909
Telephone Number: 517-241-9115

4. Name, address and telephone number of a contact person familiar with the content of the notice:

Name: Walter Bolt of The Mannik & Smith Group, Inc. Environmental Owner's Rep Consultant to MDOT
Address: 2365 Haggerty Road South
City/State: Canton, MI 48188
Telephone Number: 734-397-3100 x. 6025

5. If this Notice is provided pursuant to R 299.51017, provide the address and other location information for the *adjacent* property(s) onto which contamination is migrating, has migrated, or is likely to migrate.

If this Notice is provided pursuant to MCL Section 324.20114(1), provide the address and other location information for *each* property onto which contamination has migrated. Notice should be sent to the property owner of record. If the impacted property is owned by the State of Michigan, notice should be sent to the department managing the property (e.g., a prison, state park, etc.). Notices to the Michigan Department of Transportation (MDOT) for state owned roadways should be sent to Contaminated Site Specialist, Environmental Services Section, MDOT-Bureau of Development, 425 W. Ottawa Street, P.O. Box 30050, Lansing, MI 48909. If the impacted property is owned by the State of Michigan, notice should be sent to the department managing the property (i.e. a prison, state park, etc.).

Address: 5851 W. Jefferson Ave. Notified? No Yes Date: July 12, 2019
City/State: Detroit, MI
Property Tax ID number: 16000007-9
Other: Revere Dock, LLC

Address: 6000 W. Jefferson Ave. Notified? No Yes Date: July 12, 2019
City/State: Detroit, MI
Property Tax ID number: 16000036
Other: MDOT Parcel 5104

Address: 5873 Reeder Street Notified? No Yes Date: July 12, 2019
City/State: Detroit, MI
Property Tax ID number: 16000083
Other: MDOT Parcel 5113

Address: 5841 & 5849 Reeder Street Notified? No Yes Date: July 12, 2019
City/State: Detroit, MI
Property Tax ID number: 16000077-8
Other: MDOT Parcel 5116

Address: 5825 Reeder Street Notified? No Yes Date: July 12, 2019
City/State: Detroit, MI
Property Tax ID number: 16000075
Other: MDOT Parcel 5118



MICHIGAN DEPARTMENT OF ENVIRONMENTAL QUALITY
REMEDIATION AND REDEVELOPMENT DIVISION

Address: 5828 W. Jefferson Ave.
City/State: Detroit, MI
Property Tax ID number: 16000042.001
Other: MDOT Parcel 5119
Notified? No Yes Date: July 12, 2019

Address: 5822 W. Jefferson Ave.
City/State: Detroit, MI
Property Tax ID number: 16000043-5
Other: MDOT Parcel 5120_5120
Notified? No Yes Date: July 12, 2019

Address: 5824 W. Jefferson Ave.
City/State: Detroit, MI
Property Tax ID number: 16000042.002L
Other: MDOT Parcel 5721
Notified? No Yes Date: July 12, 2019

Address: 2 Woodward Avenue, Ste. 611
City/State: Detroit, MI, 48226
Property Tax ID number: NA
Other: City of Detroit (W. Jefferson Ave. & S. Cavalry St. adjacent to 5840, 5880, 5894 W. Jefferson Ave./16000037-41; Reeder St. adjacent to 5833 Reeder St./16000076 & 5853, 5857, 5861, 5867 Reeder St./16000079-82; & alley adjacent to listed properties)
Notified? No Yes Date: July 12, 2019

Address: 27175 Energy Way
City/State: Novi, MI, 48377
Property Tax ID number: NA
Other: International Transmission Company (ITC) (utility holder)
Notified? No Yes Date: July 12, 2019

Address: 735 Randolph Street, Ste. 1900
City/State: Detroit, MI, 48226
Property Tax ID number: NA
Other: Great Lakes Water Authority (utility holder)
Notified? No Yes Date: July 12, 2019

Address: 12775 Lydon Street
City/State: Detroit, MI, 48227
Property Tax ID number: NA
Other: Comcast/Xfinity (utility holder)
Notified? No Yes Date: July 12, 2019

Address: 208 S. Akard Street
City/State: Dallas, TX, 75202
Property Tax ID number: NA
Other: AT&T Headquarters (utility holder)
Notified? No Yes Date: July 12, 2019

Address: One Energy Plaza, Ste. 1935
City/State: Detroit, MI, 48226
Property Tax ID number: NA
Other: Detroit Edison, DTE (utility holder)
Notified? No Yes Date: July 12, 2019

Address: 6425 Huber Street
City/State: Detroit, MI, 48211
Property Tax ID number: NA
Other: Detroit Water & Sewerage Department (utility holder) – via email
Notified? No Yes Date: July 12, 2019



MICHIGAN DEPARTMENT OF ENVIRONMENTAL QUALITY
REMEDIATION AND REDEVELOPMENT DIVISION

Address: 3245 E. Jefferson Avenue, Ste. 100
City/State: Detroit, MI, 48207
Property Tax ID number: NA
Other: Detroit Health Department – via email

Notified? No Yes Date: July 12, 2019

Address: 27700 Donald Court
City/State: Warren, MI, 48092-2793
Property Tax ID number: NA
Other: EGLE, Southeast Michigan District Office
Office of Drinking Water & Municipal Assistance Division

Notified? No Yes Date: July 12, 2019

(Attach additional pages as needed) **PLEASE SEE ATTACHED MAP OF PROPERTY TAX ID NUMBERS.**

MAP OF PROPERTY TAX ID NUMBERS

Date Saved: 7/9/2019 3:18:16 PM
Path: S:\Projects\Project K-OMDOT0070\ENGAPPS\GIS\Map_Files\Notification Maps\5112_4_7_Offsite_Property_Tax_ID.mxd

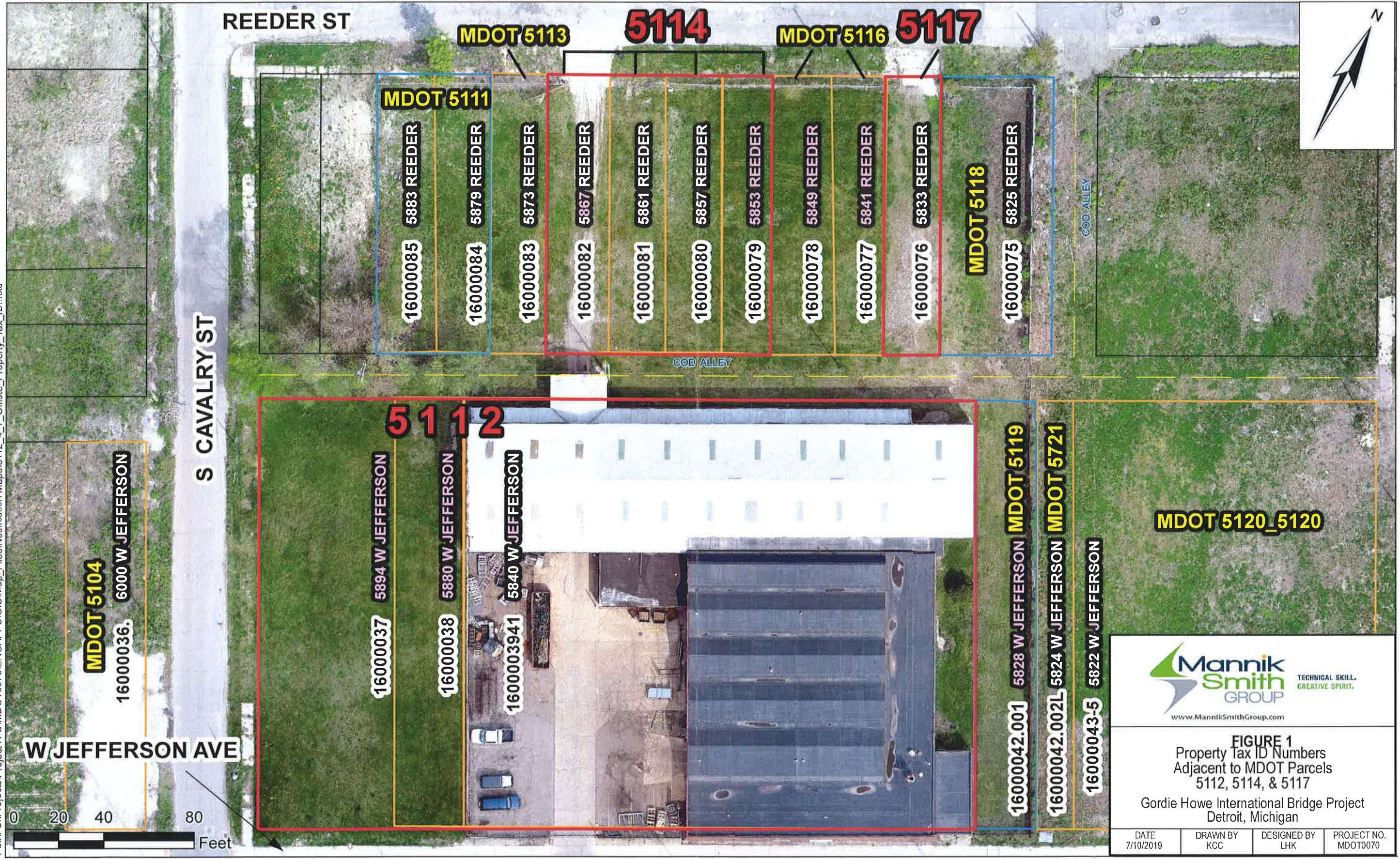



FIGURE 1
Property Tax ID Numbers
Adjacent to MDOT Parcels
5112, 5114, & 5117

Gordie Howe International Bridge Project
Detroit, Michigan

DATE 7/10/2019	DRAWN BY KCC	DESIGNED BY LHK	PROJECT NO. MDOT0070
-------------------	-----------------	--------------------	-------------------------

- MDOT Parcels 5112, 5114, 5117
- Adjacent MDOT Parcels
- Tax ID Parcel Boundaries
- MDOT Parcels



6. Complete the Table on Page 6 of this Form for each hazardous substance which has migrated, or is likely to have migrated, beyond the property boundary at a concentration that exceeds a Generic Residential Cleanup Criterion developed by the DEQ pursuant to MCL 324.20120a(1). Complete and attach additional copies of Page 6, if necessary, to list all hazardous substances that must be reported. Include a scaled map or drawing that shows the location of sampling points identified on the Table on Page 6, the property boundaries, and the adjacent property owners if providing notice pursuant to R 299.1017(1) or all impacted property owners if providing notice pursuant to MCL 324.20114(1).
7. Provide a summary of the information which shows that contamination is emanating from, or has emanated from, and is present beyond the boundary of the source property at a concentration which exceeds the generic residential criteria developed by the DEQ pursuant to MCL 324.20120a(1)(a). This summary shall identify the environmental media affected, specific hazardous substances, and the concentrations of those hazardous substances in all affected environmental media at the property boundary and in any sample locations beyond the property boundary. The summary shall also describe the basis for the conclusion that the contamination is emanating, has emanated, or is present beyond the boundary of the source property, including whether the conclusion is based on groundwater analytical data or fate and transport modeling, both, or neither.
8. If the person making this notice has reason to believe that a migrating hazardous substance has affected, or is likely to affect, a private or public water supply, then that water supply must be identified here:

NA

YES NO

9. Is this notice being submitted within the timeframes established under R 299.51017 and/or MCL 324.20114(1), as applicable?
10. Is this notice in addition to a notice that was submitted prior to *December 21, 2002*? (R 299.51017(4)(c))
11. Is this notice related to an oil and gas well permit (R 299.51017(2))? Permit #:
12. Is this notice related to an easement (R 299.51017(3))? (NOTE: All easement grantors *must* receive this notice.)
13. Has surface water been affected (R 299.51017(1))? (If yes, please identify the affected surface water body.)

CERTIFICATION:

With my signature below, I certify that I am the owner of the facility or that I am legally authorized to execute this notice on behalf of the owner or operator named on this form, and that to the best of my knowledge and belief the above representations are complete and accurate. I understand that intentionally submitting false information to the DEQ is a felony and may result in fines up to \$25,000 for each violation.

Signature Walter J. Bolt
(Owner or person legally authorized to bind the person making this report)

Date July 12, 2019

Name (Typed or Printed) Walter J. Bolt

Title (Typed or Printed) Project Manager, Environmental Owners Representative Consultant, Gordie Howe International Bridge Project, on behalf of Michigan Department of Transportation



See Item 6 on Page 5 of this Form for instructions to be used in completing this table. Attach additional pages if necessary. The information to be included in each column of the table is:

- Column A Name of hazardous substance.
- Column B Chemical Abstract Service (CAS) Number for the hazardous substance.
- Column C Maximum hazardous substance concentration measured on the property, expressed in parts per billion (e.g., ug/L or ug/Kg). Report maximum concentration separately for each environmental medium.
- Column D Sample location for Column C (relate to label on map).
- Column E Environmental medium in which concentration reported in Column C was measured (e.g., soil or groundwater).
- Column F Distance from point of maximum measured concentration (Column D) to property boundary, in direction of contaminant migration, if direction is known or can reasonably be inferred. If direction is unknown, list distance to nearest property boundary.
- Column G Direction of contaminant migration, if known.
- Column H Concentration closest to property boundary, if known. If a concentration lower than the maximum concentration reported in Column C has been measured at a point closer to the property boundary in the direction of contaminant migration, use Column H to list the concentration that was measured closest to the property boundary in the direction of contaminant migration.
- Column I Sample location for Column H (relate to label on map).
- Column J Environmental medium for measurement reported in Column H, if applicable.

PLEASE SEE ATTACHED TABLE 1

A Hazardous Substance	B CAS Number	C Maximum Concentration	D Sample Location for "C"	E Environmental Medium for "C"	F Distance to Property Boundary	G Direction of Migration	H Boundary Concentration	I Sample Location for "H"	J Environmental Medium for "H"

Total Number Samples Collected: _____ Total Number of Samples Exceeding Criteria: _____

A scaled map or drawing showing these locations and the property boundaries must be submitted with this Notice PLEASE SEE ATTACHED FIGURE 2

TABLE 1
DEQ NOTICE OF MIGRATION ATTACHMENT

A	B	C	D	E	F	G	H	I	J
Hazardous Substance	CAS Number	Maximum Concentration	Sample Location for "C"	Environmental Medium for "C"	Distance to Property Boundary	Direction of Migration	Boundary Concentration	Sample Location for "H"	Environmental Medium for "H"
Benzene	71-43-2	130	5112_SB-11_13-15_S_PM_20161022	Soil	10 feet	Unknown	-	-	-
Tetrachloroethylene	127-18-4	150	5112_SB-02_0-2_S_PM_20161022	Soil	55 feet	Unknown	-	-	-
Acenaphthene	83-32-9	23,000	5112_SB-05_0-2_S_PM_20161022	Soil	10 feet	Unknown	-	-	-
Benzo(a)anthracene	56-55-3	42,000	5112_SB-05_0-2_S_PM_20161022	Soil	10 feet	Unknown	-	-	-
Benzo(b)fluoranthene	205-99-2	50,000	5112_SB-05_0-2_S_PM_20161022	Soil	10 feet	Unknown	-	-	-
Benzo(a)pyrene	50-32-8	41,000	5112_SB-05_0-2_S_PM_20161022	Soil	10 feet	Unknown	-	-	-
Carbazole	86-74-8	13,000	5112_SB-05_0-2_S_PM_20161022	Soil	10 feet	Unknown	-	-	-
Dibenzo(a,h)anthracene	53-70-3	6,100	5112_SB-05_0-2_S_PM_20161022	Soil	10 feet	Unknown	-	-	-
Dibenzofuran	132-64-9	15,000	5112_SB-05_0-2_S_PM_20161022	Soil	10 feet	Unknown	-	-	-
Fluoranthene	206-44-0	110,000	5112_SB-05_0-2_S_PM_20161022	Soil	10 feet	Unknown	-	-	-
Fluorene	86-73-7	18,000	5112_SB-05_0-2_S_PM_20161022	Soil	10 feet	Unknown	-	-	-
Indeno(1,2,3-cd)pyrene	193-39-5	25,000	5112_SB-05_0-2_S_PM_20161022	Soil	10 feet	Unknown	-	-	-
2-Methylnaphthalene	91-57-6	6,500	5112_SB-05_0-2_S_PM_20161022	Soil	10 feet	Unknown	-	-	-
Naphthalene	91-20-3	10,000	5112_SB-05_0-2_S_PM_20161022	Soil	10 feet	Unknown	-	-	-
Phenanthrene	85-01-8	140,000	5112_SB-05_0-2_S_PM_20161022	Soil	10 feet	Unknown	-	-	-
Arsenic	7440-38-2	41,000	5117_SB-02_12-14_S_PM_20161023	Soil	10 feet	Unknown	-	-	-
Chromium (Total)	7440-47-3	25,000	5112_SB-05_0-2_S_PM_20161022	Soil	10 feet	Unknown	-	-	-
Copper	7440-50-8	1,900,000	5112_SB-02_0-2_S_PM_20161022	Soil	55 feet	Unknown	-	-	-
Lead - Total (calculated)	7439-92-1	700,000	5112_SB-06_0-2_S_PM_20161022	Soil	0 feet	Unknown	-	-	-
Lead - Fine Fraction	7439-92-1	820,000	5112_SB-06_0-2_S_PM_20161022	Soil	0 feet	Unknown	-	-	-
Lead - Coarse Fraction	7439-92-1	1,300,000	5114_SB-01_0-2_S_PM_20161023	Soil	40 feet	Unknown	-	-	-
Mercury	7439-97-6	1,100	5112_SB-01_0-2_S_PM_20161022	Soil	45 feet	Unknown	-	-	-
Selenium	7782-49-2	640	5112_SB-06_0-2_S_PM_20161022	Soil	0 feet	Unknown	-	-	-
Zinc	7440-66-6	1,000,000	5112_SB-02_0-2_S_PM_20161022	Soil	55 feet	Unknown	-	-	-
Copper	7440-50-8	32	5112_Dup-01_GW_PM_20161022*	Groundwater	55 feet	Unknown	-	-	-
Selenium	7782-49-2	11	5112_Dup-01_GW_PM_20161022*	Groundwater	55 feet	Unknown	-	-	-

Total Number of Samples Collected: 50 soil, 6 groundwater











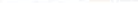

Total Number of Samples Exceeding Criteria: 14 soil, 2 groundwater

Footnotes:

* Duplicate sample corresponding to 5112_SB-02_6.5-11.5_GW_PM_20161022



LEGEND:

-  SUBJECT PROPERTY
-  APPROXIMATE FORMER/HISTORICAL SITE FEATURES
-  FENCE
-  FORMER RAIL ROAD SPUR
-  SOIL BORING (PM 2016)
-  SOIL BORING / TEMPORARY MONITORING WELL (PM 2016)
-  PREIN & NEWHOF 1992 SOIL BORING
-  FORMER DWELLING
-  FORMER OUTBUILDING
-  ESTIMATED EXTENT OF SOIL IMPACT ABOVE THE PART 201 RESIDENTIAL AND NONRESIDENTIAL DC GCC
-  ESTIMATED EXTENT OF SOIL IMPACT ABOVE THE PART 201 RESIDENTIAL DC GCC
-  ESTIMATED EXTENT OF SOIL IMPACT ABOVE THE PART 201 RESIDENTIAL GCC
-  ESTIMATED EXTENT OF GROUNDWATER IMPACT ABOVE THE PART 201 RESIDENTIAL GCC

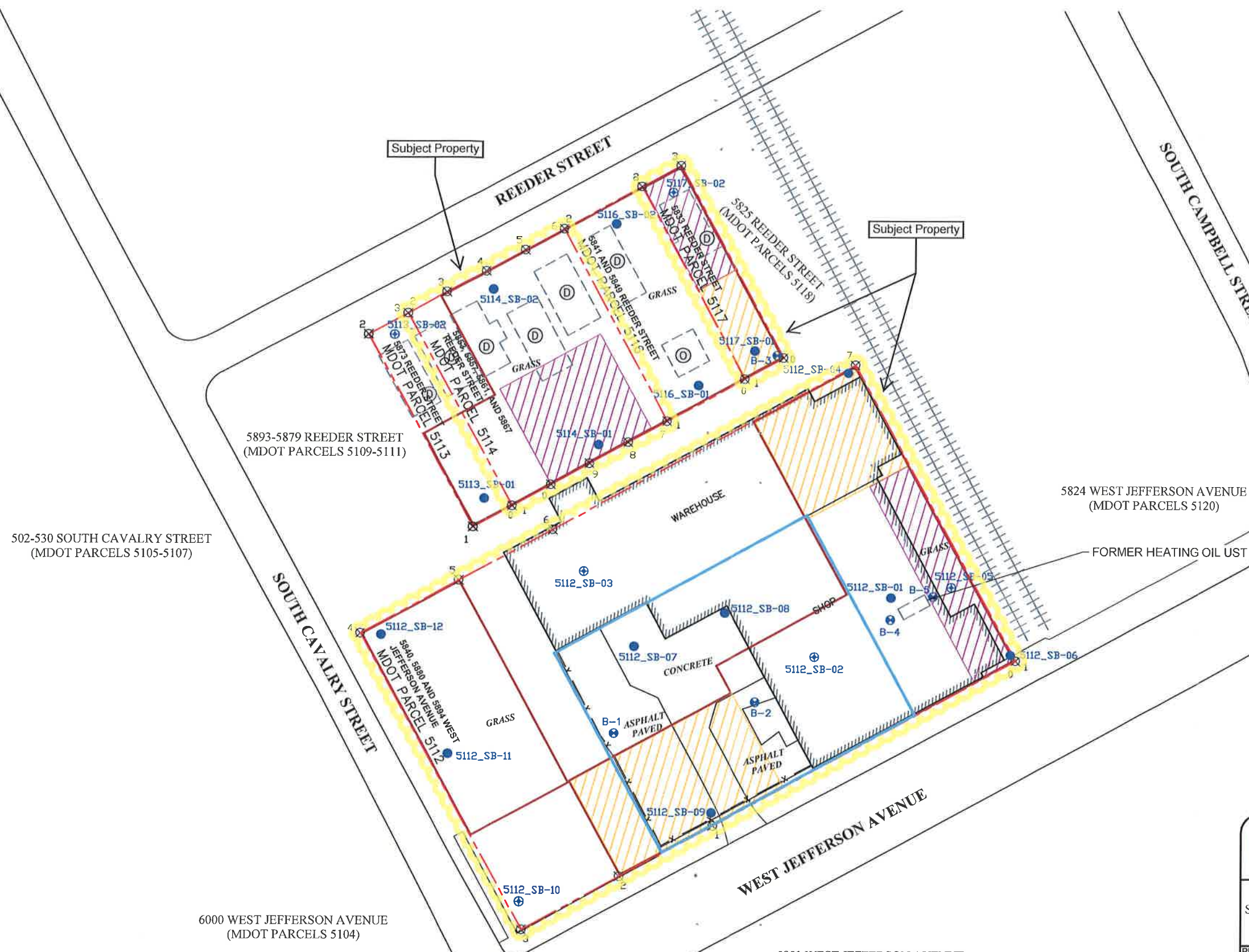

FIGURE 2
SAMPLE LOCATION MAP WITH ESTIMATED EXTENT OF SOIL AND GROUNDWATER IMPACT

PROJ: MDOT PARCELS 5112, 5113, 5114, 5116, AND 5117
DETROIT, MI

THIS IS NOT A LEGAL SURVEY	DRN BY: KS	DATE: 12/19/2016
VERIFY SCALE	CHKD BY: NL/CA	SCALE: 1" = 60'
FILE NAME: 01-7940-1-015F00R01		