

PUBLIC HIGHWAY INSTITUTIONAL CONTROL

When environmental contamination is proposed to remain in place within a public highway owned or controlled by a county road commission or local unit of government, the "Public Highway Institutional Control" may be used to satisfy all of the requirements under Section 21310a(3)(c) of Part 213, Leaking Underground Storage Tanks, of the Natural Resources and Environmental Protection Act, 1994 PA 451, as amended (NREPA). In addition, the "Public Highway Institutional Control" may serve as an alternative instrument, with department approval, pursuant to Section 20121(9) of Part 201, Environmental Remediation, of the NREPA. The party proposing this Institutional Control (IC) shall submit the completed form and all attachments with a Closure Report pursuant to Part 213 or a No Further Action Report pursuant to Part 201 to the appropriate [District Office](#). Multiple signature pages may be necessary if there is more than one authority that owns or controls the public highway. The EGLE Reference Number can be obtained by contacting the Remediation and Redevelopment Division at deq-rrd@michigan.gov, or by calling 517-284-5153.

SECTION 1. FACILITY INFORMATION:		EGLE REF. NUMBER PHIC-RRD-213-22-037	
SITE OR FACILITY NAME: 18620 Plymouth Road, LLC		SITE OR FACILITY ID NUMBER: 00034250	
STREET ADDRESS: 18620 Plymouth Road			
CITY: Detroit		ZIP: 48228	COUNTY: Wayne
NAME OF PARTY PROPOSING PUBLIC HIGHWAY IC: 18620 Plymouth, LLC		EMAIL ADDRESS: Amir2308@hotmail.com	
STREET ADDRESS: 15210 West Warren Avenue		CITY: Dearborn	STATE: MI
			ZIP: 48216
CONTACT PERSON: Mr. Amir Alshafey		PHONE: (313) 447-7327	FAX: N/A
EGLE District Office: <input type="checkbox"/> Cadillac <input type="checkbox"/> Gaylord <input type="checkbox"/> Grand Rapids <input type="checkbox"/> Jackson <input type="checkbox"/> Kalamazoo <input type="checkbox"/> Lansing <input type="checkbox"/> Saginaw Bay <input checked="" type="checkbox"/> SE Michigan <input type="checkbox"/> Upper Peninsula			

SECTION 2. AFFECTED PUBLIC HIGHWAY INFORMATION:	
1. Name of affected public highway(s) and nearest intersection: Plymouth Road, Glastonbury Avenue, and Greenview Avenue; Plymouth Road & Glastonbury Avenue and Plymouth Road & Greenview Avenue	
2. Known or suspected contaminant(s) type (Check all that apply): <input checked="" type="checkbox"/> Petroleum <input type="checkbox"/> Volatile organic compounds <input type="checkbox"/> Metals <input type="checkbox"/> Other	
3. Is residual/mobile nonaqueous-phase liquid present in the affected public highway: <input type="checkbox"/> YES <input checked="" type="checkbox"/> NO	
4. Media contaminated: a. <input checked="" type="checkbox"/> Soil Depth to contaminated soil: 2 – 7' b. <input type="checkbox"/> Groundwater Depth to contaminated groundwater: Predominant groundwater flow direction:	
5. Provide a scaled drawing of the portion of the public highway subject to the institutional control that depicts the area impacted by regulated substances and the location of utilities in the impacted area, including storm water systems and municipal separate storm water systems. At a minimum, the scaled drawing should include: a. A north arrow. b. A graphical scale bar and scale statement (e.g. 1"=50'). c. The limits of the source property plotted, to scale, showing the relationship to the county road commission or local unit of government and other affected parcels. d. The public highway(s) name identified. e. A statement identifying the Township, Range, Section, and Quarter Section where the parcel is located. f. The limits of the affected public highway plotted to scale. This area should be hatched and labeled appropriately. g. The location of significant site features such as buildings, drives, parking lots, and road surface. h. Cross section illustrating affected public highway, media, utilities, and location and depth of contaminated media. i. Most recent analytical data illustrating contaminant compounds and concentrations within the contaminated media.	

6. Provide a complete list that identifies all parties with ownership and possessory or use property interests related to the public highway (including owners of real property, easement holders, utility franchise holders, and owners or operators of public utilities):

- Detroit Water & Sewerage Department
- City of Detroit – Public Works
- DTE Energy

a. Are any of the parties listed above affected by the contamination: YES NO

b. Have all of the parties above affected by the contamination received notification of the existing conditions as part of a corrective action plan or pursuant to the due care requirements: YES NO

7. Exposure risks:

a. Due to groundwater contamination (Check all that apply):

- Drinking water Indoor air inhalation Surface water

b. Due to soil contamination (Check all that apply):

- Direct contact Ambient air Inhalation Indoor air inhalation Leaching from soil to groundwater

- Direct transport to surface water Soil excavation/relocation

Based on the exposure risks identified above, insert a paragraph below which describes the affected media, the nature and extent of the hazardous substances, the cleanup criteria exceeded, the routes of potential exposure, any response activities or corrective actions that have been taken to address the contamination, and any activities that could result in exposure to hazardous substances that would cause this institutional control to not be protective of public health, safety, and welfare (e.g. use of the groundwater for consumption, irrigation, or any other use, management and disposal of groundwater for dewatering for construction purposes; any excavation or intrusive activity that would result in contaminated soils to be placed at the ground surface or otherwise exacerbate the extent of contamination).

In May 2018, leaking underground storage tanks (USTs) were removed from the ground at the Site, along with approximately 2,228 tons of petroleum impacted soil. Groundwater was not encountered during the UST and soil removal activities. Impacted soil remains on-Site that exceed the drinking water protection (DWP) criteria, the groundwater surface water interface protection (GSIP) criteria, the soil volatilization to indoor air inhalation (SVII) criteria, and the site-specific volatilization to indoor air criteria (VIAC). Contamination has been detected and remains on-Site above the DWP and GSIP criteria, however, these are not relevant pathways for the Site because groundwater was not encountered at the property to a depth of at least 15 feet below ground surface (bgs). Groundwater is not anticipated to be continuous in the area. The property and surrounding area are serviced by the municipal water supply and no water wells are located within 0.50-mile radius of the Site, additionally, the nearest surface water body to the Site, the Rouge River, is located approximately 1.6-miles southwest of the Site. The Site and surrounding area are serviced by the municipal combined sewer system. Any water will be transported to the City of Detroit wastewater treatment plant where it will receive primary treatment before being discharged to the Detroit River. Soil ingestion, absorption and/or inhalation are potential exposure routes. The soil volatilization to indoor air pathway (VIAP) is a relevant exposure pathway that is being evaluated and addressed through quarterly sub-slab vapor sampling within the station building and off-Site soil gas monitoring. Soil contamination extends beyond the southern property boundary along Plymouth Road at approximately 3-7 feet bgs and beyond the western property boundary along Glastonbury Avenue at approximately 2-5 feet bgs. Potential residual light non-aqueous phase liquid (LNAPL) extends beyond the northeast property boundary at approximately 5-7 feet bgs and beyond the western property boundary along Glastonbury Avenue at 2-5 feet bgs approximately. A Restrictive Covenant will be filed for the Site, which imposes vapor intrusion exposure restrictions, direct contact exposure barrier restriction, and imposes contaminate soil management practices. The Owner shall manage all soils, media, and/or debris located on the Property in accordance with the applicable requirements of Section 21304b of the NREPA; Part 111, Hazardous Waste Management, of the NREPA; Subtitle C of the Resource Conservation and Recovery Act, 42 USC Section 6901 et seq.; the administrative rules promulgated thereunder; and all other relevant state and federal laws.

SECTION 3. STORM SEWER SYSTEM CERTIFICATION:

Is contamination present in or does the contamination have the potential to enter the storm sewer system (including separate storm sewer systems and combined sewers) as a result of the release from the underground storage tank system:

YES NO

If yes, please provide information below and attach any drawings, tables, etc. that clearly identifies the nature and extent of the contamination that enters or has the potential to enter the storm sewer system.

SECTION 4. SUBMITTER INFORMATION:

I, as the submitter identified in Section 1, or the qualified consultant authorized to complete this document on the submitter's behalf, hereby attest to the accuracy of the statements in this document and all attachments, and have provided this document to the county road commission or local unit of government.

Signature	Print	Date
	Keith Christofferson	5/15/23
Name of Company (if applicable)	Address, City, State, Zip	
Environmental Resources Group, LLC	28003 Center Oaks Court, Suite 106, Wixom, MI 48393	
Phone Number	Fax Number	Email Address
(248) 773-7896	(248) 924-3108	Keith.christofferson@ergrp.net

SECTION 5. COUNTY ROAD COMMISSION OR LOCAL UNIT OF GOVERNMENT CONFIRMATION:

Name of county road commission or local unit of government: City of Detroit

The aforementioned City of Detroit hereby confirms that there are no current plans to relocate, vacate, or abandon the public highway. With my signature below, I certify that I am legally authorized to sign on behalf of the City of Detroit.

Signature of Authorized Official	Print Authorized Official	
Title of Authorized Official	Date	
Name of county road commission or local unit of government	Address, City, State, Zip	
City of Detroit – Department of Public Works	2 Woodward Avenue, #611, Detroit, MI 48226	
Phone Number	Fax Number	Email Address
(313) 224-3901	NA	

Notes:
 Concentrations were compared to EGLE Cleanup Criteria Requirements for Response Activity (CCRA), Effective December 30, 2013 (formerly Part 201 Residential Generic Cleanup Criteria and Screening Levels; Part 213 Tier 1 Risk-Based Screening Levels (RBSLs)). Concentrations were also compared to Site-Specific Volatilization to Indoor Air Criteria (VIAC).

Legend for Soils:
Bold - Concentrations exceeding the Residential/Nonresidential Drinking Water Protection (DWP) CCRA.
Italic - Concentrations exceeding the Groundwater/Surface Interface Protection (GSIP) CCRA.
Underline - Concentrations exceeding the Non-Residential Site-Specific Volatilization to Indoor Air Criteria (VIAC)
 All units measured in ug/kg

Data Legend:
 B = Benzene
 E = Ethylbenzene
 N = Naphthalene
 n-B = n-Butylbenzene
 s-B = sec-Butylbenzene
 IB = Isopropyl benzene
 n-P = n-Propylbenzene
 T = Toluene
 X = Xylenes
 1,2,3-TMB = 1,2,3-Trimethylbenzene
 1,2,4-TMB = 1,2,4-Trimethylbenzene
 1,3,5-TMB = 1,3,5-Trimethylbenzene
 2-MN - 2-Methylnaphthalene
 MI ULG = Michigan Unleaded Gasoline Parameters
 GRO = Gasoline Range Organics
 ND = Non-Detect
 Analytes below EGLE cleanup criteria and laboratory detection limit were not included.
 Non Detects are noted herein.

BH-18 (5-6)		BH-19 (9-10)	
MI ULG	ND	MI ULG	ND
GRO	ND	GRO	ND

BH-19 (5-6)		BH-19 (10-11)		BH-19 (14-15)	
MI ULG	ND	MI ULG	ND	MI ULG	ND
GRO	ND	GRO	ND	GRO	ND

BH-20 (10-11)		BH-20 (13-14)		BH-20 (19-20)	
MI ULG	ND	MI ULG	ND	MI ULG	ND
GRO	ND	GRO	ND	GRO	ND

BH-30 (19-20)	
MI ULG	ND
GRO	ND

BH-21 (5-7)		BH-21 (13-14)		BH-21 (19-20)	
MI ULG	ND	MI ULG	ND	MI ULG	ND
GRO	ND	GRO	ND	GRO	ND

BH-29 (13-14)		BH-29 (19-20)	
MI ULG	ND	MI ULG	ND
GRO	ND	GRO	ND

BH-22 (5-7)		BH-22 (14-15)	
MI ULG	ND	MI ULG	ND
GRO	ND	GRO	ND

BH-27 (2-3)		BH-27 (3-5)		BH-27 (5-6)		BH-27 (14-15)	
MI ULG	ND	MI ULG	ND	MI ULG	ND	MI ULG	ND
GRO	ND	GRO	ND	GRO	ND	GRO	ND

BH-16 (3-5)		BH-16 (14-15)	
MI ULG	ND	MI ULG	ND
GRO	ND	GRO	ND

BH-17 (2-3)		BH-17 (3-5)		BH-17 (14-15)	
MI ULG	ND	MI ULG	ND	MI ULG	ND
GRO	ND	GRO	ND	GRO	ND

BH-26 (3-5)		BH-26 (14-15)	
MI ULG	ND	MI ULG	ND
GRO	ND	GRO	ND

BH-25 (4-6)		BH-25 (14-15)	
MI ULG	ND	MI ULG	ND
GRO	ND	GRO	ND

BH-24 (4-5)		BH-24 (5-7)		BH-24 (14-15)	
MI ULG	ND	MI ULG	ND	MI ULG	ND
GRO	ND	GRO	ND	GRO	ND

BH-12 (5-7)		BH-12 (11-12)	
MI ULG	ND	MI ULG	ND
GRO	ND	GRO	ND

BH-15 (5-7)		BH-15 (14-15)	
MI ULG	ND	MI ULG	ND
GRO	ND	GRO	ND

BH-13 (5-7)		BH-13 (11-12)	
MI ULG	ND	MI ULG	ND
GRO	ND	GRO	ND

BH-14 (4-6)		BH-14 (10-12)	
MI ULG	ND	MI ULG	ND
GRO	ND	GRO	ND

BH-23 (5-7)		BH-23 (14-15)	
MI ULG	ND	MI ULG	ND
GRO	ND	GRO	ND

BH-6 (3-4)		BH-6 (11-12)	
MI ULG	ND	MI ULG	ND
GRO	ND	GRO	ND

GP-1 (3-5)	
MI ULG	ND
GRO	ND

BH-4 (3-5)		BH-4 (11-12)	
MI ULG	ND	MI ULG	ND
GRO	ND	GRO	ND

BH-2 (5-6)		BH-2 (11-12)	
MI ULG	ND	MI ULG	ND
GRO	ND	GRO	ND

GP-2 (5)	
MI ULG	ND
GRO	ND

GP-4 (3-5)		GP-4 (6-7)	
MI ULG	ND	MI ULG	ND
GRO	ND	GRO	ND

GP-5 (5-6)		GP-5 (8-10)	
MI ULG	ND	MI ULG	ND
GRO	ND	GRO	ND

BH-16 (3-5)		BH-16 (14-15)	
MI ULG	ND	MI ULG	ND
GRO	ND	GRO	ND

LEGEND

- PROPERTY LINE
- CS COMBINED LATERAL SEWER
- W WATER
- FO UNDERGROUND FIBER OPTIC
- G NATURAL GAS
- OE OVERHEAD ELECTRIC
- FENCE
- UST - MULTI COMPARTMENT
- VENT PIPES
- LIMIT OF THE APPROXIMATE AREA AFFECTED FOR PUBLIC HIGHWAY INSTITUTIONAL CONTROL. PARCEL LOCATED IN T01S, R10E, SECTION 26 SW OF SE
- CATCH BASIN
- SD STORM DRAIN
- SG SOIL GAS VAPOR POINT
- P POWER POLE
- D DISPENSER
- SB PROPOSED SOIL BORING LOCATION IN ROW
- SB SOIL BORING (SB) ADVANCED BY FIBERTECH ENVIRONMENTAL SERVICES ON MAY 4TH, 2018 UNDER THE OBSERVATION OF ERG
- GP SOIL BORING (SB) ADVANCED BY FIBERTECH ENVIRONMENTAL SERVICES ON JULY 16TH, 2018 UNDER THE OBSERVATION OF ERG
- BH PROPOSED SOIL BORING LOCATION IN RESIDENTIAL AREA

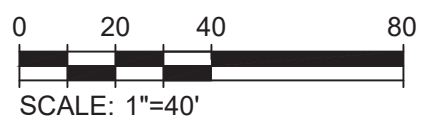

Environmental Resources Group
 28003 Center Oaks Court • Suite 106 • Wixom, MI • 48393
 Phone: 248-773-7986 • Fax: 248-924-3108

18620 PLYMOUTH, LLC

18620 PLYMOUTH ROAD
 DETROIT, MI 48228
 PUBLIC HIGHWAY SUBJECT TO INSTITUTIONAL CONTROL
 JOB No.: 1772.015
 DR. BY: RSP Date: 07/13/2020
 SHEET: FIGURE 1

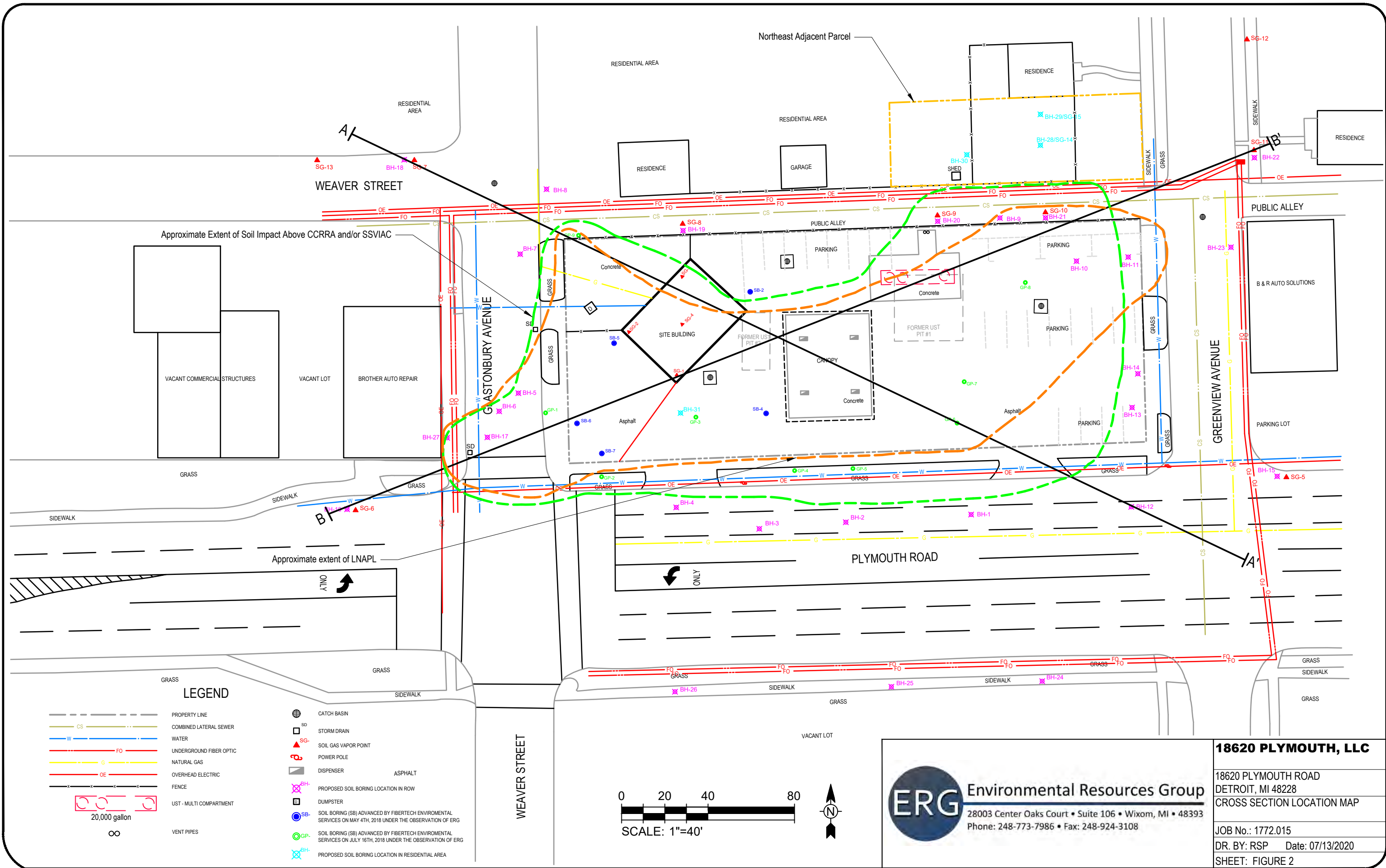

Approximate Extent of Soil Impact Above CCRRA and/or SSVIAC

Approximate extent of LNAPL

LEGEND

- PROPERTY LINE
- CS COMBINED LATERAL SEWER
- W WATER
- FO UNDERGROUND FIBER OPTIC
- G NATURAL GAS
- OE OVERHEAD ELECTRIC
- FENCE
- UST - MULTI COMPARTMENT
20,000 gallon
- VENT PIPES
- CATCH BASIN
- STORM DRAIN
- SOIL GAS VAPOR POINT
- POWER POLE
- DISPENSER
- ASPHALT
- DUMPSTER
- SOIL BORING (SB) ADVANCED BY FIBERTECH ENVIRONMENTAL SERVICES ON MAY 4TH, 2018 UNDER THE OBSERVATION OF ERG
- SOIL BORING (SB) ADVANCED BY FIBERTECH ENVIRONMENTAL SERVICES ON JULY 16TH, 2018 UNDER THE OBSERVATION OF ERG
- PROPOSED SOIL BORING LOCATION IN ROW
- PROPOSED SOIL BORING LOCATION IN RESIDENTIAL AREA

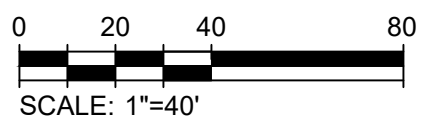

ERG Environmental Resources Group
 28003 Center Oaks Court • Suite 106 • Wixom, MI • 48393
 Phone: 248-773-7986 • Fax: 248-924-3108

18620 PLYMOUTH, LLC
 18620 PLYMOUTH ROAD
 DETROIT, MI 48228
 CROSS SECTION LOCATION MAP
 JOB No.: 1772.015
 DR. BY: RSP Date: 07/13/2020
 SHEET: FIGURE 2

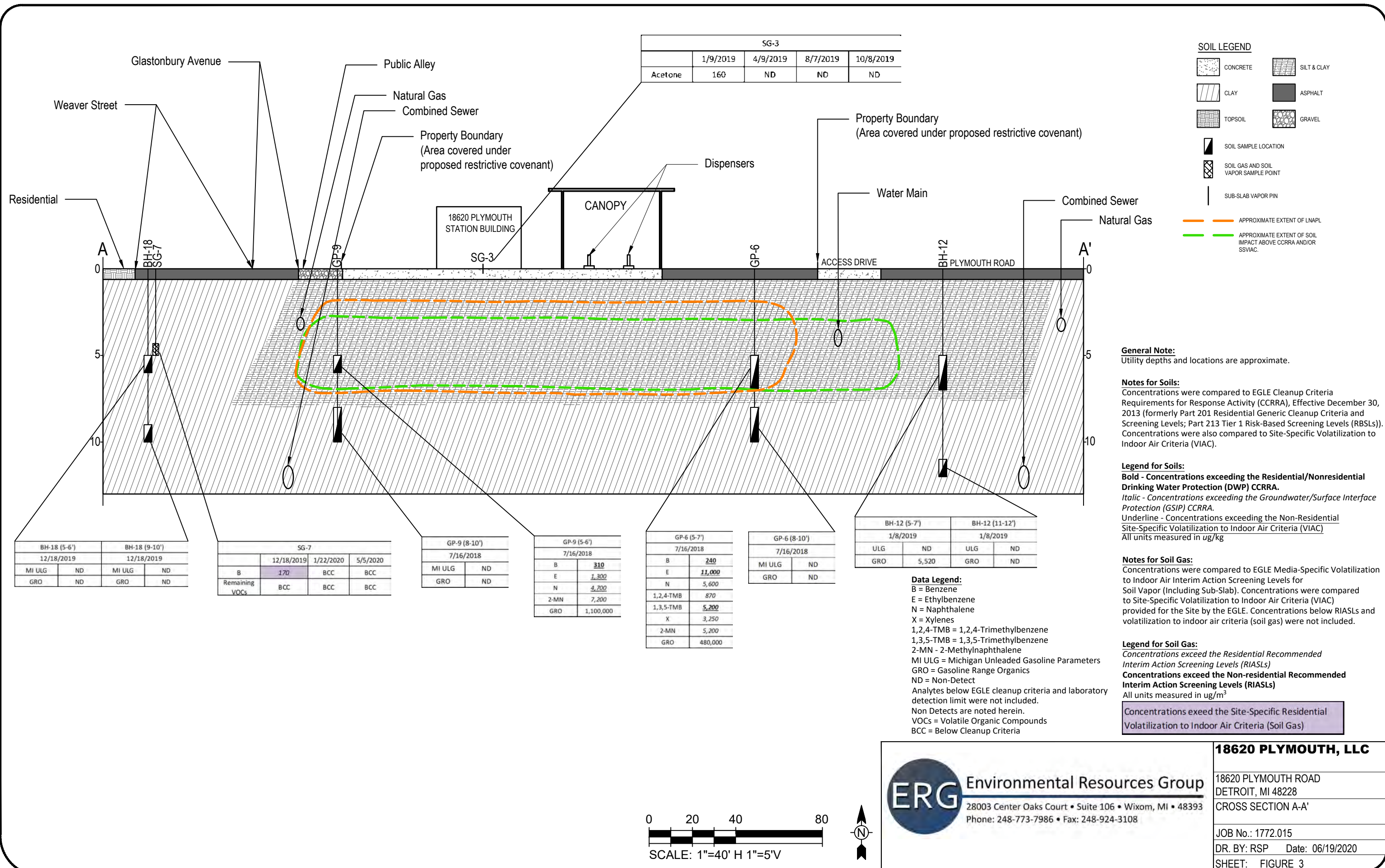

SG-3				
	1/9/2019	4/9/2019	8/7/2019	10/8/2019
Acetone	160	ND	ND	ND

SOIL LEGEND

	CONCRETE		SILT & CLAY
	CLAY		ASPHALT
	TOPSOIL		GRAVEL

SOIL SAMPLE LOCATION
 SOIL GAS AND SOIL VAPOR SAMPLE POINT
 SUB-SLAB VAPOR PIN

APPROXIMATE EXTENT OF LNAPL
 APPROXIMATE EXTENT OF SOIL IMPACT ABOVE CCRRA AND/OR SSVIAC.

General Note:
Utility depths and locations are approximate.

Notes for Soils:
Concentrations were compared to EGLE Cleanup Criteria Requirements for Response Activity (CCRRA), Effective December 30, 2013 (formerly Part 201 Residential Generic Cleanup Criteria and Screening Levels; Part 213 Tier 1 Risk-Based Screening Levels (RBSLs)). Concentrations were also compared to Site-Specific Volatilization to Indoor Air Criteria (VIAC).

Legend for Soils:
Bold - Concentrations exceeding the Residential/Nonresidential Drinking Water Protection (DWP) CCRRA.
Italic - Concentrations exceeding the Groundwater/Surface Interface Protection (GSIP) CCRRA.
Underline - Concentrations exceeding the Non-Residential Site-Specific Volatilization to Indoor Air Criteria (VIAC)
 All units measured in ug/kg

BH-18 (5-6')		BH-18 (9-10')	
12/18/2019			
MI ULG	ND	MI ULG	ND
GRO	ND	GRO	ND

SG-7			
	12/18/2019	1/22/2020	5/5/2020
B	170	BCC	BCC
Remaining VOCs	BCC	BCC	BCC

GP-9 (8-10')	
7/16/2018	
MI ULG	ND
GRO	ND

GP-9 (5-6')	
7/16/2018	
B	310
E	<u>1,300</u>
N	<u>4,700</u>
2-MN	7,200
GRO	1,100,000

GP-6 (5-7')	
7/16/2018	
B	240
E	11,000
N	5,600
1,2,4-TMB	870
1,3,5-TMB	5,200
X	3,250
2-MN	5,200
GRO	480,000

GP-6 (8-10')	
7/16/2018	
MI ULG	ND
GRO	ND

BH-12 (5-7')		BH-12 (11-12')	
1/8/2019			
ULG	ND	ULG	ND
GRO	5,520	GRO	ND

Data Legend:
 B = Benzene
 E = Ethylbenzene
 N = Naphthalene
 X = Xylenes
 1,2,4-TMB = 1,2,4-Trimethylbenzene
 1,3,5-TMB = 1,3,5-Trimethylbenzene
 2-MN = 2-Methylnaphthalene
 MI ULG = Michigan Unleaded Gasoline Parameters
 GRO = Gasoline Range Organics
 ND = Non-Detect
 Analytes below EGLE cleanup criteria and laboratory detection limit were not included.
 Non Detects are noted herein.
 VOCs = Volatile Organic Compounds
 BCC = Below Cleanup Criteria

Notes for Soil Gas:
Concentrations were compared to EGLE Media-Specific Volatilization to Indoor Air Interim Action Screening Levels for Soil Vapor (Including Sub-Slab). Concentrations were compared to Site-Specific Volatilization to Indoor Air Criteria (VIAC) provided for the Site by the EGLE. Concentrations below RIASLs and volatilization to indoor air criteria (soil gas) were not included.

Legend for Soil Gas:
Concentrations exceed the Residential Recommended Interim Action Screening Levels (RIASLs)
Concentrations exceed the Non-residential Recommended Interim Action Screening Levels (RIASLs)
 All units measured in ug/m³
Concentrations exceed the Site-Specific Residential Volatilization to Indoor Air Criteria (Soil Gas)

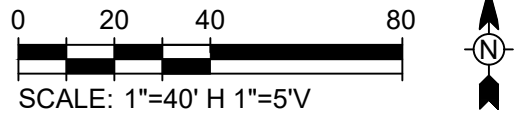

Environmental Resources Group

28003 Center Oaks Court • Suite 106 • Wixom, MI • 48393
 Phone: 248-773-7986 • Fax: 248-924-3108

18620 PLYMOUTH, LLC

18620 PLYMOUTH ROAD
 DETROIT, MI 48228
 CROSS SECTION A-A'

JOB No.: 1772.015
 DR. BY: RSP Date: 06/19/2020
 SHEET: FIGURE 3

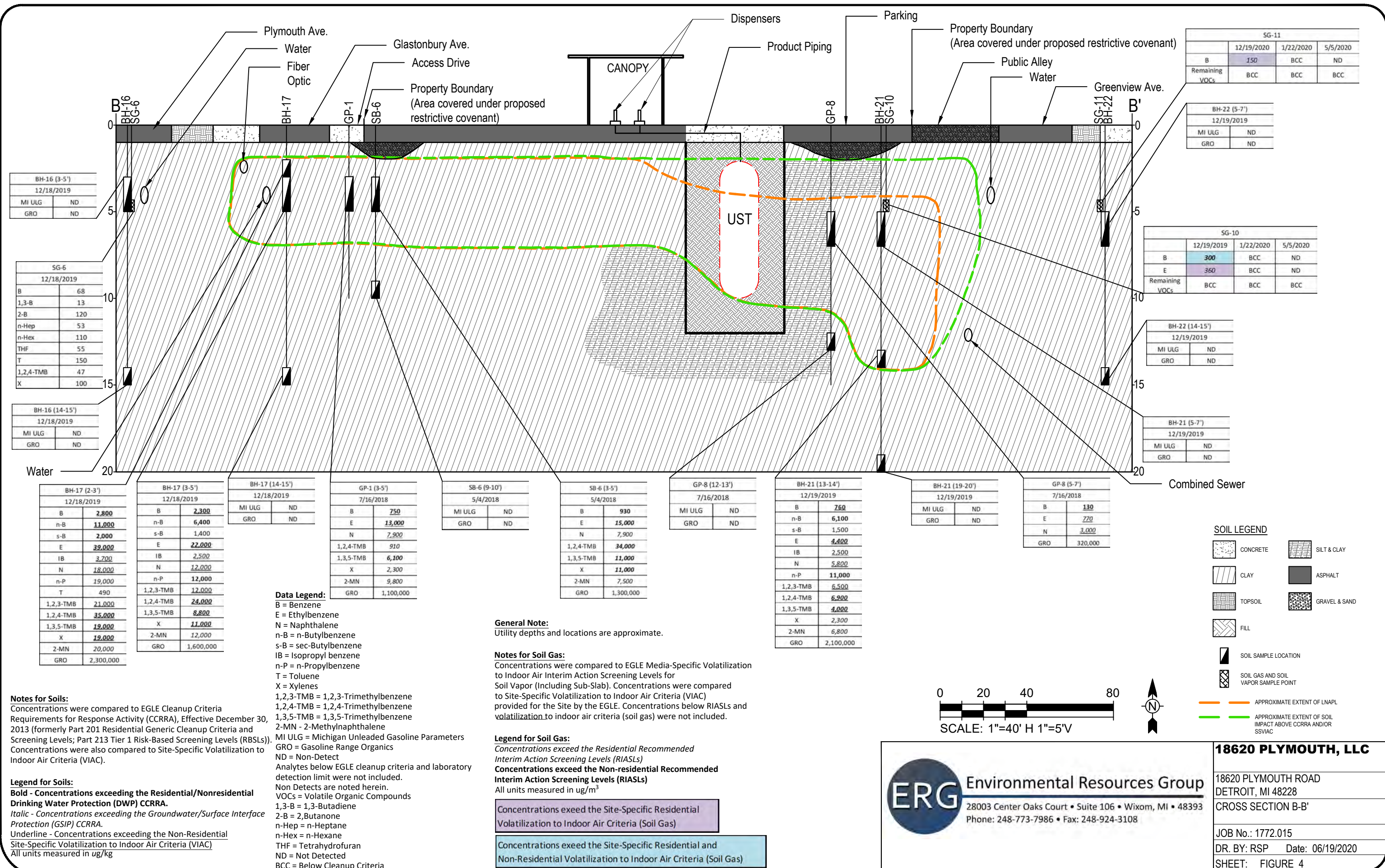

BH-16 (3-5')	
12/18/2019	
MI ULG	ND
GRO	ND

SG-6	
12/18/2019	
B	68
1,3-B	13
2-B	120
n-Hep	53
n-Hex	110
THF	55
T	150
1,2,4-TMB	47
X	100

BH-16 (14-15')	
12/18/2019	
MI ULG	ND
GRO	ND

BH-17 (2-3')	
12/18/2019	
B	2,800
n-B	11,000
s-B	2,000
E	39,000
IB	3,700
N	18,000
n-P	19,000
T	490
1,2,3-TMB	21,000
1,2,4-TMB	35,000
1,3,5-TMB	19,000
X	19,000
2-MN	20,000
GRO	2,300,000

BH-17 (3-5')	
12/18/2019	
B	2,300
n-B	6,400
s-B	1,400
E	22,000
IB	2,500
N	12,000
n-P	12,000
1,2,3-TMB	12,000
1,2,4-TMB	24,000
1,3,5-TMB	8,800
X	11,000
2-MN	12,000
GRO	1,600,000

BH-17 (14-15')	
12/18/2019	
MI ULG	ND
GRO	ND

GP-1 (3-5')	
7/16/2018	
B	750
E	13,000
N	7,900
1,2,4-TMB	910
1,3,5-TMB	6,100
X	2,300
2-MN	9,800
GRO	1,100,000

SB-6 (9-10')	
5/4/2018	
MI ULG	ND
GRO	ND

SB-6 (3-5')	
5/4/2018	
B	930
E	15,000
N	7,900
1,2,4-TMB	34,000
1,3,5-TMB	11,000
X	11,000
2-MN	7,500
GRO	1,300,000

GP-8 (12-13')	
7/16/2018	
MI ULG	ND
GRO	ND

BH-21 (13-14')	
12/19/2019	
B	760
n-B	6,100
s-B	1,500
E	4,400
IB	2,500
N	5,800
n-P	11,000
1,2,3-TMB	6,500
1,2,4-TMB	6,900
1,3,5-TMB	4,000
X	2,300
2-MN	6,800
GRO	2,100,000

BH-21 (19-20')	
12/19/2019	
MI ULG	ND
GRO	ND

GP-8 (5-7')	
7/16/2018	
B	130
E	770
N	3,000
GRO	320,000

Data Legend:
 B = Benzene
 E = Ethylbenzene
 N = Naphthalene
 n-B = n-Butylbenzene
 s-B = sec-Butylbenzene
 IB = Isopropyl benzene
 n-P = n-Propylbenzene
 T = Toluene
 X = Xylenes
 1,2,3-TMB = 1,2,3-Trimethylbenzene
 1,2,4-TMB = 1,2,4-Trimethylbenzene
 1,3,5-TMB = 1,3,5-Trimethylbenzene
 2-MN - 2-Methylnaphthalene
 MI ULG = Michigan Unleaded Gasoline Parameters
 GRO = Gasoline Range Organics
 ND = Non-Detect
 Analytes below EGLE cleanup criteria and laboratory detection limit were not included.
 Non Detects are noted herein.
 VOCs = Volatile Organic Compounds
 1,3-B = 1,3-Butadiene
 2-B = 2-Butanone
 n-Hep = n-Heptane
 n-Hex = n-Hexane
 THF = Tetrahydrofuran
 ND = Not Detected
 BCC = Below Cleanup Criteria

General Note:
 Utility depths and locations are approximate.

Notes for Soil Gas:
 Concentrations were compared to EGLE Media-Specific Volatilization to Indoor Air Interim Action Screening Levels for Soil Vapor (Including Sub-Slab). Concentrations were compared to Site-Specific Volatilization to Indoor Air Criteria (VIAC) provided for the Site by the EGLE. Concentrations below RIASLs and volatilization to indoor air criteria (soil gas) were not included.

Legend for Soil Gas:
 Concentrations exceed the Residential Recommended Interim Action Screening Levels (RIASLs)
 Concentrations exceed the Non-residential Recommended Interim Action Screening Levels (RIASLs)
 All units measured in ug/m³

Concentrations exceed the Site-Specific Residential Volatilization to Indoor Air Criteria (Soil Gas)

Concentrations exceed the Site-Specific Residential and Non-Residential Volatilization to Indoor Air Criteria (Soil Gas)

Notes for Soils:
 Concentrations were compared to EGLE Cleanup Criteria Requirements for Response Activity (CCRRA), Effective December 30, 2013 (formerly Part 201 Residential Generic Cleanup Criteria and Screening Levels; Part 213 Tier 1 Risk-Based Screening Levels (RBSLs)). Concentrations were also compared to Site-Specific Volatilization to Indoor Air Criteria (VIAC).

Legend for Soils:
 Bold - Concentrations exceeding the Residential/Nonresidential Drinking Water Protection (DWP) CCRRA.
 Italic - Concentrations exceeding the Groundwater/Surface Interface Protection (GSIP) CCRRA.
 Underline - Concentrations exceeding the Non-Residential Site-Specific Volatilization to Indoor Air Criteria (VIAC)
 All units measured in ug/kg

SG-11			
	12/19/2020	1/22/2020	5/5/2020
B	150	BCC	ND
Remaining VOCs	BCC	BCC	BCC

BH-22 (5-7')	
12/19/2019	
MI ULG	ND
GRO	ND

SG-10			
	12/19/2019	1/22/2020	5/5/2020
B	300	BCC	ND
E	360	BCC	ND
Remaining VOCs	BCC	BCC	BCC

BH-22 (14-15')	
12/19/2019	
MI ULG	ND
GRO	ND

BH-21 (5-7')	
12/19/2019	
MI ULG	ND
GRO	ND

SOIL LEGEND

	CONCRETE		SILT & CLAY
	CLAY		ASPHALT
	TOPSOIL		GRAVEL & SAND
	FILL		

- SOIL SAMPLE LOCATION
- SOIL GAS AND SOIL VAPOR SAMPLE POINT
- APPROXIMATE EXTENT OF LNAPL
- APPROXIMATE EXTENT OF SOIL IMPACT ABOVE CCRRA AND/OR SSVIAC

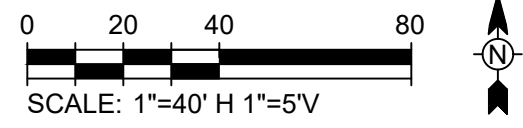

ERG Environmental Resources Group
 28003 Center Oaks Court • Suite 106 • Wixom, MI • 48393
 Phone: 248-773-7986 • Fax: 248-924-3108

18620 PLYMOUTH, LLC
 18620 PLYMOUTH ROAD
 DETROIT, MI 48228
 CROSS SECTION B-B'

JOB No.: 1772.015
 DR. BY: RSP Date: 06/19/2020
 SHEET: FIGURE 4