

December 29, 2022

City of Detroit Department of Public Works
Coleman A. Young Municipal Center
2 Woodward Avenue – Suite 611
Detroit, MI 48226

RE: Public Highway Institutional Controls
Knight #330
12750 Schaefer Highway, City of Detroit, MI
Facility ID No: 00018520
EGLE Reference Number: PHIC-RRD-213-22-040

To Whom it May Concern:

An application for utilizing institutional controls for soil and groundwater corrective action is being submitted for the Knight Enterprises, Inc. Site K-330, located at 12750 Schaefer Highway, City of Detroit, Wayne County, Michigan (Site). The Site is utilized as a gasoline station with a convenience store. BLDI, Inc. is currently retained as the environmental consultant for the Site.

The soil contamination remaining at this Site exists at concentrations that exceeds the applicable Part 213 Risk-Based Screening Levels (RBSLs) and/or Site-Specific Target Levels (SSTLs) in locations beyond the Site property boundary along and beneath the adjacent Schaefer Highway right-of-way (ROW).

The application for institutional control includes the completed Public Highway Institutional Control form. Upon your review, you will note that the Site conditions may present an exposure risk to employees or subcontractors working within the Schaefer Highway ROW. If potential construction activities would require removal of contaminated soil, the contaminated media will need to be characterized and disposed of properly, and additional precautions should be taken to prevent workers from the exposure to contaminated soil. Funding for disposal of contaminated media associated with a refined petroleum underground storage tank release and located within a public highway is available from the State of Michigan through the Michigan Underground Storage Tank Authority (MUSTA), public highway cleanup fund.

Regards,



Leslie DeBoer, EP
President, Project Manager

Attachment

cc: Mr. John Denton □ Knight Enterprises, Inc. (via email)

Corporate Office
150 Fountain Street NE
Grand Rapids, MI 49503
616.459.3737

PUBLIC HIGHWAY INSTITUTIONAL CONTROL

When environmental contamination is proposed to remain in place within a public highway owned or controlled by a county road commission or local unit of government, the "Public Highway Institutional Control" may be used to satisfy all of the requirements under Section 21310a(3)(c) of Part 213, Leaking Underground Storage Tanks, of the Natural Resources and Environmental Protection Act, 1994 PA 451, as amended (NREPA). In addition, the "Public Highway Institutional Control" may serve as an alternative instrument, with department approval, pursuant to Section 20121(9) of Part 201, Environmental Remediation, of the NREPA. The party proposing this Institutional Control (IC) shall submit the completed form and all attachments with a Closure Report pursuant to Part 213 or a No Further Action Report pursuant to Part 201 to the appropriate [District Office](#). Multiple signature pages may be necessary if there is more than one authority that owns or controls the public highway. The EGLE Reference Number can be obtained by contacting the Remediation and Redevelopment Division at deq-rrd@michigan.gov, or by calling 517-284-5153.

SECTION 1. FACILITY INFORMATION:		EGLE REF. NUMBER PHIC-RRD-213-22-040	
SITE OR FACILITY NAME: K-330		SITE OR FACILITY ID NUMBER: 00018520	
STREET ADDRESS: 12750 Schaefer Highway			
CITY: Detroit		ZIP: 48227	COUNTY: Wayne
NAME OF PARTY PROPOSING PUBLIC HIGHWAY IC: Knight Enterprises, Inc.		EMAIL ADDRESS: jdenton@knightenterprisesinc.com	
STREET ADDRESS: 47705 West Road, Suite B-102		CITY: Wixom	STATE: MI ZIP: 48393
CONTACT PERSON: John Denton		PHONE: 248-308-3970	FAX: [REDACTED]
EGLE District Office: <input type="checkbox"/> Cadillac <input type="checkbox"/> Gaylord <input type="checkbox"/> Grand Rapids <input type="checkbox"/> Jackson <input type="checkbox"/> Kalamazoo <input type="checkbox"/> Lansing <input type="checkbox"/> Saginaw Bay <input checked="" type="checkbox"/> SE Michigan <input type="checkbox"/> Upper Peninsula			

SECTION 2. AFFECTED PUBLIC HIGHWAY INFORMATION:	
1. Name of affected public highway(s) and nearest intersection: Schaefer Highway at intersection of Jefferies Service Drive	
2. Known or suspected contaminant(s) type (Check all that apply): <input checked="" type="checkbox"/> Petroleum <input checked="" type="checkbox"/> Volatile organic compounds <input type="checkbox"/> Metals <input type="checkbox"/> Other [REDACTED]	
3. Is residual/mobile nonaqueous-phase liquid present in the affected public highway: <input checked="" type="checkbox"/> YES <input type="checkbox"/> NO	
4. Media contaminated: a. <input checked="" type="checkbox"/> Soil Depth to contaminated soil: at least 0.5 feet to 14.5 feet bgs b. <input type="checkbox"/> Groundwater Depth to contaminated groundwater: NA Predominant groundwater flow direction: NA	
5. Provide a scaled drawing of the portion of the public highway subject to the institutional control that depicts the area impacted by regulated substances and the location of utilities in the impacted area, including storm water systems and municipal separate storm water systems. At a minimum, the scaled drawing should include: a. A north arrow. b. A graphical scale bar and scale statement (e.g. 1"=50'). c. The limits of the source property plotted, to scale, showing the relationship to the county road commission or local unit of government and other affected parcels. d. The public highway(s) name identified. e. A statement identifying the Township, Range, Section, and Quarter Section where the parcel is located. f. The limits of the affected public highway plotted to scale. This area should be hatched and labeled appropriately. g. The location of significant site features such as buildings, drives, parking lots, and road surface. h. Cross section illustrating affected public highway, media, utilities, and location and depth of contaminated media. i. Most recent analytical data illustrating contaminant compounds and concentrations within the contaminated media.	

6. Provide a complete list that identifies all parties with ownership and possessory or use property interests related to the public highway (including owners of real property, easement holders, utility franchise holders, and owners or operators of public utilities):

City of Detroit Department of Public Works, DTE Energy, Great Lakes Water Authority, MDOT

a. Are any of the parties listed above affected by the contamination: YES NO

b. Have all of the parties above affected by the contamination received notification of the existing conditions as part of a corrective action plan or pursuant to the due care requirements: YES NO

7. Exposure risks:

a. Due to groundwater contamination (Check all that apply):

Drinking water Indoor air inhalation Surface water

b. Due to soil contamination (Check all that apply):

Direct contact Ambient air Inhalation Indoor air inhalation Leaching from soil to groundwater

Direct transport to surface water Soil excavation/relocation

Based on the exposure risks identified above, insert a paragraph below which describes the affected media, the nature and extent of the hazardous substances, the cleanup criteria exceeded, the routes of potential exposure, any response activities or corrective actions that have been taken to address the contamination, and any activities that could result in exposure to hazardous substances that would cause this institutional control to not be protective of public health, safety, and welfare (e.g. use of the groundwater for consumption, irrigation, or any other use, management and disposal of groundwater for dewatering for construction purposes; any excavation or intrusive activity that would result in contaminated soils to be placed at the ground surface or otherwise exacerbate the extent of contamination).

Soil contamination was documented to be present in the Schaefer Highway right-of-way (ROW), resulting from confirmed releases of gasoline and diesel fuel, from underground storage tank (UST) systems, that occurred in December 2014 (C-0003-15). Groundwater was not encountered in the soil borings advanced within the Schaefer Highway ROW to a maximum depth of 20' below the ground surface (bgs). Risks due to the soil contamination includes direct contact, indoor air inhalation, and soil excavation/relocation. There are no structures present in the affected Schaefer Highway ROW. Based on detections of gasoline range organics (GRO) in soil samples collected from locations near the ROW, residual non-aqueous phase liquid (NAPL) is present. Any soil excavation deeper than 0.5 feet bgs may encounter contaminated soils. Any contaminated soil encountered should be handled and disposed of properly. Workers should be notified about the potential to encounter contaminated soils and risks associated with inhalation and skin contact with the contaminants.

SECTION 3. STORM SEWER SYSTEM CERTIFICATION:

Is contamination present in or does the contamination have the potential to enter the storm sewer system (including separate storm sewer systems and combined sewers) as a result of the release from the underground storage tank system:

YES NO

If yes, please provide information below and attach any drawings, tables, etc. that clearly identifies the nature and extent of the contamination that enters or has the potential to enter the storm sewer system.

SECTION 4. SUBMITTER INFORMATION:

I, as the submitter identified in Section 1, or the qualified consultant authorized to complete this document on the submitter's behalf, hereby attest to the accuracy of the statements in this document and all attachments, and have provided this document to the county road commission or local unit of government.

Signature	Print	Date
	Leslie DeBoer, EP	
Name of Company (if applicable)	Address, City, State, Zip	
BLDI, Inc.	150 Fountain St NE, Grand Rapids, MI 49503	
Phone Number	Fax Number	Email Address
616-459-3737	616-459-5357	ldeboer@bldi.com

SECTION 5. COUNTY ROAD COMMISSION OR LOCAL UNIT OF GOVERNMENT CONFIRMATION:		
Name of county road commission or local unit of government: City of Detroit Department of Public Works		
The aforementioned City of Detroit Department of Public Works hereby confirms that there are no current plans to relocate, vacate, or abandon the public highway. With my signature below, I certify that I am legally authorized to sign on behalf of the City of Detroit Department of Public Works .		
Signature of Authorized Official	Print Authorized Official	
Title of Authorized Official	Date	
Name of county road commission or local unit of government	Address, City, State, Zip	
Phone Number	Fax Number	Email Address

LEGEND

- ⊕ MONITORING WELL LOCATION
- ⊕ SOIL BORING LOCATION
- SOIL GAS VAPOR PIN
- SOIL GAS MONITORING WELL
- ⊕ SOIL VAPOR EXTRACTION WELL
- ⊖ VACUUM MONITORING LOCATION
- DISPENSER ISLAND
- ⊕ FIRE HYDRANT
- CATCH BASIN
- UTILITY POLE
- ⊙ LIGHT POLE
- ⊠ TRANSFORMER
- M UTILITY MANHOLE
- BROKEN ASPHALT
- CURRENT UST
- ⋮ VENT LINES
- UNDERGROUND COMBINED SEWER
- UNDERGROUND WATER LINE
- UNDERGROUND GAS LINE
- UNDERGROUND ELECTRIC
- UNDERGROUND FIBEROPTIC/CABLE
- OVERHEAD UTILITIES
- PLAT LINES
- RIGHT OF WAY
- PROPERTY BOUNDARIES

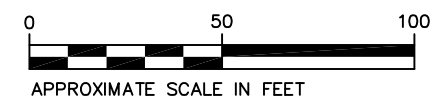
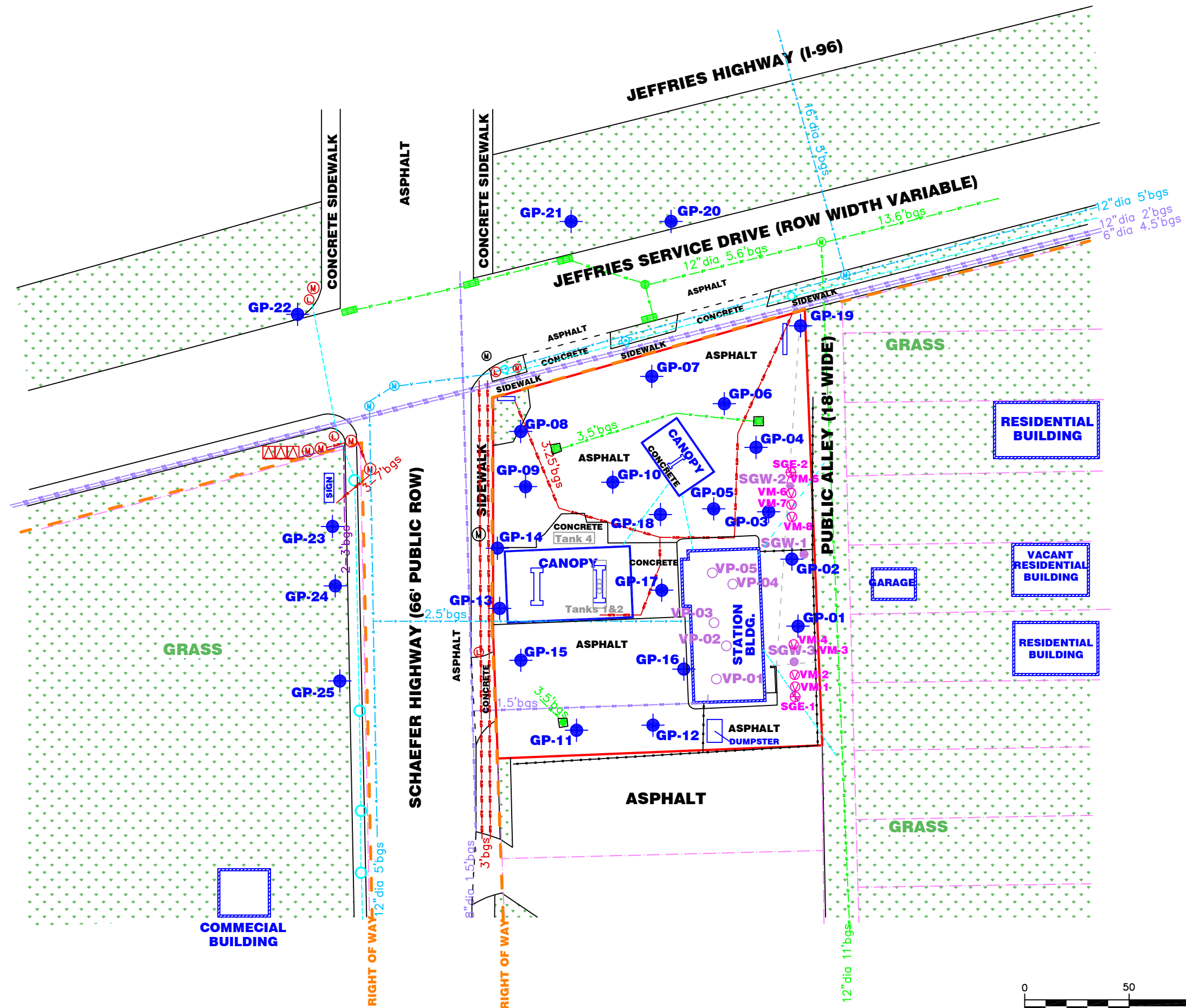

VS/SJ/AP

FIGURE 1
SITE LAYOUT MAP

Knight Station K-330
12750 Schaefer Highway
Detroit, Michigan

December 2022

154018.330

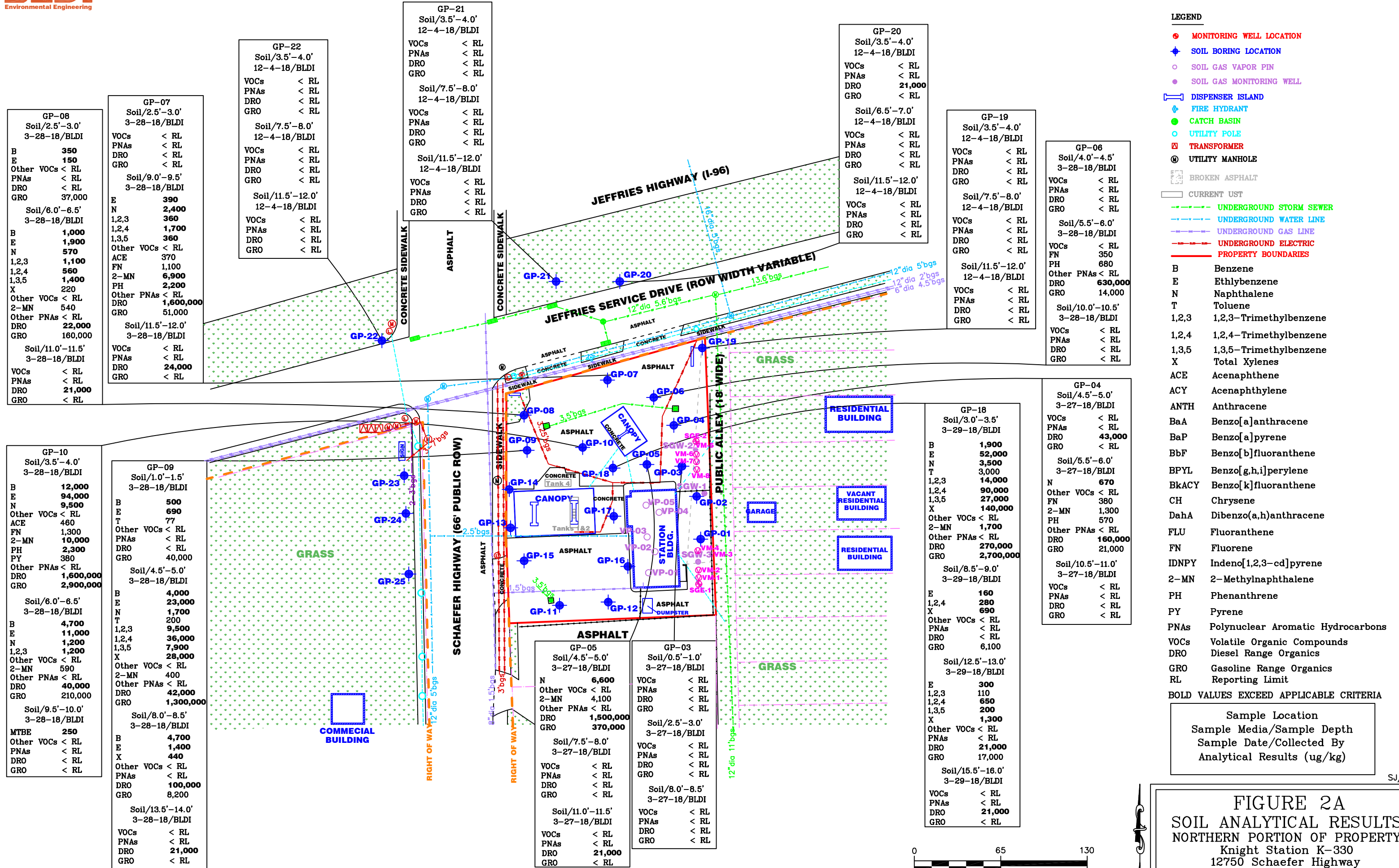

Sample Location
Sample Media/Sample Depth
Sample Date/Collected By
Analytical Results (ug/kg)

FIGURE 2A
SOIL ANALYTICAL RESULTS
NORTHERN PORTION OF PROPERTY
Knight Station K-330
12750 Schaefer Highway
Detroit, Michigan

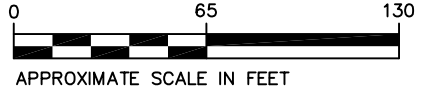

- LEGEND**
- MONITORING WELL LOCATION
 - ◆ SOIL BORING LOCATION
 - SOIL GAS VAPOR PIN
 - SOIL GAS MONITORING WELL
 - ▭ DISPENSER ISLAND
 - ◆ FIRE HYDRANT
 - CATCH BASIN
 - UTILITY POLE
 - ⊠ TRANSFORMER
 - ⊙ UTILITY MANHOLE
 - ⊞ BROKEN ASPHALT
 - ▭ CURRENT UST
 - UNDERGROUND STORM SEWER
 - UNDERGROUND WATER LINE
 - UNDERGROUND GAS LINE
 - UNDERGROUND ELECTRIC
 - PROPERTY BOUNDARIES

- B Benzene
- E Ethylbenzene
- N Naphthalene
- T Toluene
- 1,2,3 1,2,3-Trimethylbenzene
- 1,2,4 1,2,4-Trimethylbenzene
- 1,3,5 1,3,5-Trimethylbenzene
- X Total Xylenes
- ACE Acenaphthene
- ACY Acenaphthylene
- ANTH Anthracene
- BaA Benzo[a]anthracene
- BaP Benzo[a]pyrene
- BbF Benzo[b]fluoranthene
- BPYL Benzo[g,h,i]perylene
- BkACY Benzo[k]fluoranthene
- CH Chrysene
- DahA Dibenzo(a,h)anthracene
- FLU Fluoranthene
- FN Fluorene
- IDNPY Indeno[1,2,3-cd]pyrene
- 2-MN 2-Methylnaphthalene
- PH Phenanthrene
- PY Pyrene
- PNAs Polynuclear Aromatic Hydrocarbons
- VOCs Volatile Organic Compounds
- DRO Diesel Range Organics
- GRO Gasoline Range Organics
- RL Reporting Limit

BOLD VALUES EXCEED APPLICABLE CRITERIA

Sample Location	
Sample Media/Sample Depth	
Sample Date/Collected By	
Analytical Results (ug/kg)	

GP-14	
Soil/0.5'-1.0'	
3-29-18/BLDI	
B	170
1,3,5	100
Other VOCs	< RL
PNAs	< RL
DRO	< RL
GRO	15,000
Soil/4.5'-5.0'	
3-29-18/BLDI	
B	10,000
E	75,000
N	18,000
T	480,000
1,2,3	33,000
1,2,4	190,000
1,3,5	58,000
X	480,000
Other VOCs	< RL
2-MN	23,000
Other PNAs	< RL
DRO	660,000
GRO	490,000
Soil/8.5'-9.0'	
3-29-18/BLDI	
B	11,000
E	290
T	1,700
Other VOCs	< RL
PNAs	< RL
DRO	< RL
GRO	16,000
Soil/14.0'-14.5'	
3-29-18/BLDI	
E	150
T	840
1,2,4	430
1,3,5	130
X	890
Other VOCs	< RL
PNAs	< RL
DRO	21,000
GRO	9,000
Soil/16.5'-17.0'	
3-29-18/BLDI	
VOCs	< RL
PNAs	< RL
DRO	< RL
GRO	< RL

GP-23	
Soil/3.0'-3.5'	
12-4-18/BLDI	
VOCs	< RL
PNAs	< RL
DRO	< RL
GRO	< RL
Soil/7.5'-8.0'	
12-4-18/BLDI	
VOCs	< RL
PNAs	< RL
DRO	< RL
GRO	< RL
Soil/11.5'-12.0'	
12-4-18/BLDI	
VOCs	< RL
PNAs	< RL
DRO	< RL
GRO	< RL

GP-24	
Soil/3.0'-3.5'	
12-4-18/BLDI	
VOCs	< RL
PNAs	< RL
DRO	< RL
GRO	< RL
Soil/7.5'-8.0'	
12-4-18/BLDI	
VOCs	< RL
PNAs	< RL
DRO	< RL
GRO	< RL
Soil/11.5'-12.0'	
12-4-18/BLDI	
VOCs	< RL
PNAs	< RL
DRO	< RL
GRO	< RL

GP-25	
Soil/0.5'-1.0'	
12-4-18/BLDI	
VOCs	< RL
BbF	340
FLU	500
PH	340
PY	380
Other PNAs	< RL
DRO	< RL
GRO	6,000
Soil/5.5'-6.0'	
12-4-18/BLDI	
VOCs	< RL
PNAs	< RL
DRO	< RL
GRO	< RL
Soil/11.5'-12.0'	
12-4-18/BLDI	
VOCs	< RL
PNAs	< RL
DRO	< RL
GRO	< RL

GP-15	
Soil/2.0'-2.5'	
3-29-18/BLDI	
VOCs	< RL
PNAs	< RL
DRO	< RL
GRO	< RL
Soil/7.5'-8.0'	
3-29-18/BLDI	
VOCs	< RL
PNAs	< RL
DRO	< RL
GRO	< RL
Soil/11.5'-12.0'	
3-29-18/BLDI	
VOCs	< RL
PNAs	< RL
DRO	< RL
GRO	< RL

GP-11	
Soil/1.0'-1.5'	
3-28-18/BLDI	
VOCs	< RL
PNAs	< RL
DRO	24,000
GRO	9,800
Soil/5.0'-5.5'	
3-28-18/BLDI	
VOCs	< RL
PNAs	< RL
DRO	21,000
GRO	43,000
Soil/10.0'-10.5'	
3-28-18/BLDI	
VOCs	< RL
PNAs	< RL
DRO	< RL
GRO	< RL

GP-12	
Soil/3.0'-3.5'	
3-28-18/BLDI	
VOCs	< RL
PNAs	< RL
DRO	< RL
GRO	< RL
Soil/7.5'-8.0'	
3-28-18/BLDI	
VOCs	< RL
PNAs	< RL
DRO	< RL
GRO	< RL
Soil/11.5'-12.0'	
3-28-18/BLDI	
VOCs	< RL
PNAs	< RL
DRO	< RL
GRO	< RL

GP-16	
Soil/3.0'-3.5'	
3-29-18/BLDI	
VOCs	< RL
PNAs	< RL
DRO	< RL
GRO	< RL
Soil/7.0'-7.5'	
3-29-18/BLDI	
VOCs	< RL
PNAs	< RL
DRO	< RL
GRO	< RL
Soil/9.0'-9.5'	
3-29-18/BLDI	
VOCs	< RL
PNAs	< RL
DRO	< RL
GRO	< RL

GP-17	
Soil/2.5'-3.0'	
3-29-18/BLDI	
B	660
E	25,000
N	2,400
Other VOCs	< RL
2-MN	1,900
Other PNAs	< RL
DRO	100,000
GRO	6,000,000
Soil/5.0'-5.5'	
3-29-18/BLDI	
B	400
E	8,700
N	770
1,2,3	1,100
1,2,4	10,000
1,3,5	1,800
X	7,500
Other VOCs	< RL
PNAs	< RL
DRO	29,000
GRO	210,000
Soil/9.5'-10.0'	
3-29-18/BLDI	
VOCs	< RL
PNAs	< RL
DRO	< RL
GRO	< RL

GP-02	
Soil/3.0'-3.5'	
3-27-18/BLDI	
VOCs	< RL
PNAs	< RL
DRO	< RL
GRO	< RL
Soil/7.5'-8.0'	
3-27-18/BLDI	
VOCs	< RL
PNAs	< RL
DRO	< RL
GRO	< RL
Soil/11.5'-12.0'	
3-27-18/BLDI	
VOCs	< RL
PNAs	< RL
DRO	< RL
GRO	< RL

GP-13	
Soil/1.0'-1.5'	
3-29-18/BLDI	
B	220
Other VOCs	< RL
PNAs	< RL
DRO	< RL
GRO	14,000
Soil/3.5'-4.0'	
3-29-18/BLDI	
B	1,400
E	3,300
N	1,500
T	73
1,2,3	500
X	490
Other VOCs	< RL
2-MN	1,100
Other PNAs	< RL
DRO	34,000
GRO	120,000
Soil/7.5'-8.0'	
3-29-18/BLDI	
VOCs	< RL
PNAs	< RL
DRO	< RL
GRO	< RL

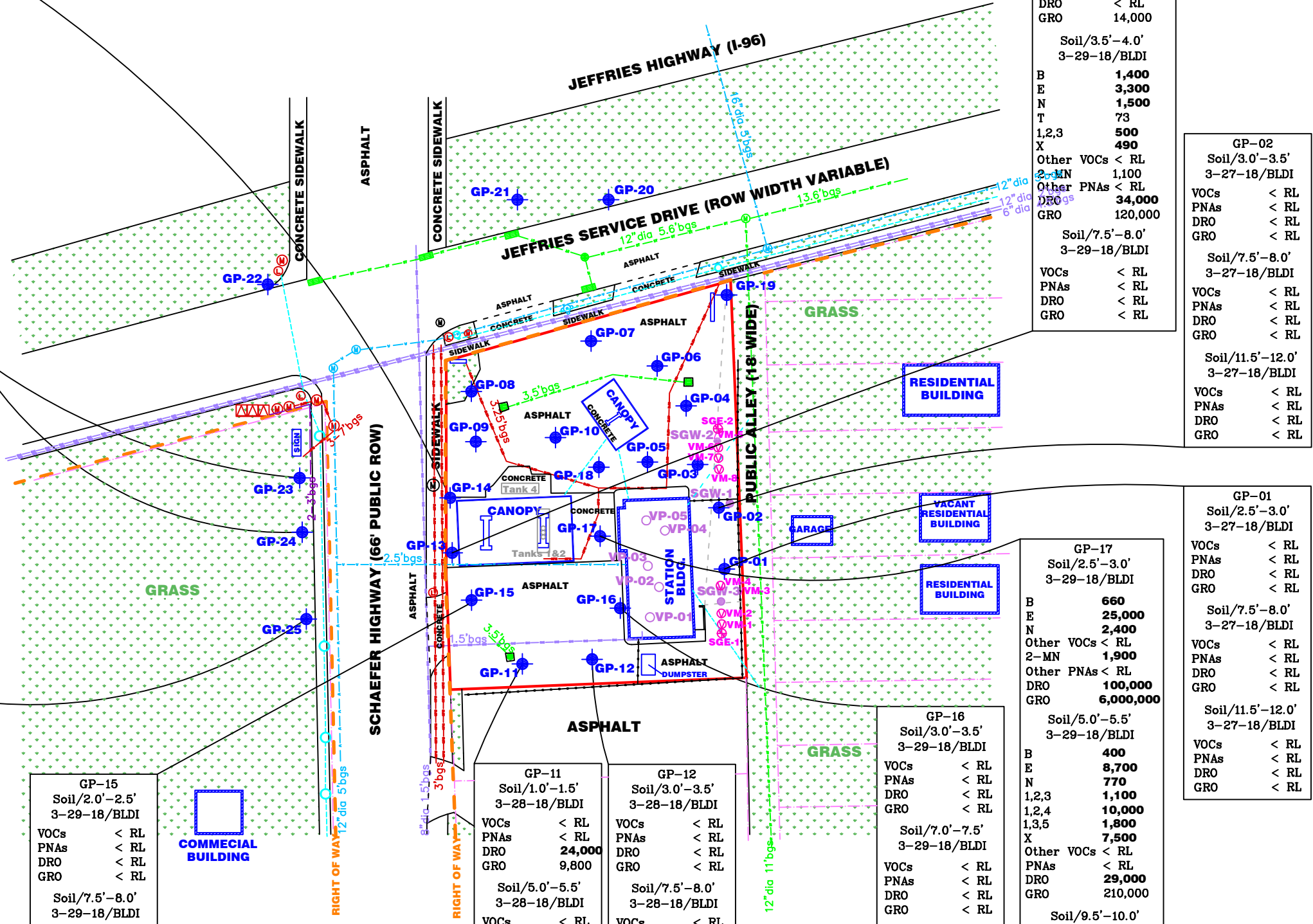
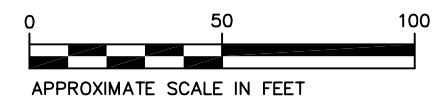
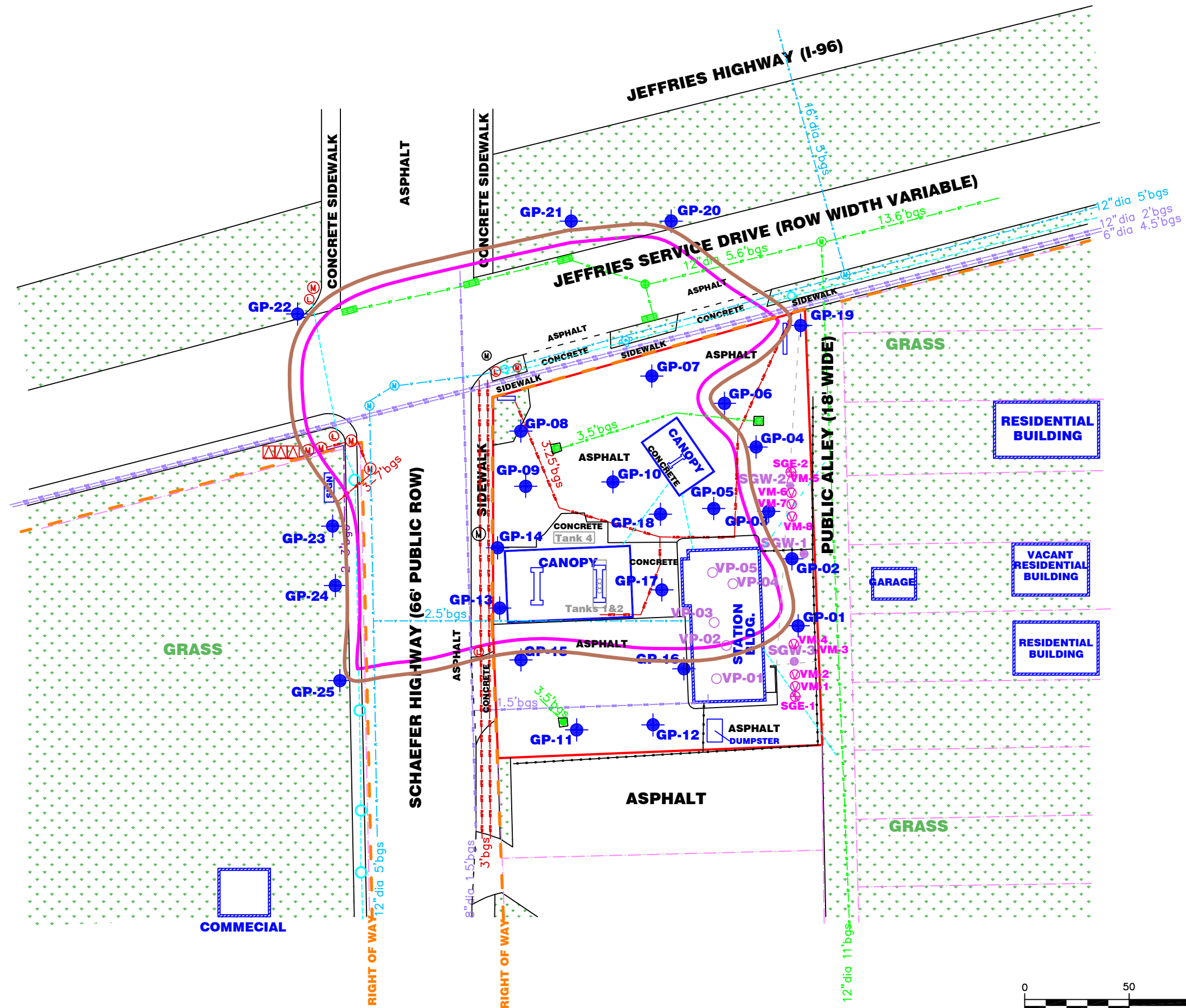

FIGURE 3B
SOIL ANALYTICAL RESULTS
SOUTHERN PORTION OF PROPERTY
Knight Station K-330
12750 Schaefer Highway
Detroit, Michigan

December 2022 154018.330

LEGEND

- ⊕ MONITORING WELL LOCATION
- ⊕ SOIL BORING LOCATION
- SOIL GAS VAPOR PIN
- SOIL GAS MONITORING WELL
- DISPENSER ISLAND
- ⊕ FIRE HYDRANT
- ⊕ CATCH BASIN
- UTILITY POLE
- ⊕ TRANSFORMER
- Ⓜ UTILITY MANHOLE
- BROKEN ASPHALT
- CURRENT UST
- UNDERGROUND STORM SEWER
- UNDERGROUND WATER LINE
- UNDERGROUND GAS LINE
- UNDERGROUND ELECTRIC
- PROPERTY BOUNDARIES
- ESTIMATED LATERAL EXTENT OF SOIL CONTAMINATION
- ESTIMATED LATERAL EXTENT OF RESIDUAL LNAPL



SJ/AP

FIGURE 2C
ESTIMATED LATERAL EXTENT
OF SOIL CONTAMINATION
Knight Station K-330
12750 Schaefer Highway
Detroit, Michigan

December 2022154018.330

Cross-Section B-B'

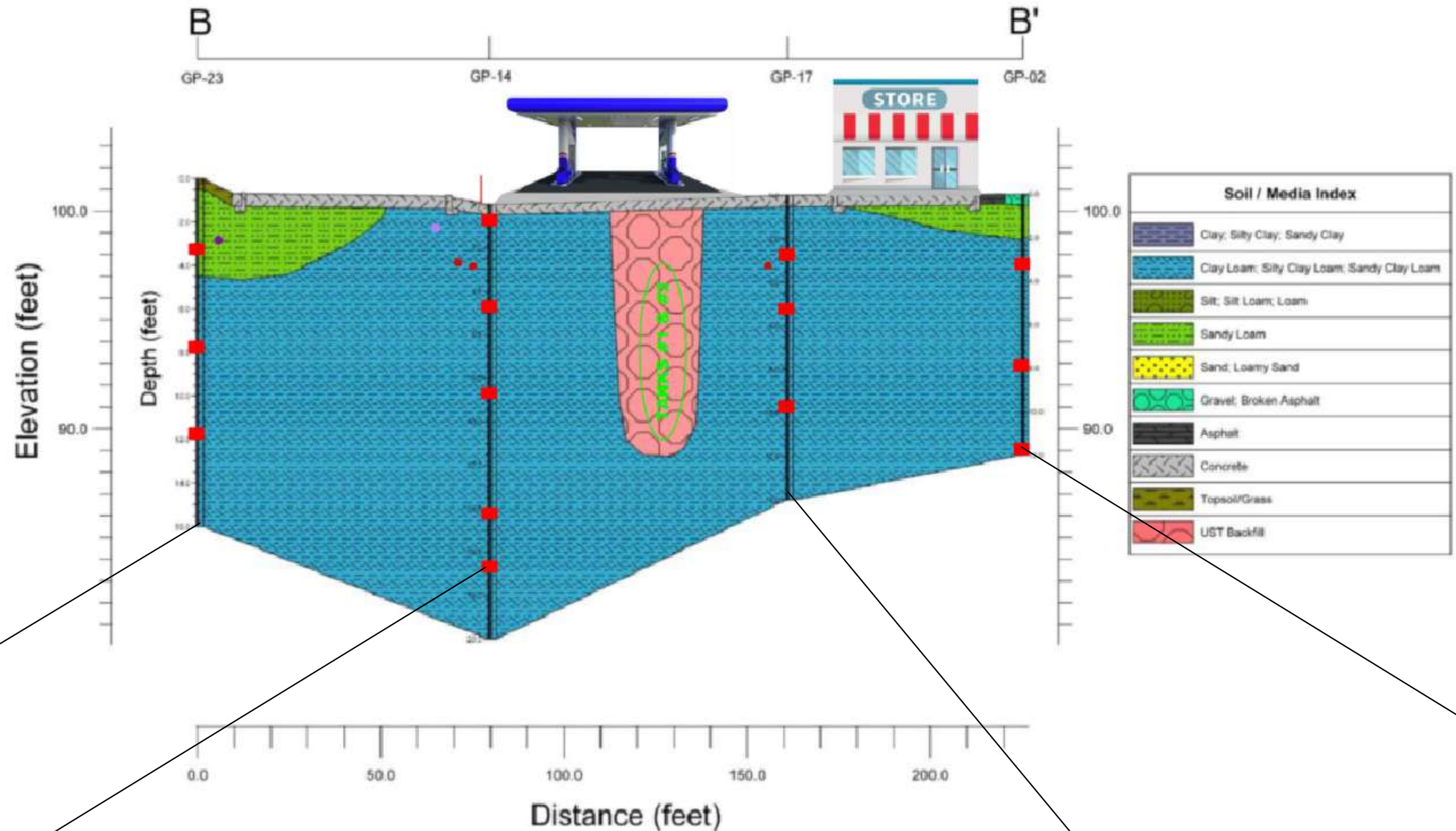

LEGEND

- SOIL SAMPLE INTERVAL
- ▼ WATER TABLE
- ▤ SCREENED INTERVAL
- UST
- UNDERGROUND GAS LINE
- UNDERGROUND SEWER LINE
- UNDERGROUND WATER LINE
- UNDERGROUND ELECTRIC LINE

- B Benzene
- E Ethylbenzene
- N Naphthalene
- T Toluene
- 1,2,3 1,2,3-Trimethylbenzene
- 1,2,4 1,2,4-Trimethylbenzene
- 1,3,5 1,3,5-Trimethylbenzene
- X Total Xylenes
- ACE Acenaphthene
- ACY Acenaphthylene
- ANTH Anthracene
- BaA Benzo[a]anthracene
- BaP Benzo[a]pyrene
- BbF Benzo[b]fluoranthene
- BPYL Benzo[g,h,i]perylene
- BkACY Benzo[k]fluoranthene
- CH Chrysene
- DahA Dibenzo(a,h)anthracene
- FLU Fluoranthene
- FN Fluorene
- IDNPY Indeno[1,2,3-cd]pyrene
- 2-MN 2-Methylnaphthalene
- PH Phenanthrene
- PY Pyrene
- PNAs Polynuclear Aromatic Hydrocarbons
- VOCs Volatile Organic Compounds
- DRO Diesel Range Organics
- GRO Gasoline Range Organics
- RL Reporting Limit

GP-23
Soil/3.0'-3.5'
12-4-18/BLDI

VOCs < RL
PNAs < RL
DRO < RL
GRO < RL

Soil/7.5'-8.0'
12-4-18/BLDI

VOCs < RL
PNAs < RL
DRO < RL
GRO < RL

Soil/11.5'-12.0'
12-4-18/BLDI

VOCs < RL
PNAs < RL
DRO < RL
GRO < RL

GP-14
Soil/0.5'-1.0'
3-29-18/BLDI

B **170**
1,3,5 100
Other VOCs < RL
PNAs < RL
DRO < RL
GRO 15,000

Soil/4.5'-5.0'
3-29-18/BLDI

B **10,000**
E **75,000**
N **18,000**
T **480,000**
1,2,3 **33,000**
1,2,4 **190,000**
1,3,5 **58,000**
X **480,000**
Other VOCs < RL
2-MN **23,000**
Other PNAs < RL
DRO **660,000**
GRO **490,000**

Soil/8.5'-9.0'
3-29-18/BLDI

B **11,000**
E **290**
T 1,700
Other VOCs < RL
PNAs < RL
DRO < RL
GRO 16,000

Soil/14.0'-14.5'
3-29-18/BLDI

E **150**
T 840
1,2,4 **430**
1,3,5 **130**
X **890**
Other VOCs < RL
PNAs < RL
DRO **21,000**
GRO 9,000

Soil/16.5'-17.0'
3-29-18/BLDI

VOCs < RL
PNAs < RL
DRO < RL
GRO < RL

GP-17
Soil/2.5'-3.0'
3-29-18/BLDI

B **660**
E **25,000**
N **2,400**
Other VOCs < RL
2-MN **1,900**
Other PNAs < RL
DRO **100,000**
GRO **6,000,000**

Soil/5.0'-5.5'
3-29-18/BLDI

B **400**
E **8,700**
N **770**
1,2,3 **1,100**
1,3,5 **1,800**
X **7,500**
Other VOCs < RL
PNAs < RL
DRO **29,000**
GRO 210,000

Soil/9.5'-10.0'
3-29-18/BLDI

VOCs < RL
PNAs < RL
DRO < RL
GRO < RL

BOLD VALUES EXCEED APPLICABLE CRITERIA

Sample Location
Sample Media/Sample Depth
Sample Date/Collected By
Analytical Results (ug/kg or ug/L)

FIGURE 3B
CROSS SECTION B-B'
Knight Station K-330
12570 Schaefer Highway
Detroit, Michigan
December 2022 154018.330

LEGEND

- ⊕ MONITORING WELL LOCATION
- ⊕ SOIL BORING LOCATION
- SOIL GAS VAPOR PIN
- SOIL GAS MONITORING WELL
- DISPENSER ISLAND
- ⊕ FIRE HYDRANT
- ⊕ CATCH BASIN
- UTILITY POLE
- ⊕ TRANSFORMER
- Ⓜ UTILITY MANHOLE
- BROKEN ASPHALT
- UNDERGROUND STORM SEWER
- UNDERGROUND WATER LINE
- UNDERGROUND GAS LINE
- UNDERGROUND ELECTRIC
- PROPERTY BOUNDARIES
- AREA SUBJECT TO PUBLIC HIGHWAY INSTITUTIONAL CONTROLS (PHIC)
- AREA SUBJECT TO ENVIRONMENTAL LICENSE AGREEMENT (ELA)

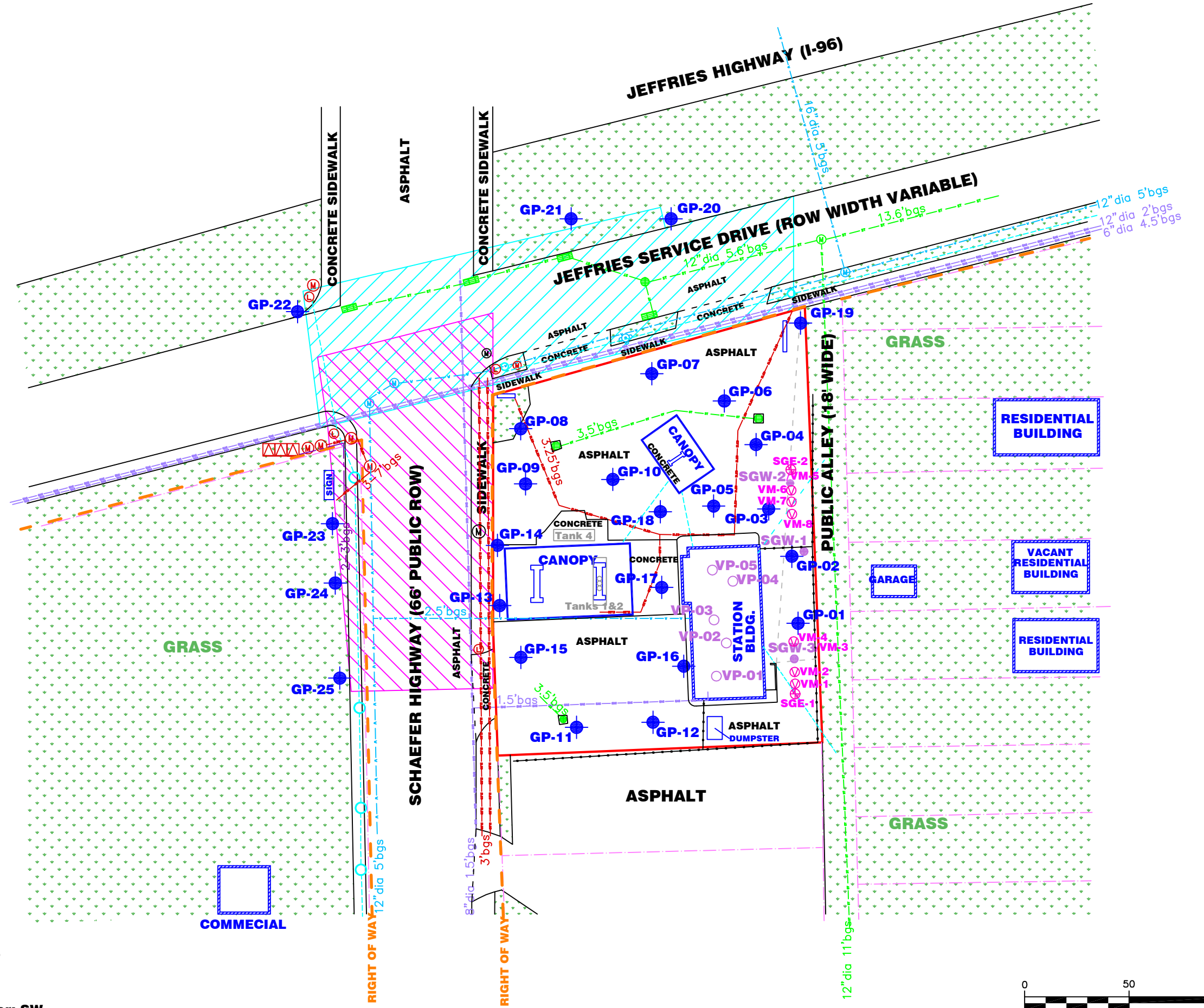

VS/SJ/AP

FIGURE 4
AREAS SUBJECT TO
INSTITUTIONAL CONTROLS

Knight Station K-330
12750 Schaefer Highway
Detroit, Michigan

December 2022

154018.330

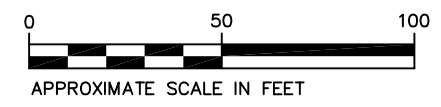

Township: 01S
Range: 11E
Section 29
Quarter: NW
Quarter-Quarter: SW
NOT A LEGAL SURVEY