

NOTE: Elevations on this sheet refer to High Water July Datum

REVISIONS	BOARD OF WAYNE COUNTY ROAD COMMISSIONERS
1. Initial Plan	DETROIT MICHIGAN
2. As per Notes	Wm. F. BUTLER
3. As per Notes	EDWARD M. HILLIS
4. As per Notes	Wm. S. HANBERTY
5. As per Notes	
6. As per Notes	
7. As per Notes	
8. As per Notes	
9. As per Notes	
10. As per Notes	
11. As per Notes	
12. As per Notes	
13. As per Notes	
14. As per Notes	
15. As per Notes	
16. As per Notes	
17. As per Notes	
18. As per Notes	
19. As per Notes	
20. As per Notes	
21. As per Notes	
22. As per Notes	
23. As per Notes	
24. As per Notes	
25. As per Notes	
26. As per Notes	
27. As per Notes	
28. As per Notes	
29. As per Notes	
30. As per Notes	
31. As per Notes	
32. As per Notes	
33. As per Notes	
34. As per Notes	
35. As per Notes	
36. As per Notes	
37. As per Notes	
38. As per Notes	
39. As per Notes	
40. As per Notes	
41. As per Notes	
42. As per Notes	
43. As per Notes	
44. As per Notes	
45. As per Notes	
46. As per Notes	
47. As per Notes	
48. As per Notes	
49. As per Notes	
50. As per Notes	
51. As per Notes	
52. As per Notes	
53. As per Notes	
54. As per Notes	
55. As per Notes	
56. As per Notes	
57. As per Notes	
58. As per Notes	
59. As per Notes	
60. As per Notes	
61. As per Notes	
62. As per Notes	
63. As per Notes	
64. As per Notes	
65. As per Notes	
66. As per Notes	
67. As per Notes	
68. As per Notes	
69. As per Notes	
70. As per Notes	
71. As per Notes	
72. As per Notes	
73. As per Notes	
74. As per Notes	
75. As per Notes	
76. As per Notes	
77. As per Notes	
78. As per Notes	
79. As per Notes	
80. As per Notes	
81. As per Notes	
82. As per Notes	
83. As per Notes	
84. As per Notes	
85. As per Notes	
86. As per Notes	
87. As per Notes	
88. As per Notes	
89. As per Notes	
90. As per Notes	
91. As per Notes	
92. As per Notes	
93. As per Notes	
94. As per Notes	
95. As per Notes	
96. As per Notes	
97. As per Notes	
98. As per Notes	
99. As per Notes	
100. As per Notes	

LEGEND

- ⊕ Detroit Edison Co. Pole
- ⊙ Mich. Bell Telephone Co. Pole
- ⊙ Telegraph Pole
- ⊙ Hydrant
- ⊙ Manhole
- ⊙ Valve
- ⊙ Future Valve
- ⊙ Future Pole

NOTES -
 That all construction or all utilities shall be subject to the approval of the Engineer.
 This plan shall be subject to all conditions, including location of poles, hydrants and manholes, which may be required by the City of Detroit, Michigan, and shall be subject to all conditions of the City of Detroit, Michigan, and shall be subject to all conditions of the City of Detroit, Michigan.

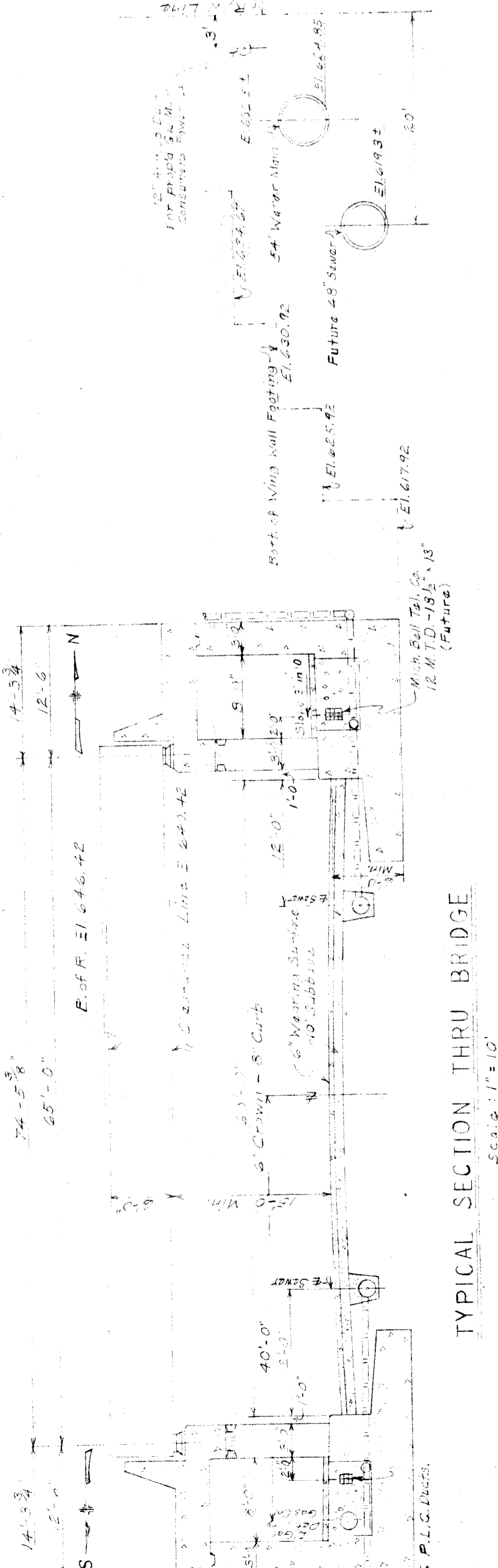

TYPICAL SECTION THRU BRIDGE
 Scale: 1/2" = 1'-0"

UTILITIES PRIOR TO GRADE SEPARATION

UTILITIES SUBSEQUENT TO GRADE SEPARATION

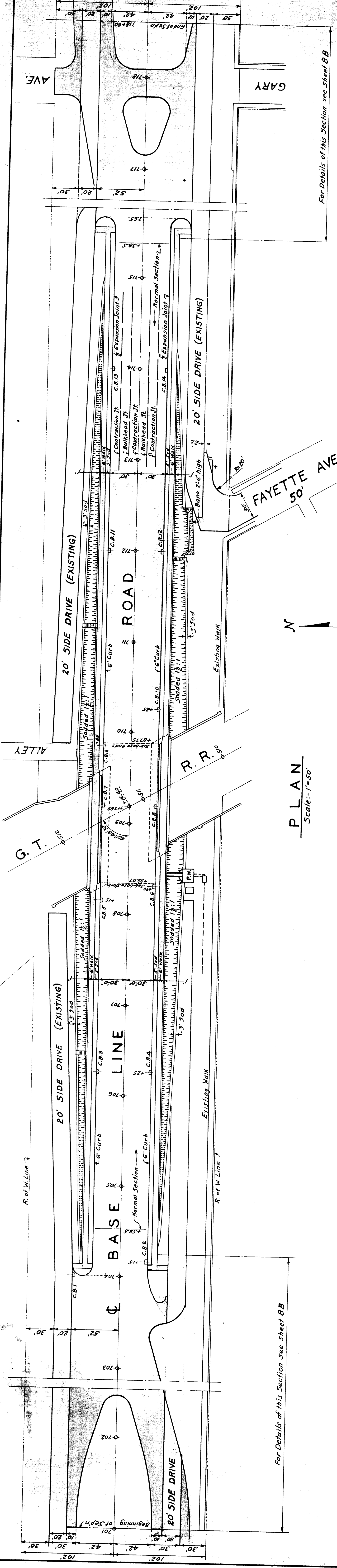

PLAN
Scale: 1" = 50'

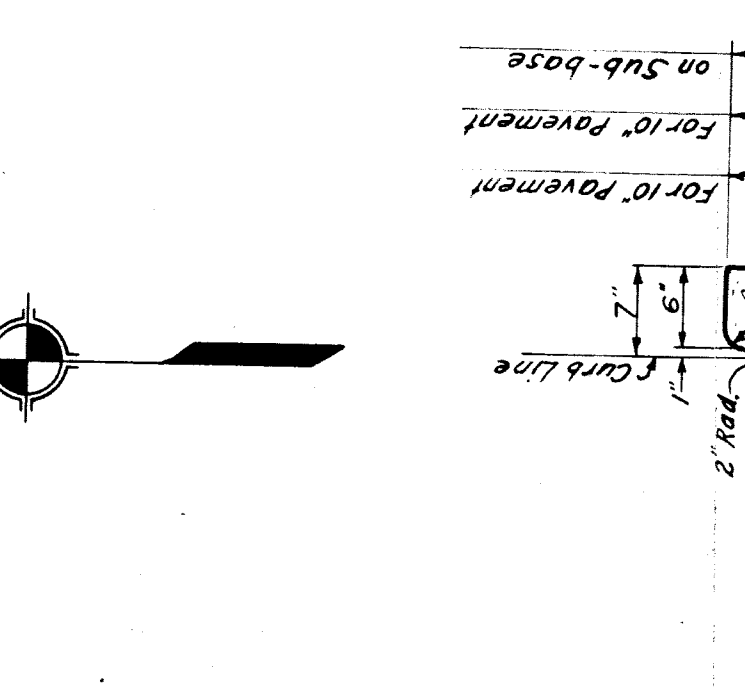

CURB DETAIL
Scale: 1" = 1'-0"

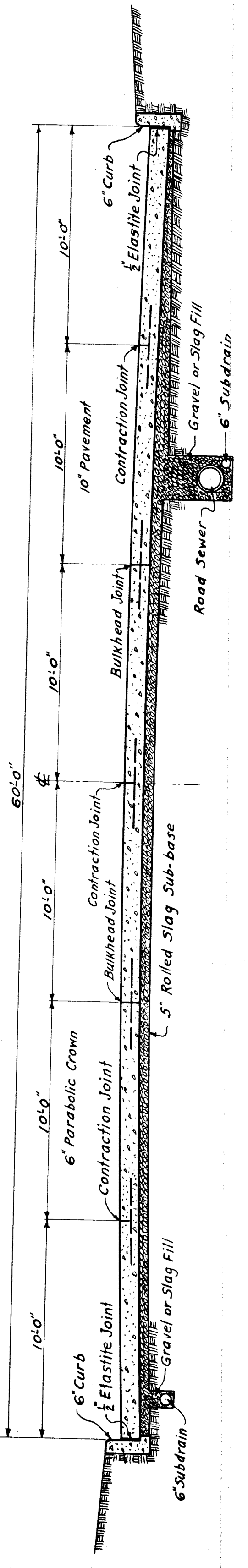

TYPICAL SECTION ON APPROACHES
Scale: 1" = 1'-0"

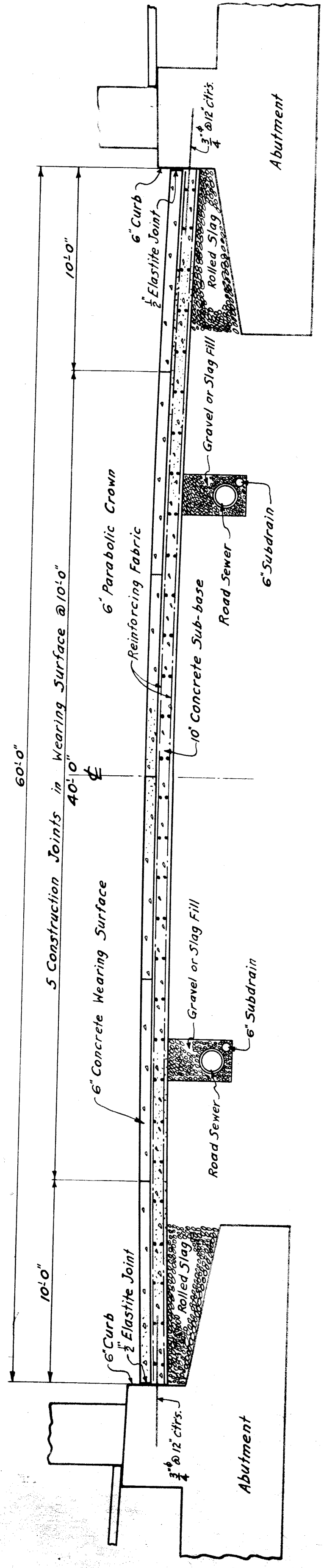

TYPICAL SECTION UNDER BRIDGE
Scale: 1" = 1'-0"

QUANTITIES

10" Concrete Paving	12,425 Sq. Yds.
10" Concrete Sub-base	1031 Sq. Yds.
6" Concrete Wearing Surface	1031 Sq. Yds.
Sidewalks	15,240 Sq. Ft.
Curbing	2,950 Lin. Ft.
Sodding	4,100 Sq. Yds.
Rolled Slag under Pavement	766 Cu. Yds.
Gravel or Slag under Walks	210 Cu. Yds.
Reinforcing Fabric	11,700 Lbs.
Reinforcing Steel	13,450 Lbs.

NOTES

Reinforcing shall be placed as shown in top and bottom of concrete sub-base and shall conform to the Board of Wayne County Road Commissioners' Specifications (as amended March 1930) for Reinforcing Fabric. Minimum weight of Fabric shall be 5 1/2 lbs. per sq. yd. of fabric per layer.

Pavements other than concrete sub-base shall not be reinforced.

Rolled slag sub-bases 5" thick under all pavement and gravel or slag 3" thick under all sidewalks shall be placed from Sta. 205+00 to Sta. 219+50 except under concrete sub-base thru the concrete sub-base.

Sidewalks shall be placed under pavement. Rolled slag backfill shall be placed over abutment and pier footings where they shall be under pavement. Show top of other locations so as to make the distance between joints above the pavement at least 50' across the entire width of road (not staggered) in the pavement.

Construction joints in curbs shall be placed at 12 foot intervals. An elastic joint in curbs shall be placed where sidewalks and curbs meet.

Contours shall be placed where sidewalks and curbs meet.

Gravel fill shall be composed of 40 parts of sand to 60 parts of pebbles.

Elevations are based on Michigan State Highway Datum.

B.M. #74 - E.L. 636.09 - Spike in 30' Elm. 37' R. of Sta. 725+40

B.M. #1 - (G.T.R.R.) Bronze Top in concrete Mon. Sta. 501+60 - (G.T.R.R. E.L. 637.19)

B.M. #8 - E.L. 637.87 - R.R. Spike in 40' Maple, 365' of Sta. 712+55

Where gravel backfill is called for in sewer trenches, slag or sand may be substituted, except over sub-drains with open joints, where sand will be used.

For Profiles see sheet #1.

For Details of Approaches see sheet BB.

The longitudinal joint is to be formed immediately following the finishing machine and shall not be formed by hand. The groove is to be filled with a joint filler. The joint filler shall be placed and completely fill and seal the joint without overflowing the pavement.

4" x 4" Dowel bars placed to a height of 1/2" of the 1/2" in the pavement and spaced at 30" intervals. A dowel bar "Chair" at each end of the bar as shown.

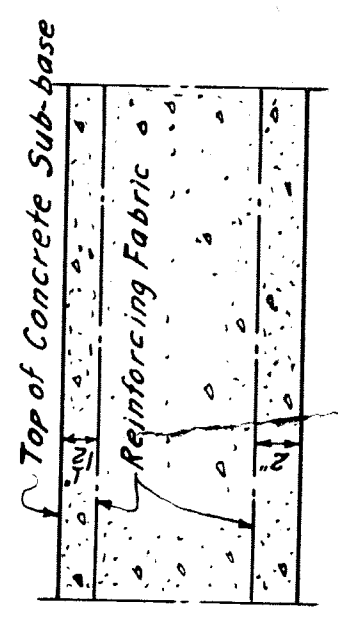

DETAIL OF CONTRACTION JOINT
Scale: 1" = 1'-0"

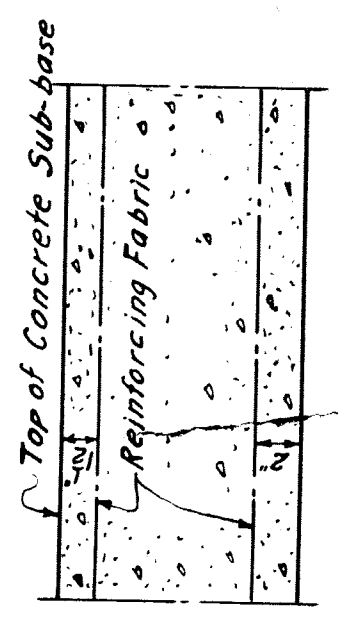

DETAIL SHOWING REINFORCING FABRIC
Scale: 1" = 1'-0"

REVISIONS	BOARD OF WAYNE COUNTY ROAD COMMISSIONERS
1. J.M.C. 5-23-31	EDWARD N. HINES, COMMISSIONER
2. J.M.C. 5-23-31	JOHN S. HAGGERTY, COMMISSIONER
3. J.M.C. 5-23-31	WILLIAM F. BUTLER, COMMISSIONER
4. J.M.C. 5-23-31	
5. J.M.C. 5-23-31	
6. J.M.C. 5-23-31	
7. J.M.C. 5-23-31	
8. J.M.C. 5-23-31	
9. J.M.C. 5-23-31	
10. J.M.C. 5-23-31	
11. J.M.C. 5-23-31	
12. J.M.C. 5-23-31	
13. J.M.C. 5-23-31	
14. J.M.C. 5-23-31	
15. J.M.C. 5-23-31	
16. J.M.C. 5-23-31	
17. J.M.C. 5-23-31	
18. J.M.C. 5-23-31	
19. J.M.C. 5-23-31	
20. J.M.C. 5-23-31	
21. J.M.C. 5-23-31	
22. J.M.C. 5-23-31	
23. J.M.C. 5-23-31	
24. J.M.C. 5-23-31	
25. J.M.C. 5-23-31	
26. J.M.C. 5-23-31	
27. J.M.C. 5-23-31	
28. J.M.C. 5-23-31	
29. J.M.C. 5-23-31	
30. J.M.C. 5-23-31	
31. J.M.C. 5-23-31	
32. J.M.C. 5-23-31	
33. J.M.C. 5-23-31	
34. J.M.C. 5-23-31	
35. J.M.C. 5-23-31	
36. J.M.C. 5-23-31	
37. J.M.C. 5-23-31	
38. J.M.C. 5-23-31	
39. J.M.C. 5-23-31	
40. J.M.C. 5-23-31	
41. J.M.C. 5-23-31	
42. J.M.C. 5-23-31	
43. J.M.C. 5-23-31	
44. J.M.C. 5-23-31	
45. J.M.C. 5-23-31	
46. J.M.C. 5-23-31	
47. J.M.C. 5-23-31	
48. J.M.C. 5-23-31	
49. J.M.C. 5-23-31	
50. J.M.C. 5-23-31	
51. J.M.C. 5-23-31	
52. J.M.C. 5-23-31	
53. J.M.C. 5-23-31	
54. J.M.C. 5-23-31	
55. J.M.C. 5-23-31	
56. J.M.C. 5-23-31	
57. J.M.C. 5-23-31	
58. J.M.C. 5-23-31	
59. J.M.C. 5-23-31	
60. J.M.C. 5-23-31	
61. J.M.C. 5-23-31	
62. J.M.C. 5-23-31	
63. J.M.C. 5-23-31	
64. J.M.C. 5-23-31	
65. J.M.C. 5-23-31	
66. J.M.C. 5-23-31	
67. J.M.C. 5-23-31	
68. J.M.C. 5-23-31	
69. J.M.C. 5-23-31	
70. J.M.C. 5-23-31	
71. J.M.C. 5-23-31	
72. J.M.C. 5-23-31	
73. J.M.C. 5-23-31	
74. J.M.C. 5-23-31	
75. J.M.C. 5-23-31	
76. J.M.C. 5-23-31	
77. J.M.C. 5-23-31	
78. J.M.C. 5-23-31	
79. J.M.C. 5-23-31	
80. J.M.C. 5-23-31	
81. J.M.C. 5-23-31	
82. J.M.C. 5-23-31	
83. J.M.C. 5-23-31	
84. J.M.C. 5-23-31	
85. J.M.C. 5-23-31	
86. J.M.C. 5-23-31	
87. J.M.C. 5-23-31	
88. J.M.C. 5-23-31	
89. J.M.C. 5-23-31	
90. J.M.C. 5-23-31	
91. J.M.C. 5-23-31	
92. J.M.C. 5-23-31	
93. J.M.C. 5-23-31	
94. J.M.C. 5-23-31	
95. J.M.C. 5-23-31	
96. J.M.C. 5-23-31	
97. J.M.C. 5-23-31	
98. J.M.C. 5-23-31	
99. J.M.C. 5-23-31	
100. J.M.C. 5-23-31	

WAYNE COUNTY ROAD COMMISSIONERS	PAVING PLAN
EDWARD N. HINES, COMMISSIONER	BASE LINE ROAD - MILE: 13.4
JOHN S. HAGGERTY, COMMISSIONER	G.T.R.R. GRADE SE P.M. X of 63-19-10 (Holly Subin)
WILLIAM F. BUTLER, COMMISSIONER	DESIGNED BY: TRACER P.L.C.
	DRAWN BY: G.J.P.
	CHECKED BY: J.M.C.
	DATE: 5-6-31
	SCALE: As Shown
	CONTRACT: F. B. ...
	APPROVED: ...
	REG. CIV. ENR.
	REG. CIV. ENR.
	SHEET NO. 8A

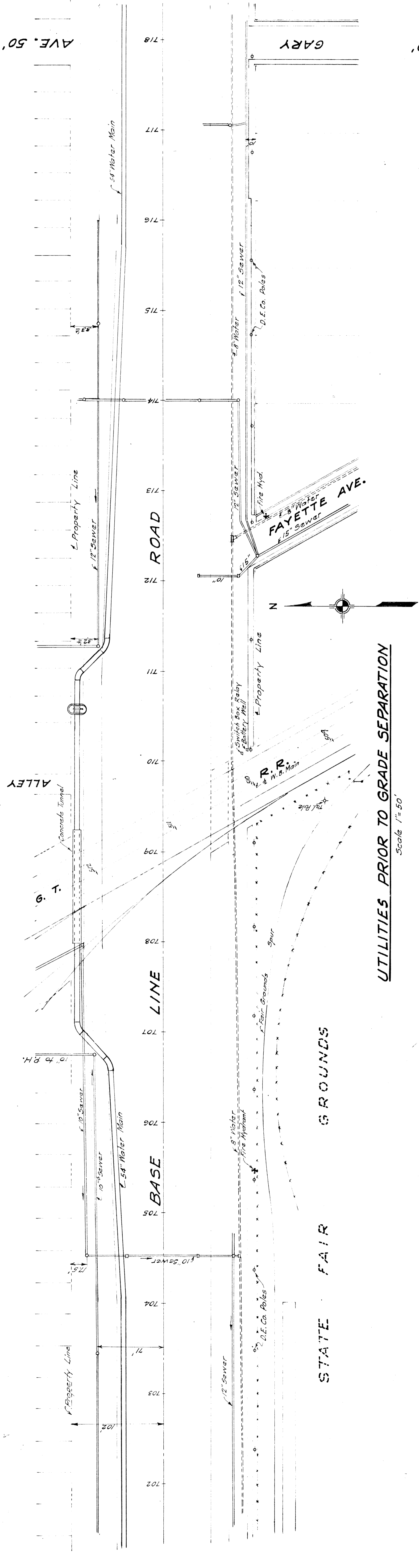

UTILITIES PRIOR TO GRADE SEPARATION
Scale 1" = 50'

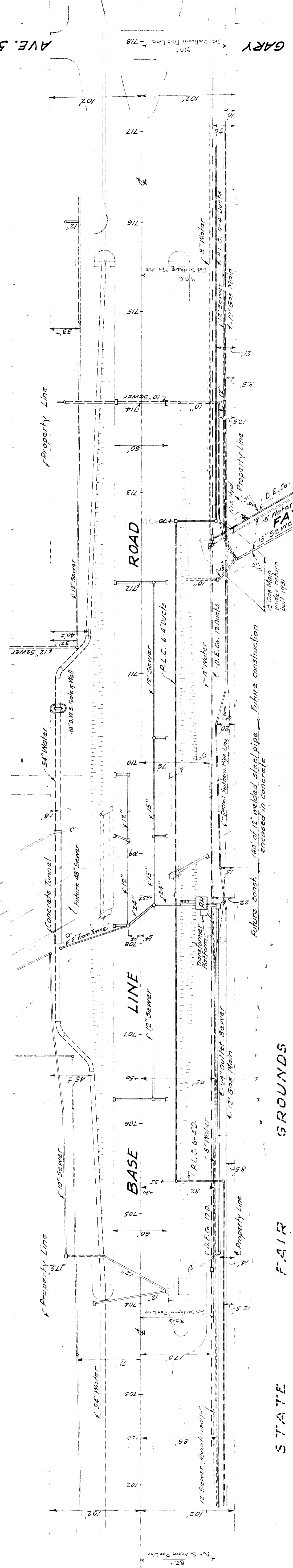

UTILITIES SUBSEQUENT TO GRADE SEPARATION
Scale 1" = 50'

Time of construction of all utilities shall be subject to the approval of the engineer. The installation of such utilities, including backfilling of trenches under proposed paving, curb or sidewalk with gravel sand or slag (water tamped) and elsewhere with excavated material (well tamped) and disposal of excess excavated material shall be done by the owners of the respective utilities.

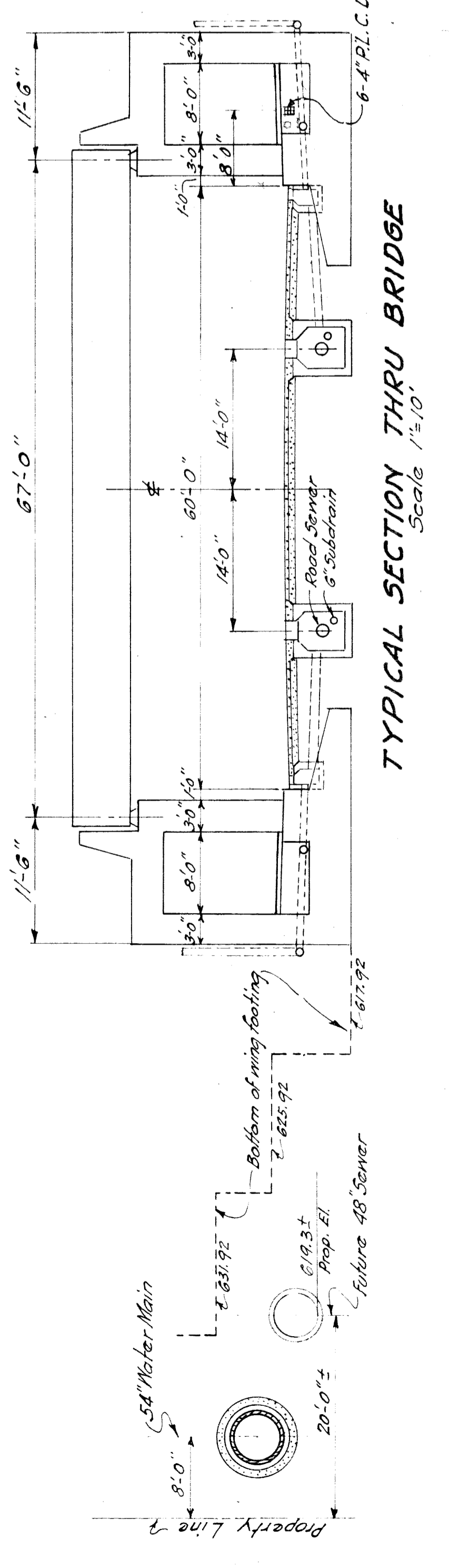

TYPICAL SECTION THRU BRIDGE
Scale 1/2" = 10'

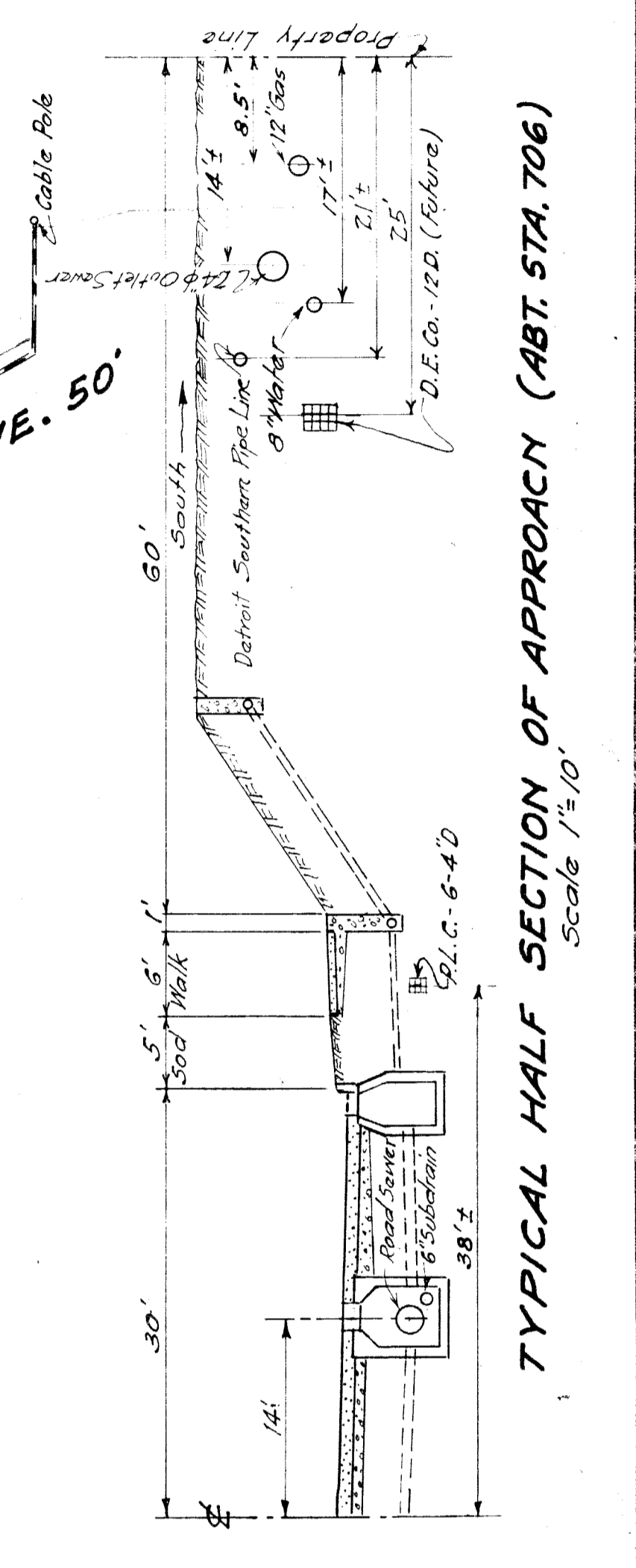

TYPICAL HALF SECTION OF APPROACH (ABT. STA. 706)
Scale 1/2" = 10'

REVISIONS Trace of 12" Sewer as per field logs 10-10-31 J.M.C. Amend for 2-1-32 12" Sewer Pipe Line under 2-1-32 12" Gas Main under 2-1-32 8" Water under 2-1-32 10" Gas Main under 2-1-32	BOARD OF WAYNE COUNTY ROAD COMMISSIONERS DETROIT, MICHIGAN EDWARD N. HINES, CHAIRMAN JOHN S. HAGGERTY, COMMISSIONER WILLIAM F. BUTLER, COMMISSIONER
UTILITY PLAN BASE LINE ROAD-MILE: G.T.R.R. GRADE SEPN. XI 96-63-19-10 (1044) Traced J.M.C. As shown on G.T.P.	JOB NO. 121 SHEET NO. 3 DATE: 2-6-31 APPROVED: [Signature] ENGINEER: [Signature]

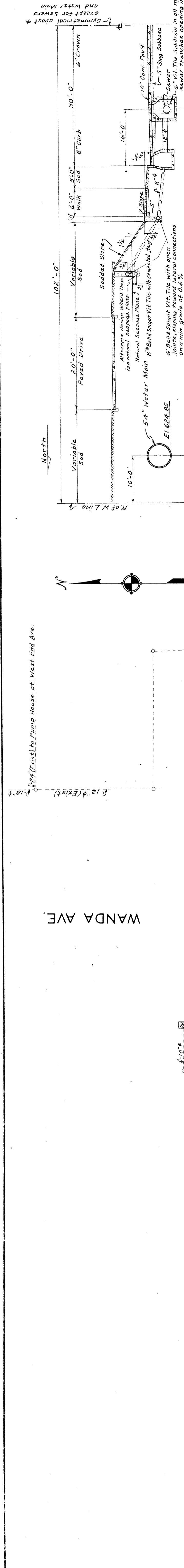

TYPICAL HALF SECTION OF APPROACH
Scale: 1" = 10"

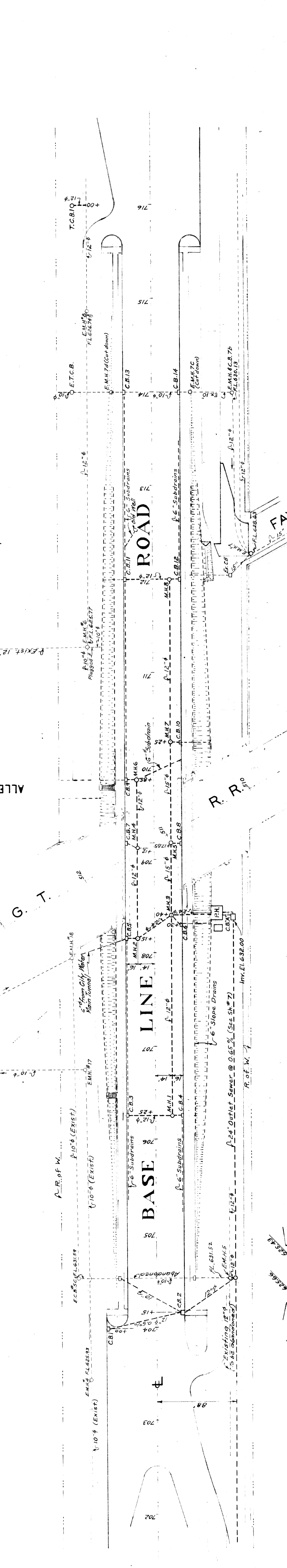

PLAN
Scale: 1" = 50"

GENERAL NOTES ~
All pipe 12" and over shall be bell and spigot reinforced concrete. Culvert Pipe shall be reinforced concrete. All pipe shall be laid on a 4" concrete base. All pipe shall be laid on a 4" concrete base. All pipe shall be laid on a 4" concrete base.

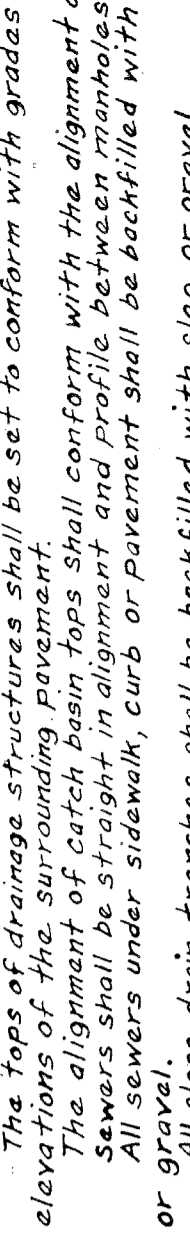

CROSS-OVER AT PUMP HOUSE

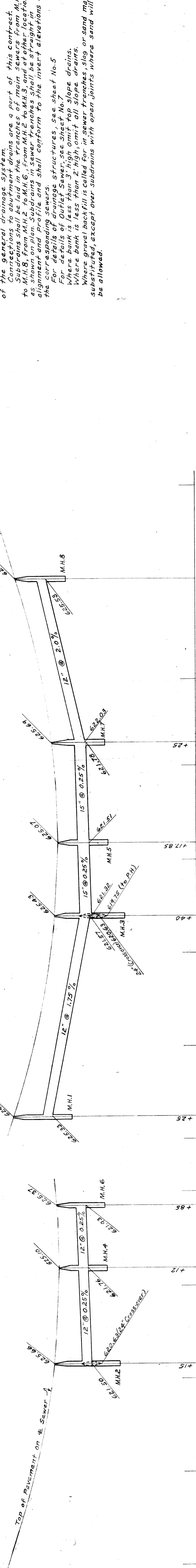

PROFILE - SEWERS NORTH SIDE
Scale: Vert. 1" = 5"

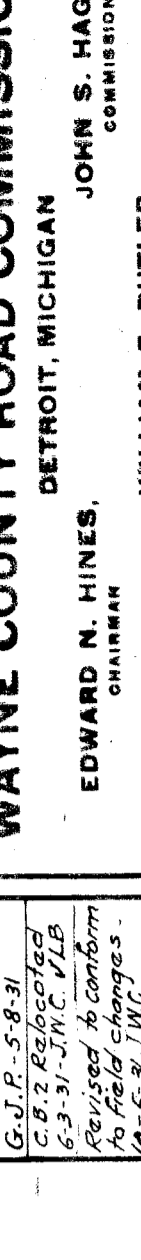

PROFILE - SEWERS SOUTH SIDE
Scale: Vert. 1" = 5"

QUANTITIES

DESCRIPTION	AMT.	UNIT
Slope Drains: 6" V.T. Pipe	2700	L.F.
GENERAL DRAINAGE		
6" V.T. Connections to Abut. Drains	100	L.F.
6" V.T. Subdrains	1900	L.F.
8" V.T. Connections to Slope Drains	300	L.F.
12" Reinforced Concrete Culvert Pipe	870	L.F.
15" "	177	L.F.
24" "	79	L.F.
Concrete in Drainage Structures	45.8	Cu. Yds
Reinf. Steel in "	535	Lbs.

NOTE: Elevations on this sheet refer to Mich. State Highway Datum. To obtain elevations according to G.T.R.R. Datum - Subtract 0.42. To obtain elevations according to City of Detroit Datum - Subtract 480.451.

REVISIONS

NO.	DATE	DESCRIPTION
1	3-10-31	Scale 1" = 50'
2	3-10-31	Scale 1" = 50'
3	3-10-31	Scale 1" = 50'
4	3-10-31	Scale 1" = 50'

DESIGNED BY: G.J.P. CHECKED BY: J.M.C. CHIEF DESIGNER
DATE: 3-10-31 SCALE: As Shown CORRECT

APPROVED: [Signature] ENGINEER

ISSUE NO. 121

DATE: 3-10-31

BOARD OF WAYNE COUNTY ROAD COMMISSIONERS
DETROIT, MICHIGAN

EDWARD M. HINES, CHAIRMAN
JOHN S. HARGETY, COMMISSIONER
WILLIAM F. BUTLER, COMMISSIONER

DRAINAGE PLAN
BASE LINE ROAD - MILE 134
G.T.R.R. GRADE SEPN. XI OF 63-1910 (HOLLY SUBN.)

DESIGNED BY: G.J.P. CHECKED BY: J.M.C. CHIEF DESIGNER
DATE: 3-10-31 SCALE: As Shown CORRECT

APPROVED: [Signature] ENGINEER

ISSUE NO. 121

DATE: 3-10-31