

REVISED PLAN OF SEWER  
TO BE CONSTRUCTED FOR  
DRAINING SUBWAY IN  
TRUMBULL AVENUE

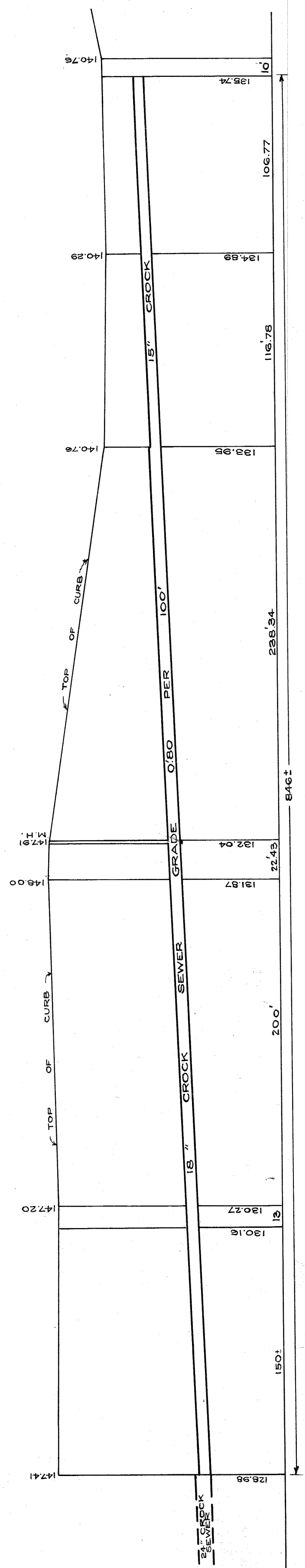

SCALE, HOR. ONE INCH = 50'  
VER. " " = 10'

CITY ENGINEER'S OFFICE  
OFFICE OF THE CITY ENGINEER  
A 4-I 1915

