

CITY OF DETROIT
 DEPARTMENT OF PUBLIC WORKS
 OFFICE OF CITY ENGINEER
 DIVISION OF GRADE SEPARATION & BRIDGES
 VERNOR HIGHWAY-JOHNSON ST.
 RETAINING WALL

Scale - As Shown
 Drawn by J.T.H.
 Checked by R.S. 8/30/27

NOTES:-
 All exposed corners to be chamfered to 1".
 All concrete mix 1:2:4.
 Back of walls to receive two brush coats of asphalt waterproofing.

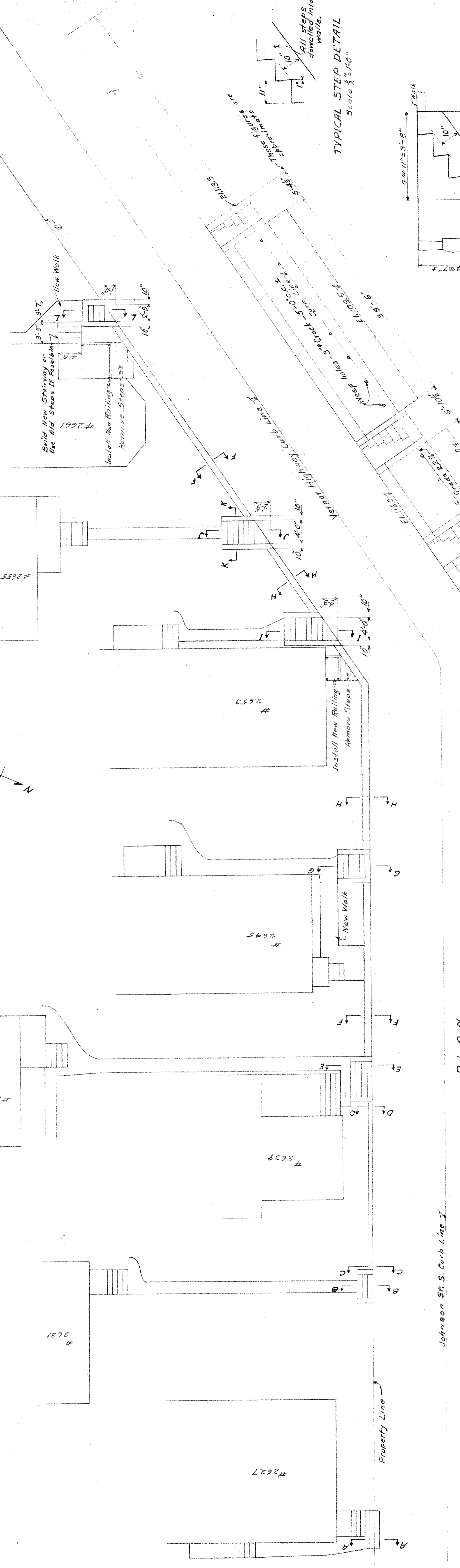

PLAN
 Scale 1/4"=1'-0"

Johnson St. S. Curb Line

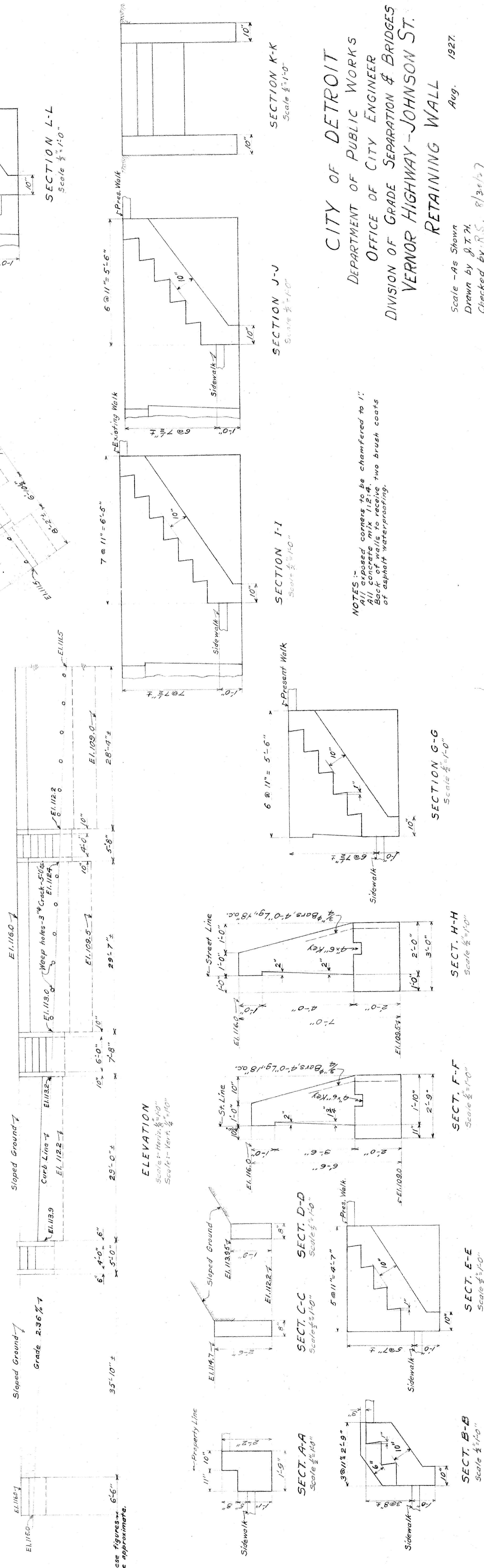

ELEVATION
 Scale 1/4"=1'-0"
 Scale - Vertical 1/4"=1'-0"

These figures are approximate.

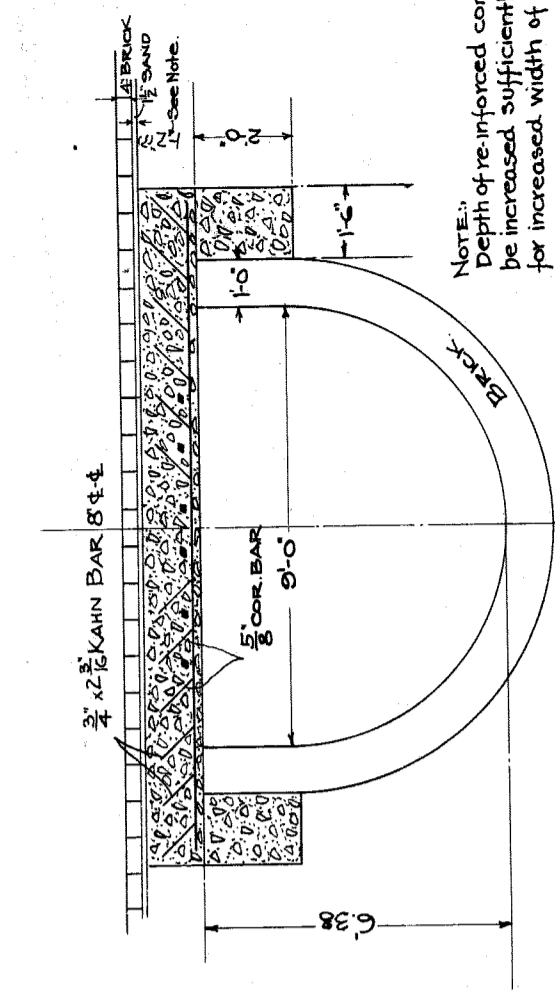
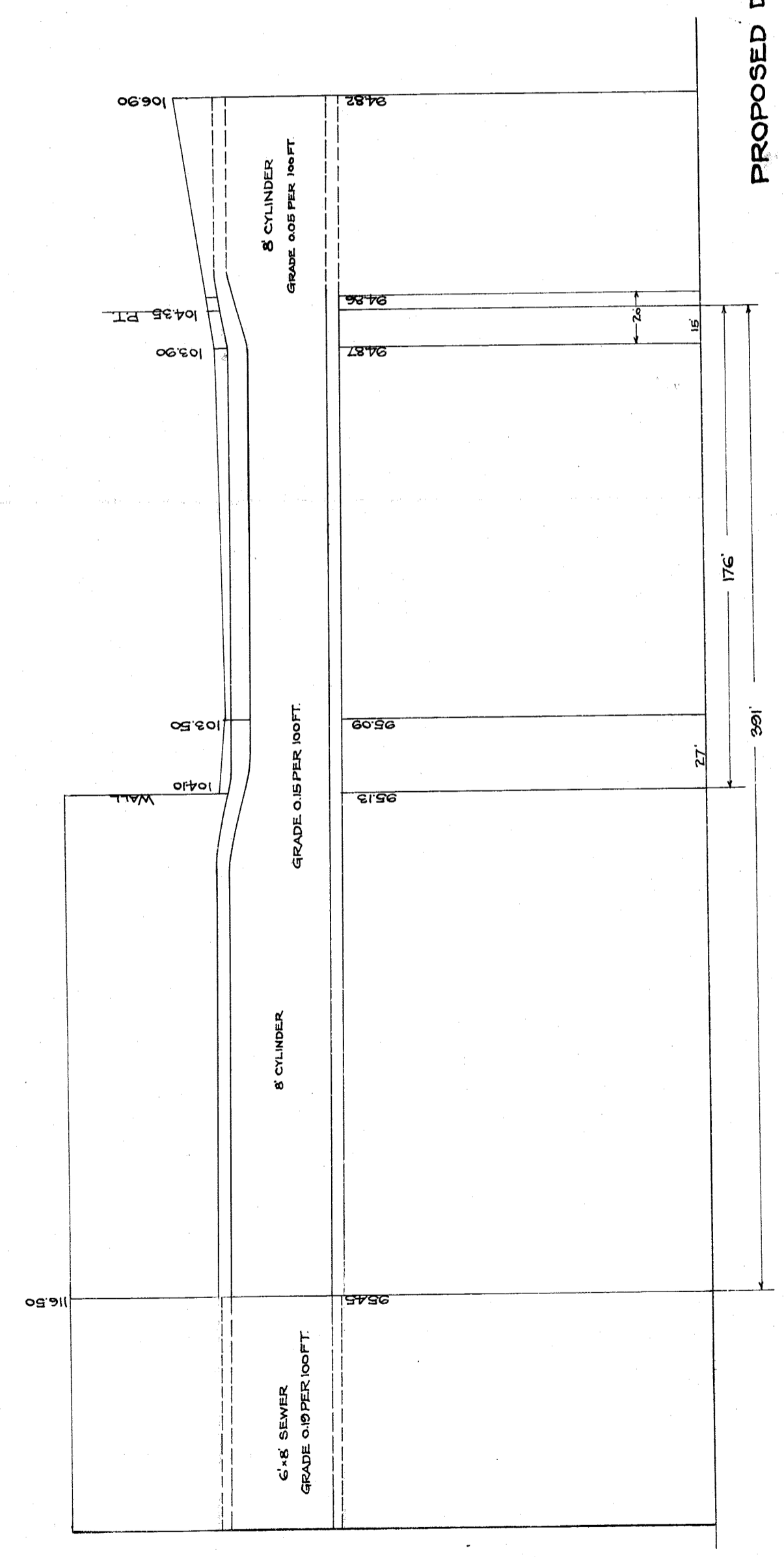
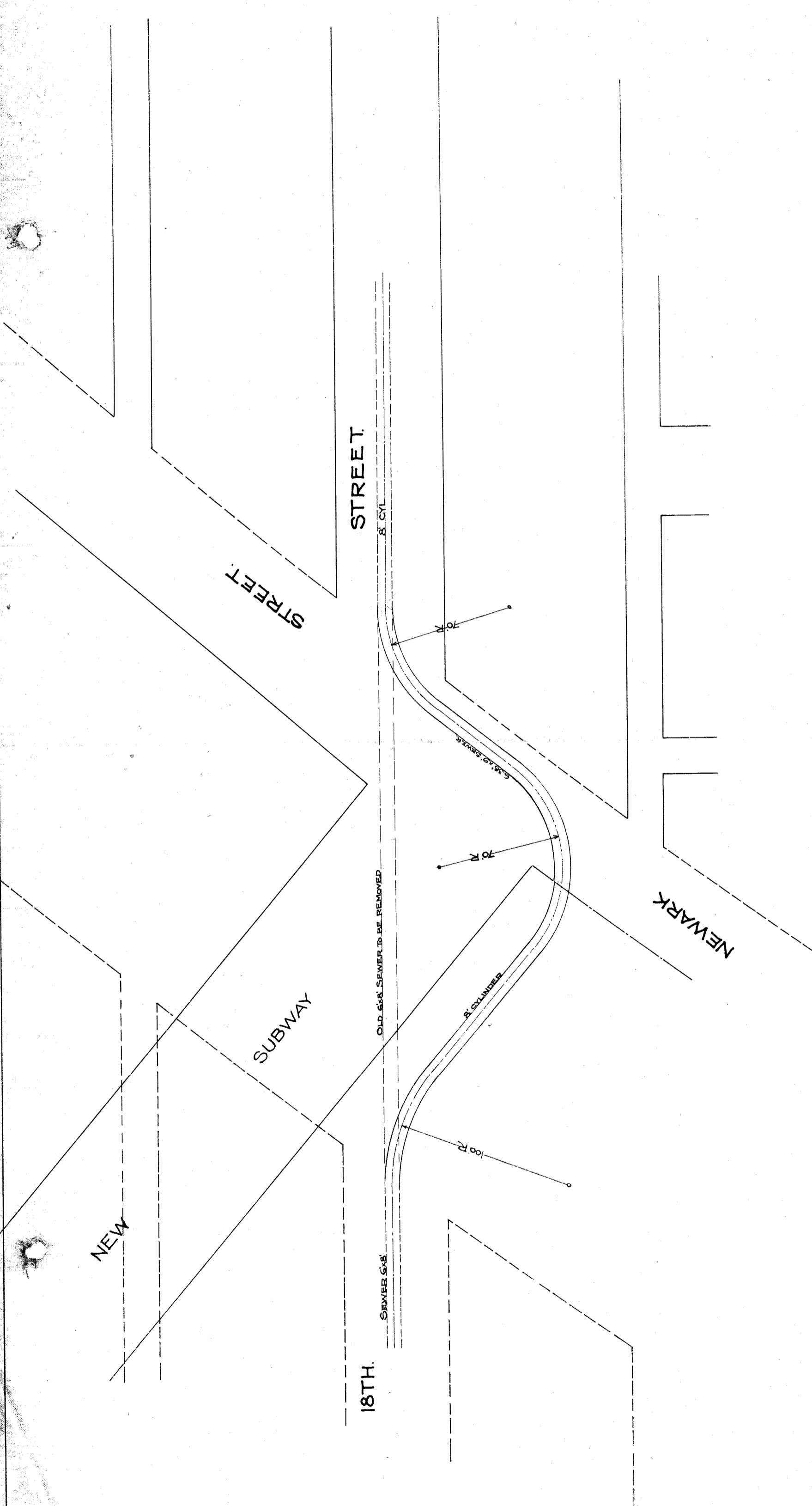

NOTE: Depth of re-inforced concrete to be increased sufficiently to provide for increased width of sewer.

SCALES:
 HOR. 1"=50'
 VERT. 1"=10'
 DETAILS 1"=4'

2a

SEC. OF SEWER UNDER PAVEMENT.

PROPOSED DIVERSION OF 18TH ST. SEWER

File XU54-2

NEWARK ST.

18 TH. ST.

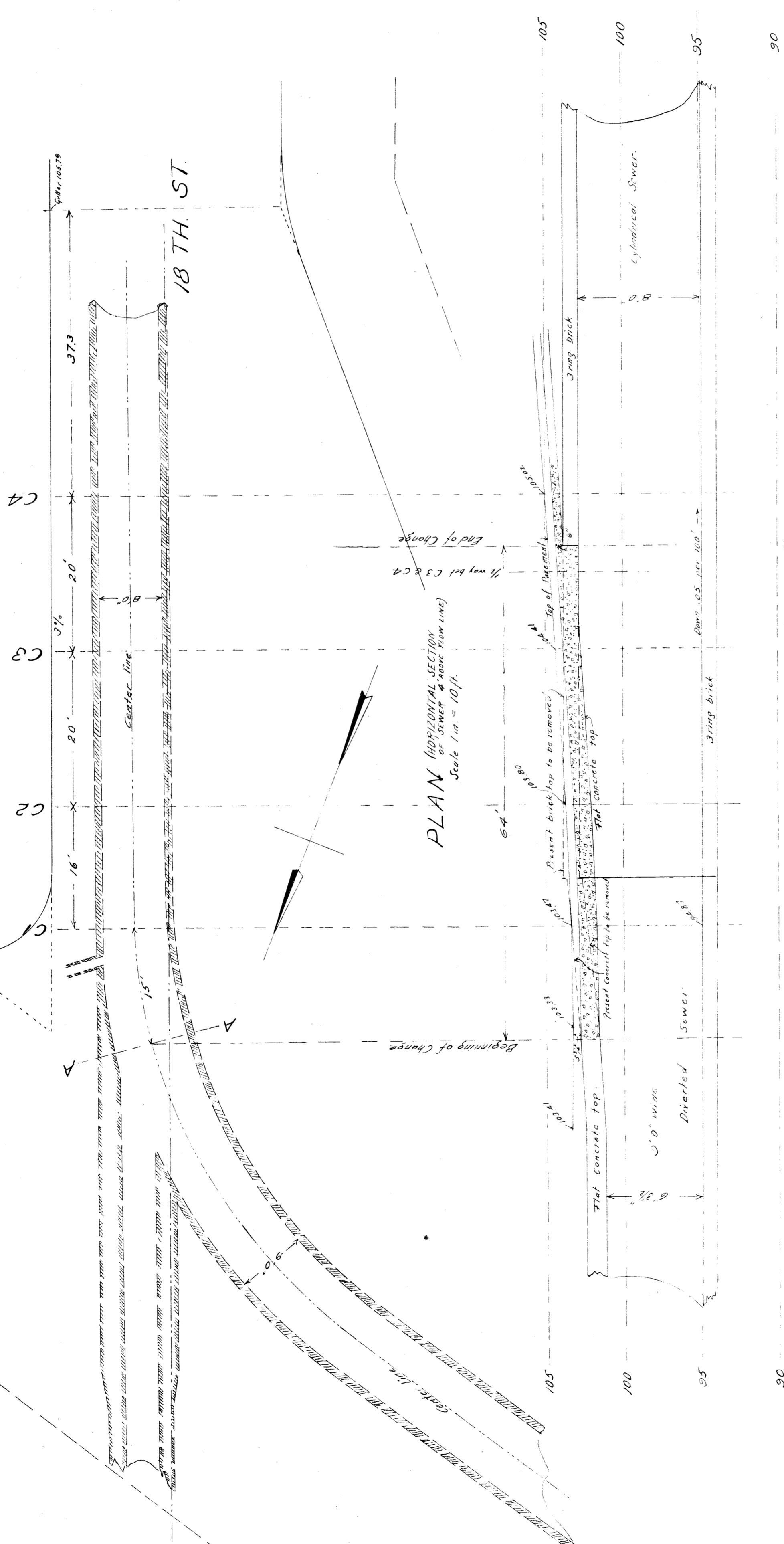

PLAN (HORIZONTAL SECTION) OF SEWER SOUTH OF NEWARK ST. Scale 1 in = 10 ft.

LONGITUDINAL SECTION ON CENTER LINE. Horizontal Scale 1 in = 10 ft. Vertical Scale 1 in = 5 ft.

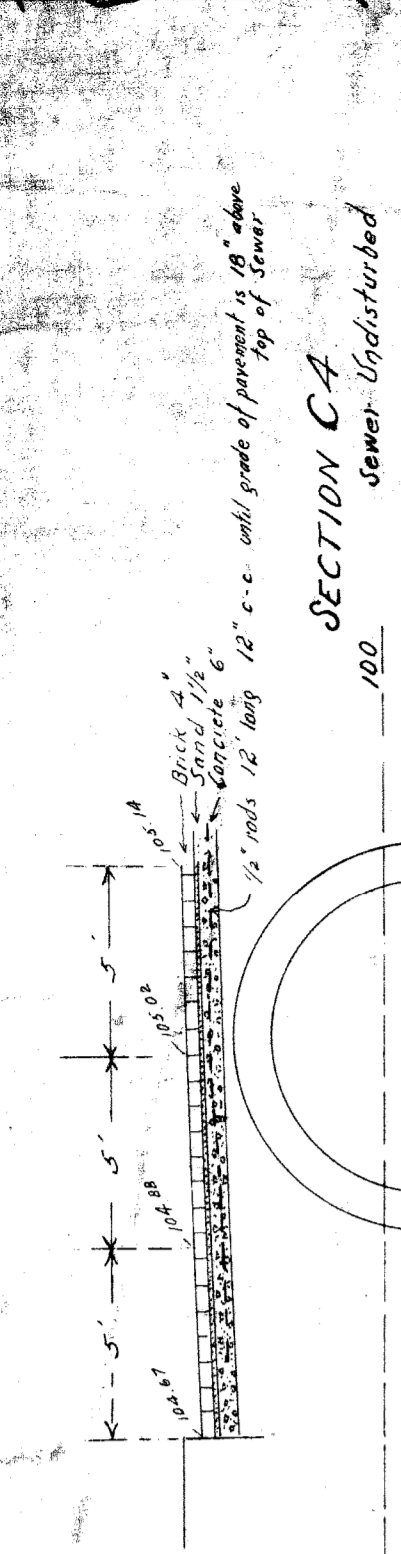

SECTION C4 Sewer Undisturbed

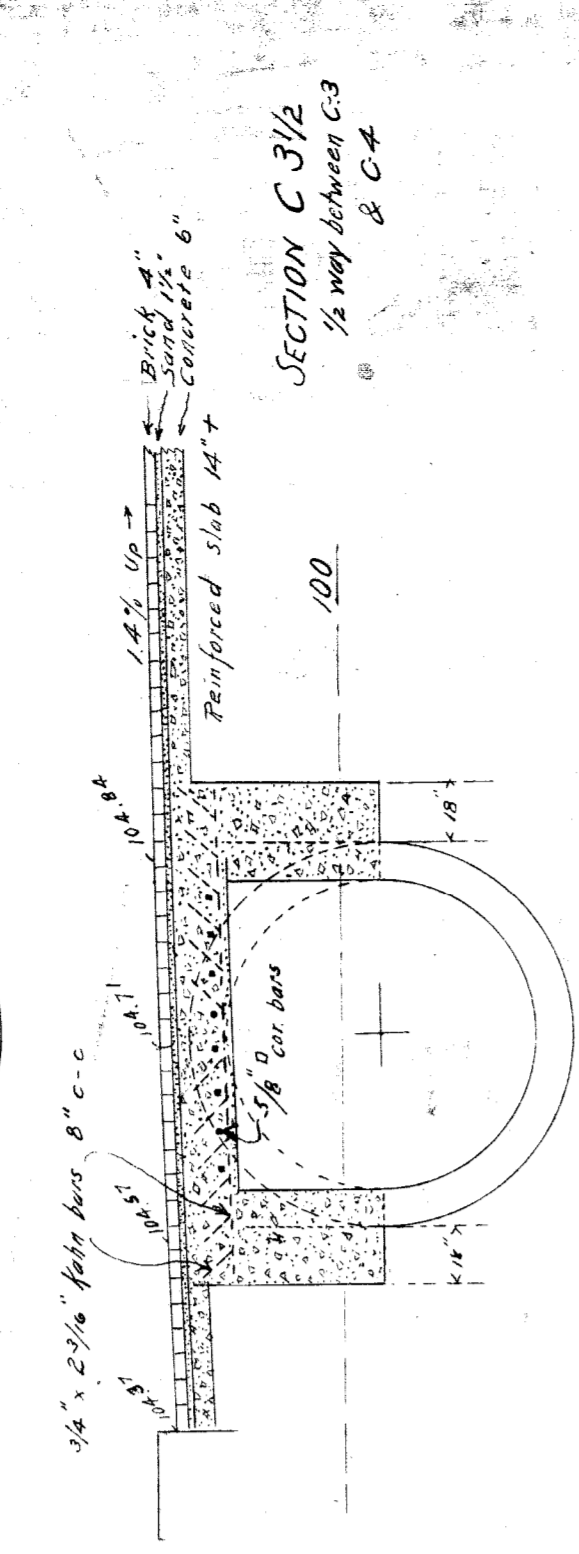

SECTION C 3 1/2 1/2 way between C3 & C4

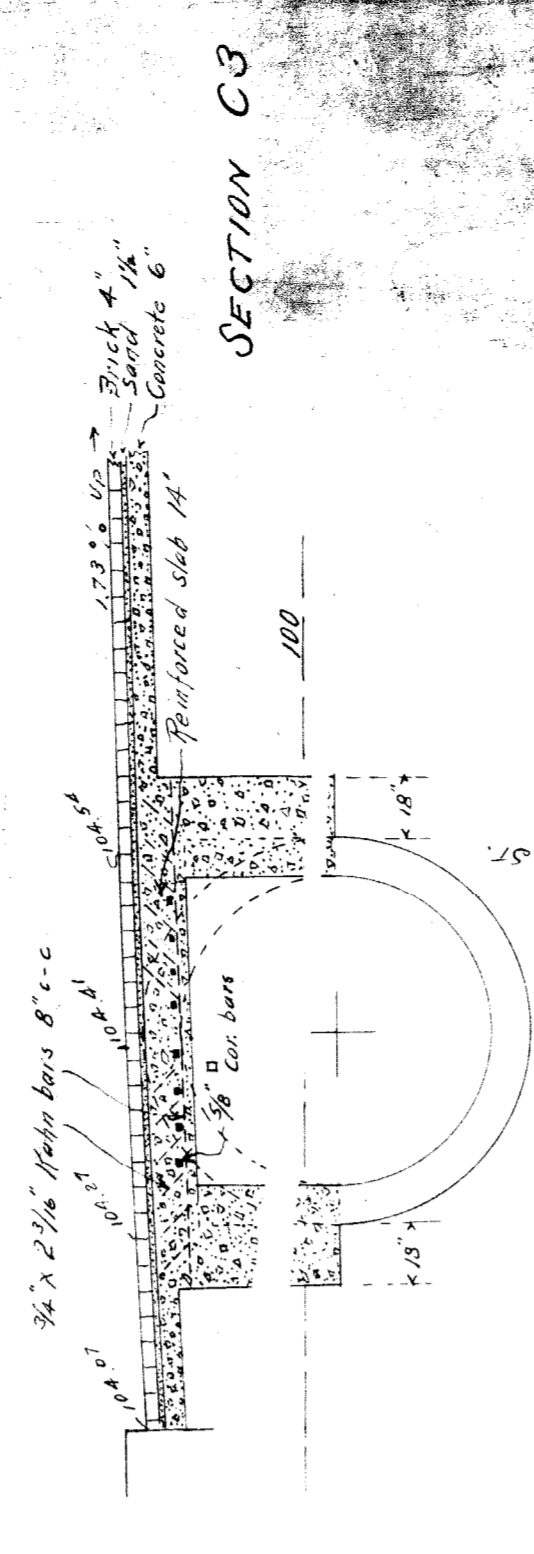

SECTION C3

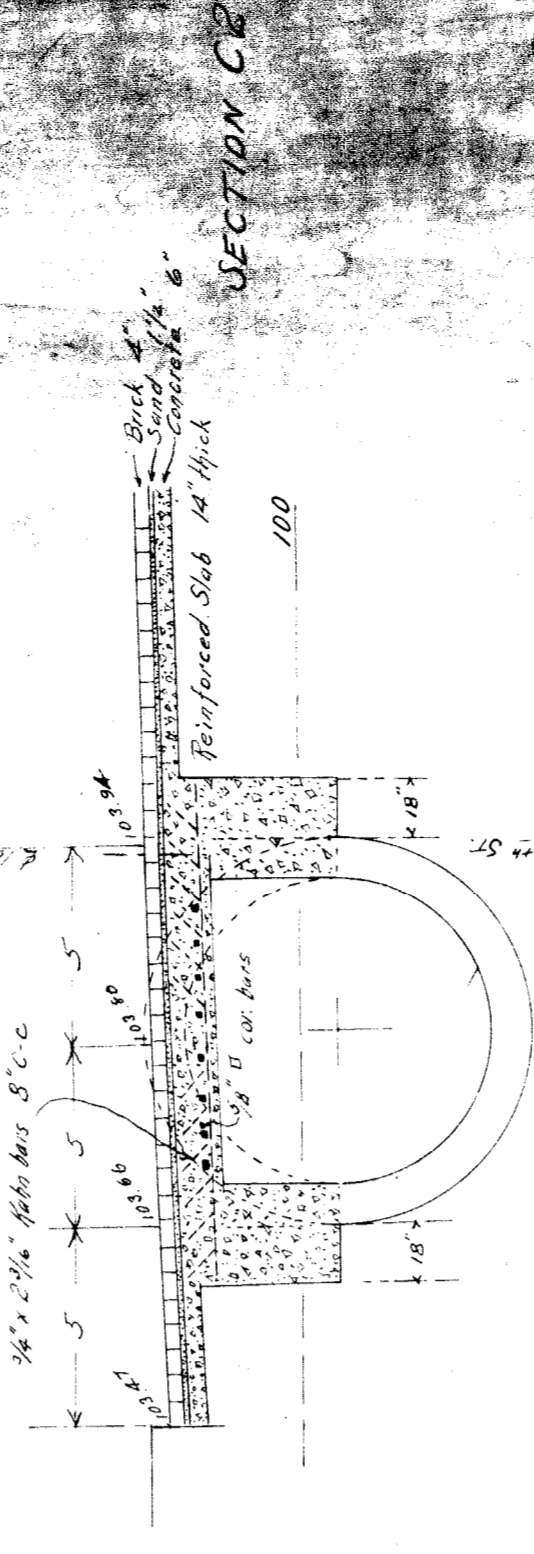

SECTION C2

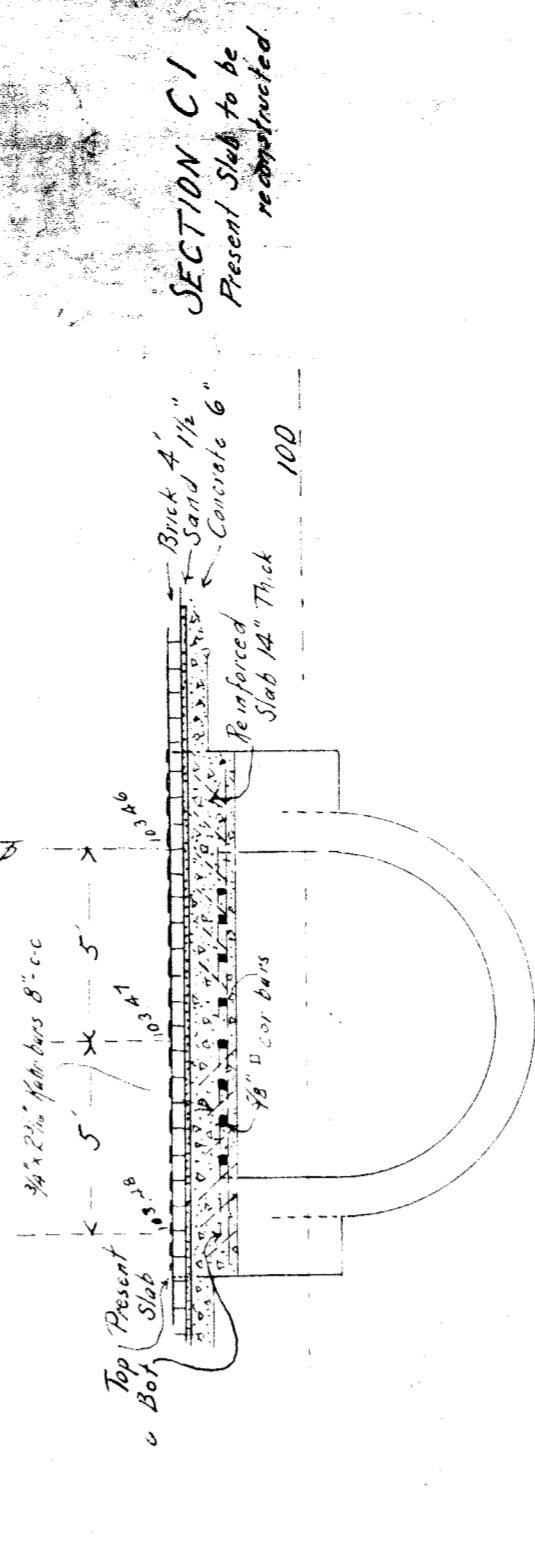

SECTION C1 Present Sill to be reconstructed

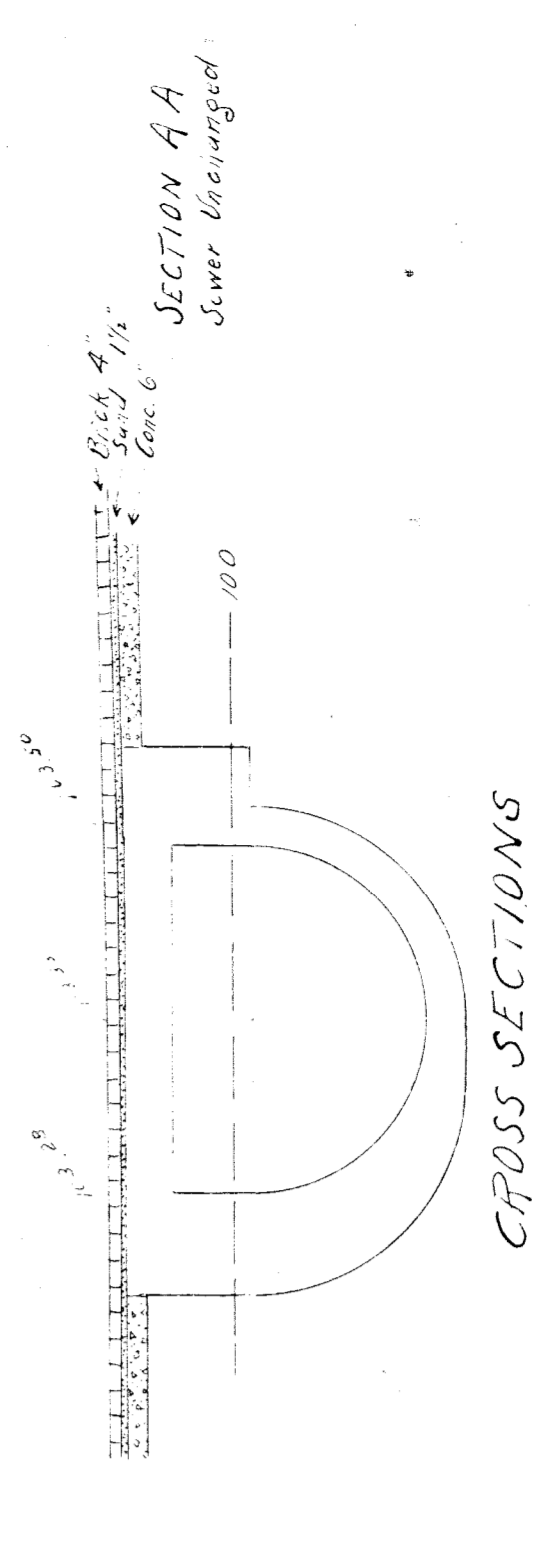

SECTION A A Sewer Unchanged

CROSS SECTIONS Scale 1 in = 5 ft.

MICHIGAN CENTRAL RAILROAD
LOWERING TOP OF 18 TH. ST. SEWER
SOUTH OF NEWARK ST.
DETROIT

Office of Grade Separation Eng'r
 Detroit May 8 1913

Approved *W. H. M. C. R. R.* Chief Eng'r M. C. R. R.
 Approved *W. H. M. C. R. R.* City Eng'r

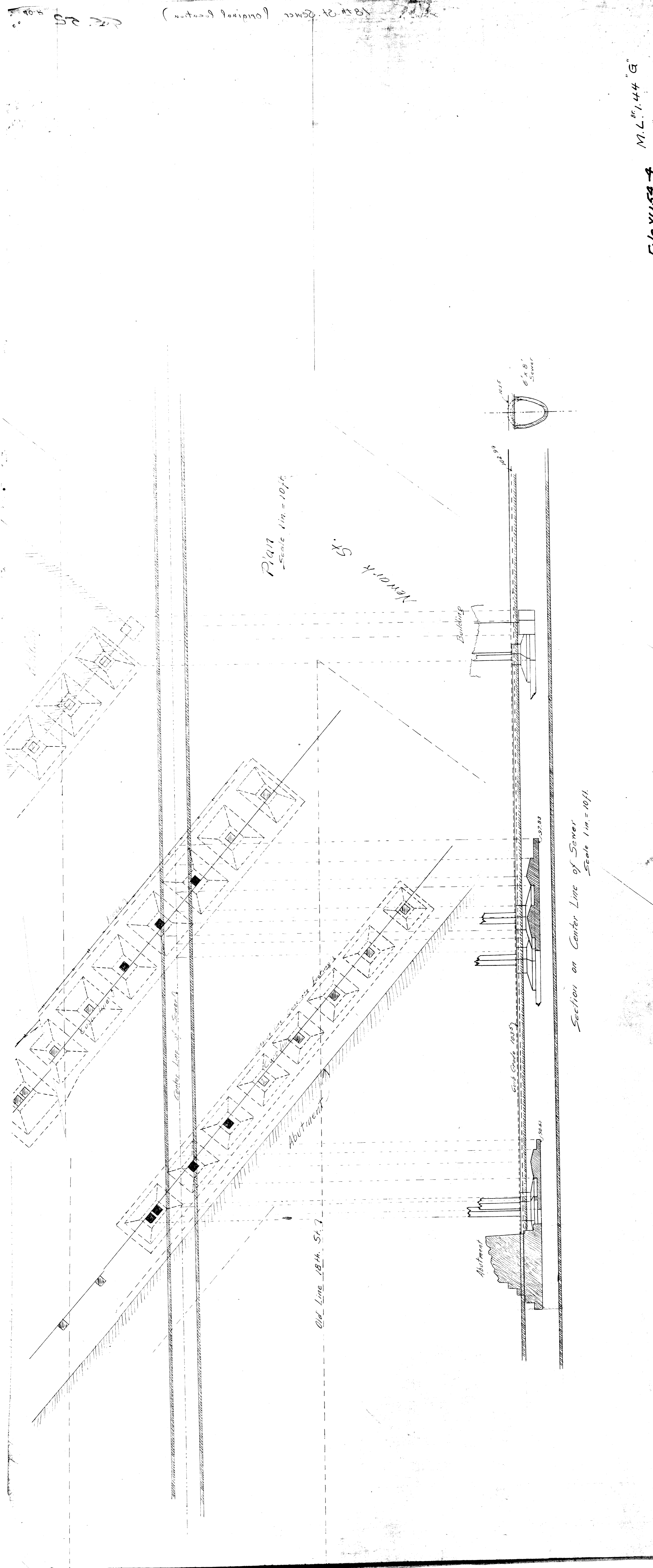

18th St. Sewer (original location)
 18th St. Sewer
 18th St. Sewer

M.L. 1.44 "G"
 18th St. Sewer